

B.M. 100.17 Top screw WIS HLP NE cor Savannah & Bennett.
 Base Line = Stationing (West to East) on South 1/2.

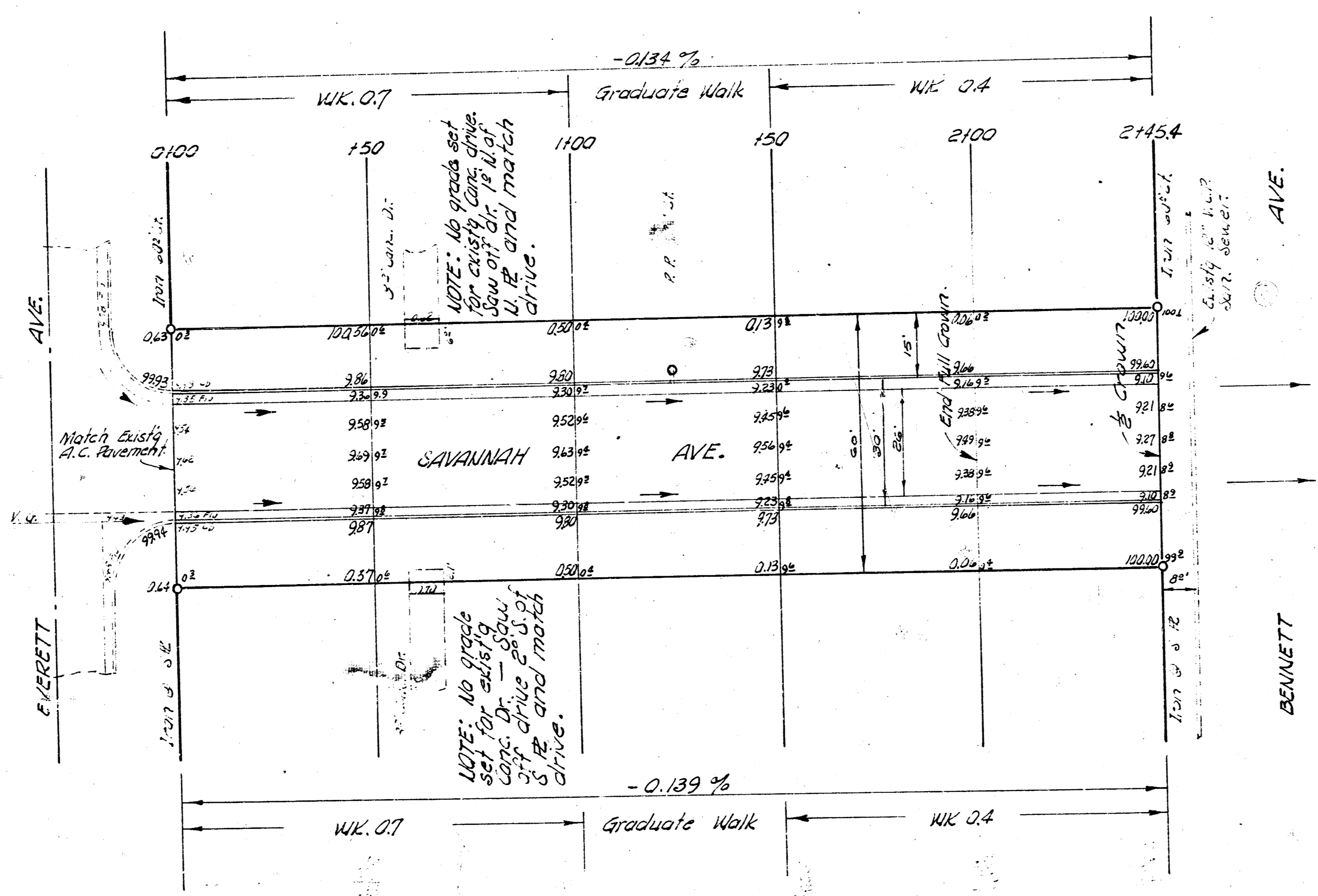

C.E. H. SMITH
 CIVIL ENGINEER
 WICHITA, KANS.

CITY	EXPLANATION	PROP.
2.0	+10%	209.2
		20.3
		230.1

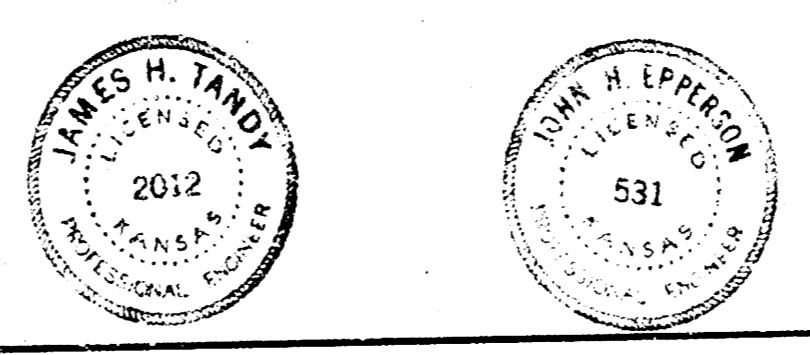

SAVANNAH AVE.
 EL EVERETT TO WL BENNETT
 26-2-30 A.C.
 CITY OF WICHITA, KANS.
 B. E. SMITH CITY ENGINEER
 AUG. 1958, PROJ. NO. C14-247