

BM=11702 SE. Cor Conc Porch. House on NW. Cor. St. Louis and Millwood

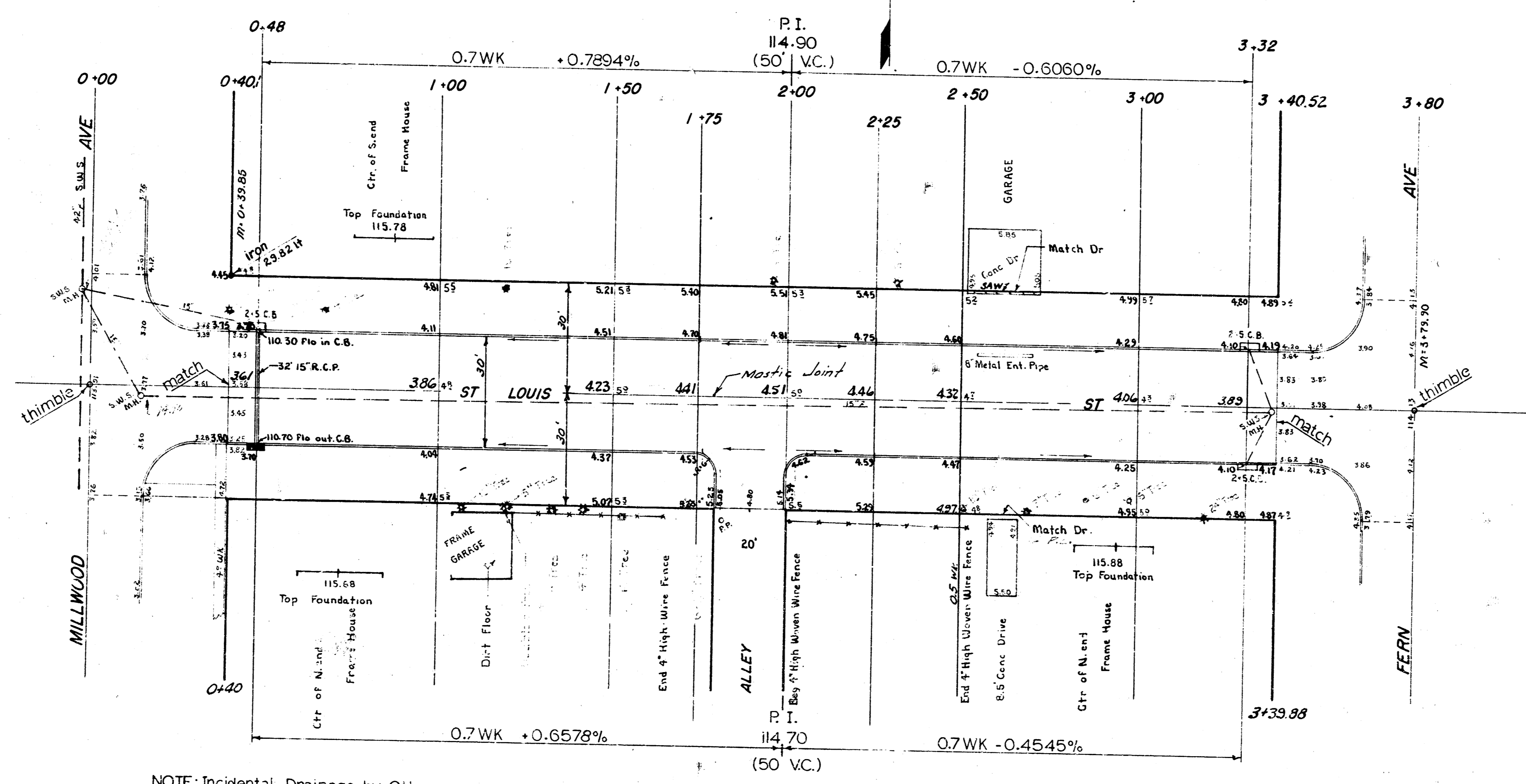

Scale 1" = 20'



NOTE: Incidental Drainage by Others (50 V.C.)

EXCAVATION	
PROPERTY	CITY
460 Cu. Yds.	28 Cu. Yds.
+10' 46 "	3 "
Totals 506 Cu. Yds.	31 Cu. Yds.

ST LOUIS ST
 E.L. MILLWOOD TO W.L. FERN AVE
 30' CONC & CURB
 CITY OF WICHITA, KANSAS
 B.E. SMITH CITY ENGINEER
 DATE: Aug 1964 1/2 PROJ. C 14 - 50

