

B.M. 108.37 "G" IN GLOBE W. CO. S. OF N.L. IRVING  
 B.M. 108.66 R.R. SPIKE IN P.P. SE COR. WALKER & ST. CLAIR  
 B.M. 108.71 "G" IN GLOBE CENTER BACK CO. NEAR E.L. ST. CLAIR & McCORMICK  
 CHAINING NORTH ON E

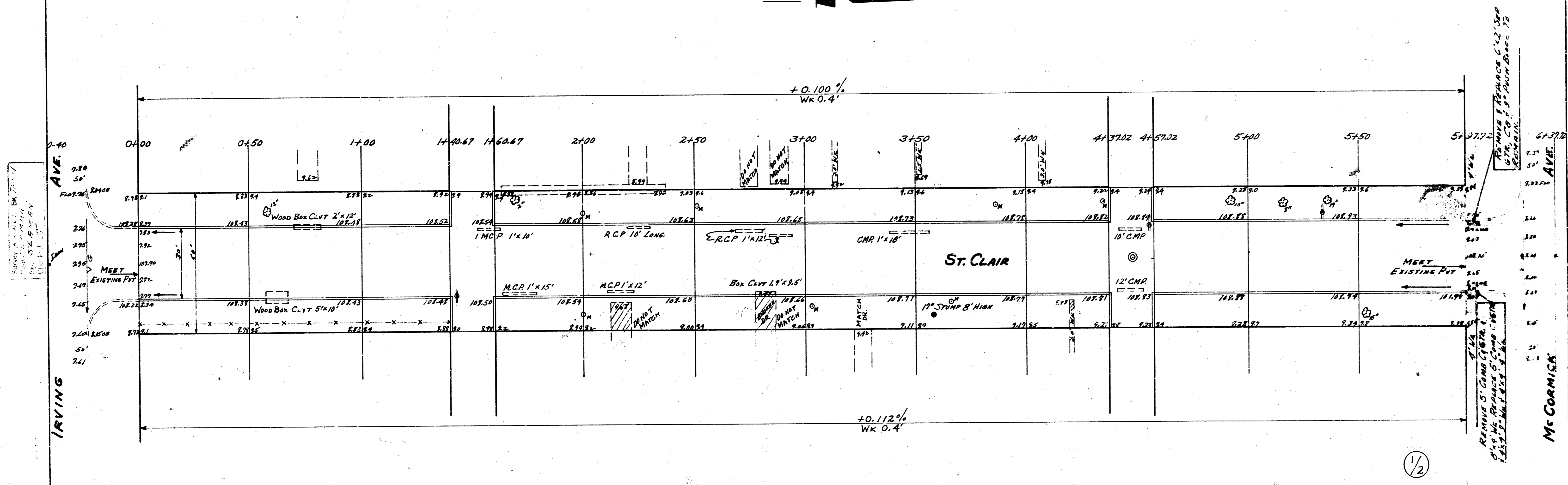
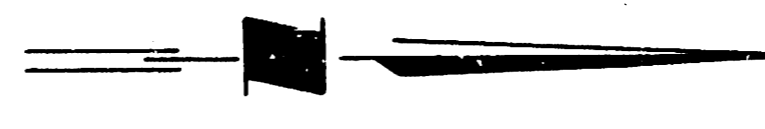

Survey by B.E. Smith  
 Dec. 1954  
 Proj. No. CH-398

REMAINING 5' CONC. CURB  
 6" x 6" REINFORCED CONC. 18" DIA.  
 12" x 12" MANHOLE BASE TO  
 CORNER

PROPERTY  
 1159.3  
 +12% 115.9  
 1275.2 CU. YDS. CUT

CITY  
 133.5  
 +11% 13.4  
 146.9 CU. YDS. CUT

ST. CLAIR  
 S.L. McCORMICK TO N.L. IRVING  
 30' CONC. & CB.  
 CITY OF WICHITA, KAN.  
 B.E. SMITH, CITY ENGINEER  
 Dec. 1954 Proj. No. CH-398



1/2