

B.M. 104.85 Sta. S.W. Cor. Meridian & May.
 B.M. 105.95 "M" In Muller, Fire Plug N.E. Cor. May & St. Clair
 Chaining From S. To N. On W.R.

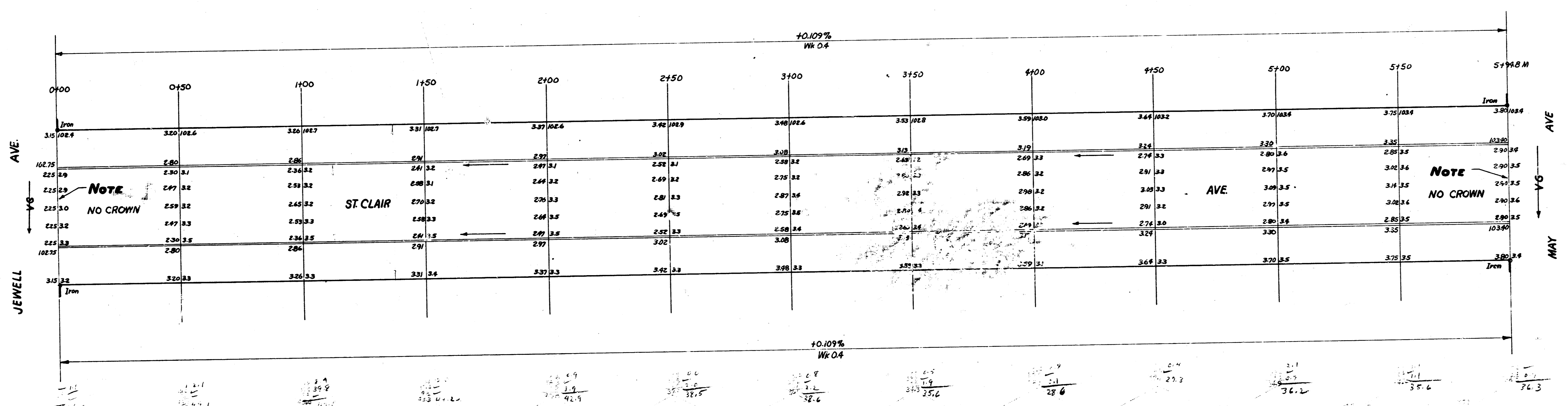

Surveyed by J.A. Jones
 Checked by W. H. Johnson
 Date 6/1/55

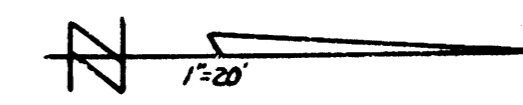

ST. CLAIR AVE.
 N.L. JEWELL TO S.L. MAY
 30 CONC. & CB.
 CITY OF WICHITA, KANSAS
 B.E. SMITH CITY ENGINEER
 JUNE, 1955 Proj. No. CM-367