

Survey/Plan
 Plan No. 14
 Checked

W. REVERSE CURVE DATA - FACE OF CURB

R=42.42'
 Δ=36° 06' 13"
 L=26.73'
 C=26.29'
 T=19.83'

SCALE: 1"=20'

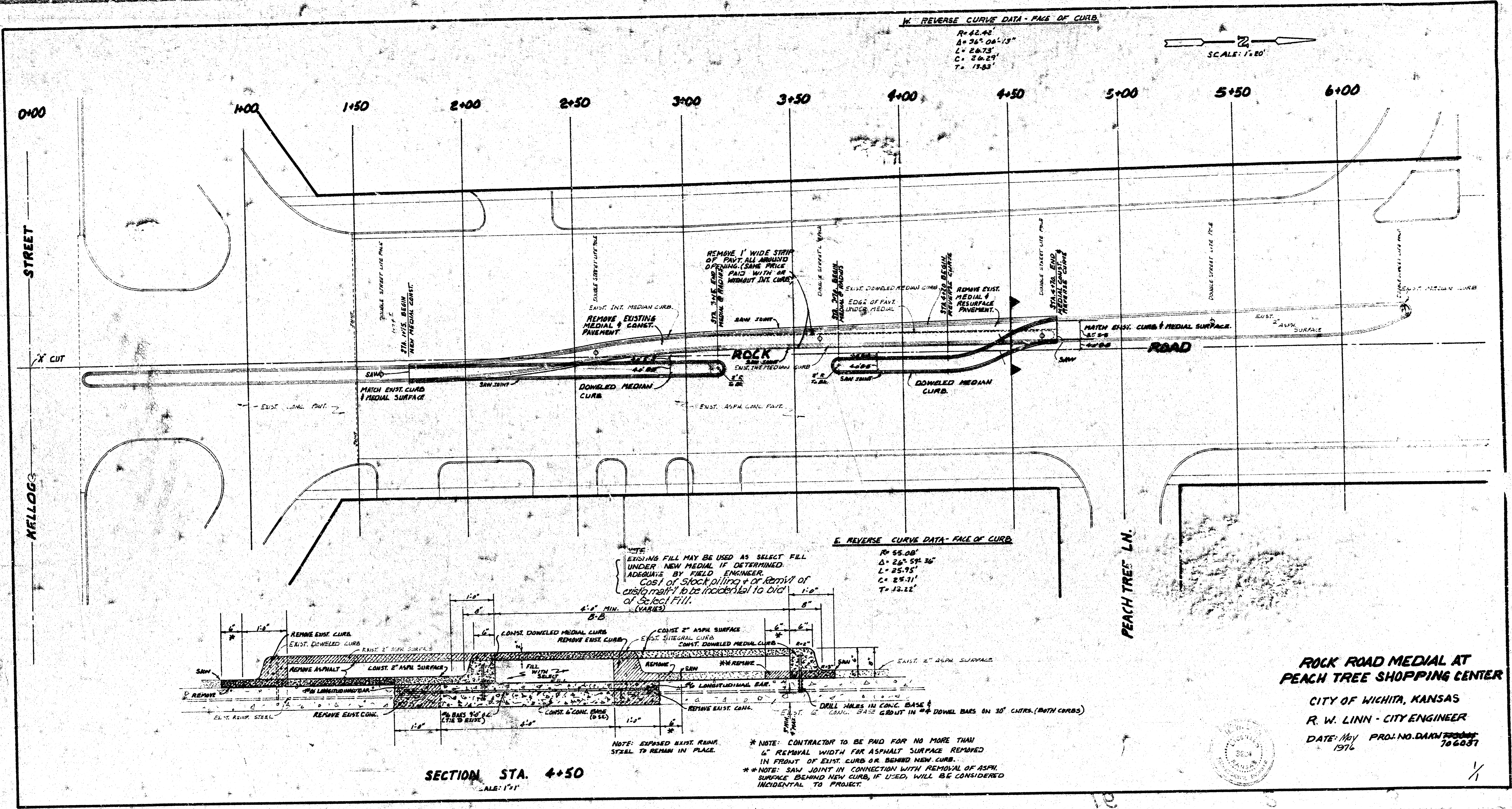

E. REVERSE CURVE DATA - FACE OF CURB

R=55.08'
 Δ=26° 59' 36"
 L=25.95'
 C=25.31'
 T=13.22'

NOTE: EXISTING FILL MAY BE USED AS SELECT FILL UNDER NEW MEDIAL IF DETERMINED ADEQUATE BY FIELD ENGINEER. COST OF STOCK PILING & REMOVAL OF CURB MATERIAL TO BE INCIDENTAL TO COST OF SELECT FILL.

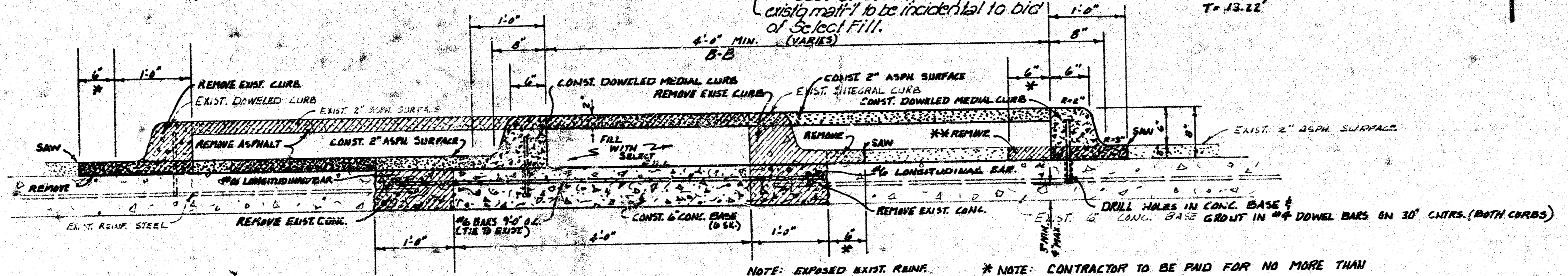

SECTION STA. 4+50
 SCALE: 1"=1'

NOTE: EXPOSED EXIST. REIN. STEEL TO REMAIN IN PLACE.

* NOTE: CONTRACTOR TO BE PAID FOR NO MORE THAN 6" REMOVAL WIDTH FOR ASPHALT SURFACE REMOVED IN FRONT OF EXIST. CURB OR BEHIND NEW CURB.
 ** NOTE: SAW JOINT IN CONNECTION WITH REMOVAL OF ASPH. SURFACE BEHIND NEW CURB, IF USED, WILL BE CONSIDERED INCIDENTAL TO PROJECT.

ROCK ROAD MEDIAL AT PEACH TREE SHOPPING CENTER

CITY OF WICHITA, KANSAS
 R. W. LINN - CITY ENGINEER
 DATE: May 1976
 PROJ. NO. DAKW 762837

