

B. M. 101.99 NE cor. conc. Po. 2nd to N. of Savannah W.S. Everett.
 B. M. 102.70 NW cor. conc. Po. to # 2203 Savannah.
 Base line of sta on N. E. chain E.

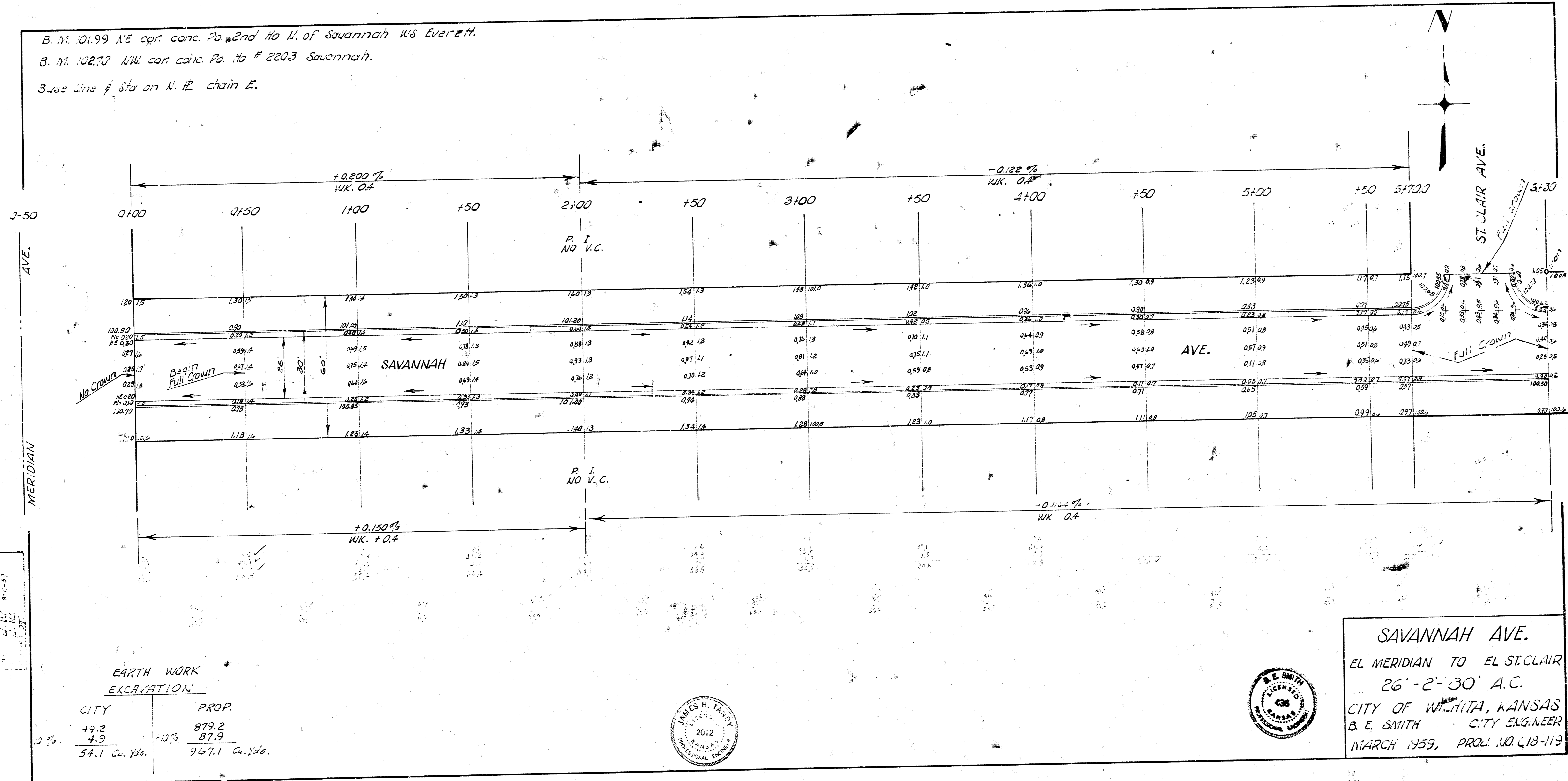

EARTH WORK EXCAVATION

CITY	PROP.
49.2	879.2
4.9	87.9
54.1 Cu. Yds.	967.1 Cu. Yds.

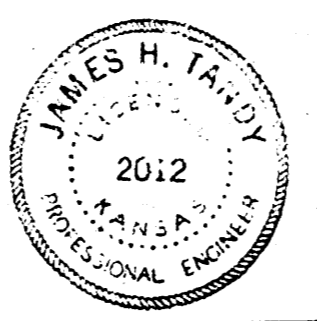

SAVANNAH AVE.
 EL MERIDIAN TO EL ST. CLAIR
 26'-2'-30" A.C.
 CITY OF WICHITA, KANSAS
 B. E. SMITH CITY ENGINEER
 MARCH 1959, PROJ. NO. C18-119