

B.M. 103.79 "9" in 1948 N. Curb Waterman, 10' W. of W.L. Topeka, 10' W. of catch basin.

B.M. 108.24 "4" on walk at building S.E. Corner Topeka & English.

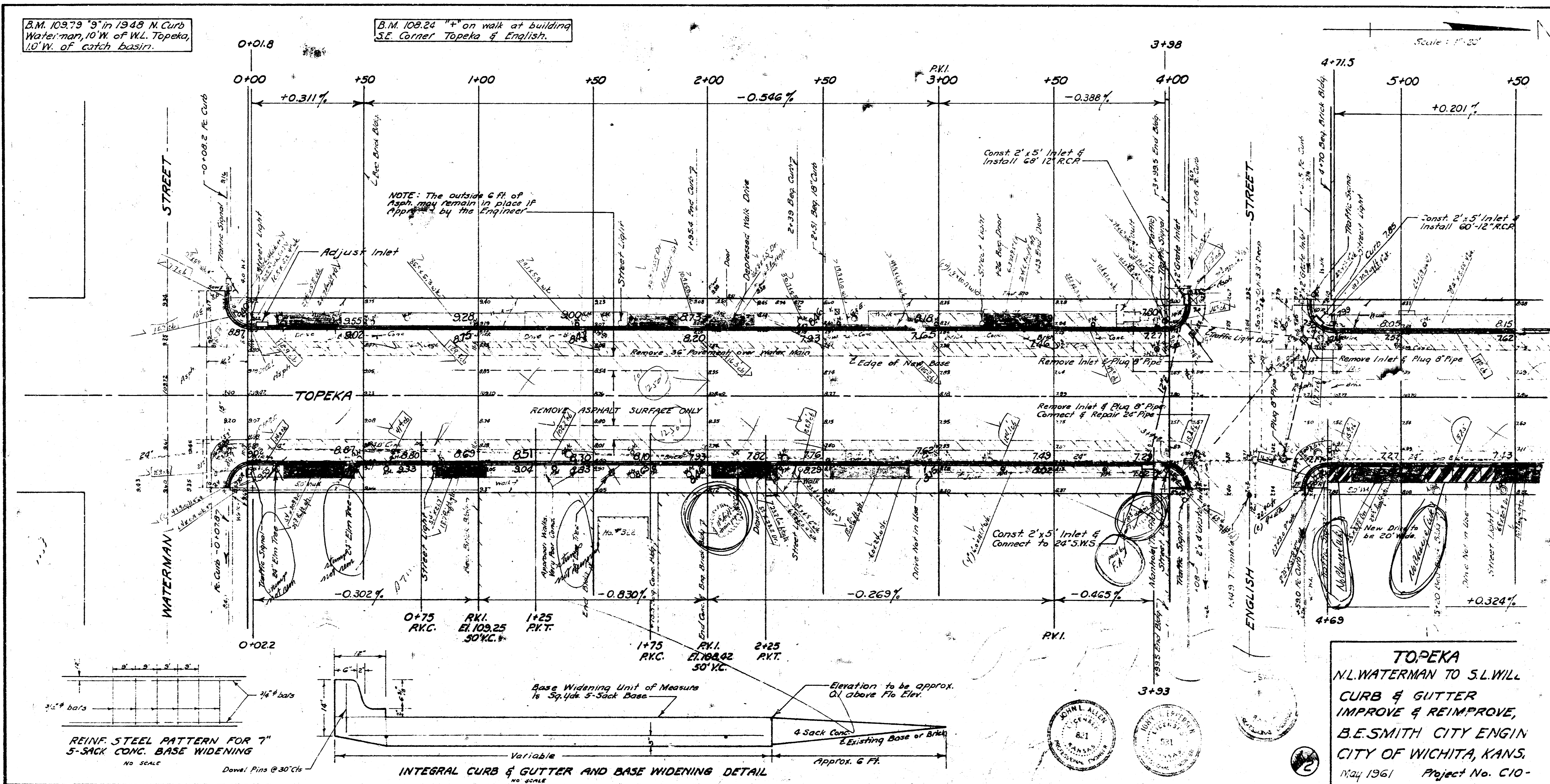

Survey Chart Br. 93
Checked

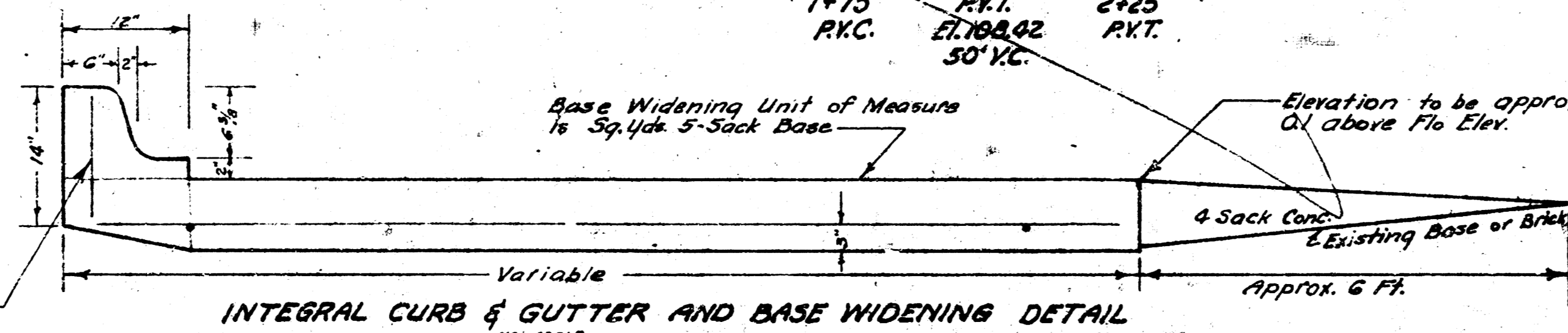
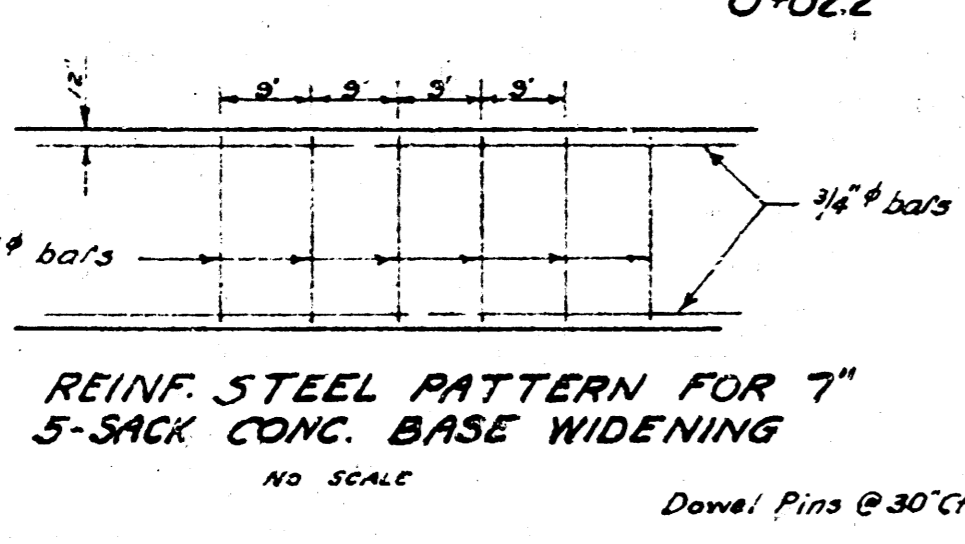

TOPEKA
N.L. WATERMAN TO S.L. WILL
CURB & GUTTER
IMPROVE & REIMPROVE,
B.E. SMITH CITY ENGINEER
CITY OF WICHITA, KANS.
May 1961 Project No. C10-

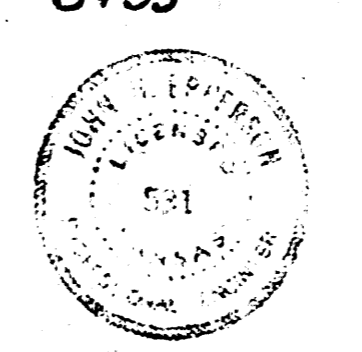
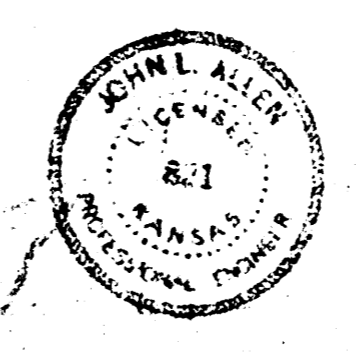

B.M. 109.79 "3" in 1948 N. Curb Waterman, 10' W. of W.L. Topeka, 10' W. of catch basin.

B.M. 108.24 "4" on walk at building S.E. corner Topeka & English.

Scale: 1"=20'

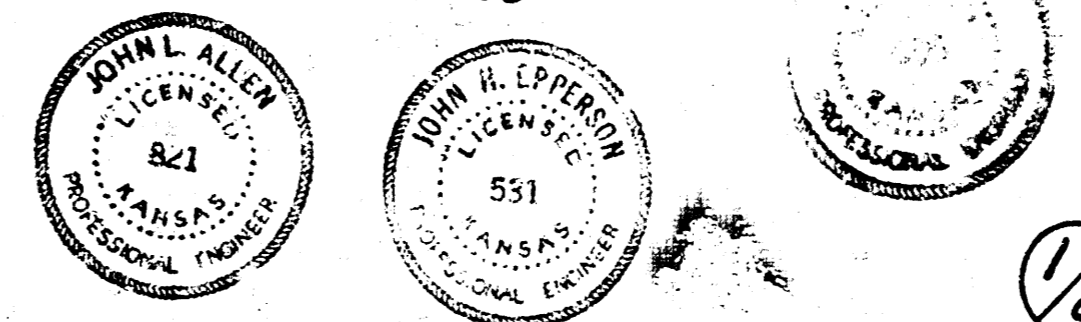
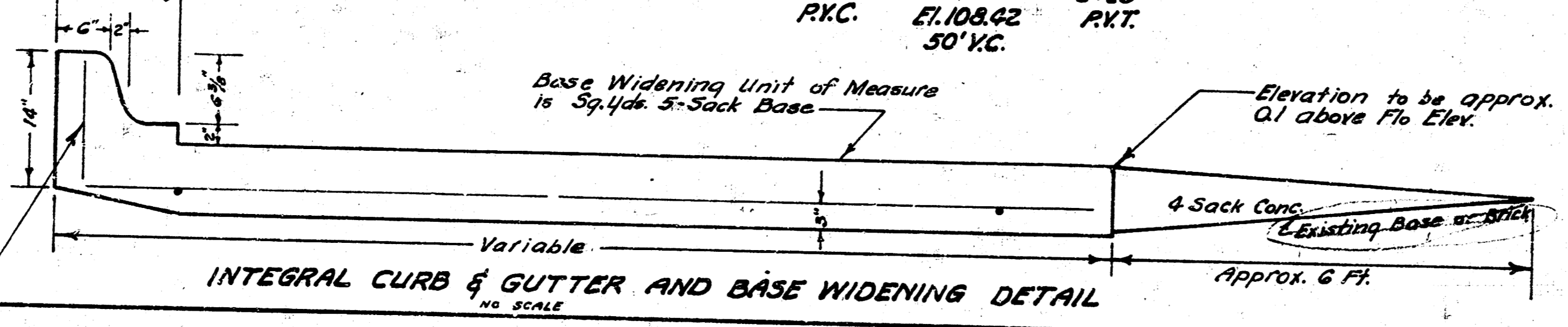
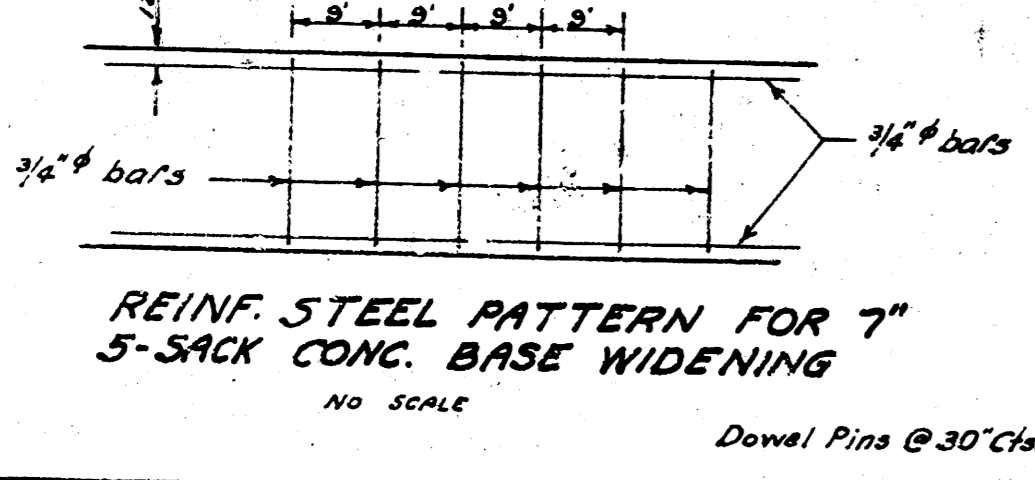
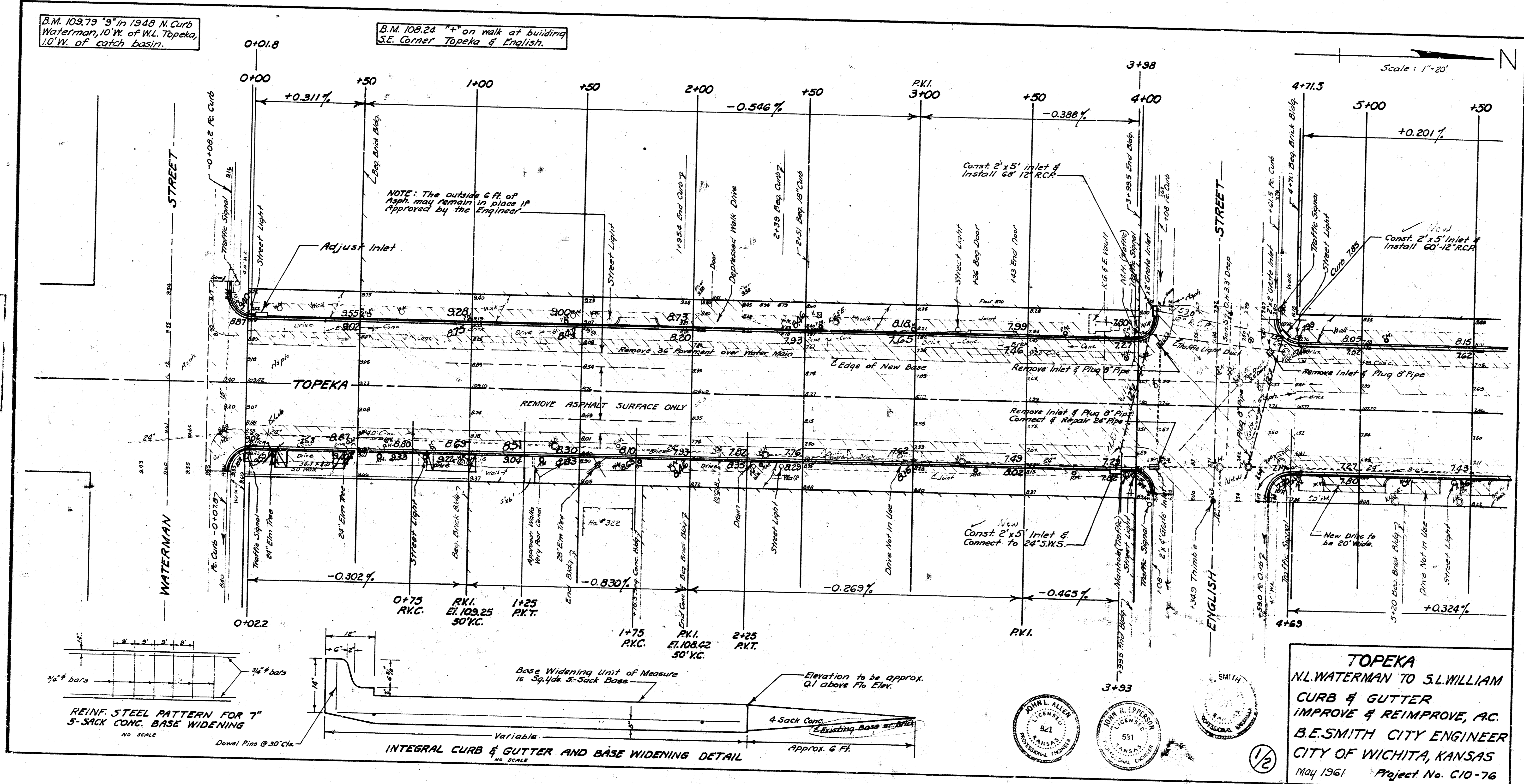

TOPEKA
N.L. WATERMAN TO S.L. WILLIAM
CURB & GUTTER
IMPROVE & REIMPROVE, A.C.
B.E. SMITH CITY ENGINEER
CITY OF WICHITA, KANSAS
May 1961 Project No. C10-76

