

WOODCHUCK LANE

South line of Special Ed ADD. to the North line of Country Acres

472-76-245-80831-000-000-001

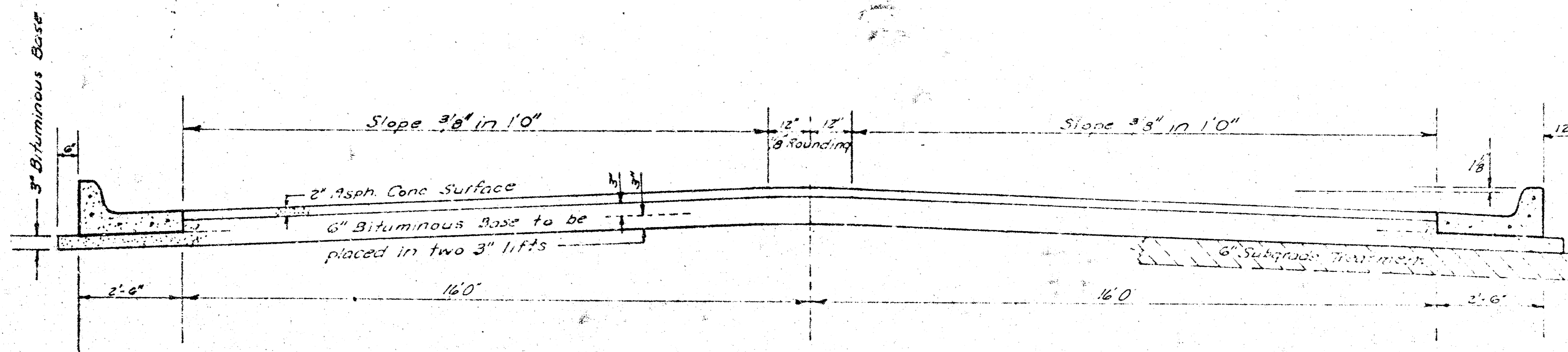

TYPICAL SECTION

37' ASPHALTIC CONCRETE PAVEMENT WITH BITUMINOUS BASE

A TACK COAT OF EMULSIFIED ASPHALT (SS-1H) SHALL BE APPLIED AT AN APPROXIMATE RATE 0.05 GALLONS PER SQ YD BETWEEN LIFTS OF ASPHALTIC MATERIALS WHEN ORDERED BY THE ENGINEER. TACK COAT WILL NOT BE PAID FOR DIRECTLY AND SHALL BE CONSIDERED AS SUBSIDIARY TO PRICE BID FOR ASPHALTIC PAVEMENT. BITUMINOUS BASE AND ASPHALTIC CONCRETE WEARING SURFACE SHALL BE PLACED WITH A LAYDOWN MACHINE HAVING AUTOMATIC CONTROLS FOR CROWN AND GRADE. CONSTRUCTION JOINTS IN EACH LIFT SHALL BE STAGGERED A MINIMUM DISTANCE OF 1' WITH JOINTS IN PRECEDING LIFTS AND PLACED SUCH THAT A JOINT WILL BE CONSTRUCTED ON THE CENTERLINE IN THE TOP LIFT.

DETAIL OF TRANSVERSE CONSTRUCTION JOINTS

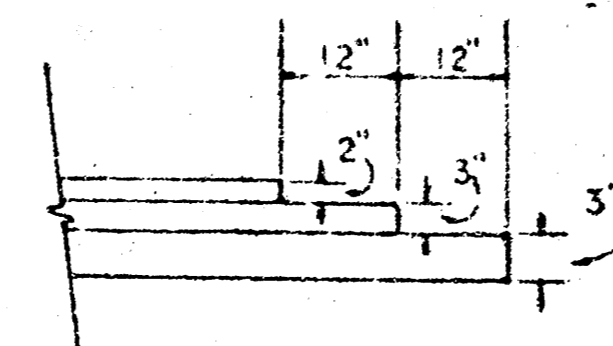

TRANSVERSE CONSTRUCTION JOINTS SHALL BE CONSTRUCTED IN FLEXIBLE BASE PAVEMENTS AT LOCATIONS WHERE PAVEMENT TEMPORARILY ENDS TO FACILITATE FUTURE PAVEMENT CONSTRUCTION AS SHOWN BY DETAIL. THE COST OF CONSTRUCTING THE TRANSVERSE CONSTRUCTION JOINTS SHALL NOT BE MEASURED OR PAID FOR DIRECTLY BUT SHALL BE INCLUDED IN THE BID PRICE FOR SQUARE YARDS OF ASPHALTIC CONCRETE PAVEMENT.

The A.C. Pavement between the comb curb & gutter shall be paid as Sq.Yds. 8" A.C. Pavement (6" Bituminous Base).
The Bituminous Base under the comb curb & gutter shall be paid as Sq.Yds. 3" Bituminous Base.

* NOTE: CONSTRUCTION OF THIS PROJECT SHALL BE COORDINATED WITH THAT OF "SOUTH HALF OF COUNTRY ACRES AVE" AND THE CONTRACTOR OF THE "SPECIAL EDUCATION CENTER" IN ORDER TO PROVIDE ACCESS.

COMBINED CURB & GUTTER

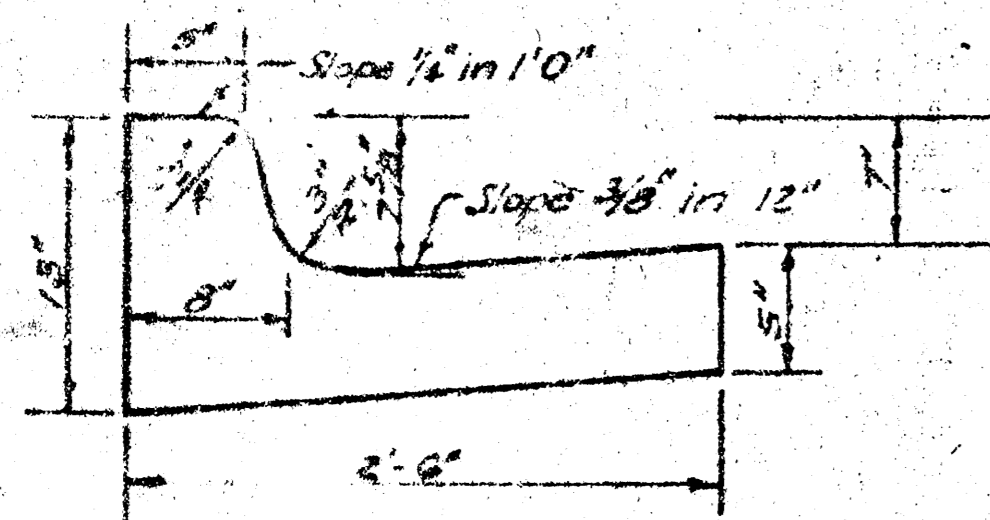

TYPE TYPE CURB & GUTTER

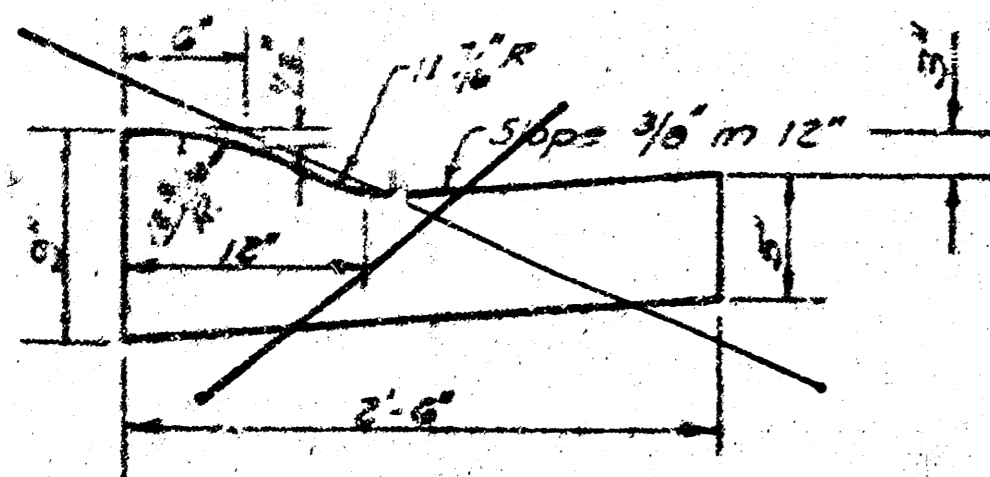

CITY OF WICHITA KANSAS

DEPARTMENT of PUBLIC WORKS - Engineering
Division

DEAN SELLERS CITY ENGINEER

DATE _____ Proj No. 472-76-245-80831-000-000-001

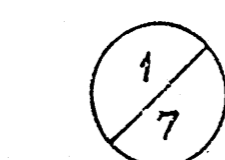

B-M = 154-048 WOODCHUCK & Central, City Std 52' N & 24' W of C Both
 B-M = 151-59 R R Spike in N Side PP 178E & 24-50' N of 1/4 Sec Stone

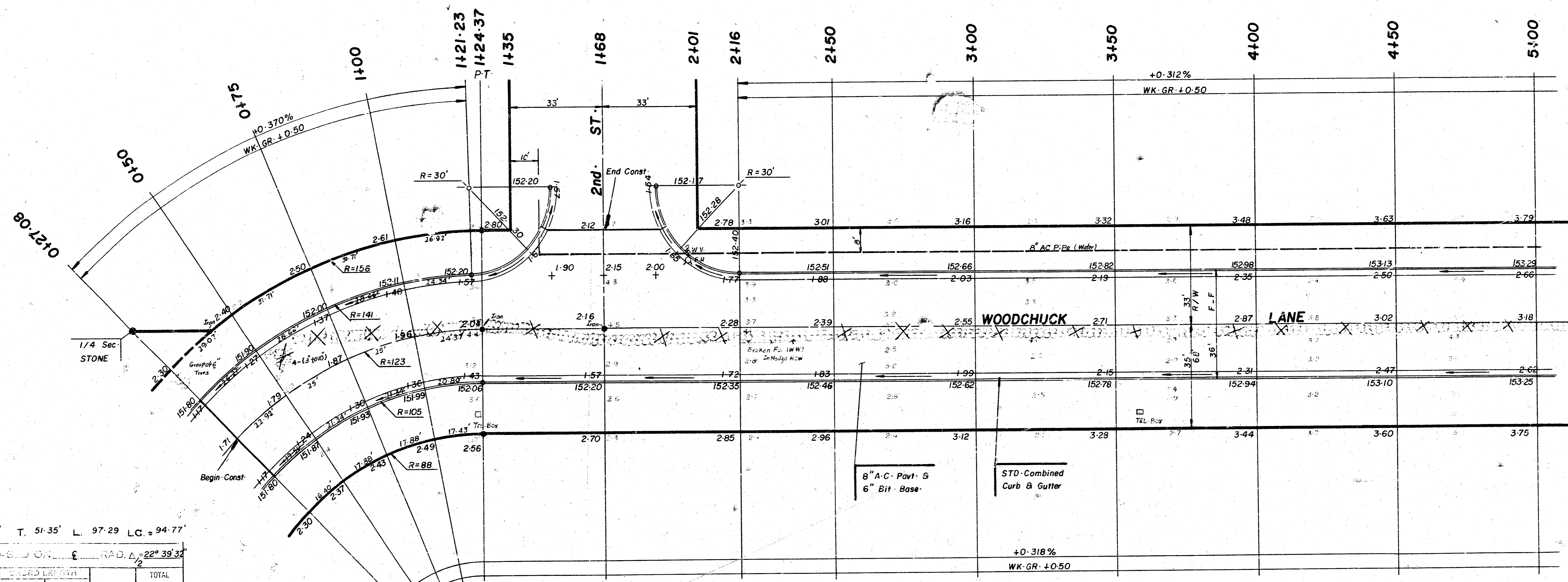
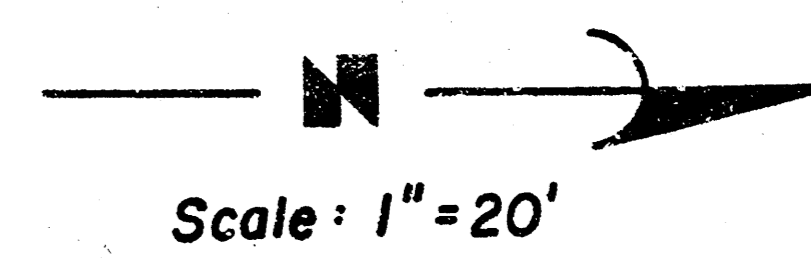

Survey Done by T.C.D.B.
 Plan Checked
 Elevation Checked

$\Delta = 45^\circ 19' 05''$ T = 123' L = 97.29' L.C. = 94.77'

CURVE DATA BASED ON $\Delta = 22^\circ 39' 32''$

STA	ARC	CHORD	OFF SET	DEFLECTION	TOTAL DEFLECTION
0+27-08	---	---	---	---	0 00' 00"
0+50	22.92	27.72	18.05	5° 20' 18"	5° 20' 18"
0+75	25.00	30.23	19.68	5° 49' 21"	11° 05' 39"
1+00	25.00	30.23	19.68	5° 49' 21"	16° 59' 00"
1+21.23	21.23	25.68	19.19	4° 56' 44"	21° 55' 40"
1+24.37	3.14	3.80	19.19	0° 43' 52"	22° 39' 32"

Defl./ft = 13.97458 Min

	PROP	CITY
Excavation	481.77 c.y	621.42 c.y
+10%	481.88 c.y	621.44 c.y
TOTAL	5300.65 c.y	683.56 c.y
Comp. Fill	0 c.y	0 c.y
Manipulation	4305.00 s.y	834.00 s.y

- NOTES
- 1- Fence Removal to be Incidental to Hedge Row Removal
 - 2- Hedge Row & Trees Removal are Marked All Trees, Which in Opinion of the Field Engineer Can be Saved, Shall be Saved
 - 3- Field Engineer to Take Ties to all Irons, Any Thimbles Removed or Destroyed Due to Construction Shall be Replaced

Note - No more than 12-20' Dr's. to be Constructed on this project.

CAUTION
 UNDERGROUND UTILITIES
 Please call 811 or 800-485-5844 or Telephone Co. for Location

SUB-GRADE
 TYPE OF SUB-GRADE TREATMENT SHALL BE DETERMINED BY THE FIELD ENGINEER. SUB-GRADE TREATMENT MAY CONSIST OF LIME TREATMENT, CEMENT TREATMENT, SUB-GRADE MODIFICATION, OR ANY COMBINATION OF THESE.

WOODCHUCK LANE
 S-L of Special ED Add to N-L Country Acres
 (37' B-B AC Pavt / Comb Curb & Gutter)
CITY OF WICHITA, KS
 DEAN SELLERS ACTING CITY ENGINEER
 PROJ. NO. 472-76-245-80831-000-000-001

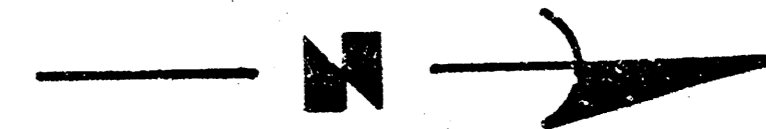

Scale 1" = 20'

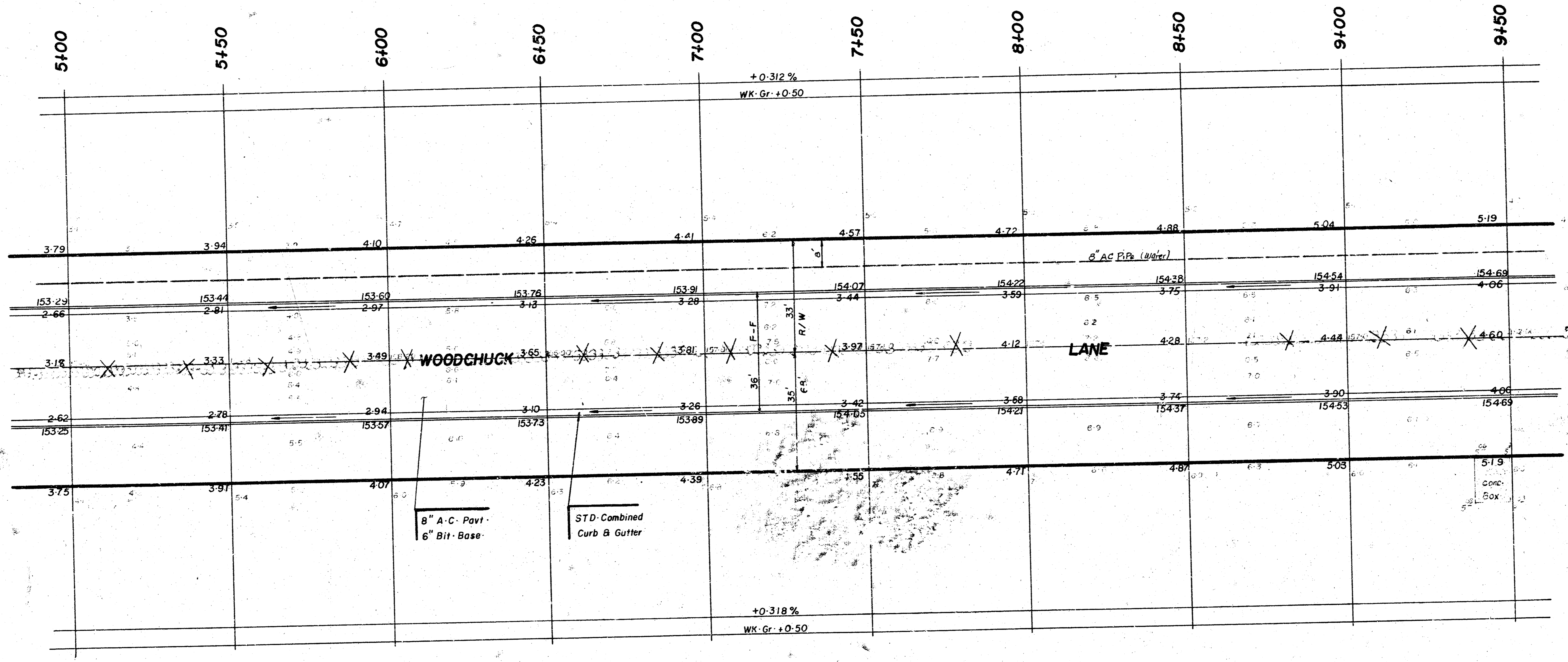

WOODCHUCK LANE

3/4

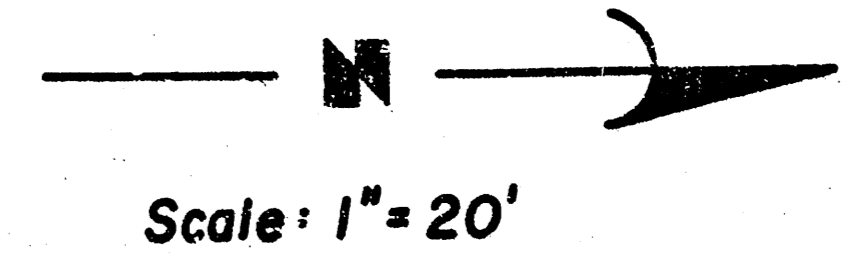
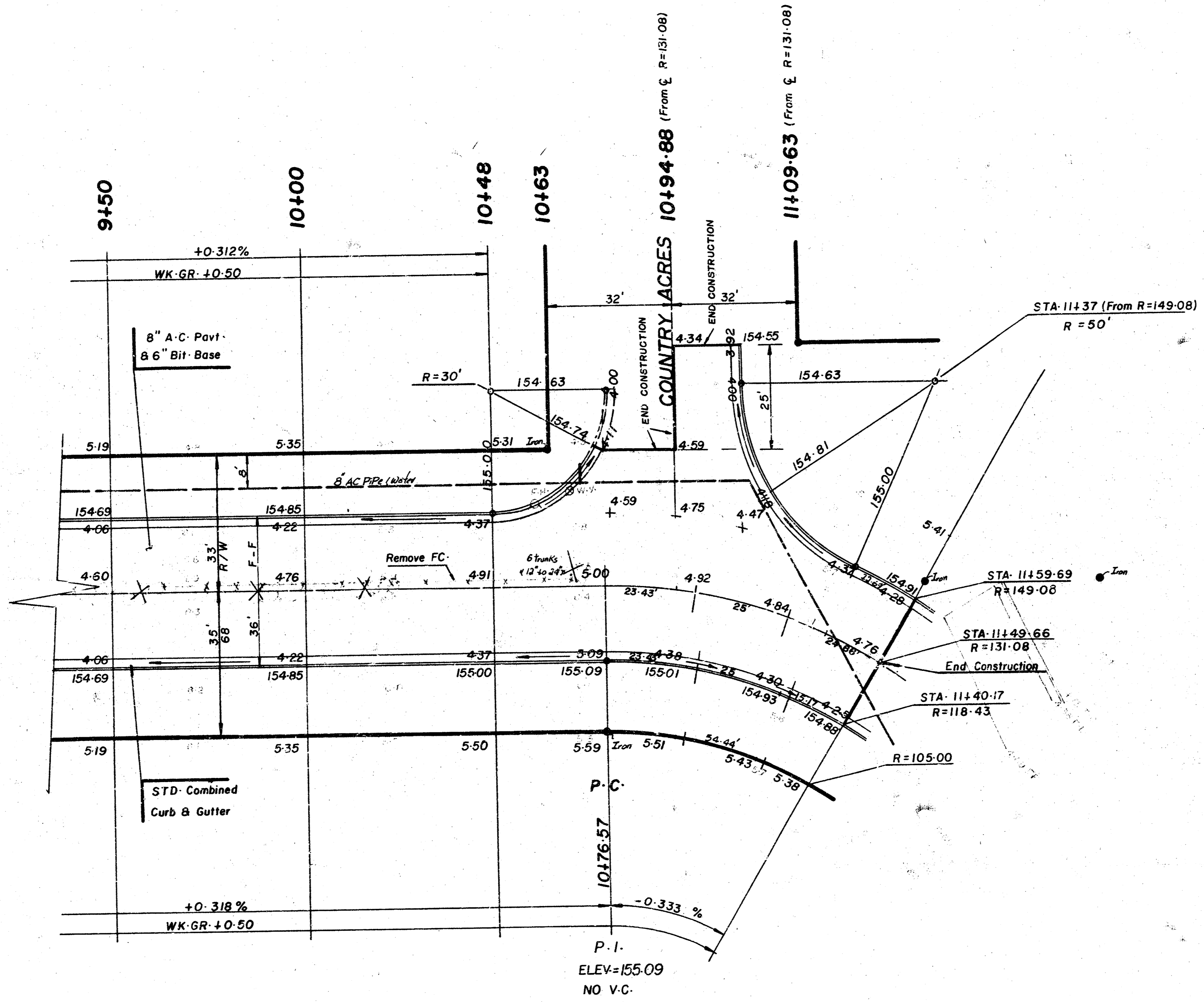

$\Delta=3^{\circ}56'50'' R=131.08' T=37.52' L=73.09' LC=72.14'$
 CURVE DATA BASED ON Δ_2 RAD. $\Delta_2=15^{\circ}58'25''$
 $R=50'$

$\Delta=30^{\circ}46'06'' R=118.43' T=32.58' L=63.60' LC=62.84'$
 CURVE DATA BASED ON RT-CB. RAD. $\Delta_2=15^{\circ}23'03''$

STA.	ARC	CHORD LENGTH	DEFLECTION	TOTAL DEFLECTION
10+76.57	---	---	---	0' 00' 00"
11+00	23-43	21.81	5° 40' 03"	5° 40' 03"
11+25	25-00	23.27	6° 02' 50"	11° 42' 53"
11+40-17	15-17	14.13	3° 40' 10"	15° 23' 03"

Defl./11=14-51383 Min.

$\Delta=3^{\circ}56'50'' R=149.08' T=42.47' L=83.12' LC=82.05'$
 CURVE DATA BASED ON LT-CB. RAD. $\Delta_2=15^{\circ}58'25''$

STA.	ARC	CHORD LENGTH	DEFLECTION	TOTAL DEFLECTION
10+76.57	---	---	---	0' 00' 00"
11+00	23-43	24.66	4° 30' 10"	4° 30' 10"
11+25	25-00	26.31	4° 48' 16"	9° 18' 26"
11+37	12-00	12.64	2° 18' 22"	11° 36' 48"
11+50	13-00	13.69	2° 29' 54"	14° 06' 42"
11+59.69	9-69	10.21	1° 51' 43"	15° 58' 25"

Defl./11=11-52987 Min.

WOODCHUCK LANE

4/4