

WOODLAWN BOULEVARD
SL 10TH STR. — SL 13TH STR.
PROJECT C18-122

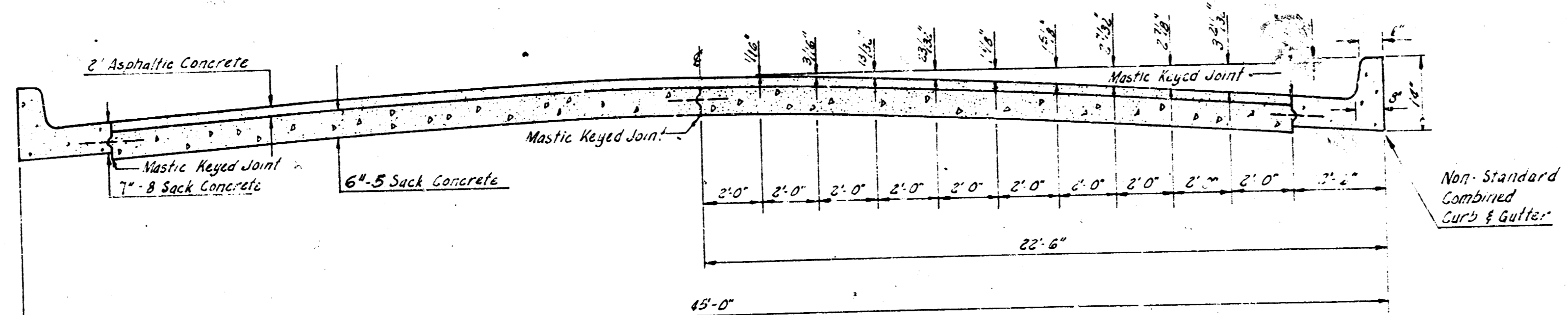

TYPICAL SECTION
 NOT TO SCALE

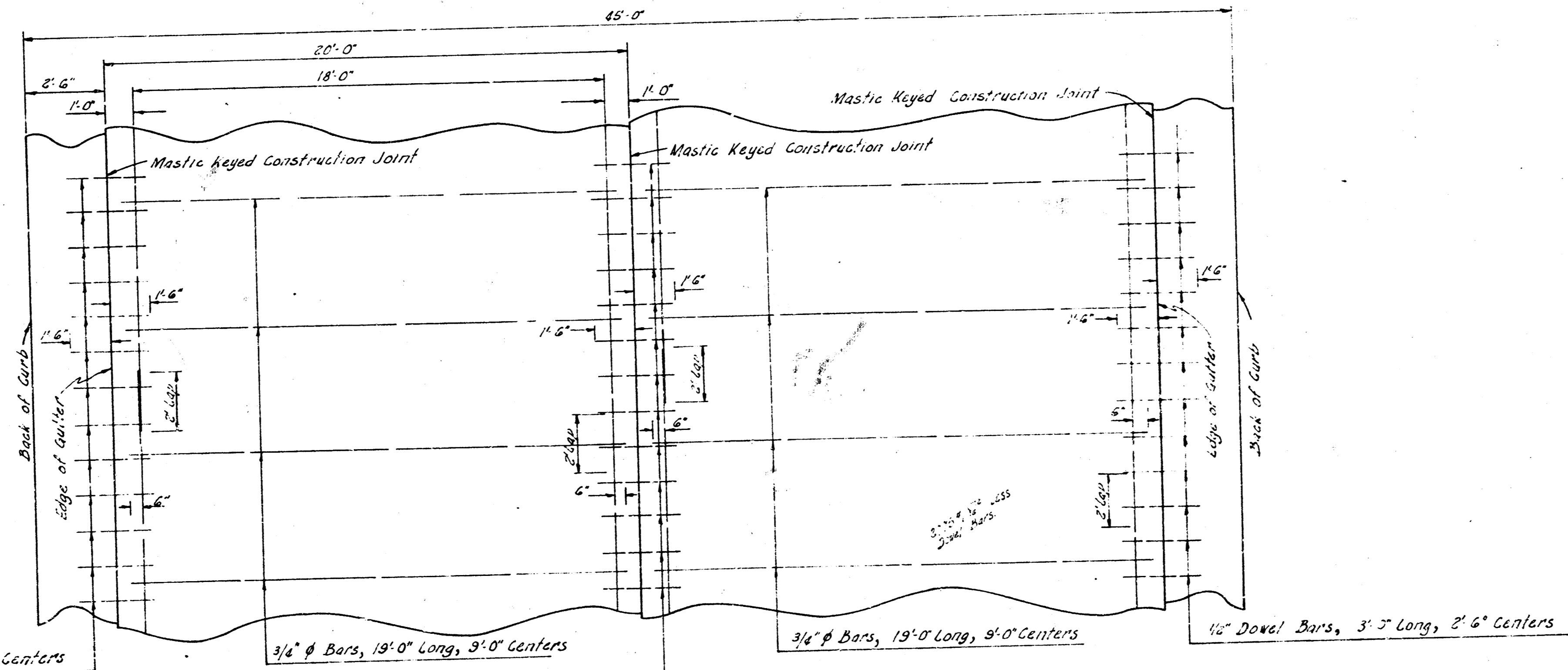

STEEL PATTERN
 NOT TO SCALE

USE 3/4" Ø BARS EXCEPT WHERE NOTED

1.0000
 5.0000
 5.0000

1/5

B.M. 198.20 R IN RITCHIE CTR. N. RAD. OF ALLEY WEST SIDE WOODLAWN 186' N. OF 13TH STR.
 B.M. 198.20 R IN RITCHIE W.C.B. WOODLAWN SL 10TH
 B.M. 197.79 R IN RITCHIE W.C.B. WOODLAWN N.L. PATRICIA
 T.P. 201.25 T IN TROY P.P. S.W. COR. TWELFTH & WOODLAWN

Scale - 1" = 20' N

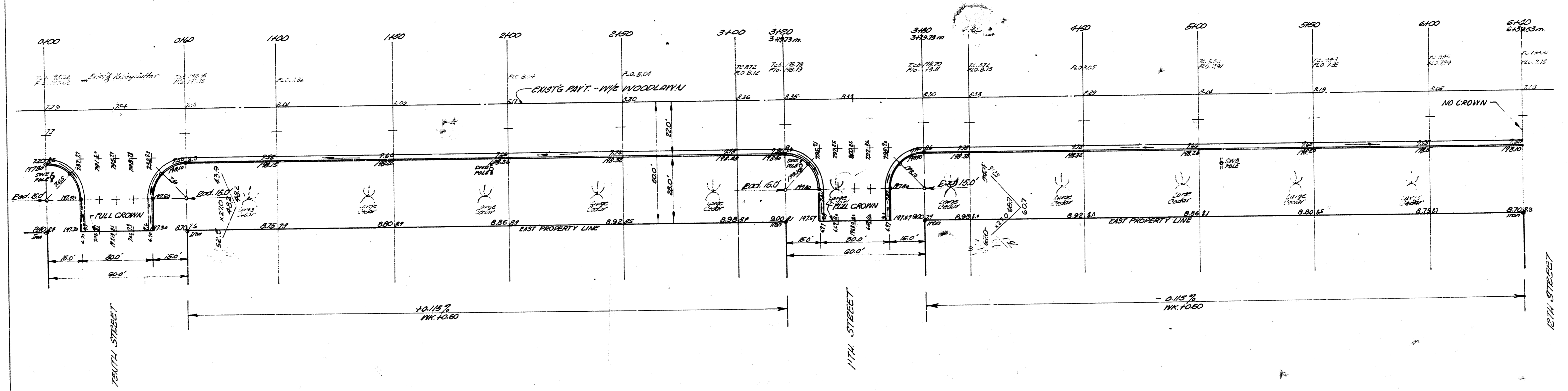

WOODLAWN BOULEVARD
 13-15 ASPH. CONC.
 WIDEN TO 22.0'

2/5

FILL		EXCAVATION		CITY	
PROP.	ACT.	PROP.	ACT.	PROP.	ACT.
83	23	408.2	482	325	325
107.2	29	5370	5635	3503	3503



WOODLAWN BOULEVARD
 SL. 10TH STREET - SL. 13TH STREET
 13-2-15 ASPH. CONC.
 WIDEN TO 22.0'
 CITY OF WICHITA, KANSAS
 B.E. SMITH CITY ENGINEER
 DATE: SEPT. 1958, PROJ. NO. C18-122

