

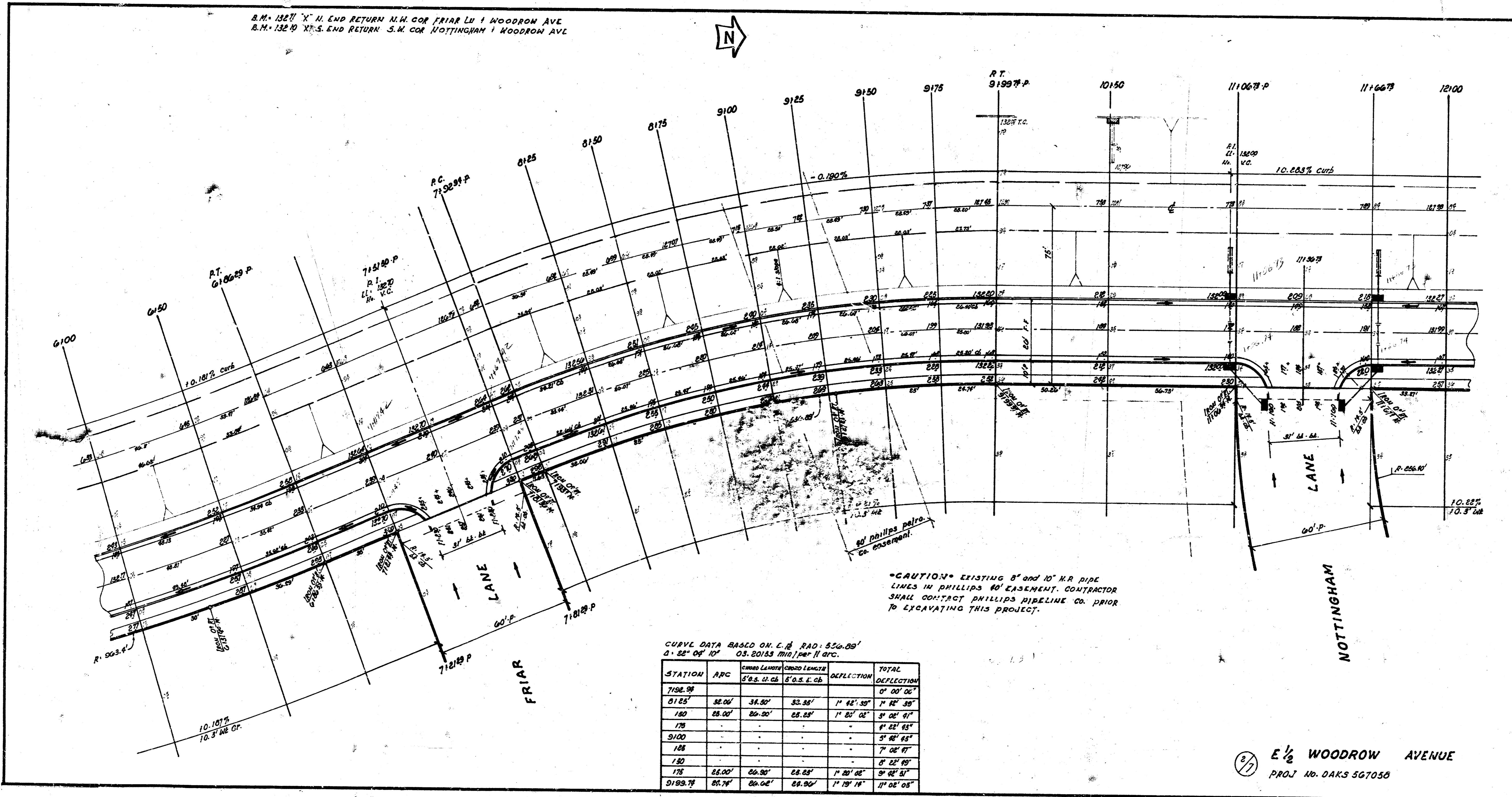

B.M. 1327' X 11' END RETURN N.W. COR FRIAR LN + WOODROW AVE  
 B.M. 13210 X 11' S. END RETURN S.W. COR NOTTINGHAM + WOODROW AVE



CURVE DATA BASED ON C.C. RAD: 320.00'  
 3.22° OF 10' @ 50.00 MPH PER 11 ARC.

STATION	ARC	CHORD LENGTH		DEFLECTION	TOTAL DEFLECTION
		S.O.S. O.C.	S.O.S. E.C.		
7+00.00					0° 00' 00"
0+125	28.00'	38.80'	33.36'	1° 42' 39"	1° 42' 39"
1+00	28.00'	38.80'	33.36'	1° 42' 39"	3° 25' 18"
1+75					4° 47' 57"
2+00					6° 30' 36"
2+25					8° 13' 15"
2+50					9° 55' 54"
2+75					11° 38' 33"
3+00					13° 21' 12"
3+25					15° 03' 51"
3+50					16° 46' 30"
3+75					18° 29' 09"
4+00					20° 11' 48"
4+25					21° 54' 27"
4+50					23° 37' 06"
4+75					25° 19' 45"
5+00					27° 02' 24"
5+25					28° 45' 03"
5+50					30° 27' 42"
5+75					32° 10' 21"
6+00					33° 53' 00"
6+25					35° 35' 39"
6+50					37° 18' 18"
6+75					39° 00' 57"
7+00					40° 43' 36"
7+25					42° 26' 15"
7+50					44° 08' 54"
7+75					45° 51' 33"
8+00					47° 34' 12"
8+25					49° 16' 51"
8+50					50° 59' 30"
8+75					52° 42' 09"
9+00					54° 24' 48"
9+25					56° 07' 27"
9+50					57° 50' 06"
9+75					59° 32' 45"
10+00					61° 15' 24"
10+25					62° 58' 03"
10+50					64° 40' 42"
10+75					66° 23' 21"
11+00					68° 06' 00"
11+25					69° 48' 39"
11+50					71° 31' 18"
11+75					73° 13' 57"
12+00					74° 56' 36"

② E 1/2 WOODROW AVENUE  
 PROJ. NO. DAKS 567056

R.M. 1327' X ON W. CURB - So. RT. - W. 1/2 WOODROW ST. 16.

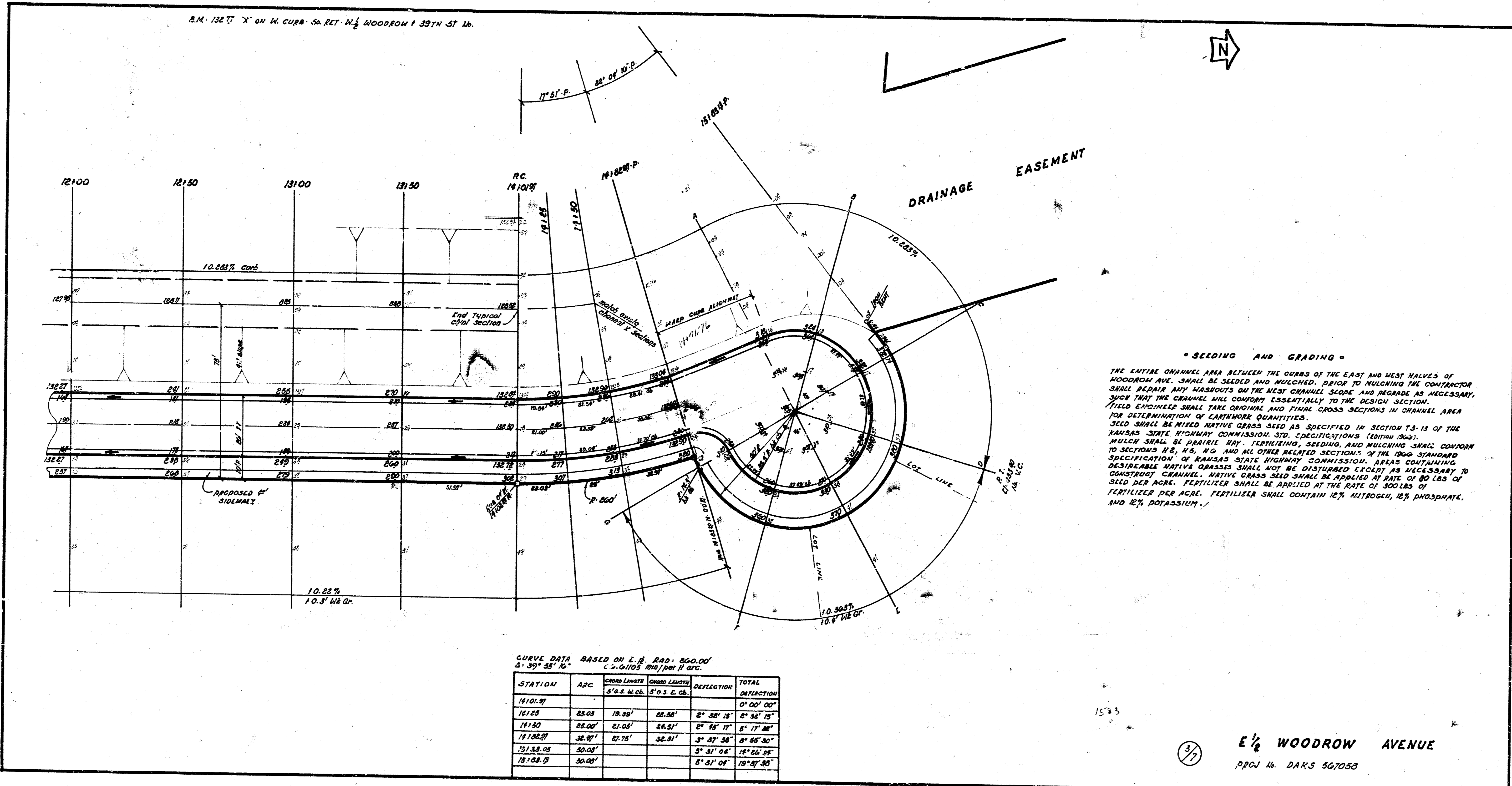

**SEEDING AND GRADING**

THE ENTIRE CHANNEL AREA BETWEEN THE CURBS OF THE EAST AND WEST HALVES OF WOODROW AVE. SHALL BE SEEDED AND MULCHED. PRIOR TO MULCHING THE CONTRACTOR SHALL REPAIR ANY HARBORS ON THE WEST CHANNEL SLOPE AND REGRADE AS NECESSARY, SUCH THAT THE CHANNEL WILL CONFORM ESSENTIALLY TO THE DESIGN SECTION. FIELD ENGINEER SHALL TAKE ORIGINAL AND FINISH CROSS SECTIONS IN CHANNEL AREA FOR DETERMINATION OF EARTHWORK QUANTITIES. SEED SHALL BE MIXED NATIVE GRASS SEED AS SPECIFIED IN SECTION T3-13 OF THE KANSAS STATE HIGHWAY COMMISSION STD. SPECIFICATIONS (EDITION 1962). MULCH SHALL BE PINE BARK, FERTILIZING, SEEDING, AND MULCHING SHALL CONFORM TO SECTIONS H2, H3, H4, H5, H6 AND ALL OTHER RELATED SECTIONS OF THE 1962 STANDARD SPECIFICATION OF KANSAS STATE HIGHWAY COMMISSION. AREAS CONTAINING DESIRABLE NATIVE GRASSES SHALL NOT BE DISTURBED EXCEPT AS NECESSARY TO CONSTRUCT CHANNEL. NATIVE GRASS SEED SHALL BE APPLIED AT RATE OF 80 LBS OF SEED PER ACRE. FERTILIZER SHALL BE APPLIED AT THE RATE OF 300 LBS OF FERTILIZER PER ACRE. FERTILIZER SHALL CONTAIN 12% NITROGEN, 12% PHOSPHATE, AND 12% POTASSIUM.

CURVE DATA BASED ON C. R. RAD. 200.00'  
 $\Delta = 39^\circ 55' 16''$  C.S. 0.1105' MIN/PER 11' ARC.

STATION	ARC	CHORD LENGTH S.O.S. N.O.B.	CHORD LENGTH S.O.S. E.O.B.	DEFLECTION	TOTAL DEFLECTION
1610.97					0° 00' 00"
16125	23.03	19.39'	22.80'	8° 38' 18"	8° 38' 18"
16150	23.00'	21.05'	24.51'	8° 53' 17"	17° 31' 35"
16182.97	36.97'	27.75'	32.31'	3° 37' 58"	21° 09' 33"
16133.03	30.03'			5° 31' 08"	15° 38' 25"
16164.97	30.03'			5° 31' 08"	19° 09' 33"

1583

3/7

**E 1/2 WOODROW AVENUE**  
 PROJ. No. DAKS 567058

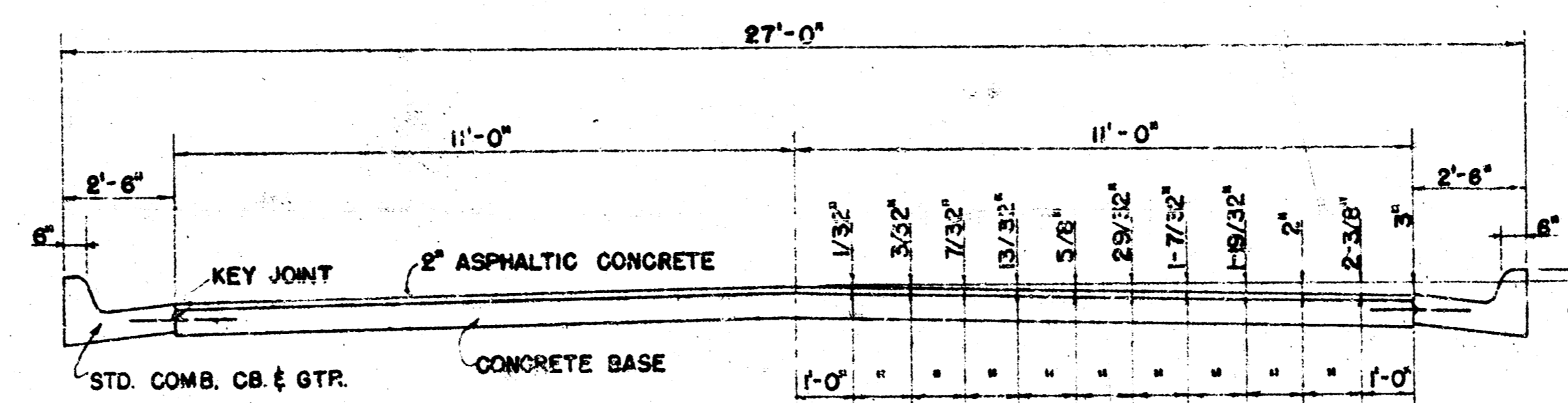

TYPICAL SECTION

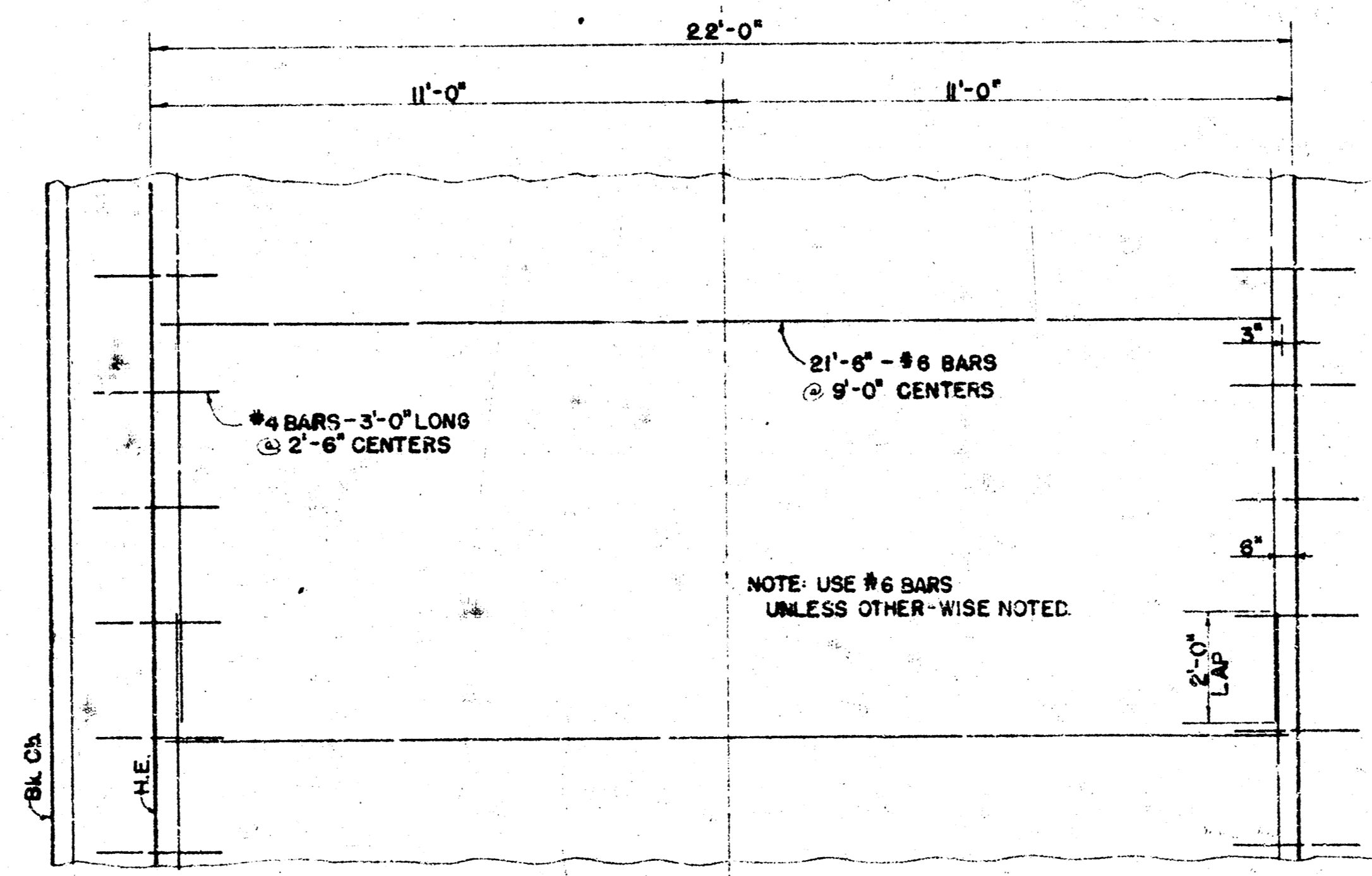

STEEL PATTERN

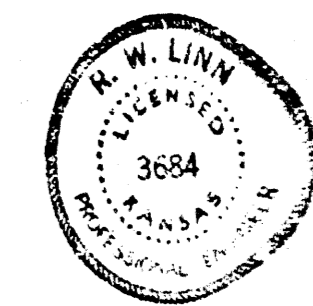

CITY OF WICHITA, KANSAS  
 Department of Public Works - Engineering Division  
 R. W. LINN City Engineer  
 Date: Project No.

J 11 5 513

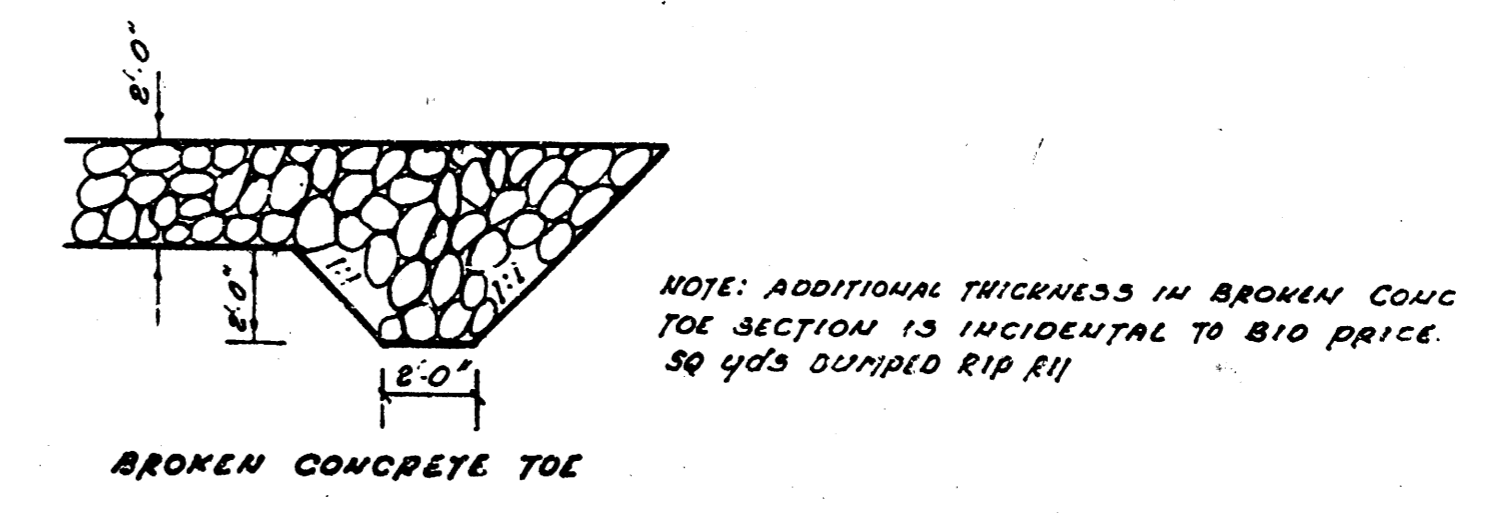
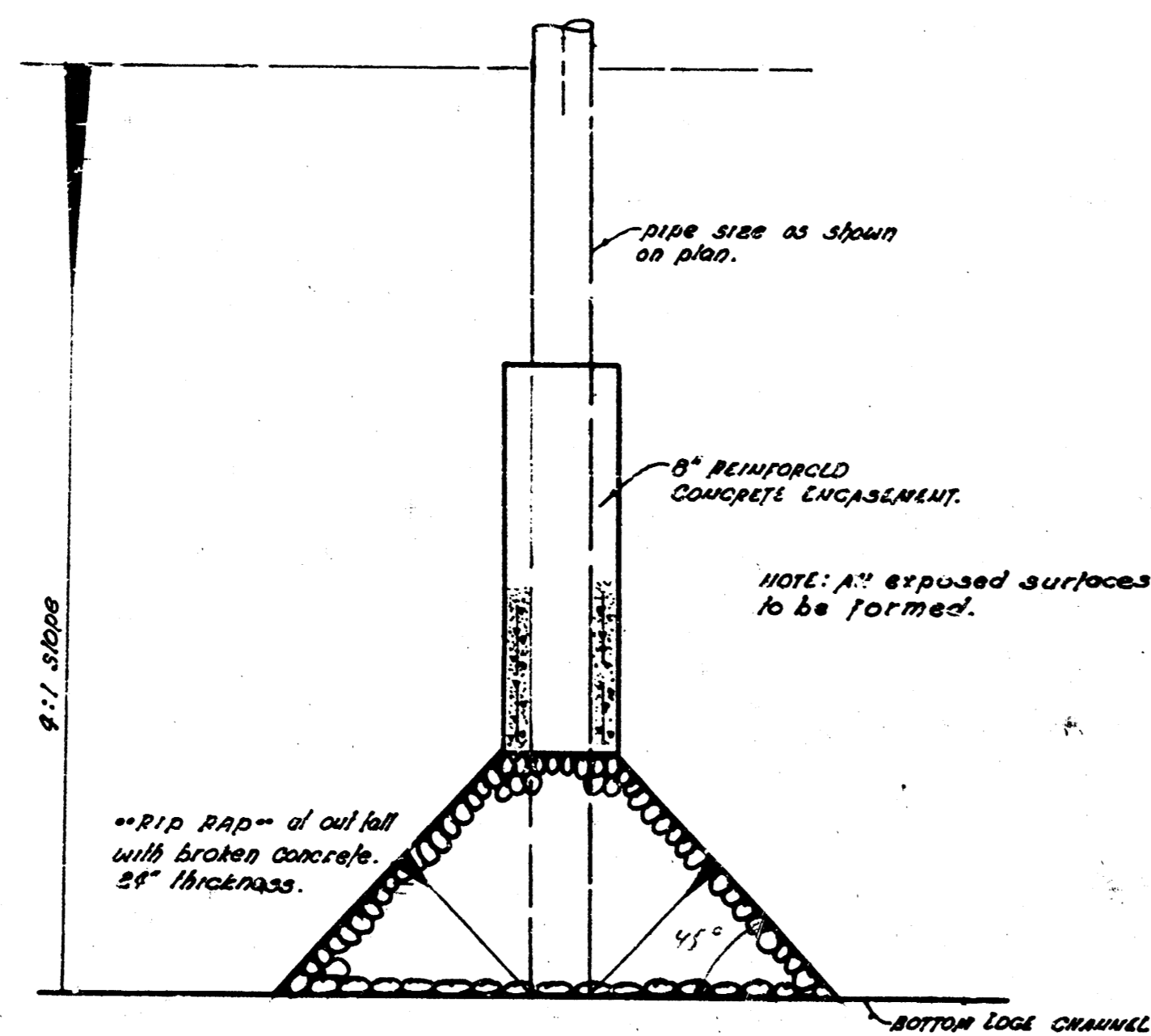
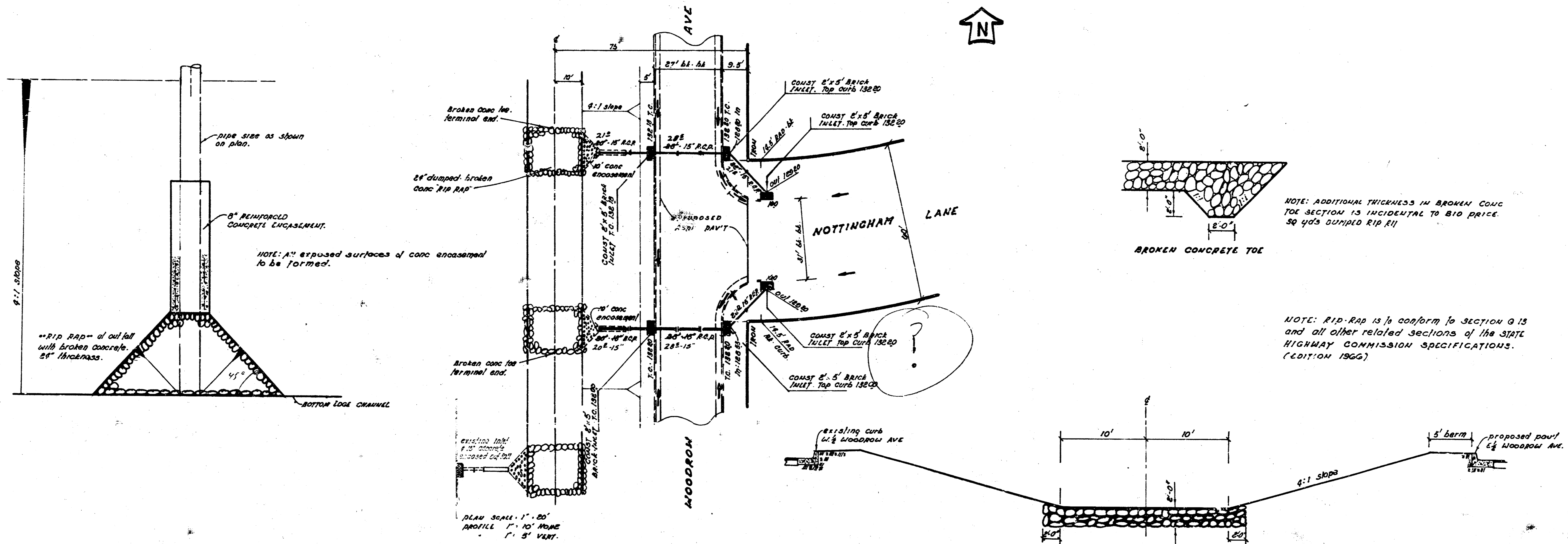

NOTE: RIP-RAP IS TO CONFORM TO SECTION 915 AND ALL OTHER RELATED SECTIONS OF THE STATE HIGHWAY COMMISSION SPECIFICATIONS. (EDITION 1966)

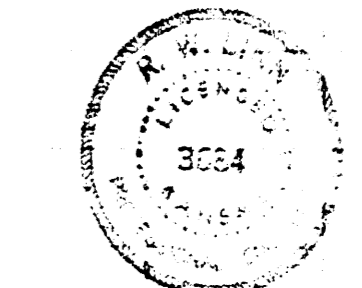
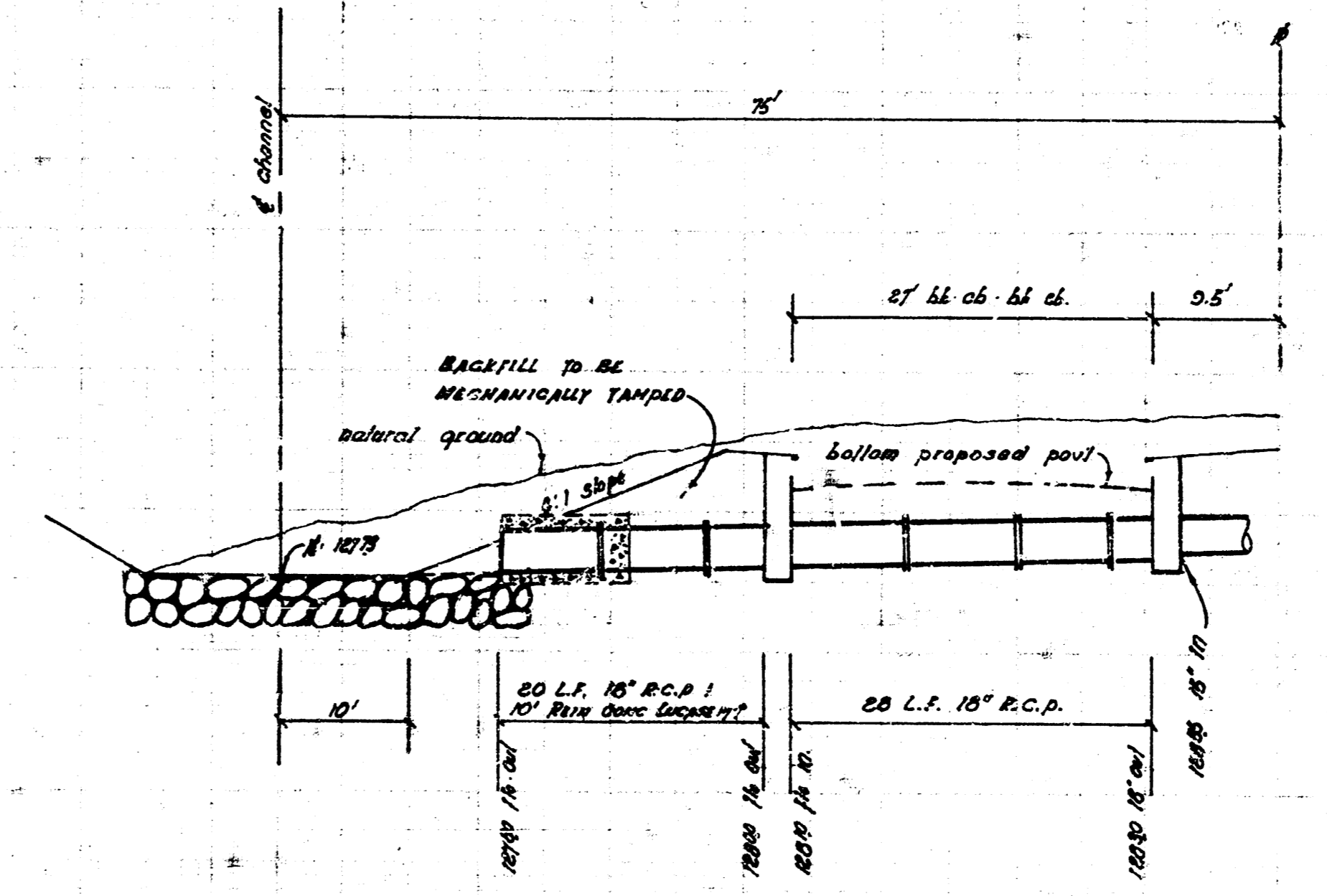
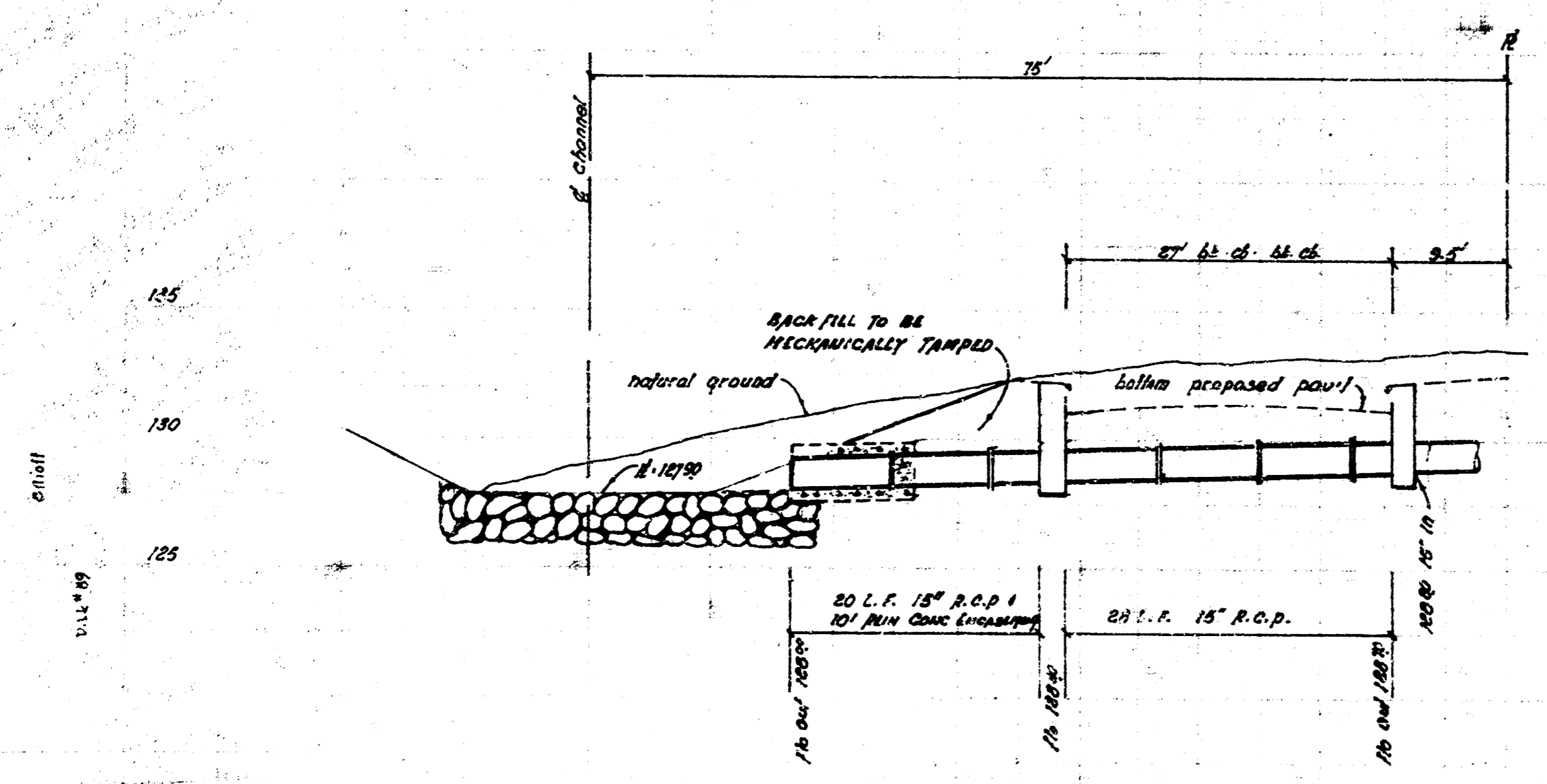

As Built Final Mes. H-100  
 INCIDENTAL DRAINAGE IN CONNECTION WITH PAVING THE E. 1/2 WOODROW AVENUE, N.E. 37TH ST TO 1/4 INCL COR-DE-SAC IN BLK 1, SHERWOOD GLEN 2ND ADDN.  
 CITY OF MICHITA, KANSAS  
 R. W. LINN CITY ENGINEER  
 DATE: JULY 1972, PROJ. N. DARK 567053