

SEDGWICK COUNTY HIGHWAY DEPARTMENT
 G.C. MCLURE, JR., P.E. COUNTY ENGINEER
TYPICAL SECTIONS
 PAVING
 SEDGWICK COUNTY PROJECT 875-SU-428(1)
 PROFESSIONAL ENGINEERING CONSULTANTS
 WORTH, TEXAS

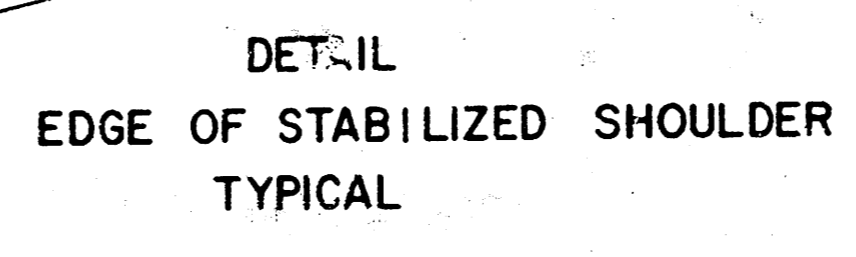

SEDGWICK COUNTY HIGHWAY DEPARTMENT
G.C. M'LEURE, JR., P.E. COUNTY ENGINEER
TYPICAL SECTIONS
SIDE ROADS - PAVING & SURFACING
SEDGWICK COUNTY PROJECT 87S-SU-428(II)
PROFESSIONAL ENGINEERING CONSULTANTS

PUB. ROAD DIV. NO.	STATE	PROJECT NO.	FISCAL YEAR	SHEET NO.	TOTAL SHEETS
5	KANSAS	875-SU-428(III)	72	21	72

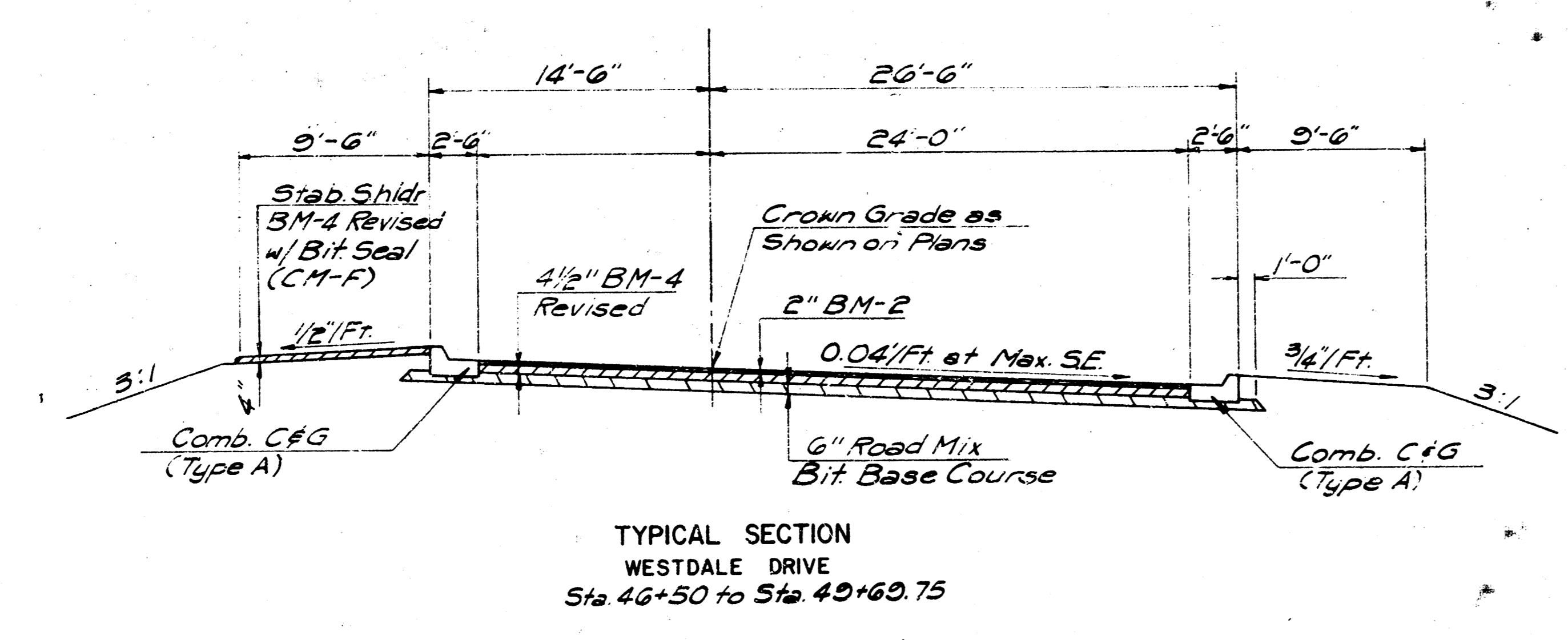
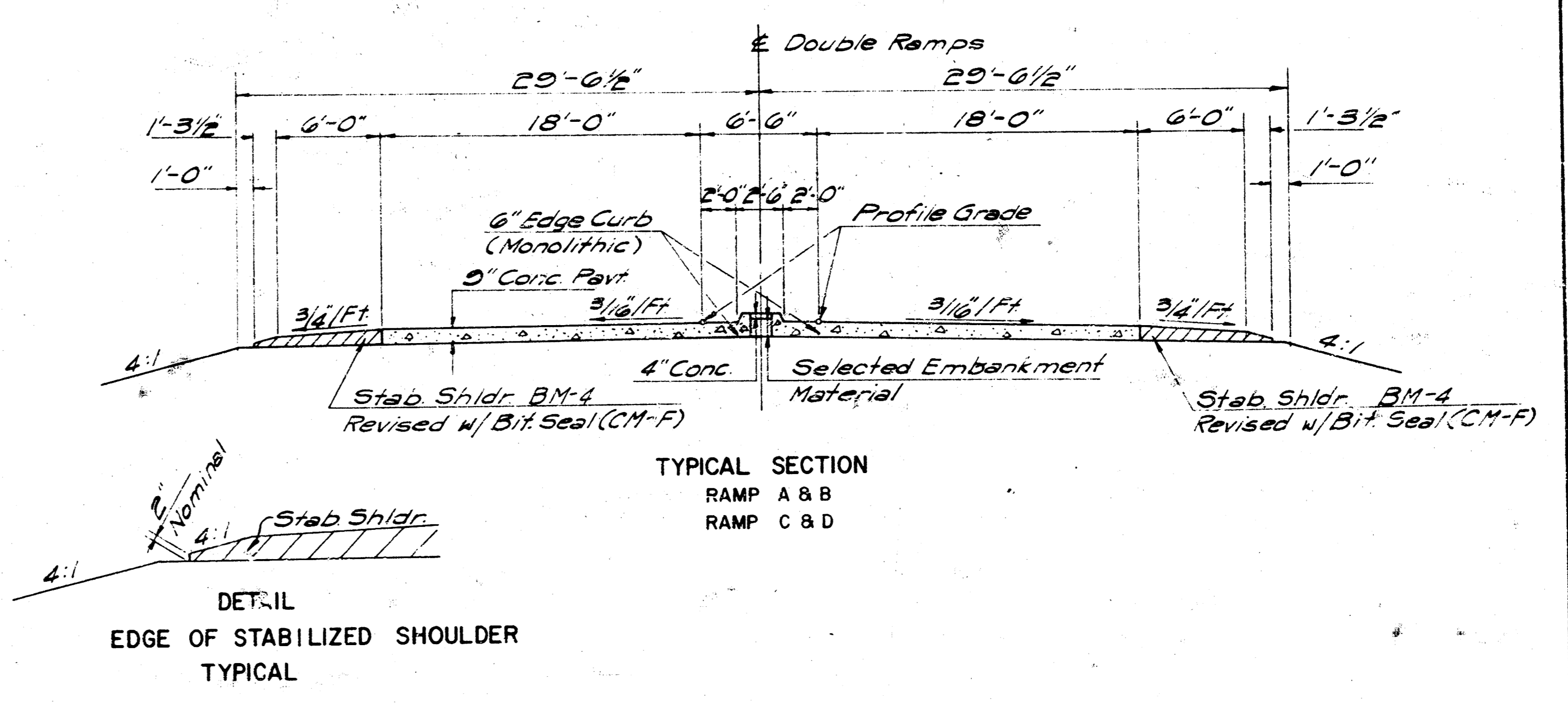
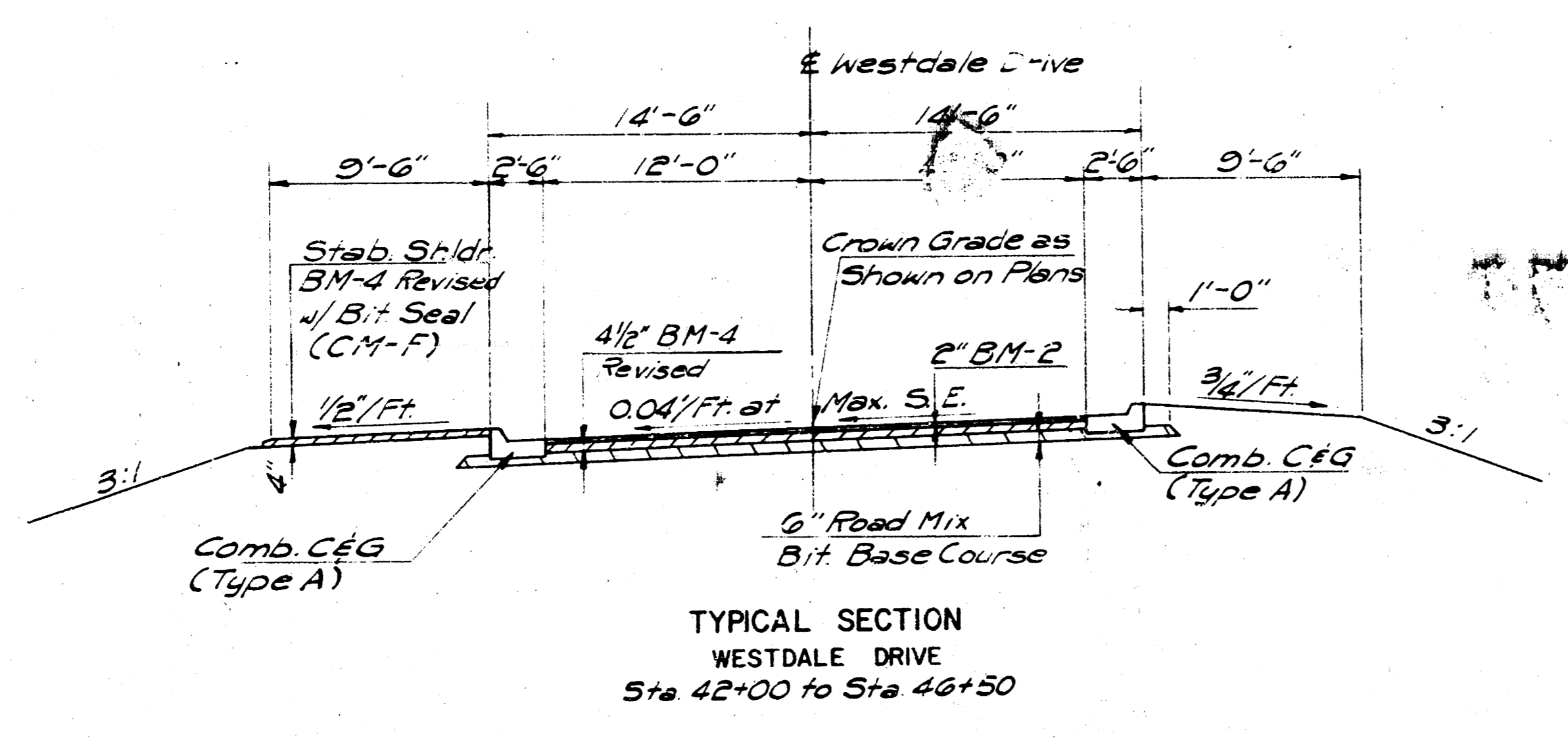
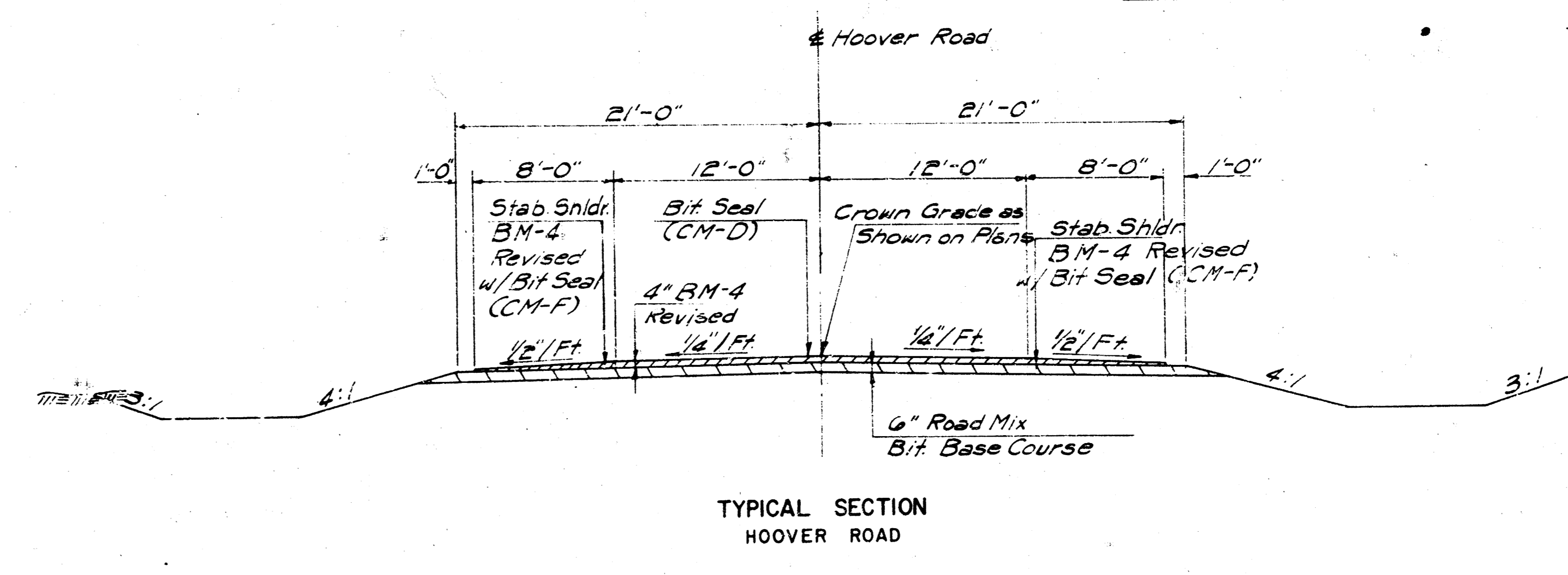
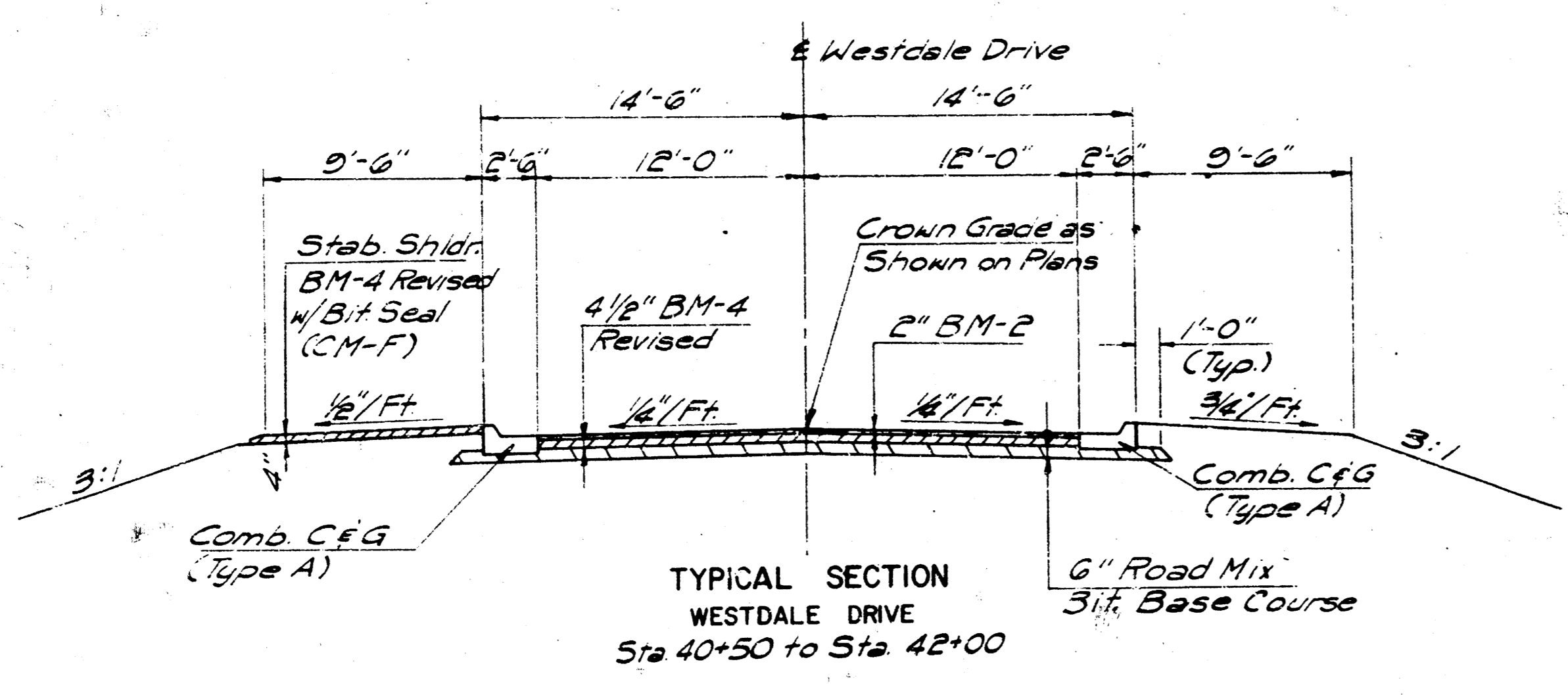
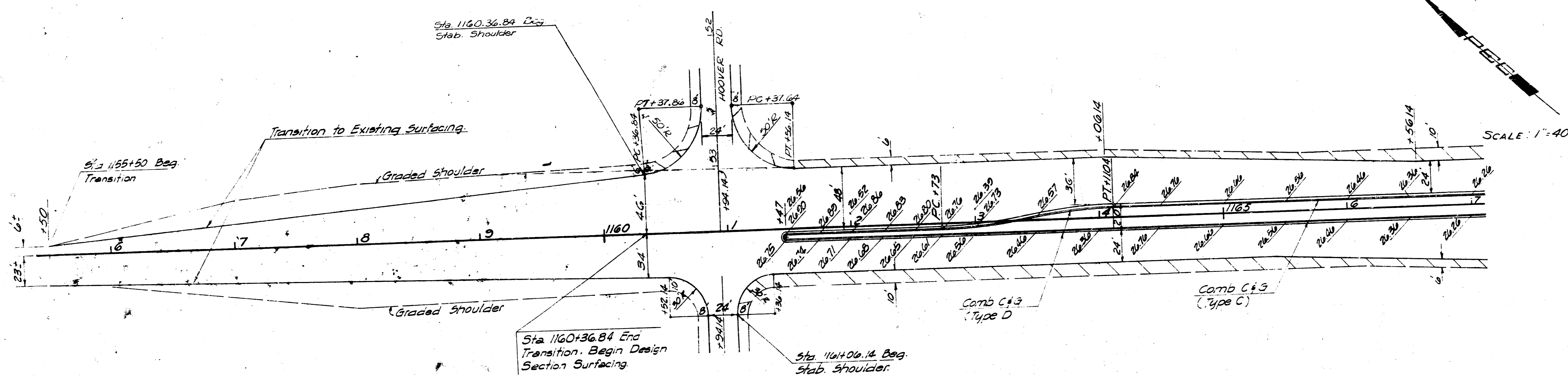

Note: Entrances are to be surfaced as shown on the plans with 6" B.M.-4 Revised and 2" B.-1-2. The subgrade is to be stabilized through the entrances on the shoulder line with 6" Road Mix Bituminous Base Course.

See Sheet No. 28 for Typical Median Details

B.M. #34 Chris "D" on Sewer @ Southern most cor. of Blg. 173 Rt. @ Sta. 1162+80 El. 1325.70.

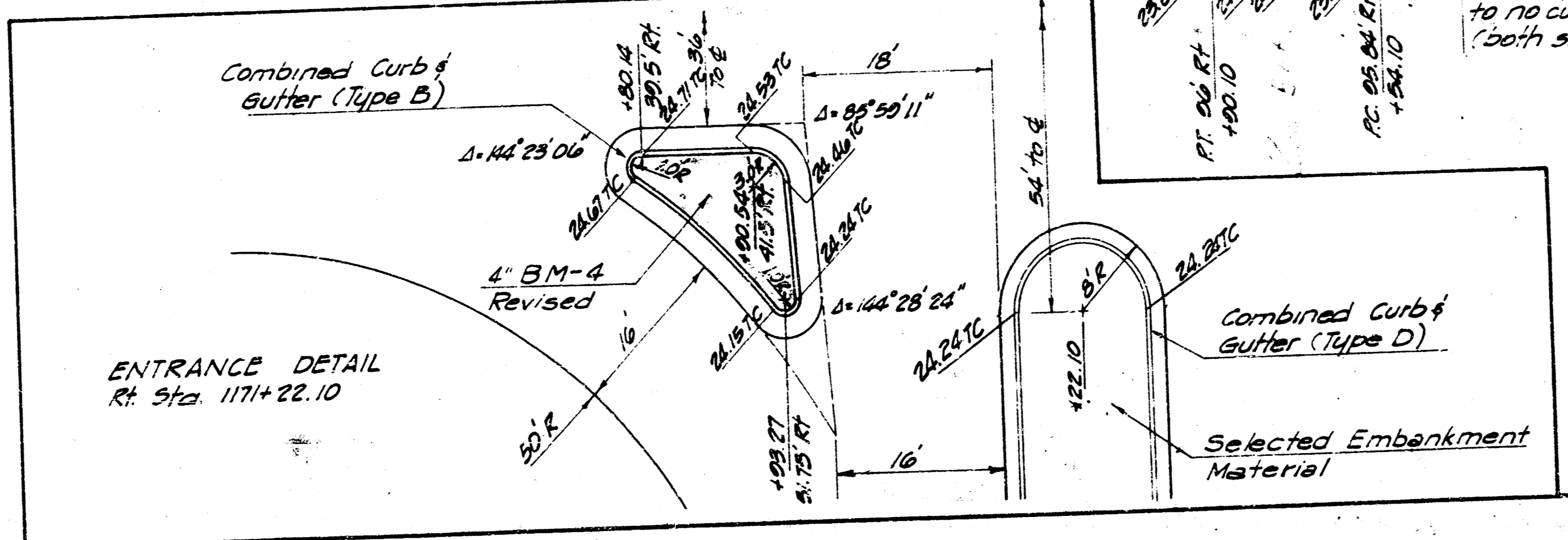
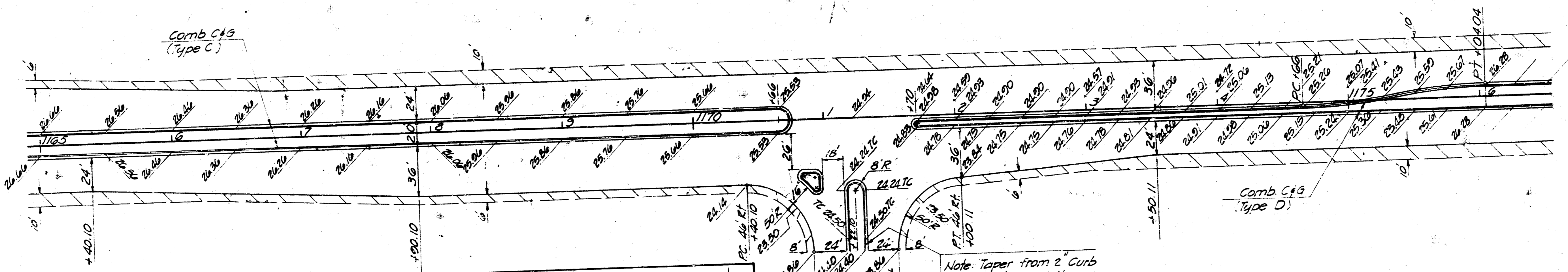

Note: Taper from 2' Curb to no curb in 10 ft. (both sides)

SEDGWICK COUNTY HIGHWAY DEPARTMENT
 G. C. MCLURE, JR., P.E. COUNTY ENGINEER
SURFACING PLAN
 Sta. 1155+50 to Sta. 1176+04.04
 SEDGWICK COUNTY PROJECT 875-SU-428(III)
 PROFESSIONAL ENGINEERING CONSULTANTS
 ENGINEERS
 WICHITA, KANSAS

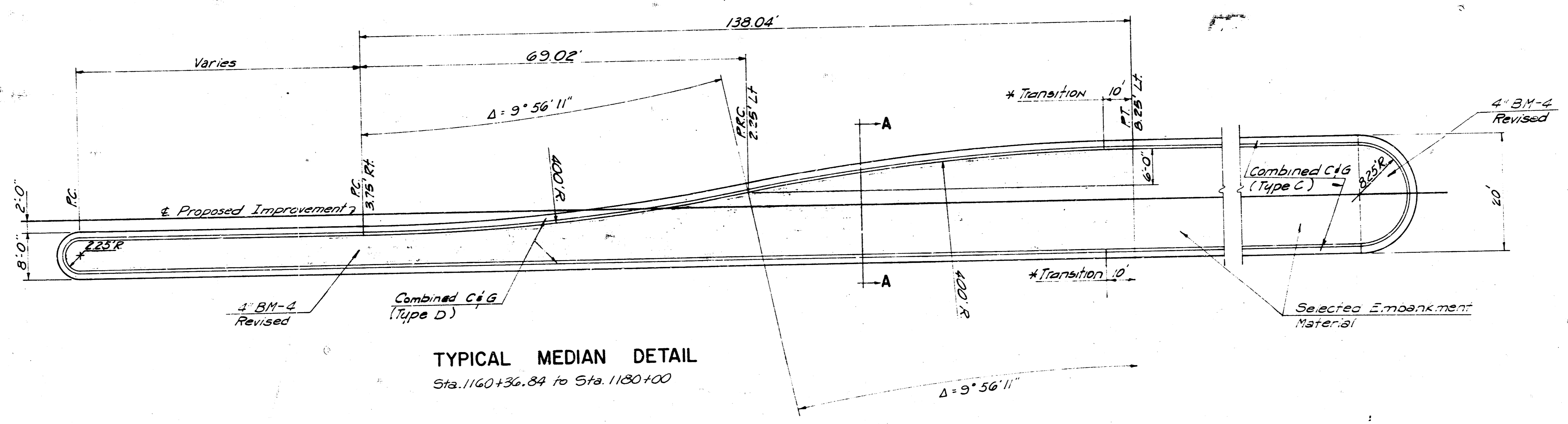

TYPICAL MEDIAN DETAIL
 Sta. 1160+36.84 to Sta. 1180+00

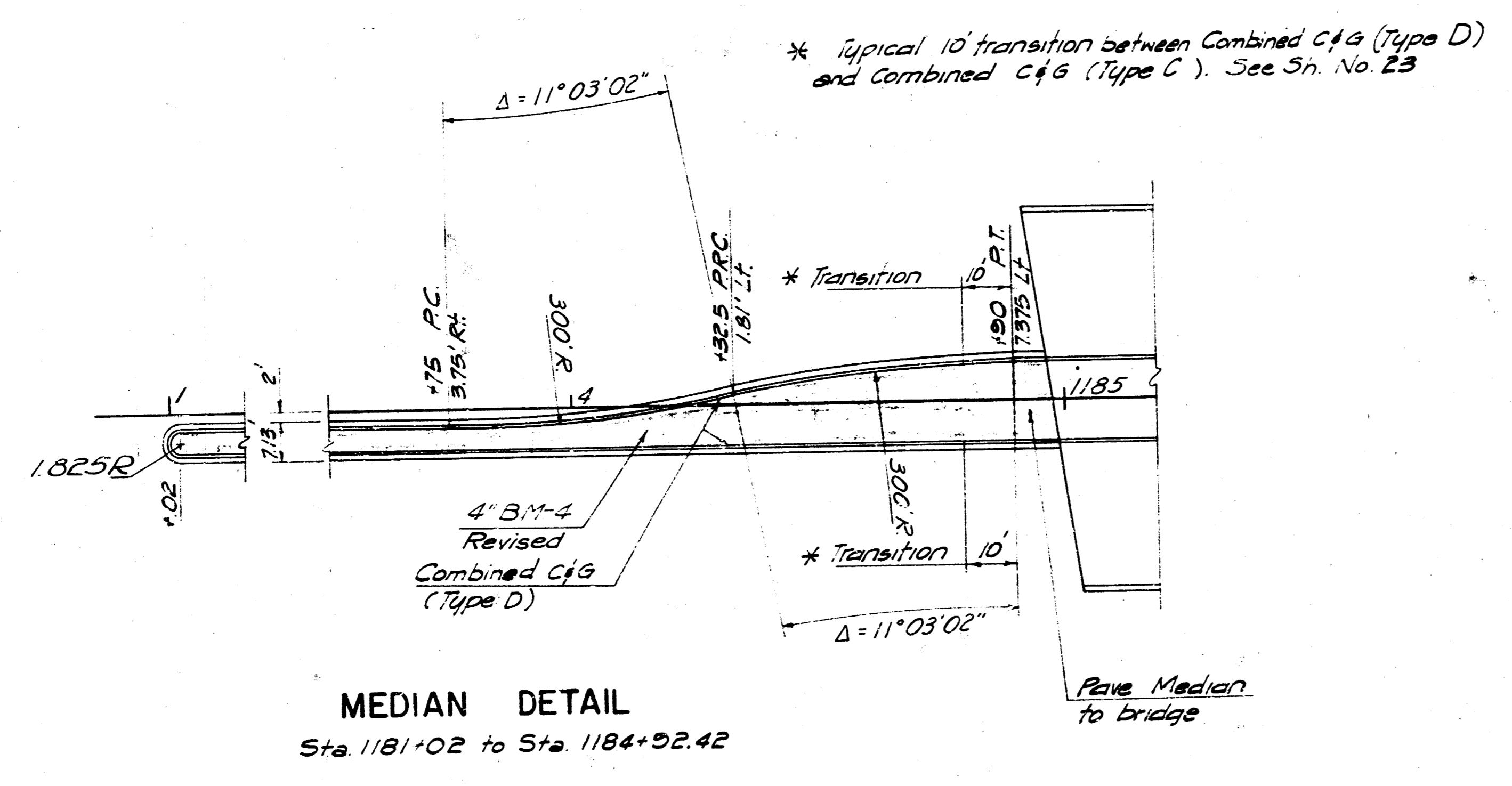

MEDIAN DETAIL
 Sta. 1181+02 to Sta. 1184+92.42

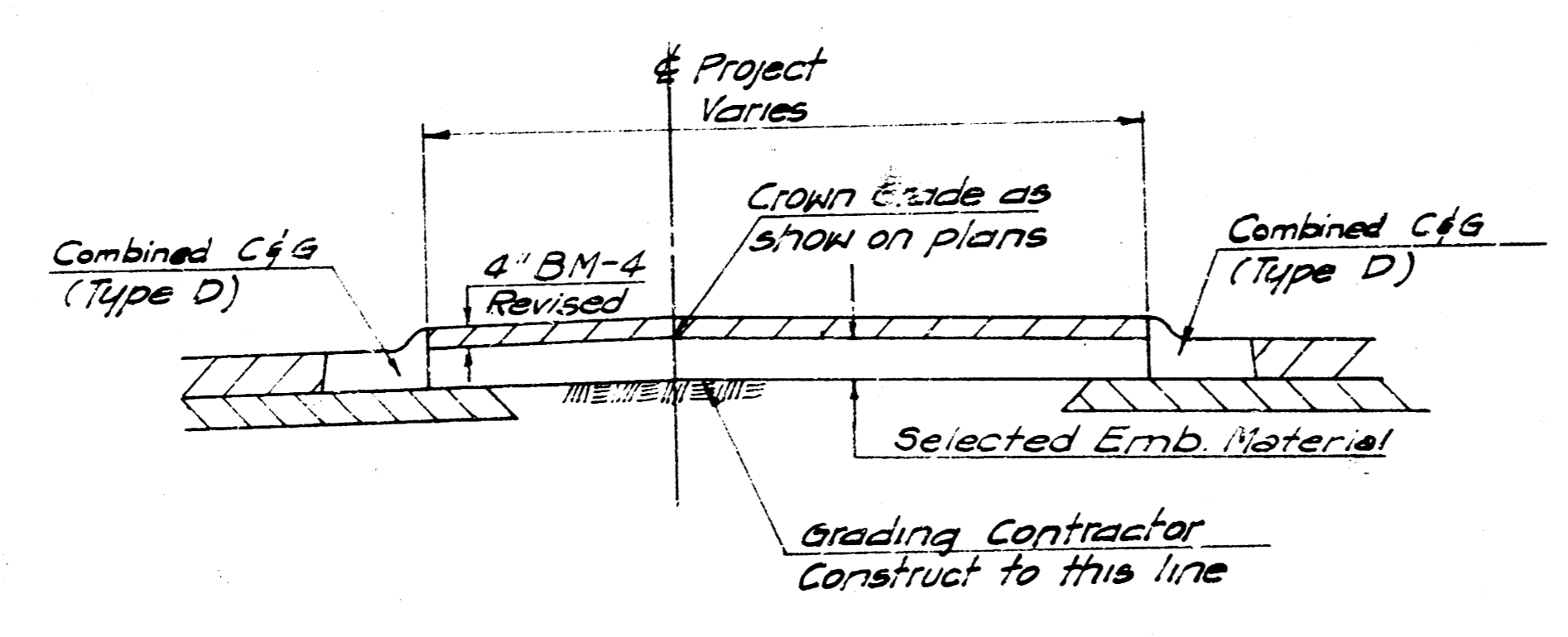

SECTION A-A

SEDGWICK COUNTY HIGHWAY DEPARTMENT
 G.C. MCLURE, JR., P.E. COUNTY ENGINEER
MEDIAN DETAILS
 Sta. 1160+36.84 to Sta. 1184+92.42
 SEDGWICK COUNTY PROJECT 875-SU-428(1)
 PROFESSIONAL ENGINEERING CONSULTANTS
 W.C. & A. KRISKE
 Drawn by: E.S. L.F. Created by: K.E.
 Date: Mar. 72 Job No.: 71027

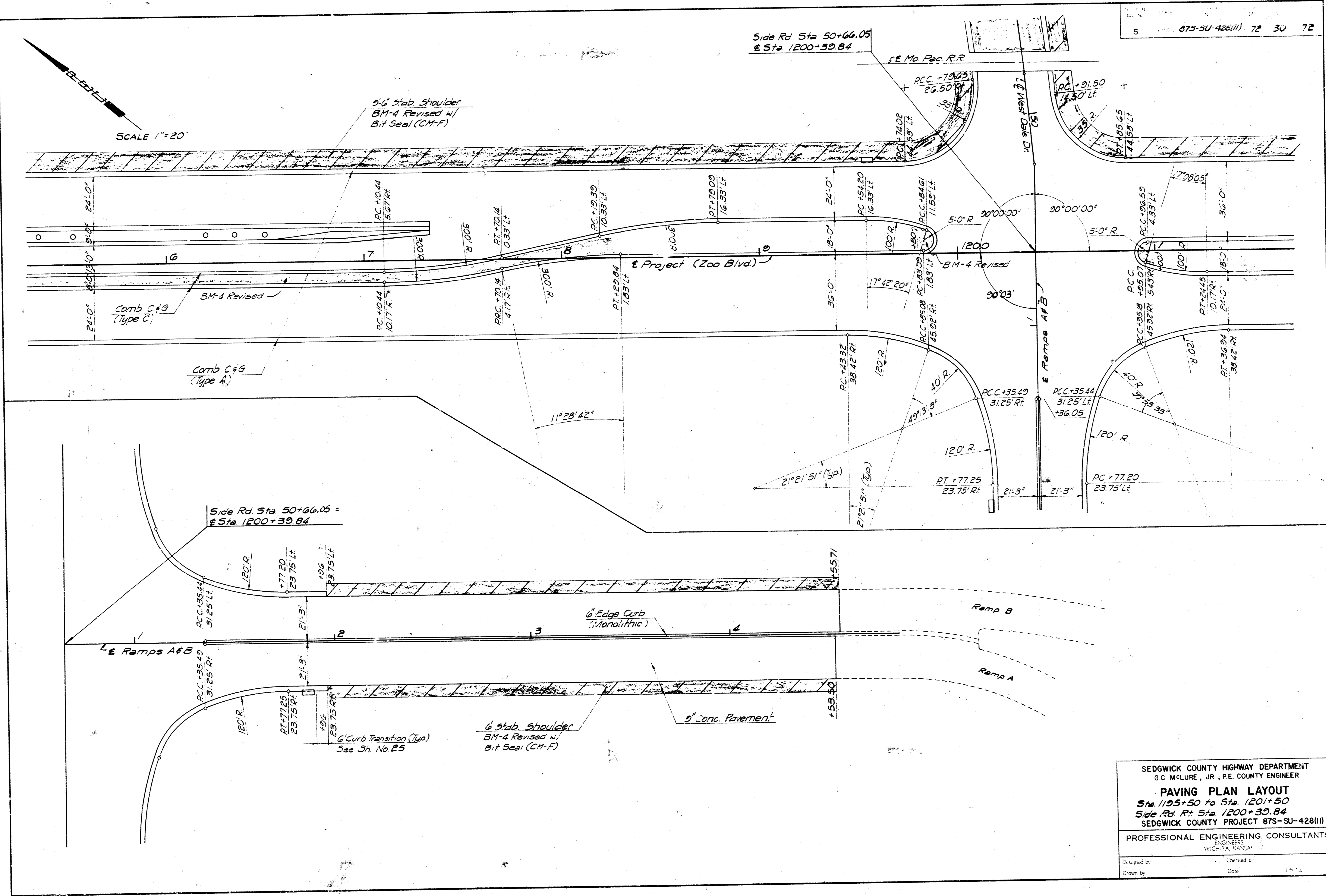

SEDGWICK COUNTY HIGHWAY DEPARTMENT
 G.C. MCLURE, JR., P.E. COUNTY ENGINEER
PAVING PLAN LAYOUT
 Sta. 1195+50 to Sta. 1201+50
 Side Rd. R+ Sta. 1200+39.84
 SEDGWICK COUNTY PROJECT 875-SU-428(II)
 PROFESSIONAL ENGINEERING CONSULTANTS
 ENGINEERS
 WICHITA, KANSAS
 Designed by: _____ Checked by: _____
 Drawn by: _____ Date: _____

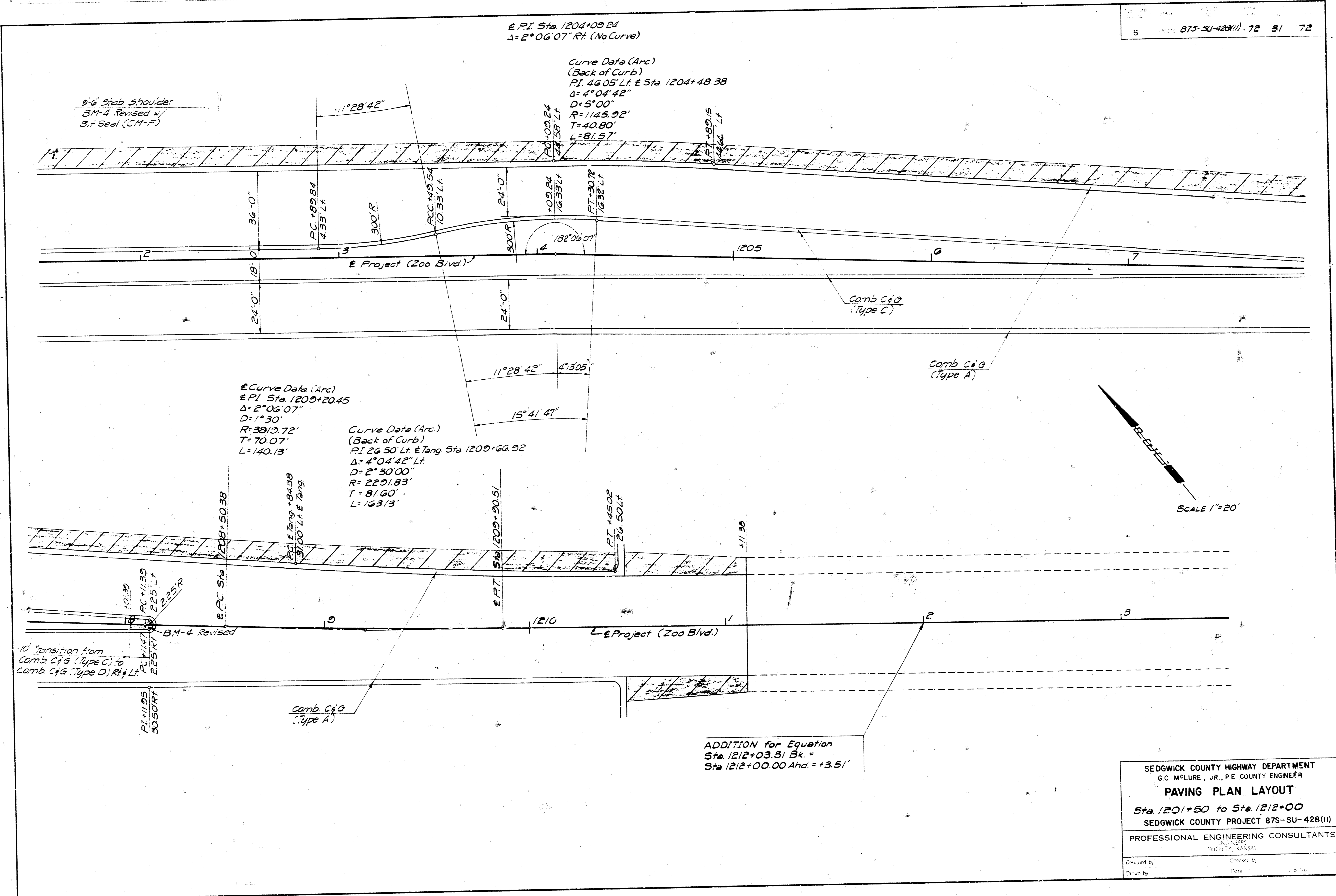

SEDGWICK COUNTY HIGHWAY DEPARTMENT
 G.C. MCLURE, JR., P.E. COUNTY ENGINEER
PAVING PLAN LAYOUT
 Sta. 1201+50 to Sta. 1212+00
 SEDGWICK COUNTY PROJECT 875-SU-428(II)
 PROFESSIONAL ENGINEERING CONSULTANTS
 WICHITA, KANSAS

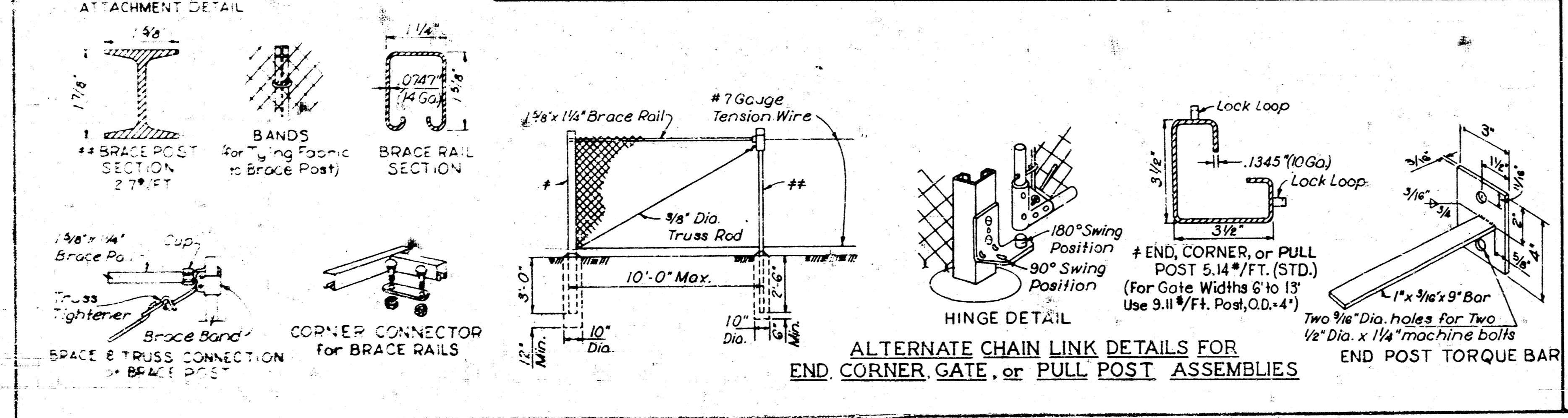
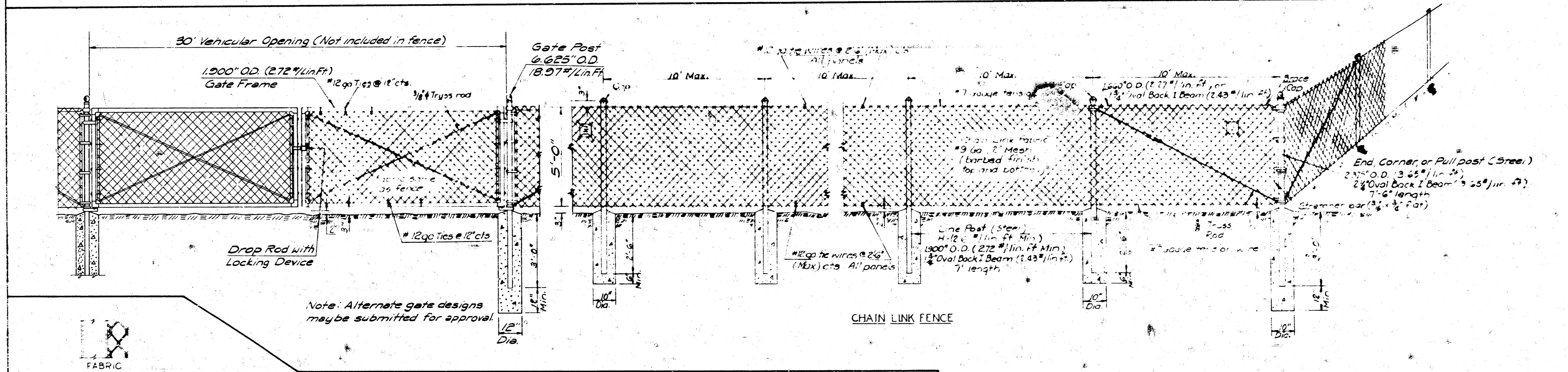
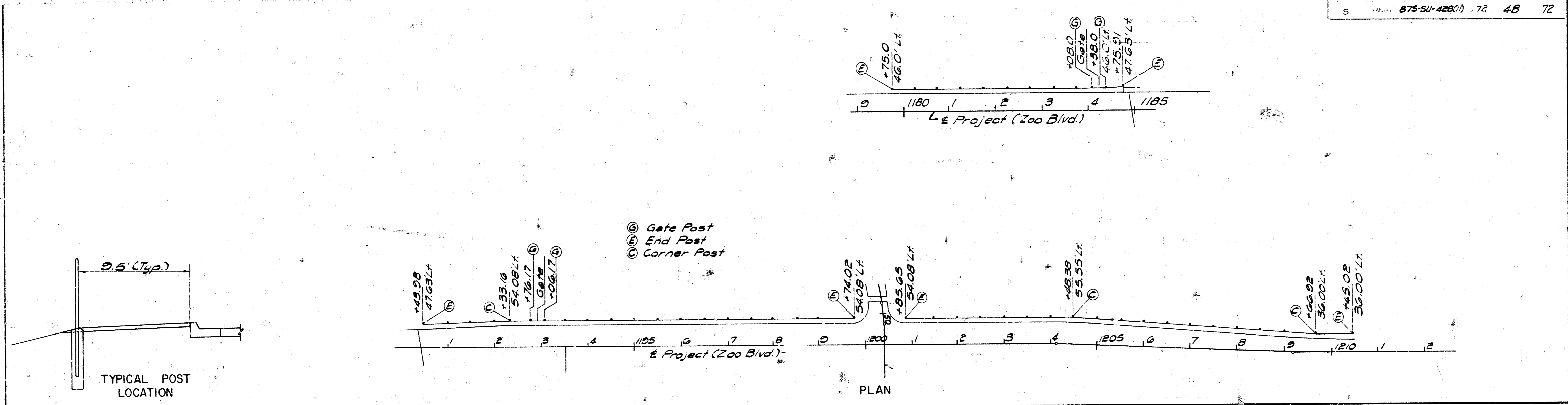

General Note
Pull Posts shall be used at sharp breaks in vertical grade or at approximately 330' centers on straight runs or as directed by the Engineer. All concrete used in fence installation shall be Class B and shall conform to the requirements of the Specifications. All steel posts, braces, and gate frames shall be galvanized. Outside diameters shown for tubular steel posts, braces, and gate frames are nominal. Weight tolerances shall be as shown in the specifications. Tension wire, and chain link fabric shall be either zinc coated (galvanized) or aluminum coated.

SEDGWICK COUNTY HIGHWAY DEPARTMENT
G.C. McFLURE, JR., PE COUNTY ENGINEER

FENCING PLAN & DETAILS
Sta 1179+75.00 to Sta 1210+45.02
SEDGWICK COUNTY PROJECT 875-SU-428(11)

PROFESSIONAL ENGINEERING CONSULTANTS
D.W. REEVE
WICHITA, KANSAS

SUMMARY OF QUANTITIES

ITEM	SURFACING MAINLINE	SURFACING SIDE ROADS	SHOULDERS MAINLINE	SHOULDERS SIDE ROADS	RIGHTS OF ISLANDS	TOTAL	UNIT
SURFACE COURSE							
AGGREGATE FOR BITUMINOUS SURFACE COURSE (SM-2)	2,043.5	342.5				2,386.0	TONS
ASPHALT CEMENT (AC-5)	156.4	21.2				177.6	TONS
EMULSIFIED ASPHALT (SS-1H) FOR TACK	7.8	1.3				9.1	TONS
BASE COURSE							
AGGREGATE FOR BITUMINOUS BASE COURSE (OM-4 REVISED)	7,143.8	1,377.7	2,604.2	812.8	377.7	12,116.2	TONS
ASPHALT CEMENT (AC-5)	402.1	77.5	146.6	34.9	21.3	682.4	TONS
EMULSIFIED ASPHALT (SS-1H) FOR TACK	24.8	4.3	7.1	1.8		38.0	TONS
WATER (NO. 10 DILUTION)						1.0	M GALS.
ROAD MIX BITUMINOUS BASE COURSE							
EMULSIFIED ASPHALT	551.1	153.7				704.8	TONS
MINERAL FILLER	787.3	219.8				1,007.1	TONS
BITUMINOUS BASE (B-1)	27,028	7,538				34,566	SQ. YDS.
BITUMINOUS SEALING							
COVER MATERIAL (CM-A)**	78.6	21.4				100.0	CU. YDS.
COVER MATERIAL (CM-D)		19.7				19.7	CU. YDS.
COVER MATERIAL (CM-E)			51.8	18.5		70.3	CU. YDS.
CUTBACK ASPHALT (RC-3000)**	10.4	2.8				13.2	TONS
CUTBACK ASPHALT (RC-3000)**		2.9	7.7	2.4		13.0	TONS
MANIPULATION (BITUMINOUS SEAL)	28.8	8.8				37.6	STA.
MANIPULATION (BITUMINOUS SEAL)		7.4				7.4	STA.
MANIPULATION (BITUMINOUS SEAL) SHOULDERS		7.4				7.4	STA.
ASPHALTIC PAVEMENT SAMPLING							
SELECTED EMBANKMENT MATERIAL (VEHICLE MEASUREMENT)	14	5				19	EACH
					2,283	2,283	CU. YDS.

RATES OF APPLICATION (SURFACING)

RATE	UNITS	ITEM	THICKNESS	TOP WIDTH	BOTTOM WIDTH	REMARKS
SURFACE COURSE						
28.87	TONS/STA.	AGGREGATE FOR BITUMINOUS SURFACE COURSE (SM-2)	2"	24'-0"	23'-11"	MAINLINE - MEDIAN TO CURB & GUTTER
1.82	TONS/STA.	ASPHALT CEMENT (AC-5)				
	TONS/STA.	AGGREGATE FOR BITUMINOUS SURFACE COURSE (SM-2)	2"	24'-0"	24'-0"	MAINLINE - MEDIAN TO SHOULDER
	TONS/STA.	ASPHALT CEMENT (AC-5)				
14.50	TONS/STA.	AGGREGATE FOR BITUMINOUS SURFACE COURSE (OM-4)	2"	12'-0"	12'-0"	ACCELERATION/DECELERATION OR LEFT TURN LANE
8.87	TONS/STA.	ASPHALT CEMENT (AC-5)				
0.10	GALS./SQ. YD.	EMULSIFIED ASPHALT (SS-1H) FOR TACK				
BASE COURSE						
89.55	TONS/STA.	AGGREGATE FOR BITUMINOUS BASE COURSE (OM-4 REVISED)	8"	23'-11"	23'-10"	MAINLINE - MEDIAN TO CURB & GUTTER
5.285	TONS/STA.	ASPHALT CEMENT (AC-5)				
94.16	TONS/STA.	AGGREGATE FOR BITUMINOUS BASE COURSE (OM-4 REVISED)	8"	24'-0"	24'-1"	MAINLINE - MEDIAN TO SHOULDER
5.300	TONS/STA.	ASPHALT CEMENT (AC-5)				
48.99	TONS/STA.	AGGREGATE FOR BITUMINOUS BASE COURSE (OM-4 REVISED)	8"	12'-0"	12'-0"	ACCELERATION/DECELERATION OR LEFT TURN LANE
2.844	TONS/STA.	ASPHALT CEMENT (AC-5)				
74.78	TONS/STA.	AGGREGATE FOR BITUMINOUS BASE COURSE (OM-4 REVISED)	8"	23'-11"	23'-10.5"	SIDE RD. LT. STA. 1200+58.84
4.288	TONS/STA.	ASPHALT CEMENT (AC-5)				
37.52	TONS/STA.	AGGREGATE FOR BITUMINOUS BASE COURSE (OM-4 REVISED)	8"	12'-0"	12'-0"	RT. TURN LANE SIDE RD.
2.112	TONS/STA.	ASPHALT CEMENT (AC-5)				LT. STA. 1200+58.84
88.93	TONS/STA.	AGGREGATE FOR BITUMINOUS BASE COURSE (OM-4 REVISED)	8"	12'-0"	12'-0"	SIDE ROAD LT.
3.787	TONS/STA.	ASPHALT CEMENT (AC-5)				STA. 1180+14
0.10	GALS./SQ. YD.	EMULSIFIED ASPHALT (SS-1H) FOR TACK				
ROAD MIX BITUMINOUS BASE COURSE						
6.974	TONS/STA.	EMULSIFIED ASPHALT	8"	30'-3"	31'-0"	MAINLINE - MEDIAN TO CURB & GUTTER
8.98	TONS/STA.	MINERAL FILLER				
341.67	SO. YDS./STA.	BITUMINOUS BASE (B-1)				
9.348	TONS/STA.	EMULSIFIED ASPHALT	8"	30'-5-5/8"	42'-11-5/8"	MAINLINE - MEDIAN TO SHOULDER
13.24	TONS/STA.	MINERAL FILLER				
457.89	SO. YDS./STA.	BITUMINOUS BASE (B-1)				
2.721	TONS/STA.	EMULSIFIED ASPHALT	8"	12'-0"	12'-0"	LEFT TURN LANE & ACCELERATION/DECELERATION LANE
3.89	TONS/STA.	MINERAL FILLER				
133.23	SO. YDS./STA.	BITUMINOUS BASE (B-1)				MAIN CURB & GUTTER
2.812	TONS/STA.	EMULSIFIED ASPHALT	8"	8'-1-5/8"	8'-1-5/8"	ACCELERATION/DECELERATION LANE ALIGHT CURB & GUTTER
2.98	TONS/STA.	MINERAL FILLER				
101.58	SO. YDS./STA.	BITUMINOUS BASE (B-1)				
8.978	TONS/STA.	EMULSIFIED ASPHALT	8"	42'-0"	46'-0"	SIDE ROAD LT. STA. 1180+54.18
14.26	TONS/STA.	MINERAL FILLER				
488.88	SO. YDS./STA.	BITUMINOUS BASE (B-1)				
BITUMINOUS SEALING						
2.67	CU. YDS./STA.	COVER MATERIAL (CM-A)**				TEMP. SURFACE - SEE SPECIFICATIONS - TRACK
83.34	GALS./STA.	CUTBACK ASPHALT (RC-3000)**				SM. NO. 8
	STA.	MANIPULATION (BITUMINOUS SEAL)				
2.67	CU. YDS./STA.	COVER MATERIAL (CM-D)				SIDE ROAD LT. STA. 1180+54.18
83.33	GALS./STA.	CUTBACK ASPHALT (RC-3000)**				
	STA.	MANIPULATION (BITUMINOUS SEAL)				

RATES OF APPLICATION (SHOULDERS)

RATE	UNITS	ITEM	SHOULDER WIDTH	REMARKS
BASE COURSE				
48.50	TONS/STA.	AGGREGATE FOR BITUMINOUS BASE COURSE (OM-4 REVISED)	10'-0"	MAINLINE
2.736	TONS/STA.	ASPHALT CEMENT (AC-5)		
25.08	TONS/STA.	AGGREGATE FOR BITUMINOUS BASE COURSE (OM-5 REVISED)	8'-0"	MAINLINE AT ACCELERATION OR DECELERATION LANES
1.074	TONS/STA.	ASPHALT CEMENT (AC-5)		
15.82	TONS/STA.	AGGREGATE FOR BITUMINOUS BASE COURSE (OM-4 REVISED)	8'-0"	SIDE ROAD LT. STA. 1180+54.18
0.538	TONS/STA.	ASPHALT CEMENT (AC-5)		
27.82	TONS/STA.	AGGREGATE FOR BITUMINOUS BASE COURSE (OM-4 REVISED)	8'-0"	MAINLINE & SIDE ROAD LT. STA. 1200+58.84
1.571	TONS/STA.	ASPHALT CEMENT (AC-5)		
31.84	TONS/STA.	AGGREGATE FOR BITUMINOUS BASE COURSE (OM-4 REVISED)	8'-0"	SIDE ROAD RT. STA. 1200+58.84
1.792	TONS/STA.	ASPHALT CEMENT (AC-5)		
0.10	GALS./SQ. YD.	EMULSIFIED ASPHALT (SS-1H) FOR TACK		
BITUMINOUS SEALING				
0.007	CU. YDS./SQ. YD.	COVER MATERIAL (CM-F)	ALL	ALL STABILIZED SHOULDERS
0.25	GALS./SQ. YD.	CUTBACK ASPHALT (RC-3000)		
	STA.	MANIPULATION (BITUMINOUS SEAL) SHOULDERS		

NOTES

ROAD MIX BITUMINOUS BASE COURSE:
 THE TOP 8" OF IN-PLACE MATERIAL SHALL BE USED FOR THE ROAD MIX BITUMINOUS BASE COURSE WITH THE CONDITION THAT SUCH MATERIAL CONTAIN A MINIMUM OF 10% BY DRY WEIGHT OF MINUS 200 MATERIAL. THE SUITABILITY OF THE IN-PLACE MATERIAL SHALL BE DETERMINED IN THE FIELD BY THE ENGINEER.

* MINERAL FILLER:
 MINERAL FILLER HAS BEEN INCLUDED IN THE BID QUANTITIES WITH THE STIPULATION THAT IT BE SUBJECT TO AN UNDERDRUM UP TO 100%. NO ADJUSTMENT IN BID PRICE WILL BE MADE FOR UNDERDRUM OF THE BID ITEM MINERAL FILLER.

MINERAL FILLER FOR ROAD MIX BITUMINOUS BASE COURSE SHALL BE IN ACCORDANCE WITH SPECIAL PROVISION 809.012 OF THE INC. STANDARD SPECIFICATIONS.

** TEMPORARY SURFACE:
 A BITUMINOUS SEAL (CM-A) HAS BEEN INCLUDED IN THE BID QUANTITIES WITH THE STIPULATION THAT IT BE SUBJECT TO AN UNDERDRUM UP TO 100%. NO ADJUSTMENT IN BID PRICE WILL BE MADE FOR AN UNDERDRUM OF THE BID ITEMS FOR THIS SEAL.

ADDITIONAL TACK COATS:
 AN ADDITIONAL TACK COAT OF EMULSIFIED ASPHALT (SS-1H) SHALL BE PROVIDED BETWEEN EACH LIFT OF THE SURFACE OR BASES WHEN SO ORDERED BY THE ENGINEER AND AT THE RATE DESIGNATED BY HIM. QUANTITIES FOR THESE TACKS HAVE BEEN COMPUTED AT 0.880418 TON PER SQ. YD.

AGGREGATE FOR BITUMINOUS SURFACE COURSE (SM-2) HAS BEEN COMPUTED AT THE RATE OF 145 LBS./CU. FT. (TOTAL MIX - AGGREGATE & ASPHALT). ASPHALT CEMENT (AC-5) HAS BEEN COMPUTED AT THE RATE OF 94.9 BY DRY WEIGHT OF AGGREGATE.

AGGREGATE FOR BITUMINOUS BASE COURSE (OM-4 REVISED) HAS BEEN COMPUTED AT THE RATE OF 145 LBS./CU. FT. (TOTAL MIX - AGGREGATE & ASPHALT). ASPHALT CEMENT (AC-5) HAS BEEN COMPUTED AT THE RATE OF 88 BY DRY WEIGHT OF AGGREGATE.

DENSITY OF THE ROAD MIX BITUMINOUS BASE COURSE HAS BEEN ASSUMED AT 120 LBS./CU. FT. (DRY WEIGHT - AGGREGATE & MINERAL FILLER). THE MOISTURE MATERIAL IN PLACE IS TO BE USED FOR AGGREGATE. MINERAL FILLER HAS BEEN COMPUTED AT THE RATE OF 106 BY DRY WEIGHT.

DENSITY OF THE LIME TREATED SUBGRADE HAS BEEN ASSUMED AT 110 LBS./CU. FT. (DRY WEIGHT - AGGREGATE & LIME). HYDRATED LIME HAS BEEN COMPUTED AT THE RATE OF 38 BY DRY WEIGHT.

COVER MATERIAL (CM-F) HAS BEEN COMPUTED AT THE RATE OF 0.008 CU. YDS./SQ. YD. CUTBACK ASPHALT (RC-3000) HAS BEEN COMPUTED AT THE RATE OF 0.25 GAL./SQ. YD. COVER MATERIAL (CM-D) HAS BEEN COMPUTED AT THE RATE OF 0.013 CU. YDS./SQ. YD. CUTBACK ASPHALT (RC-3000) HAS BEEN COMPUTED AT THE RATE OF 0.25 GAL./SQ. YD.

SELECTED EMBANKMENT MATERIAL SHALL BE OBTAINED FROM THE HOMOGENEOUS AREAS AS NOTED ON SHEET NO. 18 AS APPROVED BY THE ENGINEER.

RATES AND QUANTITIES FOR BITUMINOUS BASE COURSES HAVE BEEN INCREASED FOR CONTINGENCIES (8% - 0" BASE; 15% - 4" & 8" BASE).

SEDGWICK COUNTY HIGHWAY DEPARTMENT
 G. C. MCLURE, JR., COUNTY ENGINEER

SURFACING RATES AND QUANTITIES

SEDGWICK COUNTY PROJECT 875-SU-42000
 PROFESSIONAL ENGINEERING CONSULTANTS

* RATES INCREASED 8%
 ** RATES INCREASED 15%

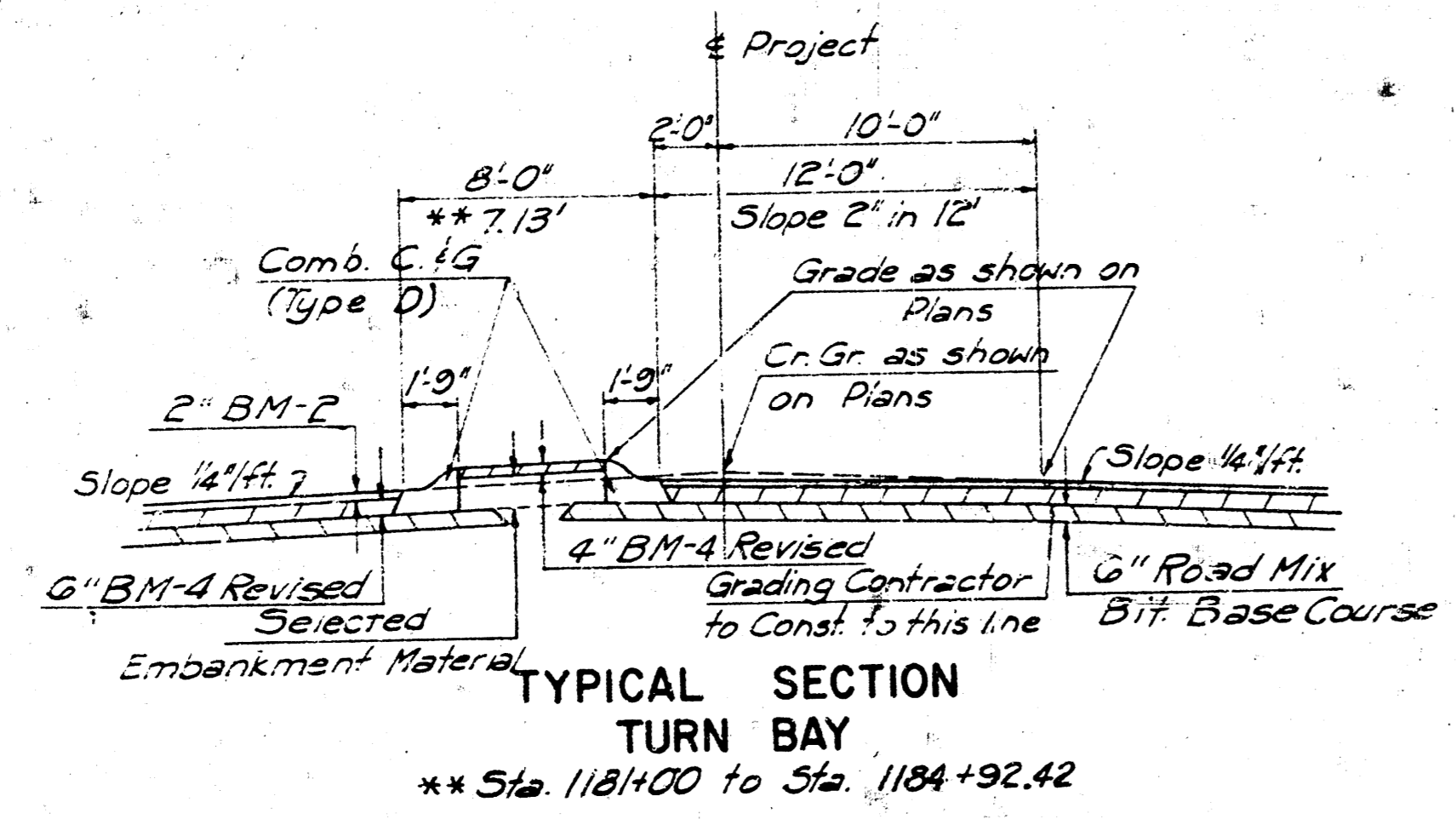
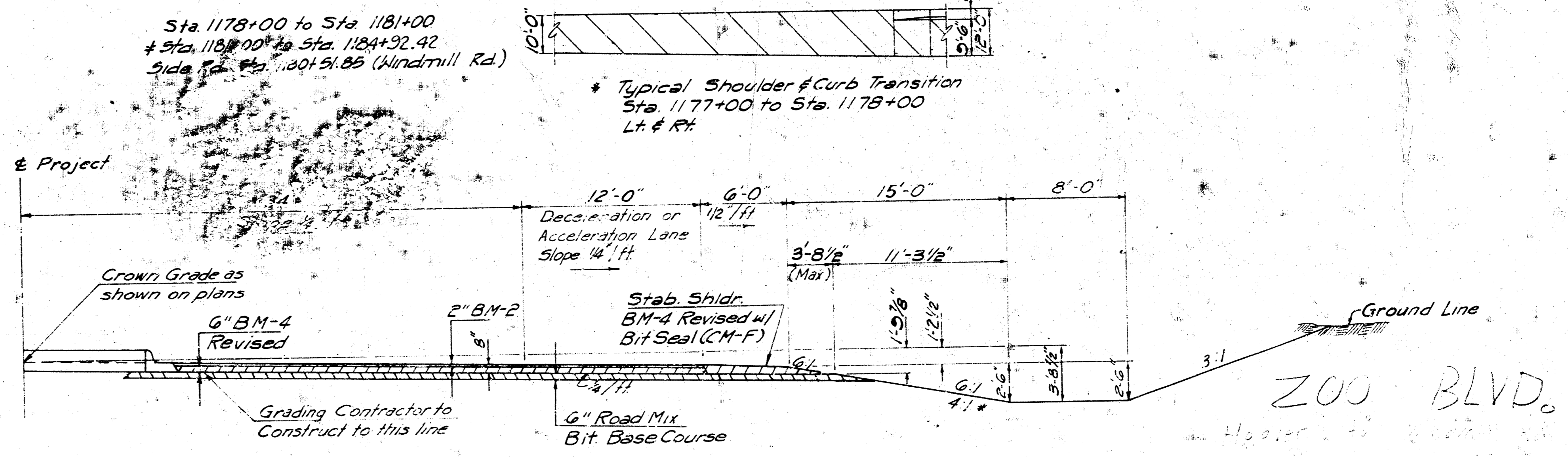
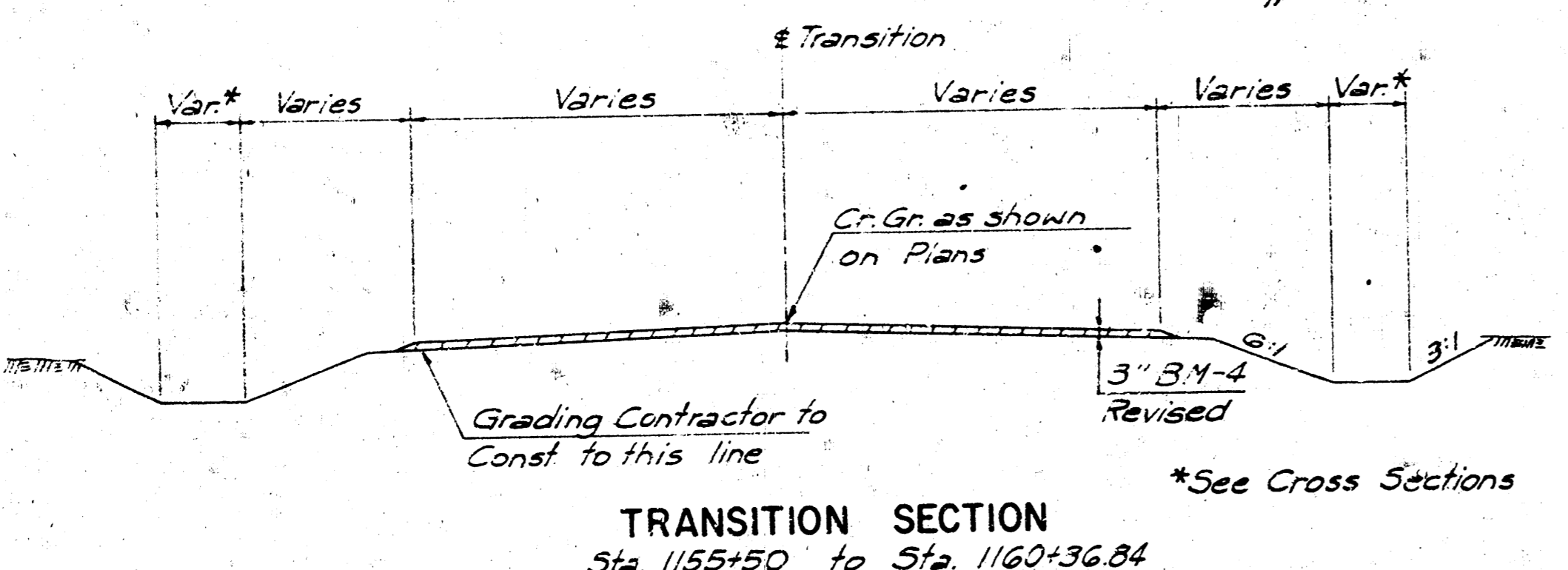
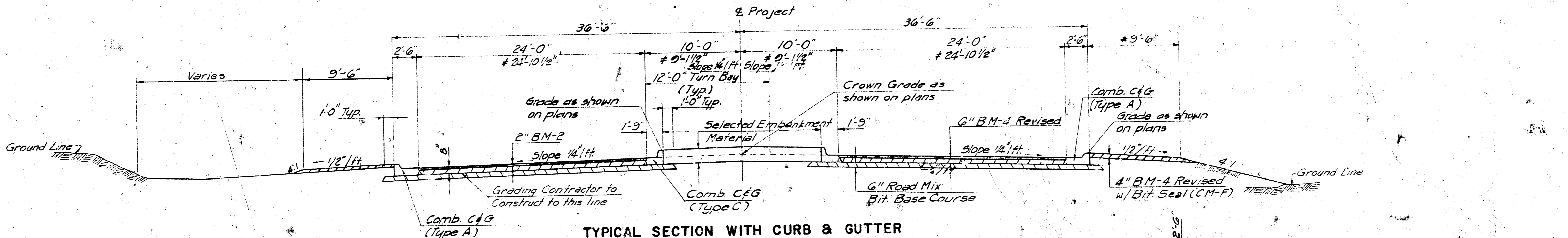
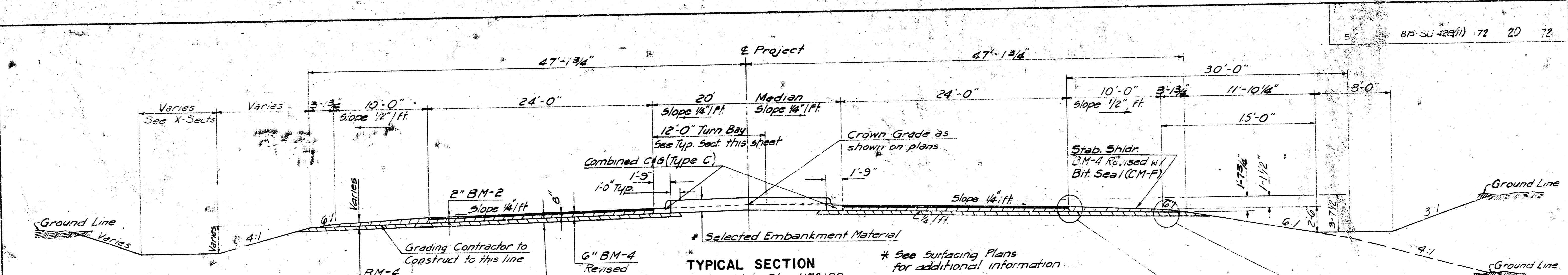

SEDGWICK COUNTY HIGHWAY DEPARTMENT
G. C. MCLURE, JR., P.E. COUNTY ENGINEER
TYPICAL SECTIONS SURFACING
SEDGWICK COUNTY PROJECT 87S-SU-428(1)
PROFESSIONAL ENGINEERING CONSULTANTS
K.E.
G.G. Mar 72 70028

ZOO BLVD.