

Bm 16477 R. in Ritchie Top Cb. East End Radius N.E. Zimmerly & Rosalie
Sta. On N.L. Zimmerly

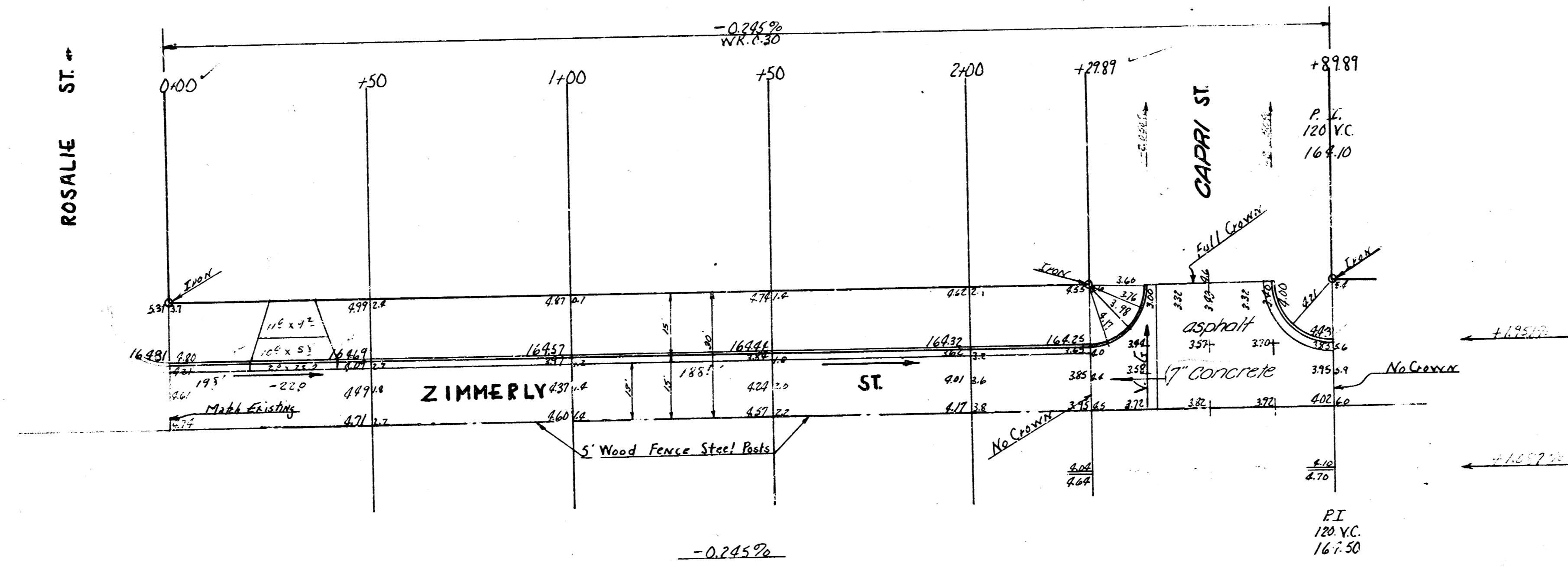

| Total Excavation | | City | |
|------------------|------|------|------|
| Cut | Fill | Cut | Fill |
| 324 | 2934 | 1212 | 0 |

| ESTIMATE OF QUANTITIES | | |
|------------------------|----------|-------------------|
| Quantity | Unit | Item |
| 332 | Sq. Yds. | Asph. Conc. Pavt. |
| 230 | Lin. Ft. | Curb Ch. & Gutter |
| 35 | Cu. Yds. | Excavation |
| 1130 | Lbs. | Reinf. Steel |
| 295 | Cu. Yds. | Gravel Fill |

NOTE TO CONTRACTOR
This project will be constructed under the supervision of the City Engineer and subject to the conditions of the contract. It is the contractor's responsibility to verify the data and to provide the City with a copy of the proposed engineering plan.

| | | |
|---|--|--|
| NO. 1/2 INTERSECTION ZIMMERLY & ^(WEST SIDE) CAPRI ASPH. CONCRETE | | NO. 1/2 ZIMMERLY E.L. ROSALIE W.L. CAPRI 13-2-15 AC. |
| CITY OF WICHITAKAN B.E. SMITH CITY ENGINEER DATE | | CITY OF WICHITAKAN B.E. SMITH CITY ENGINEER DATE |
| PROJ. NO. C-19-150 | | PRIVATE CONTRACT |

Young
8-1-51



1/2