

Scale: 1" = 20'  
• = Iron

**BENCHMARK:**  
BM #1: "□" in top of curb at north end of median at intersection of Gilda & MacArthur.  
MacArthur.  
Elev = 124.26 (City Datum)

BM #2: 60D step bench on north face of power pole, 68' north and 21' east of SE corner of Gray's 6th Addition.  
Elev = 123.70 (City Datum)

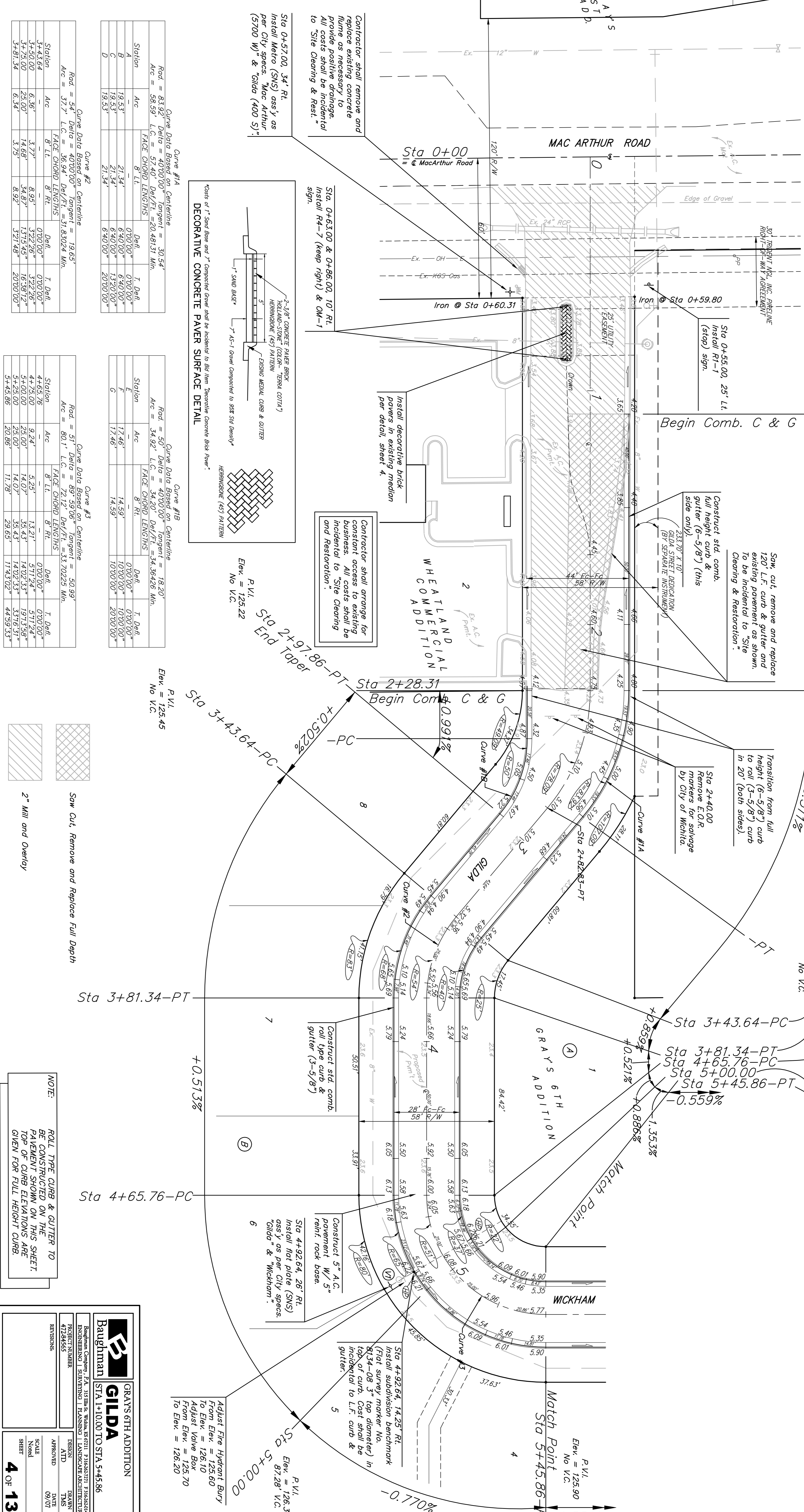

Curve #1A  
Rad = 83.92' Delta = 40°00'00" Tangent = 30.54'  
Arc = 58.59' L.C. = 57.40' Def/FT. = 20.49131 Mn.

Station	Arc	FACE CHORD LENGTHS	Def/Lt.	T. Defl.
A	19.53'	8' Lt.	0.7000"	0.7000"
B	19.53'	8' Lt.	6.4000"	6.4000"
C	19.53'	8' Lt.	6.4000"	13.2000"
D	19.53'	8' Lt.	21.34'	20.0000"

Curve #1B  
Rad = 50' Delta = 89°35'06" Tangent = 50.99'  
Arc = 80.1' L.C. = 72.12' Def/FT. = 33.70225 Mn.

Station	Arc	FACE CHORD LENGTHS	Def/Lt.	T. Defl.
E	17.46'	8' Rt.	10.0000"	10.0000"
F	17.46'	8' Rt.	14.59'	10.0000"
G	17.46'	8' Rt.	14.59'	20.0000"

Curve #2  
Rad = 34.92' Delta = 40°00'00" Tangent = 18.20'  
Arc = 34.92' L.C. = 34.20' Def/FT. = 34.35426 Mn.

Station	Arc	FACE CHORD LENGTHS	Def/Lt.	T. Defl.
H	9.24'	8' Rt.	5.25'	0.7000"
I	9.24'	8' Rt.	13.21'	5.1124"
J	9.24'	8' Rt.	35.43'	19.1358"
K	9.24'	8' Rt.	35.43'	33.7631"
L	9.24'	8' Rt.	11.78'	44.5933"

Curve #3  
Rad = 51' Delta = 89°35'06" Tangent = 50.99'  
Arc = 80.1' L.C. = 72.12' Def/FT. = 33.70225 Mn.

Station	Arc	FACE CHORD LENGTHS	Def/Lt.	T. Defl.
M	17.46'	8' Rt.	10.0000"	10.0000"
N	17.46'	8' Rt.	14.59'	10.0000"
O	17.46'	8' Rt.	14.59'	20.0000"

**NOTE:**  
ROLL TYPE CURB & GUTTER TO BE CONSTRUCTED ON THE PAVEMENT SHOWN ON THIS SHEET. TOP OF CURB ELEVATIONS ARE GIVEN FOR FULL HEIGHT CURB.

**Baughman**  
Gray's 6th Addition  
STA 1+10.00 TO STA 5+45.86

Project Number: 4724565  
Revisions: 09/07

Scale: 1" = 20'  
Sheet: 4 OF 13