

Sta. 0+00, Begin Const. of 4-10'x5' RCBC w/RC Headwall, Flared Wingwalls and Conc. Apron, the cost of which shall be incidental to RCBC. Install 80 square feet of stone masonry to face of flared wingwalls costs shall be incidental to RCBC. See Detail Sheets 23-26. Install 271.5 S.Y. of Heavy Stone Rip-Rap. Handrails to be installed w/street project.

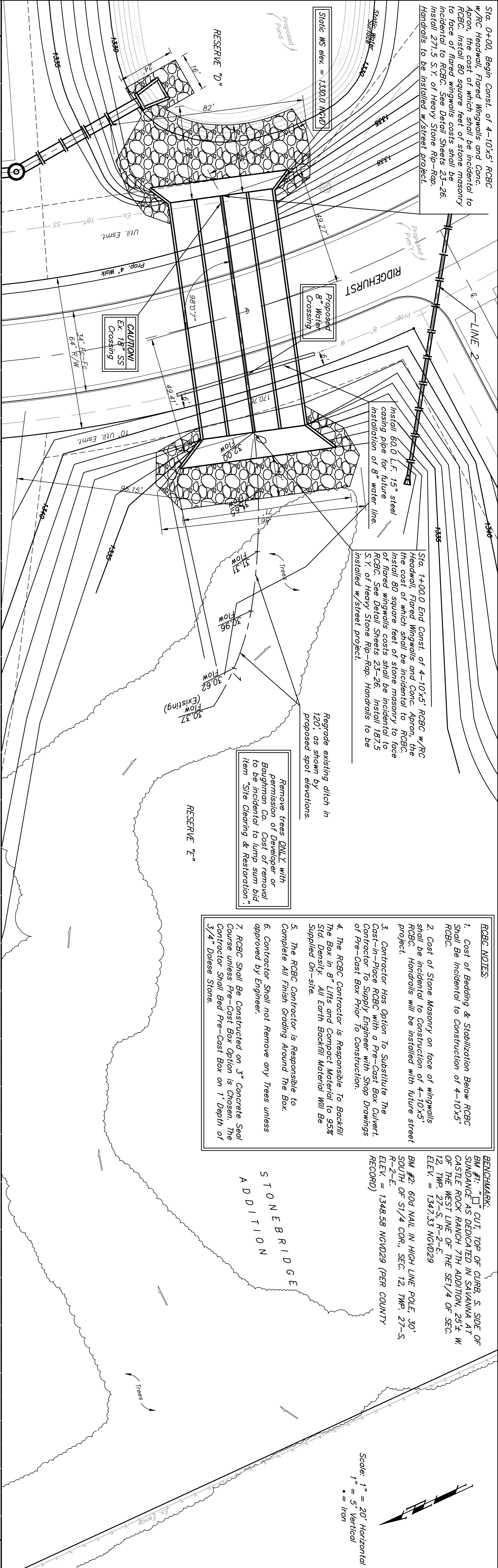

Sta. 0+00, Begin Const. of 4-10'x5' RCBC w/RC Headwall, Flared Wingwalls and Conc. Apron, the cost of which shall be incidental to RCBC. Install 80 square feet of stone masonry to face of flared wingwalls costs shall be incidental to RCBC. See Detail Sheets 23-26. Install 271.5 S.Y. of Heavy Stone Rip-Rap. Handrails to be installed w/street project.

Sta. 1+00.0 End Const. of 4-10'x5' RCBC w/RC Headwall, Flared Wingwalls and Conc. Apron, the cost of which shall be incidental to RCBC. Install 80 square feet of stone masonry to face of flared wingwalls costs shall be incidental to RCBC. See Detail Sheets 23-26. Install 187.5 S.Y. of Heavy Stone Rip-Rap. Handrails to be installed w/street project.

Sta. 1+00.0 End Const. of 4-10'x5' RCBC w/RC Headwall, Flared Wingwalls and Conc. Apron, the cost of which shall be incidental to RCBC. Install 80 square feet of stone masonry to face of flared wingwalls costs shall be incidental to RCBC. See Detail Sheets 23-26. Install 187.5 S.Y. of Heavy Stone Rip-Rap. Handrails to be installed w/street project.

Regrade existing ditch in 120', as shown by proposed spot elevations.

Remove trees ONLY with permission of Developer or Baughman Co. Cost of removal to be incidental to lump sum bid "Site Clearing & Restoration".

- RCBC NOTES:**
1. Cost of Bedding & Stabilization Below RCBC Shall Be Incidental to Construction of 4-10'x5' RCBC.
 2. Cost of Stone Masonry on face of wingwalls shall be incidental to Construction of 4-10'x5' RCBC. Handrails will be installed with future street project.
 3. Contractor Has Option To Substitute The Cost-In-Piece RCBC with a Pre-Cost Box Culvert. Contractor To Supply Engineer with Shop Drawings of Pre-Cost Box Prior To Construction.
 4. The RCBC Contractor is Responsible To Backfill The Box in 8" Lifts and Compact Material to 95% Std. Density. All Earth Backfill Material Will Be Supplied On-site.
 5. The RCBC Contractor is Responsible to Complete All Finish Grading Around The Box.
 6. Contractor Shall not Remove any Trees unless approved by Engineer.
 7. RCBC Shall Be Constructed on 3" Concrete Seal Course unless Pre-Cost Box Option is Chosen. The Contractor Shall Bed Pre-Cost Box on 1' Depth of 3/4" Dolose Stone.

BENCHMARK:
 BM #1: CUT, TOP OF CURB, S. SIDE OF SUNDANCE AS DEDICATED IN SAVANNA AT CASTLE ROCK RANCH 7TH ADDITION, 25± W OF THE WEST LINE OF THE SE1/4 OF SEC. 12, TWP. 27-S, R-2-E, ELEV. = 1344.33 NGVD29
 BM #2: 60d NAIL IN HIGH LINE POLE, 30' SOUTH OF S1/4 COR., SEC. 12, TWP. 27-S, R-2-E, ELEV. = 1348.58 NGVD29 (PER COUNTY RECORD)

STONEBRIDGE ADDITION

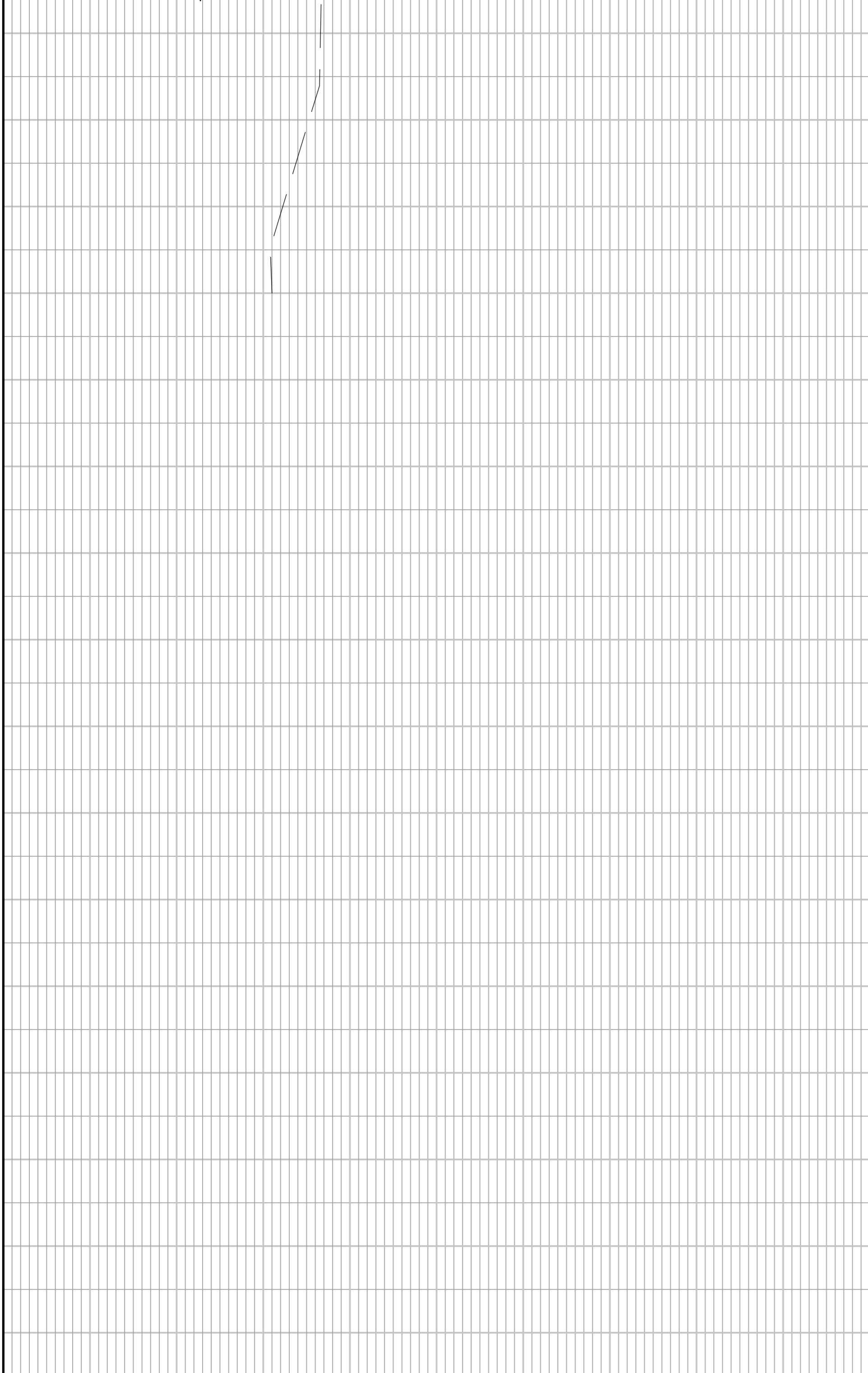
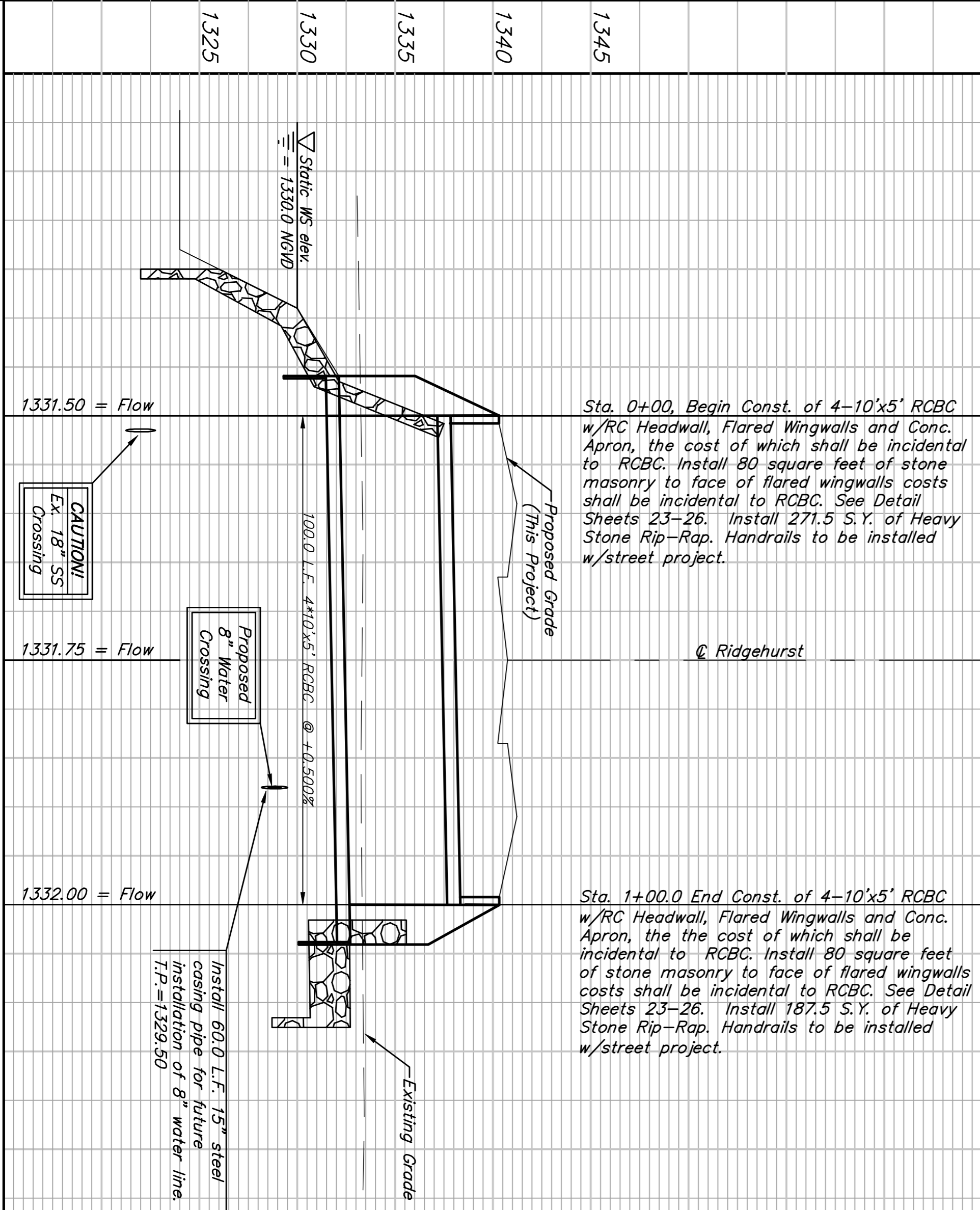
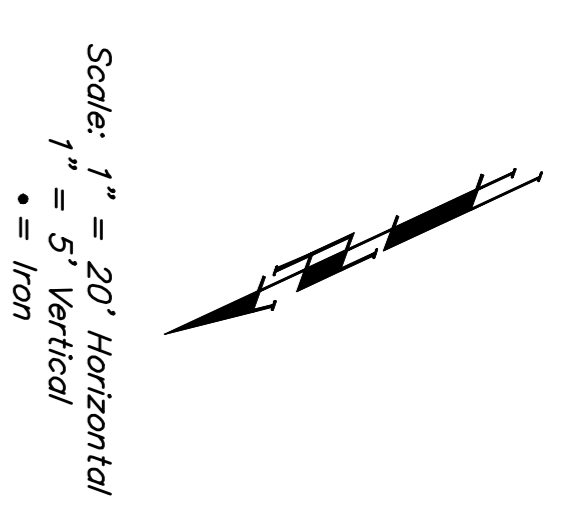

Baughman RCBC
 STORM WATER SEWER IMPROVEMENTS
 STONEBRIDGE ADDITION

PROJECT NUMBER: 46844395
 DESIGN: ATD
 APPROVED: TMS
 DATE: 09/07

DESIGN: TMS
 DRAWN: TMS
 SCALE: None
 SHEET: 22 OF 51

06-07-2008