

NOTES:

1. Pond bottom and sideslopes below static pool elevation shall be over-excavated 1" and a 1' clay liner shall be compacted to 95% std. density. The plasticity index (P.I.) shall be at least 28. The compaction and P.I. shall be verified during construction. P.I. determination and compaction testing shall be arranged and paid by the contractor at the request of the inspector. Cost shall be incidental to "Site Clearing & Restoration". Cost of over-excavation to install Clay Liner shall be incidental to bid item, "Excavation." Contractor shall use the best material from site for clay liner.
2. Any excess excavation shall be stockpiled as noted on Mass Grading Plan out of easements and R/W. Area will be staked by Engineer as requested. Additional area will be staked out if needed.
3. All of Reserves "D" & "F" above the static water surface shall be seeded and mulched as follows: (Permanent Seeding)  
SEED -- Kansas Premium Fescue Blend; 8#/1000 Sq. Ft.  
FERTILIZER -- 12-24-12 Ratio at 350 Lbs./Ac.  
MULCH -- 2 Tons Prairie Hay / Acre
4. All other disturbed areas not in street R/W are to be seeded as follows: (Temporary seeding)  
SEED -- Rye grass (PLS)--5#/1000 Sq. Ft. and Kansas Premium Fescue Blend; 5#/1000 Sq. Ft.
5. Install Erosion Control Mat (Curlux II or approved equal) from 2' below the water surface to top bank.
6. Contractor to strip top 3" of soil within Res. "D" & "F" under proposed ponds and berms and street R/W before mass grading and stockpile. Top soil stockpile to be redistributed over Reserves "D" & "F" above water elevation prior to seeding.
7. Compaction of 95% shall be obtained in all street R/W's, 90% in all other areas including berm construction. Contractor shall be responsible for the arranging and payment of testing at direction of inspector, all costs associated with testing shall be incidental to "Mass Grading".

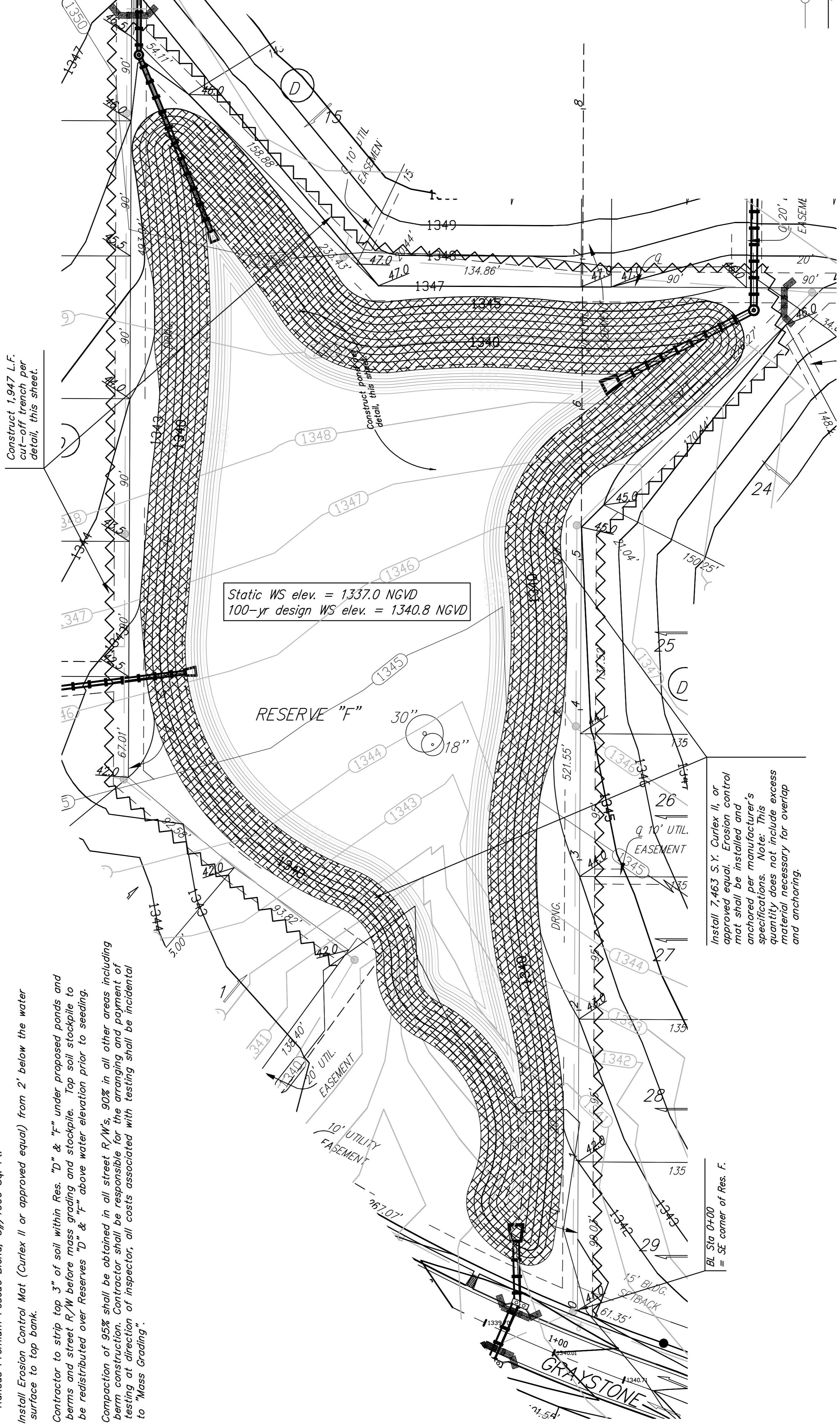
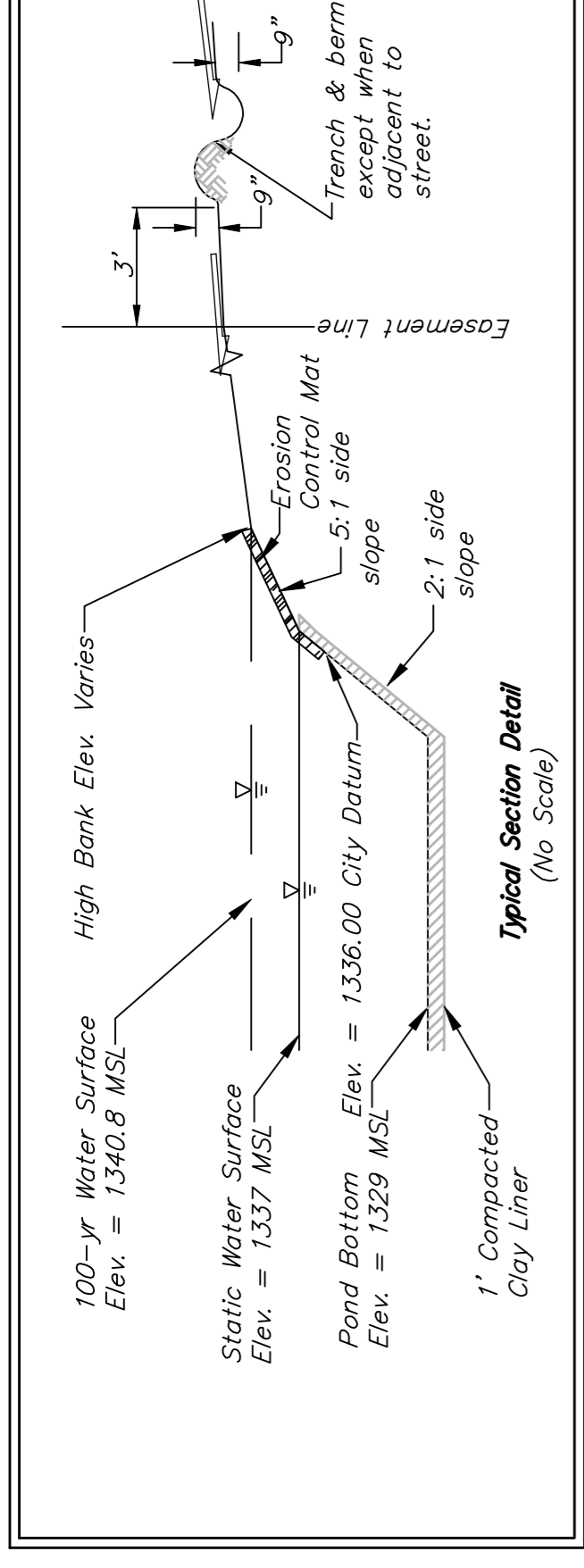

| EARTH WORK TOTALS    |                 |
|----------------------|-----------------|
| C. Y. EXC C. Y. FILL |                 |
| MASS GRADING         | 59,921 122,009  |
| BIG BERM RES D       | 6,798           |
| SMALL BERM RES D     | 8,892           |
| BERM RES B           | 8,603           |
| RES E                | 3,359           |
| POND RES F           | 62,581 3,349    |
| POND RES D           | 34,270 1,273    |
| TOTAL                | 156,772 146,283 |

Earthwork quantities do not include correction factors and are for reference only. All cost associated with mass grading shall be included in the bid item "Mass Grading". Berm construction shall be incidental to "Mass Grading".

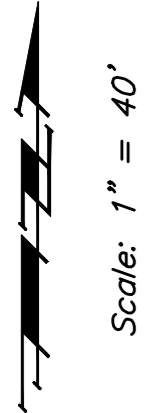

STONEBRIDGE ADDITION  
**POND PLAN "F"**  
SEDGWICK COUNTY, KANSAS

Baughman  
Engineering & Planning, Inc.  
1305 S. 11th St., Topeka, KS 66603  
405-343-3935

|                |              |
|----------------|--------------|
| PROJECT NUMBER | 405-343-3935 |
| DESIGN         | TMS          |
| DATE           | 09/07        |
| APPROVED       | Noted        |
| SCALE          | Noted        |
| SHEET          | 40 OF 51     |

06/07/2008

