

CITY OF WICHITA
 MICHAEL E. LINDEBAK, P.E., CITY ENGINEER
 PRIVATE PROJECT NO. 589PPS
 INDEX CODE: 607861

APPROVED AS NOTED
 BY CITY ENGINEER OF WICHITA

Sanitary Sewers _____
 Storm Sewers VRH 12/15/95
 Driveway Approaches _____
 Water Mains _____
 Paving _____

GENERAL NOTES

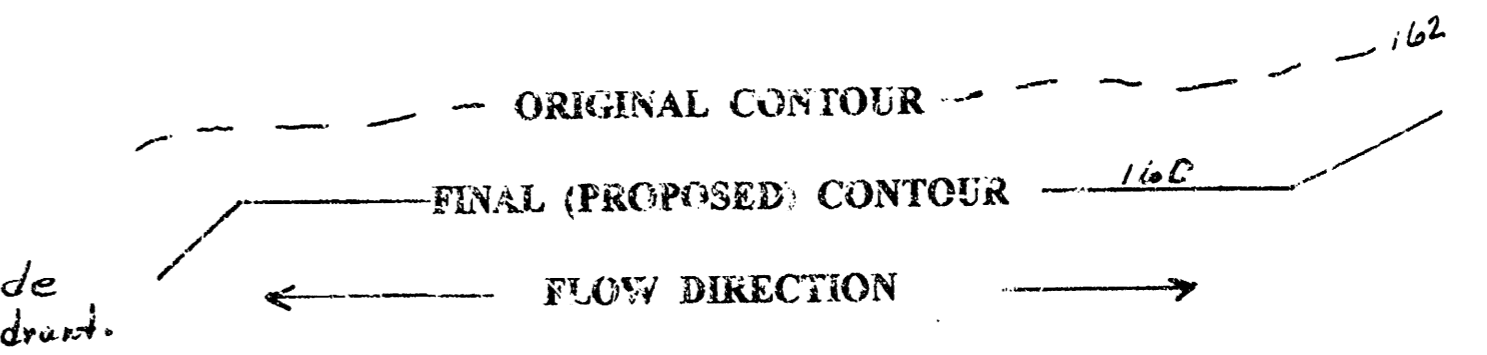

- All storm sewer pipe is to be RCP - Class III minimum, $n = 0.11$, or an approved by engineer equal.
- All storm sewer grates are to have a minimum capacity of 12 cfs with 1.0' of head on the inlet grate. An acceptable grate is the Neenah R-1792-BG, Type G, with a minimum 2.7" square face of opening, heavy duty. Alternate grates will be accepted if approved by the engineer. All grates are to be bicycle safe, and capable of handling H-20 loading.
- An acceptable alternate storm sewer pipe is the double walled ADS smooth interior wall, $n = 0.010$, heavy duty Polyethylene pipe meeting AASHTO M294 TYPE S, and ASTM D1248, D3350, and D2221, installed with proper bedding as recommended by the manufacturer for H-20 loading.
- Inlets and manholes are to be round, 48" in diameter minimum, and cast in place, to fit the inlet or manhole grate, with a minimum 8" wall thickness, or as approved by engineer acceptable alternate.
- Where sufficient depth allows, inlets and manholes may be pre-cast concrete barrel sections with an 8" eccentric concrete cap, or precast eccentric cone section. All pre-cast inlet or manhole sections over 3.5' in barrel depth are to have cast in place steps.
- SPECIAL NOTE: NO STEPS IN MH OR WELLS. MH TO BE 48" UNLESS SPECIFIED AS OTHER.

NOTE TO CONTRACTOR

INSPECTION AND TESTING FOR THIS PROJECT IS TO BE PROVIDED BY A LICENSED CONSULTING ENGINEERING FIRM UNDER CONTRACT WITH THE OWNER/DEVELOPER. SAID INSPECTION TO BE IN ACCORDANCE WITH THE CITY OF WICHITA STANDARD CONSTRUCTION ENGINEERING PRACTICES AND CERTIFIED BY A LICENSED PROFESSIONAL ENGINEER. NO WORK SHALL BE PERFORMED IN DEDICATED EASEMENTS OR THE PUBLIC RIGHT-OF-WAY BY THE CONTRACTOR WITHOUT SUCH INSPECTION NOR SHALL ANY WORK BE COMMENCED IN DEDICATED EASEMENTS OR PUBLIC RIGHT-OF-WAY WITHOUT WRITTEN AUTHORIZATION BY THE CITY ENGINEER.

GRADING PLAN

BENCH MARK: R.R. SPIKE IN NORTH FACE
 H.L.P., 60' EAST OF S.W. CORNER OF
 LOT 1, BLOCK 6, STERLING FARMS.
 ELEVATION: 162.37

I HEREBY DECLARE THAT THIS PLAN WAS
 PREPARED BY ME OR UNDER MY DIRECT
 SUPERVISION AND I AM A DULY REGISTERED
 ENGINEER UNDER THE LAWS OF THE STATE
 OF KANSAS

Douglas M. Dahms
 DOUGLAS M. DAHMS, P.E. # 13826
 ASBUILT 2/20/96 JFB BANGHAM CO.

REVISIONS	BY

Lot 1, Block 6, Sterling Farms

DRAWN	
CHECKED	
DATE	Aug-1995
SCALE	1" = 50'
JOB NO.	
SHEET	
OF	5
SHEETS	2

284982

LOT 1, BLOCK 6
STERLING FARMS

STORM SEWER - PROFILES

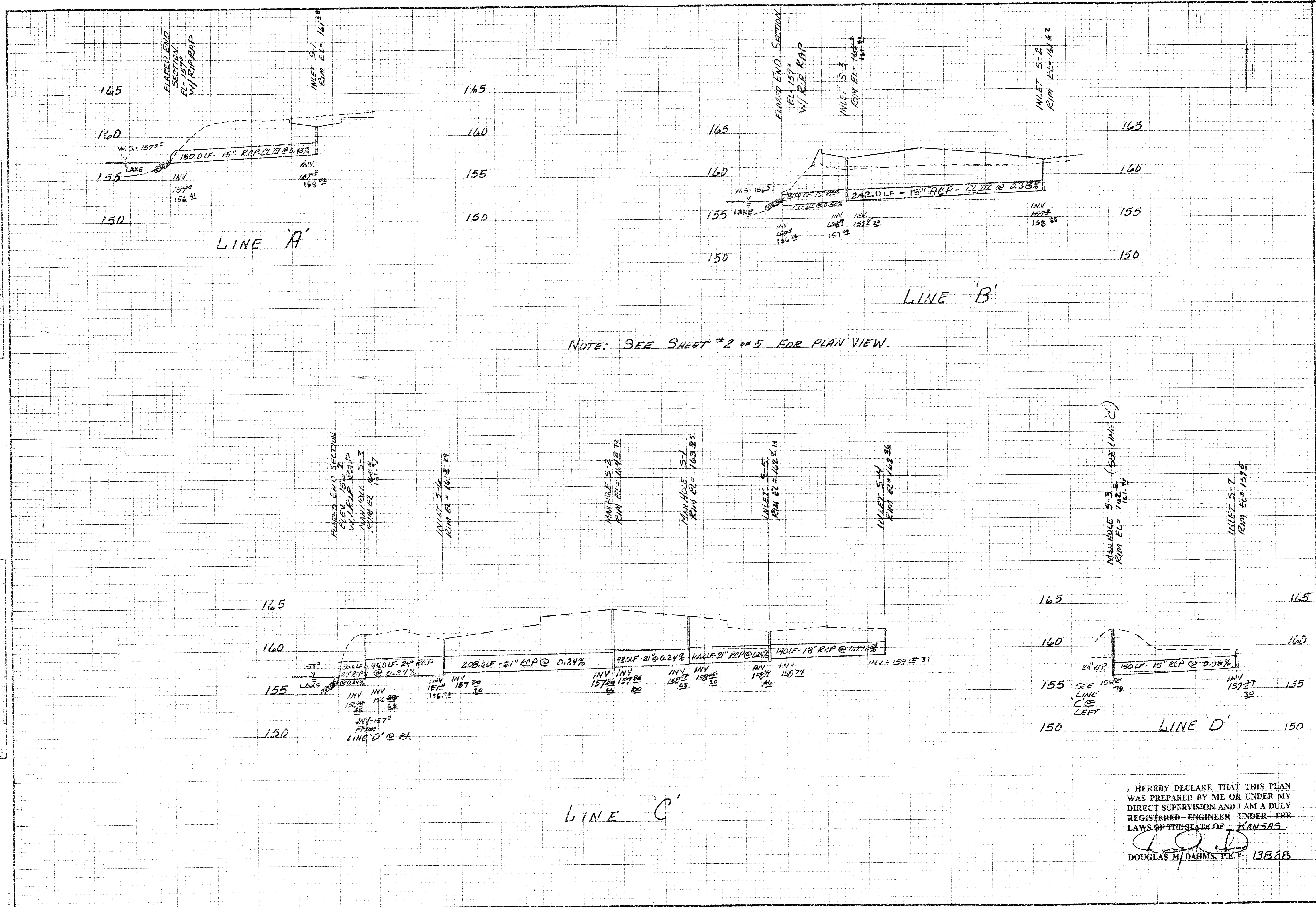

NOTE: SEE SHEET # 2 OF 5 FOR PLAN VIEW.

I HEREBY DECLARE THAT THIS PLAN WAS PREPARED BY ME OR UNDER MY DIRECT SUPERVISION AND I AM A DULY REGISTERED ENGINEER UNDER THE LAWS OF THE STATE OF KANSAS.

[Signature]
DOUGLAS M. DAHMS, P.E. 13828

DATE	9/12/95
DESIGNED BY	DMD
DRAWN BY	DMD
CHECKED BY	
JOB NO	13828
CITY	WICHITA KS
SHEET	2A
OF	5

FINAL SURVEY
REVISIONS
DATE

ORIGINAL SURVEY
REVISIONS
DATE