

**BENCHMARKS:**  
 BM #8 - RR Spike in West face of HLP, East side of Hydraulic, at the Centerline of Selma St. Sta. 162+06, 41' Rt. Elev. = 89.66 (City Datum)  
 BM #9 - City of Wichita Bench Mark Disc, 48.6' South and 32.4' West of Centerlines Hydraulic and Mac Arthur Sta. 168+35.3, 32.4' Rt. Elev. = 86.98 (City Datum)

**CAUTION!**  
 Contractor is to Use Caution when Planting Selected Trees Due to the Close Proximity of the 6" and 4" Steel Gas Lines.

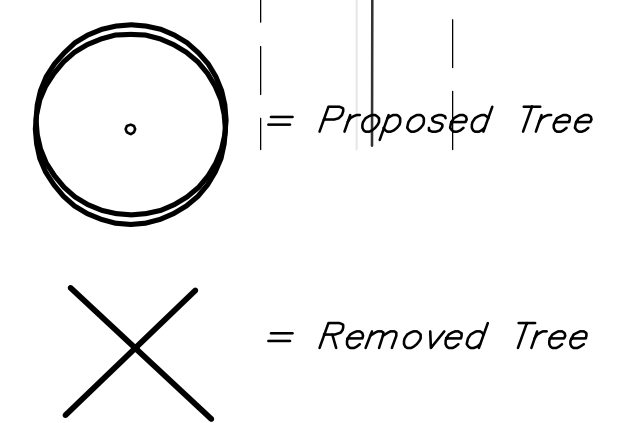
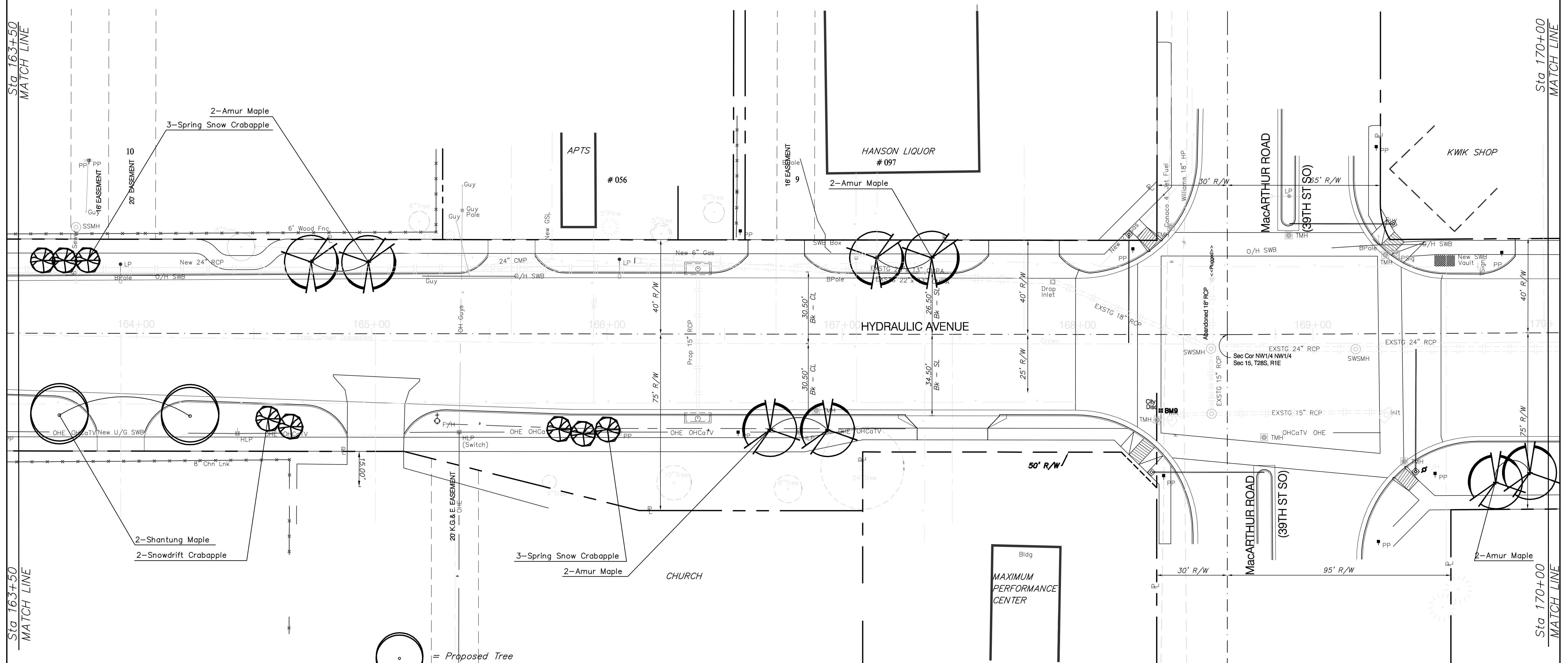
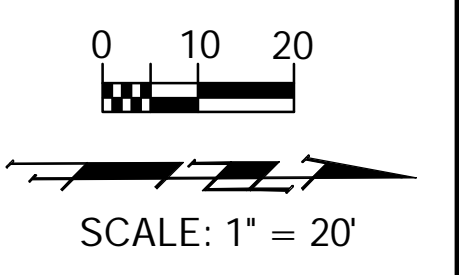

**PLANT SCHEDULE-This sheet only**

QTY	BOTANICAL NAME	COMMON NAME	SIZE	CONDITION	REMARKS
<b>LARGE SHADE TREES</b>					
2	<i>Acer truncatum</i>	Shantung Maple	2" Cal.	B&B	Single Stem Only
<b>ORNAMENTAL TREES</b>					
8	<i>Acer ginnala</i>	Amur Flame Maple	2" Cal.	B&B	Single Stem Only
2	<i>Malus 'Snowdrift'</i>	Snowdrift Crabapple	2" Cal.	B&B	Single Stem Only
6	<i>Malus 'Spring Snow'</i>	Spring Snow Crabapple	2" Cal.	B&B	Single Stem Only

PROJECT NUMBER 472-84118a		SHEET NAME Phase 1 LS	ENGINEERING DIRECTORY E:\HYDRAULIC LS
DESIGN BDT	DRAWN BDT	APPROVED BDT/PJM	DATE Mar 07
SCALE 1" = 20'		BAUGHMAN NO 99-09-E453	

CAPITAL IMPROVEMENT PROJECT  
**LANDSCAPE PLAN - SEGMENT 1**  
 47th STREET SOUTH to MacARTHUR ROAD

**BAUGHMAN COMPANY, P.A.**  
 ENGINEERING, SURVEYING, & PLANNING  
 316-262-7271 • 315 ELLIS • WICHITA, KANSAS 67211

SHEET  
9  
OF  
30