

BENCHMARKS:

BM #8 - City of Wichita Bench Mark Disc Top of Hub Guard East Side of Hydraulic @ RCB (Riverside Drainage District Canal) 15.76' East of CenterLine of Hydraulic. Sta. 46+51.9, 15.7' Rt. Elev. = 77.73 (City Datum)

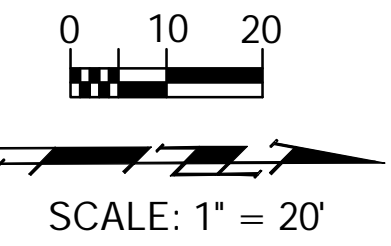

**M. MEYER & SON NURSERY INC
B - 201 - UP**

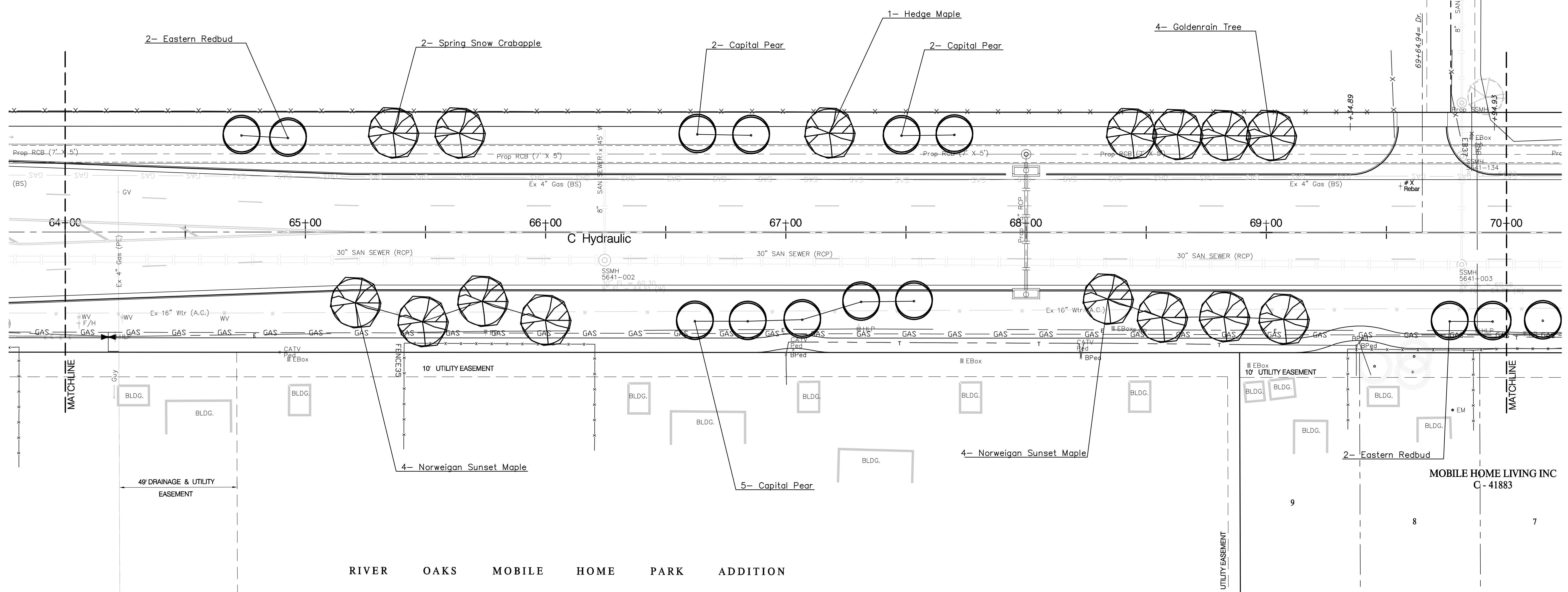

PLANT SCHEDULE-This sheet only

QTY	BOTANICAL NAME	COMMON NAME	SIZE	CONDITION	REMARKS
LARGE SHADE TREES					
1	<i>Acer campestre</i>	Hedge Maple	2" Cal.	B&B	Single Stem Only
8	<i>Acer truncatum x platanoides 'Keithsform'</i>	Norwegian Sunset Maple	2" Cal.	B&B	Single Stem Only
4	<i>Koelreuteria paniculata</i>	Golden Raintree	2" Cal.	B&B	Single Stem Only
ORNAMENTAL TREES					
4	<i>Cercis canadensis</i>	Eastern Redbud	2" Cal.	B&B	Single Stem Only
2	<i>Malus 'Spring Snow'</i>	Spring Snow Crabapple	2" Cal.	B&B	Single Stem Only
9	<i>Pyrus calleryana 'Capital'</i>	Capital Pear	2" Cal.	B&B	Single Stem Only

PROJECT NUMBER 472-84118a		SHEET NAME Phase2 LS		ENGINEERING DIRECTORY E:\Hydraulic LS\		STA 64+00 TO STA 70+00	
LANDSCAPE PLAN - SEGMENT 2				HYDRAULIC AVE PAVING - SOUTH OF 57th STREET SOUTH TO 47th STREET SOUTH			
DESIGN BDT	DRAWN BDT	APPROVED BDT/PJM	DATE Mar07	SCALE 1" = 20'	BAUGHMAN NO 99-09-E451	BAUGHMAN COMPANY, P.A. ENGINEERING, SURVEYING, & PLANNING 316-262-7271 • 315 ELLIS • WICHITA, KANSAS 67211	
						SHEET 14 OF 30	

Call Before You Dig!
1-800-DIG SAFE
or 687-2470 in Wichita
Call Kansas One-Call at Least Two
Working Days Before Work Begins