

MEDIAL RECONSTRUCT CENTRAL AVE & WACC AVE CENTRAL AVE WIDENING

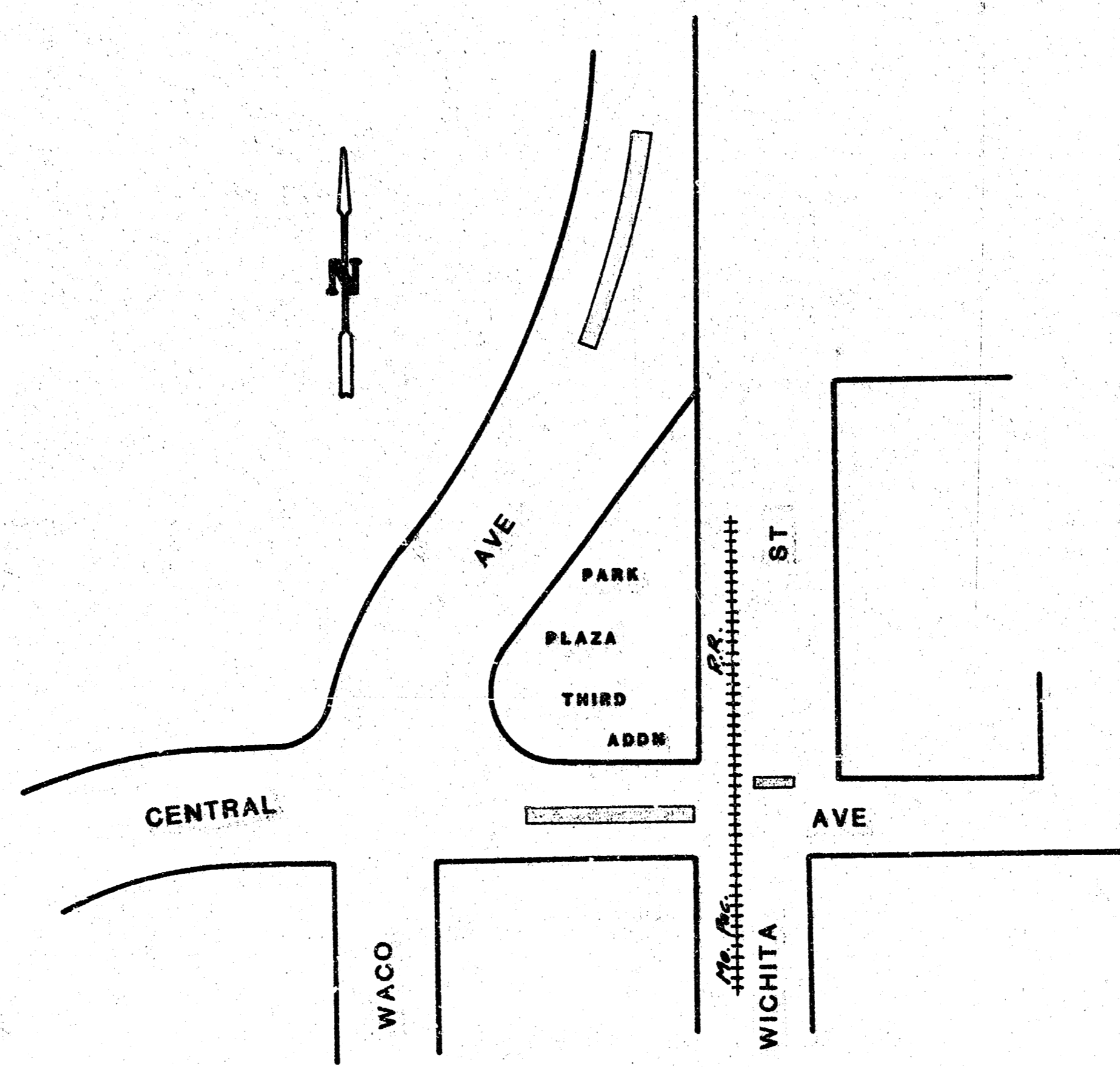

Note: Traffic Shall Be Carried Through Construction.

THE CONTRACTOR SHALL BE RESPONSIBLE FOR PRESERVING PROPERTY IRONS. THE CONTRACTOR SHALL BE REQUIRED TO RE-ESTABLISH ANY PROPERTY IRONS WHICH ARE DAMAGED OR DESTROYED BY HIS CONSTRUCTION OPERATIONS. SUCH IRONS SHALL BE RE-ESTABLISHED BY A LICENSED LAND SURVEYOR OR A LICENSED PROFESSIONAL ENGINEER IN ACCORDANCE WITH STATE LAWS.

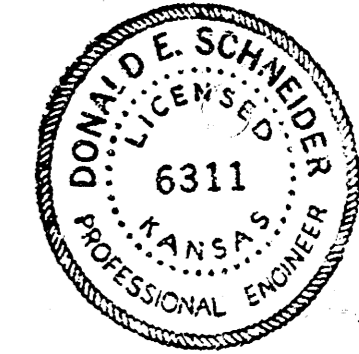

PROJECT DESCRIPTION		
PROJECT NUMBER 472 76 245 81206 000 000 001		
BOOK NO.	APPROVED BY	DATE
DRAWN BY <i>KEK</i>		REVISED 1/3
CITY OF WICHITA DEPARTMENT OF ENGINEERING		
DIRECTOR OF ENR./CITY ENGINEER R. W. BRUGGEMAN		SCALE

BM = 111.75 - RR Spike N. Fa. PP @ SE Cor.
Waco & Third.

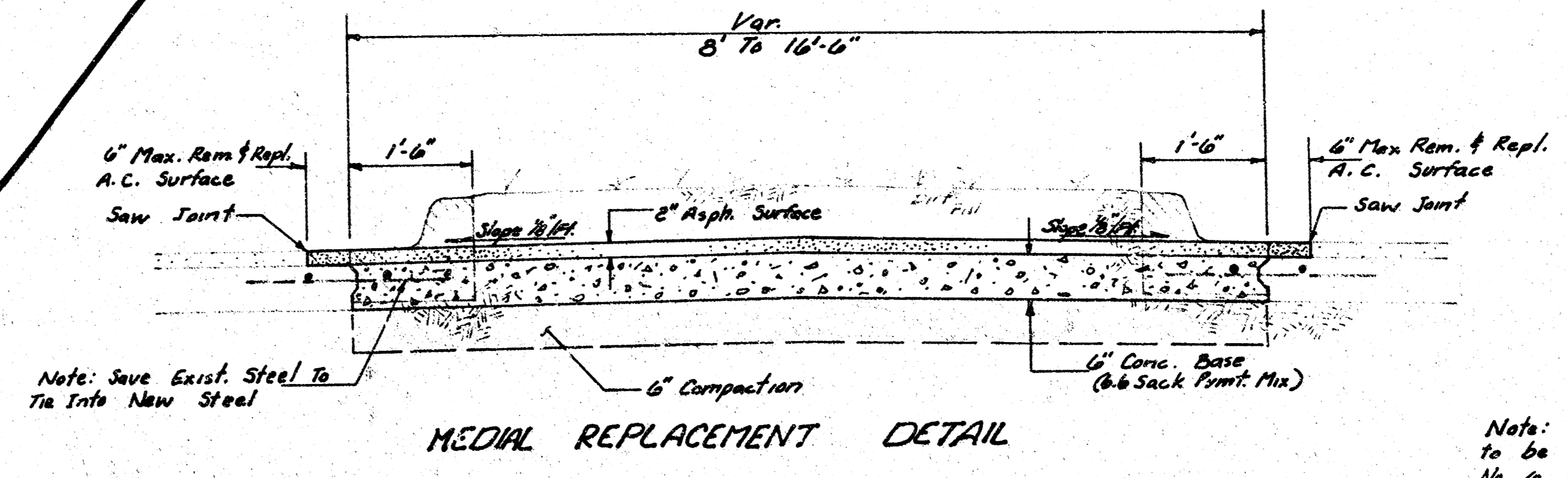
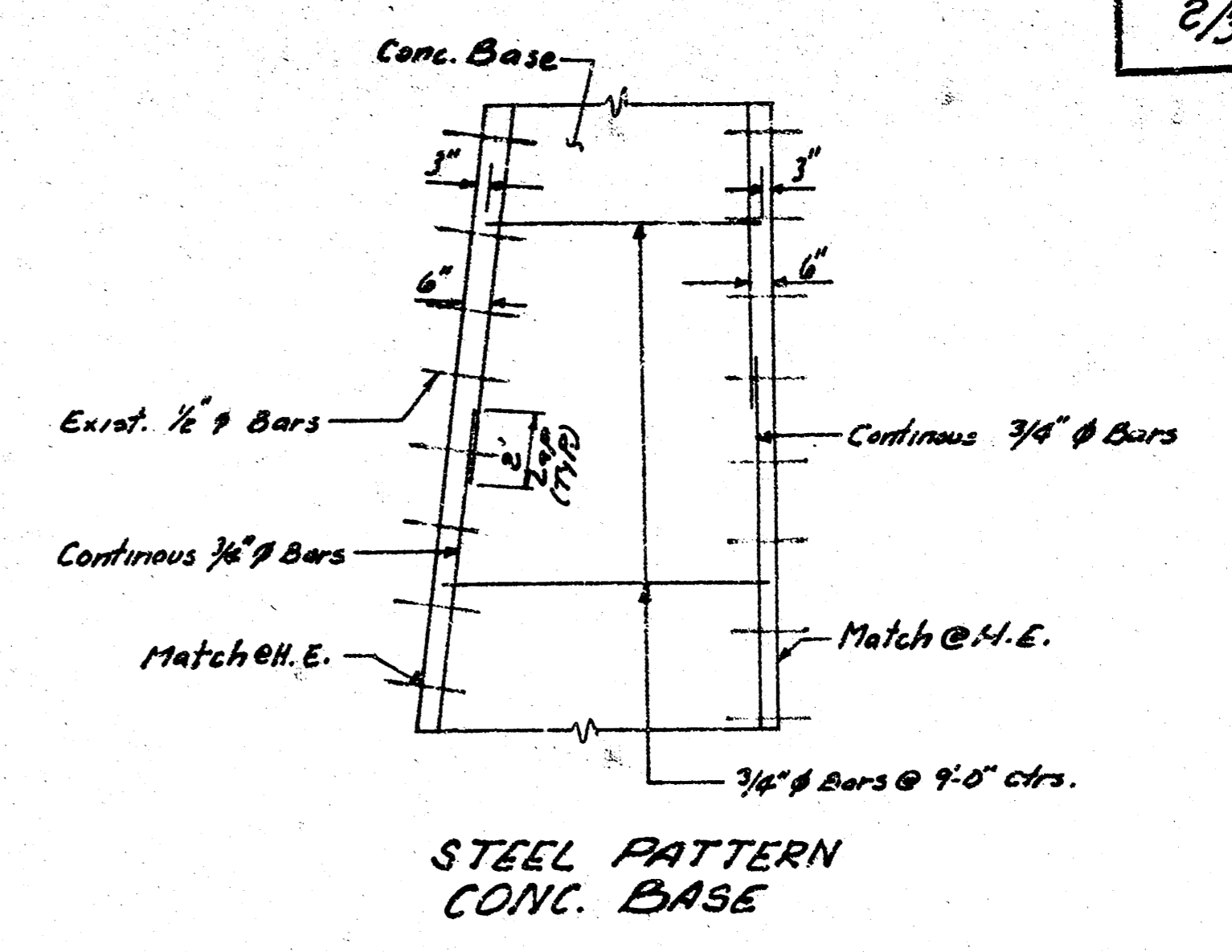
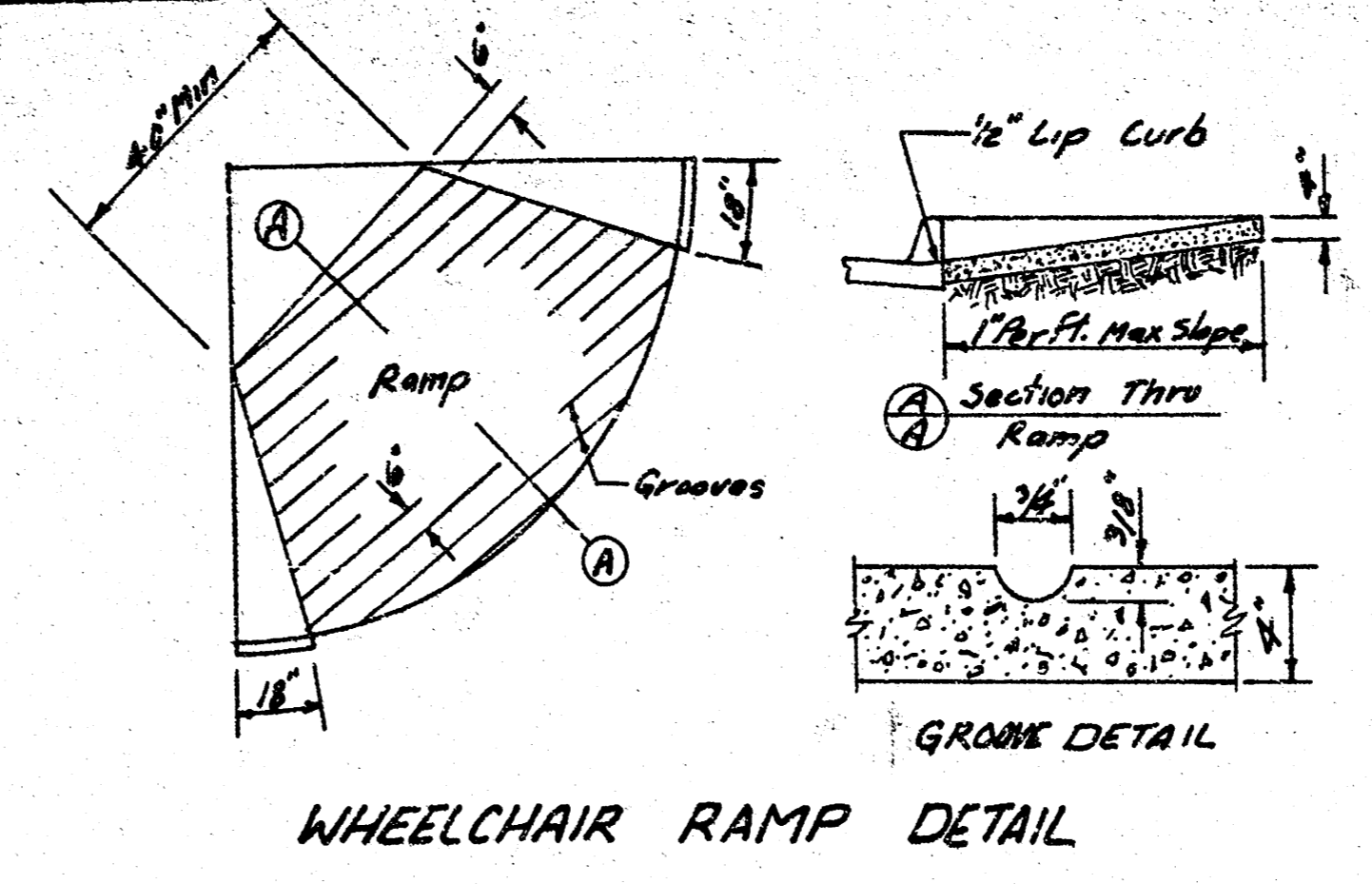
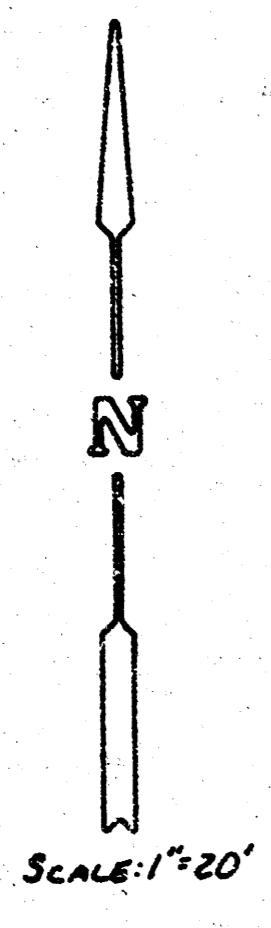

Note: Save Exist. Steel To Tie Into New Steel

Note: Steel pattern for 8" conc. pmt. to be determined in the field using No. 6 Bars. Save all exist. steel to tie into new steel. New steel to have min. rate of 3.5 lb./sq. yd.

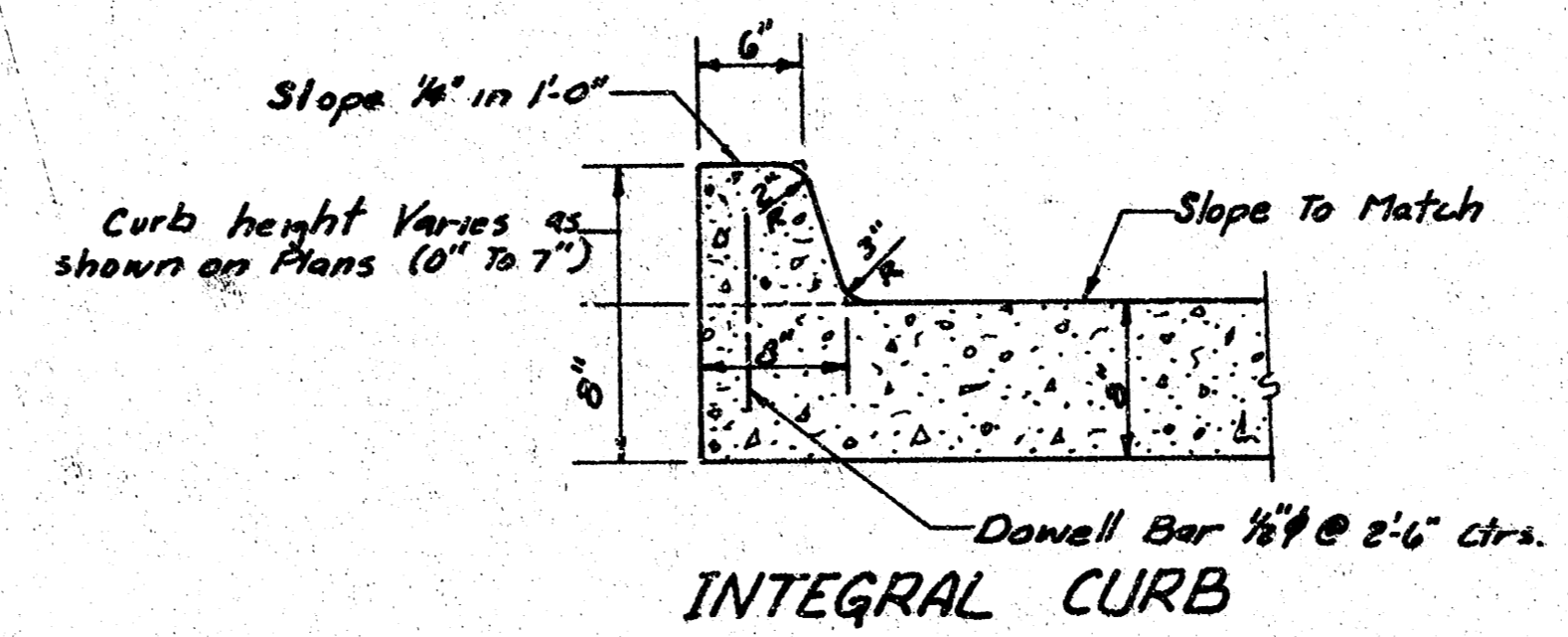

Note: Contraction joints shall be cut in the integral curb to the pavement with a uniform spacing of not more than 10'. Expansion joints shall be installed at radius points. Calculate dowell bars when curb heights are less than 3". Curb shall be constructed monolithically with pavement when height is less than 3".

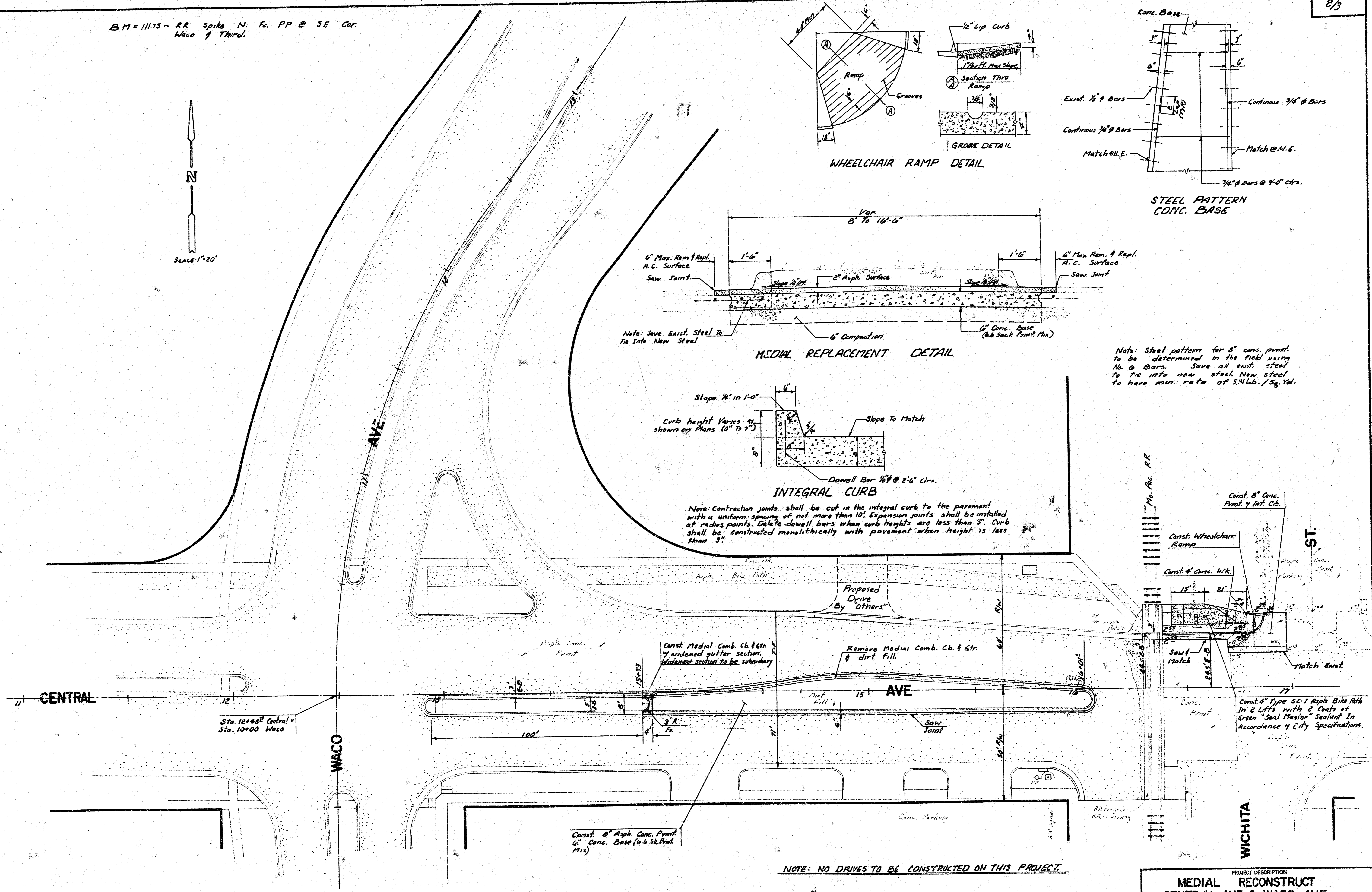

NOTE: NO DRIVES TO BE CONSTRUCTED ON THIS PROJECT.

PROJECT DESCRIPTION
**MEDIAL RECONSTRUCT
 CENTRAL AVE & WACO AVE
 CENTRAL AVE WIDENING**
 PROJECT NUMBER
 472 76 245 81206 000 000 001 2/3

BM = 116.72 ~ 2" Cut Top Curb S. End Of Medial
E Waco N. L. Murdock

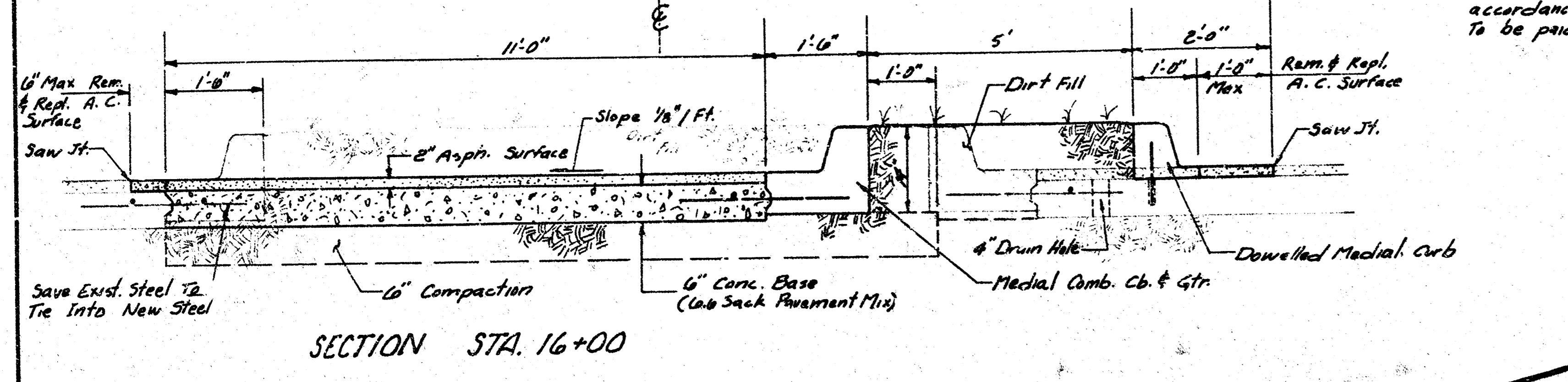
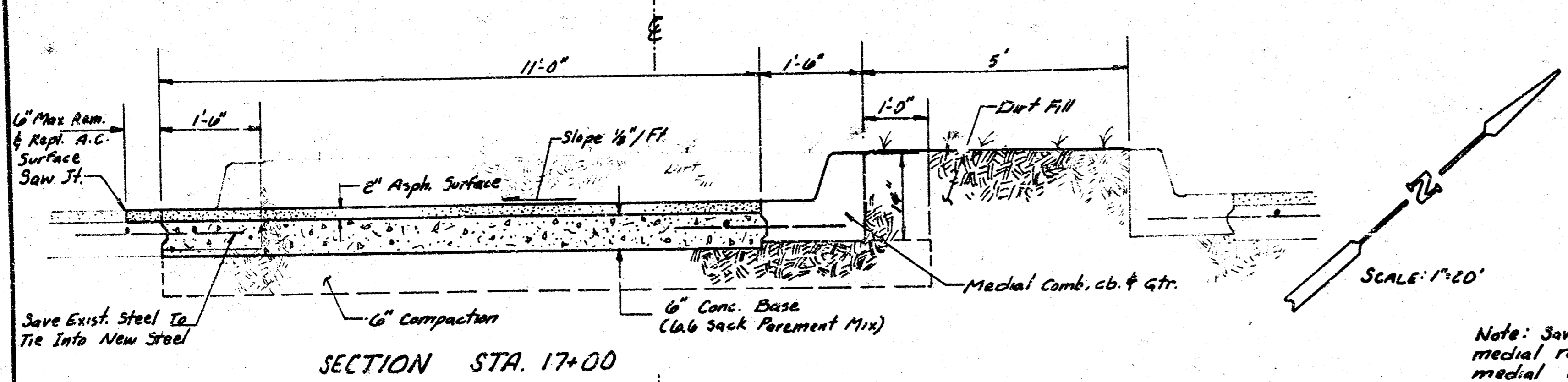

Note: Save enough grass sod from medial removal to cover all new medial construction. Place in accordance with Park Dept. Specs. To be paid as "Lump Sum Grass Sodding."

SCALE: 1"=20'

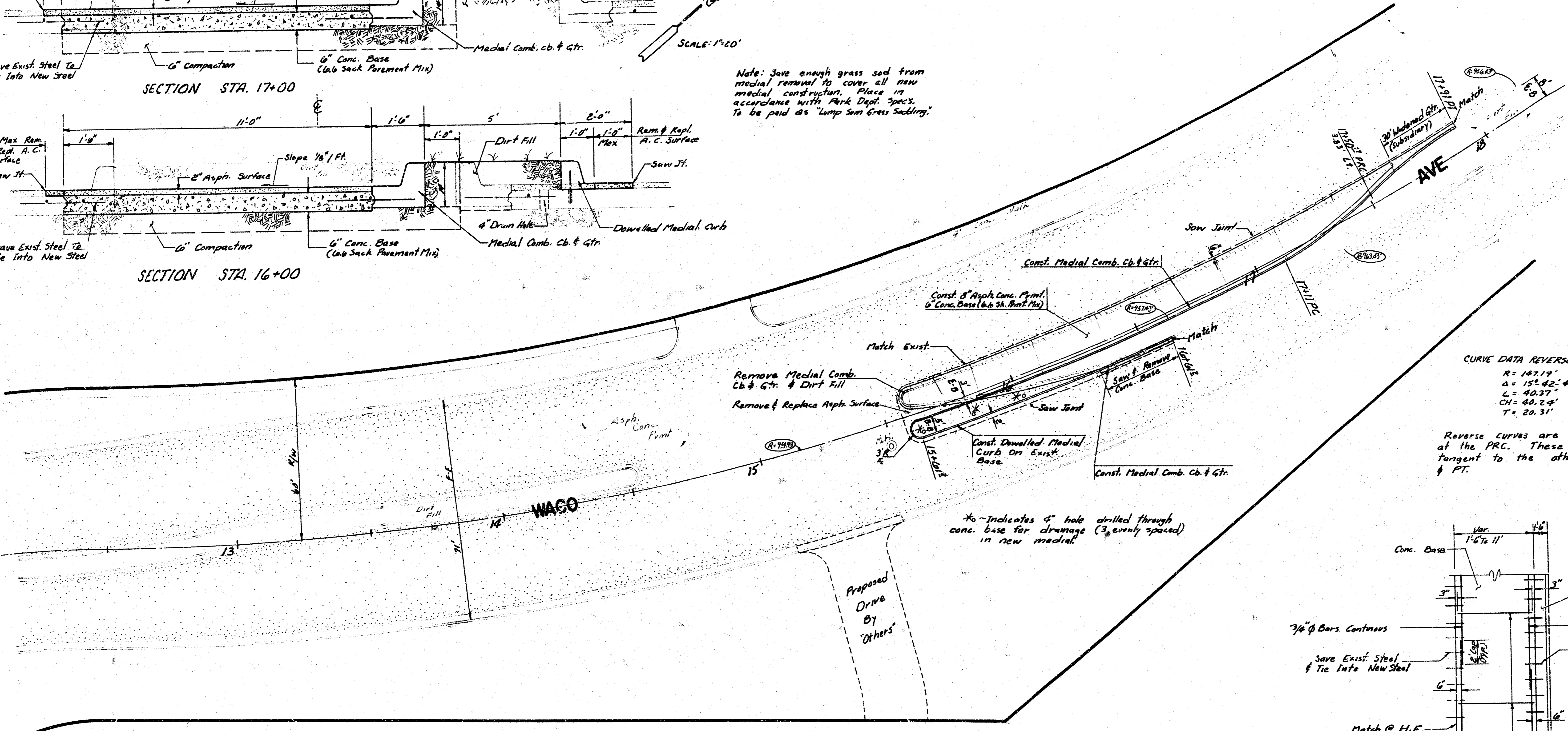

CURVE DATA REVERSE CURVE (Medial)

R = 147.19'
 Δ = 15° 42' 45"
 L = 40.37'
 CH = 40.24'
 T = 20.31'

Reverse curves are tangent to each other at the PRC. These reverse curves are not tangent to the other curves at the PC & PT.

*o indicates 6" hole drilled through conc. base for drainage (3 evenly spaced) in new medial.

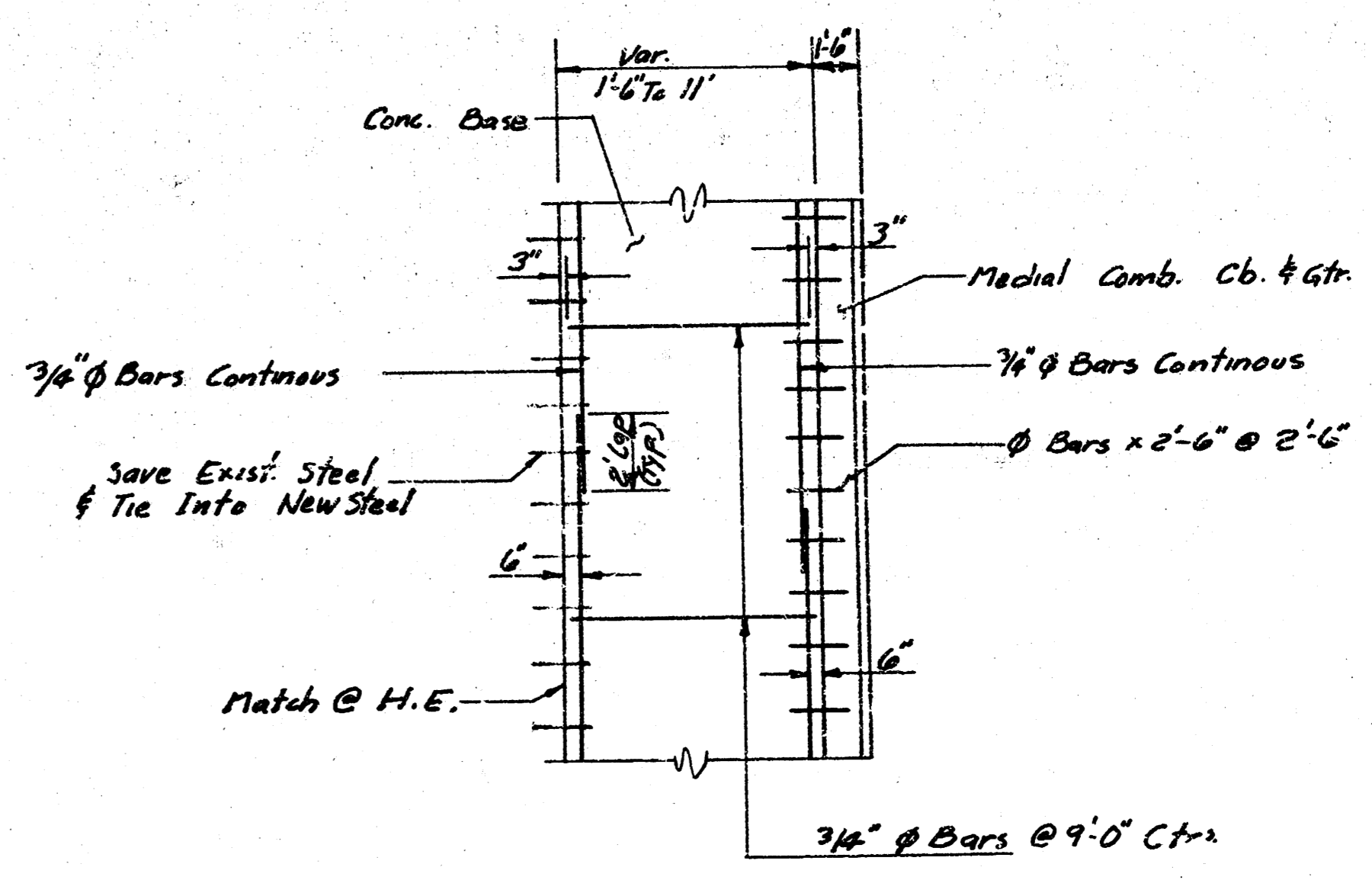

STEEL PATTERN CONC. BASE

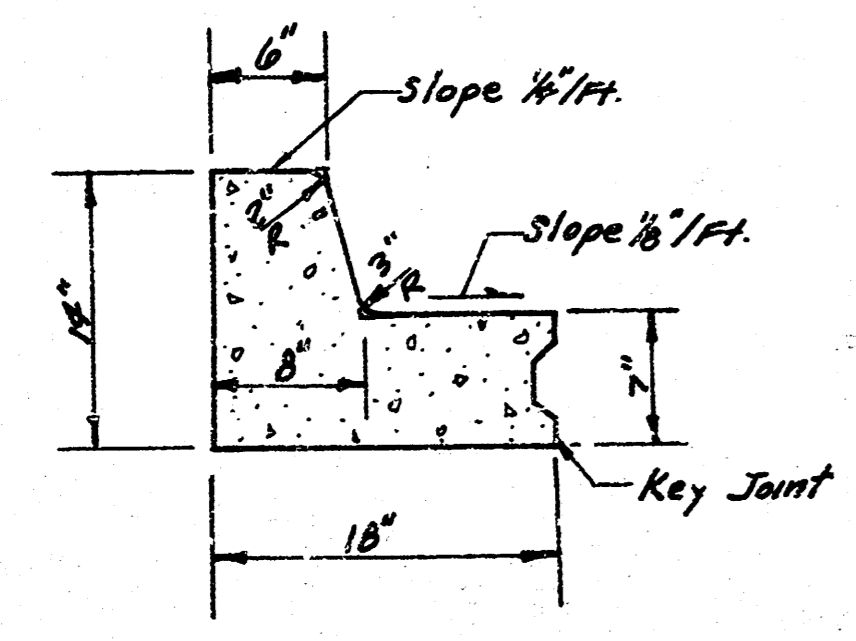

MEDIAL COMB. CURB & GTR.

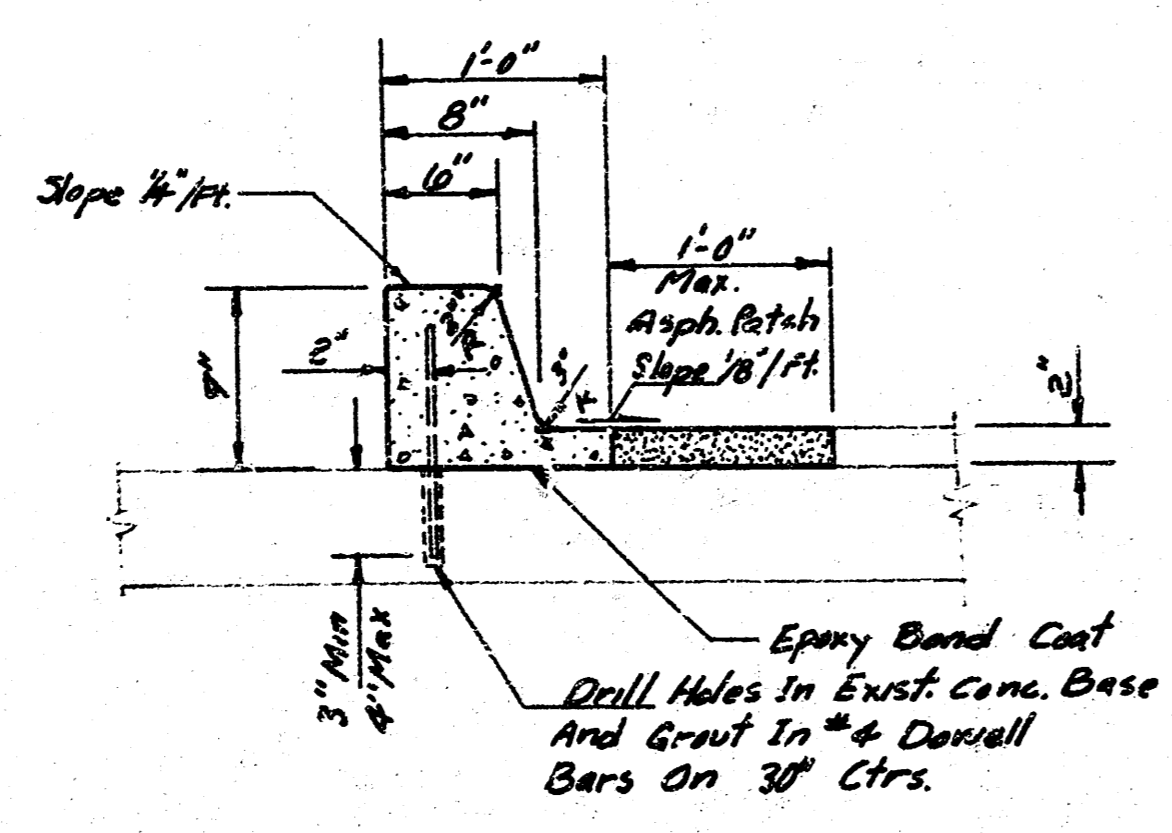

DOWELLED MEDIAL CURB

Note: Construction joints shall be constructed in the Medial Comb. Cb. & Gtr. and the dowelled Medial Curb with a uniform spacing of not more than 10'. These joints may be sawed with an approved concrete saw. Saw cuts shall extend a minimum of 2" below the surface of the curb & gutter and then filled with an approved joint filler such that the joint in the gutter section is completely filled. Expansion joints shall be installed at all radius points.

PROJECT DESCRIPTION
MEDIAL RECONSTRUCT
CENTRAL AVE & WACO AVE
CENTRAL AVE WIDENING

PROJECT NUMBER
 472 76 245 81206 000 000 001

10 4 5 1