

CURVE DATA: BASED ON C. R. $R=325'$ $\Delta=12^{\circ}40'$ DEFLECTION=6.13097 MIN./FT.

STATION	8' OFFSET FROM FACE OF NORTH CURB		8' OFFSET FROM FACE OF SOUTH CURB		DEFLECTION	ACCUMULATED DEFLECTION
	ARC	CHORD	ARC	CHORD		
P.C. 3+95	-	-	-	-	-	-
4+25	25.25'	28.24'	29.37'	29.36'	2° 38' 54"	2° 33' 54"
4+50	21.04'	21.04'	24.46'	24.46'	2° 08' 17"	4° 42' 15"
P.T. 4+70	16.84'	16.84'	19.58'	19.58'	1° 42' 37"	6° 24' 50"

GENERAL NOTES:
 1) ALL DISTANCES BASED ON PLATTED DISTANCES UNLESS MARKED OTHERWISE. FIELD MEASURED DISTANCES WILL BE DENOTED BY THE SYMBOL (M) FOLLOWING THE MEASUREMENT.
 2) CONTRACTOR TO CLEAR RIGHT-OF-WAY & GRADE PARKING FOR PROPOSED SIDEWALKS. SIDEWALKS TO BE PLACED BY OTHERS.

B.M. EL. 170.05 "O" CUT TOP C. CL. DOREEN @ 4. END RADUS ON S.E. COR. RUTLAND & DOREEN.
 B.M. EL. 169.77 "R" IN RITCHIE TOP N. CL. RUTLAND RD. 140' N. OF N.L. DOREEN SOUTH.
 BASELINE ON SOUTH FE.

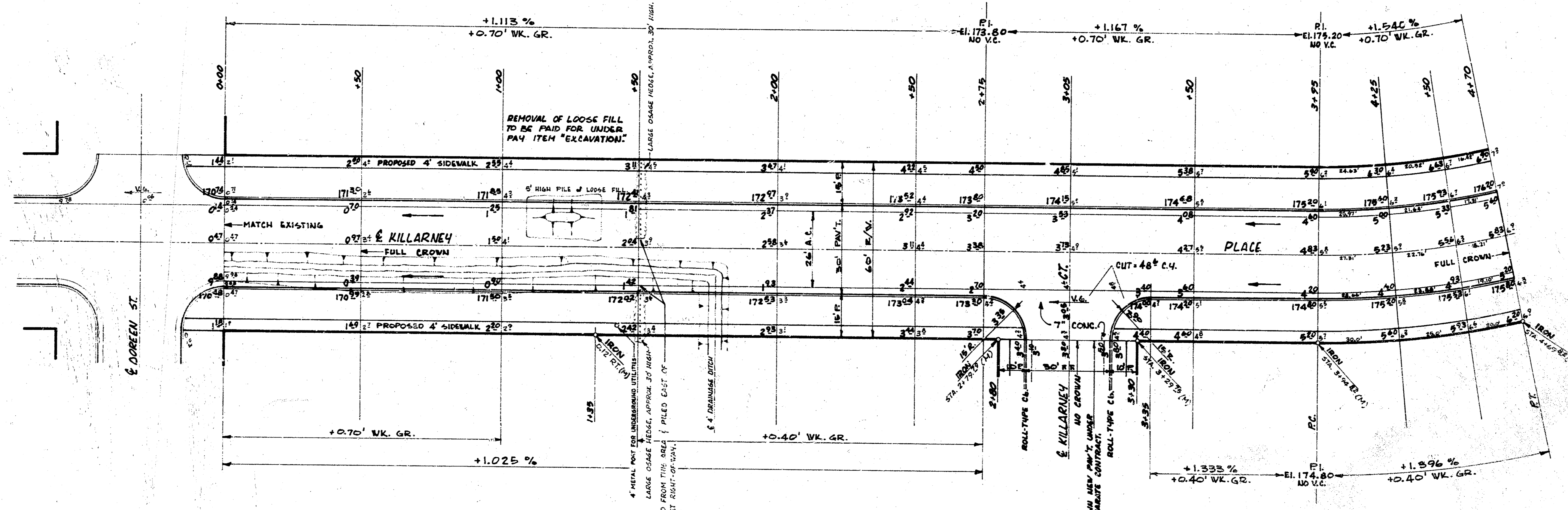

EARTHWORK

	EXCAVATION		COMP. FILL
	PROPERTY	CITY	PROPERTY
FLUG 10%	1,491.2 C.Y.	91.4 C.Y.	8.7 C.Y.
TOTAL	1,640.3 C.Y.	100.5 C.Y.	9.6 C.Y.

KILLARNEY PLACE E.L. DOREEN TO E.L. LOT 10
 WOODLAWN EAST, 2ND ADDITION.

26'-2'-30" ASPH. CONC.
CITY of VICHITA, KANSAS.
 B.E. SMITH CITY ENGINEER

DATE: SEPT., 1968 PROJECT NO. C18-77
 SHEET 1 of 2

SURVEY: J.E.S.
 PLAN: C.E.S.
 EXP: C.E.S.
 CHECKED:

