

B.M. 103.20 T in tray. Fire Hydrant. N.W. Cor. Santa Fe & Kinkaid.

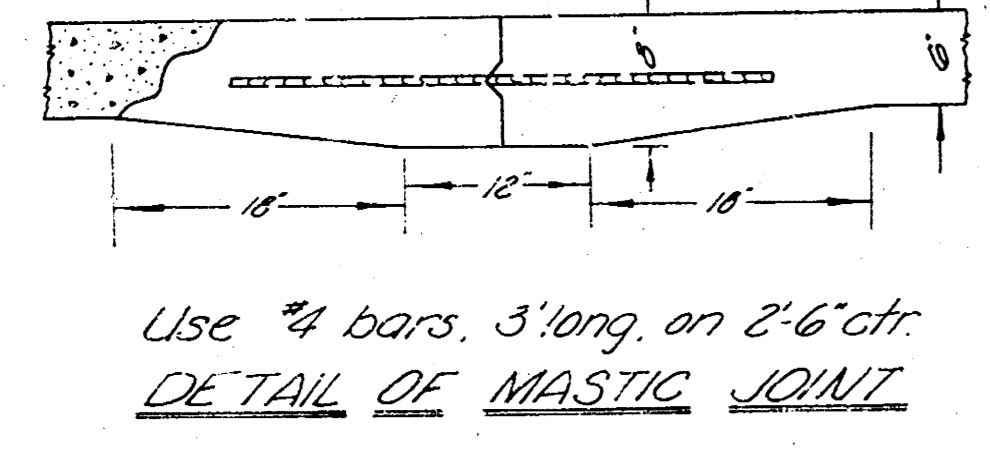

Notes:
Removal of conc. block curb 15' S. of & is to be considered as part of the excavation bid price.

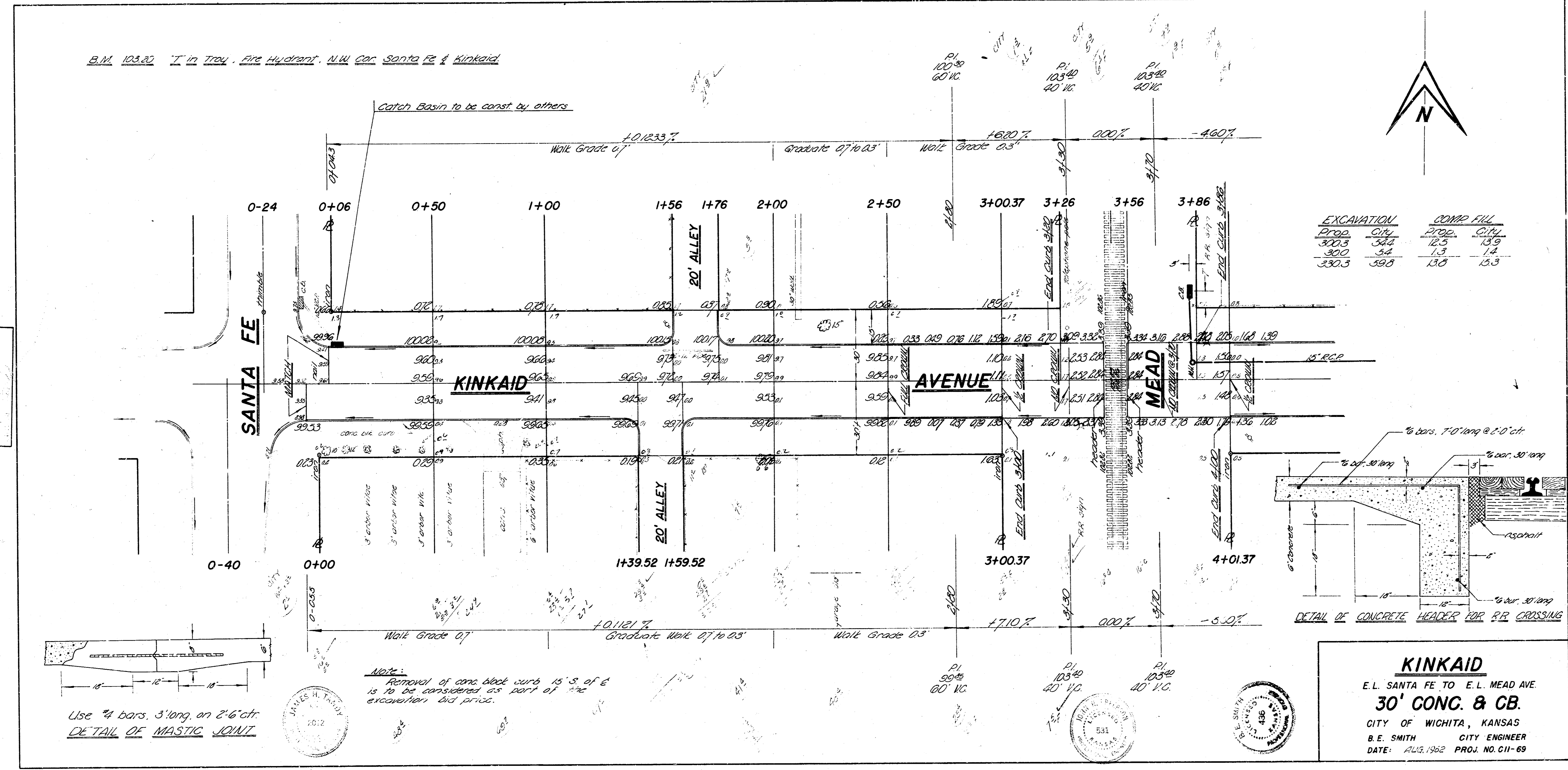
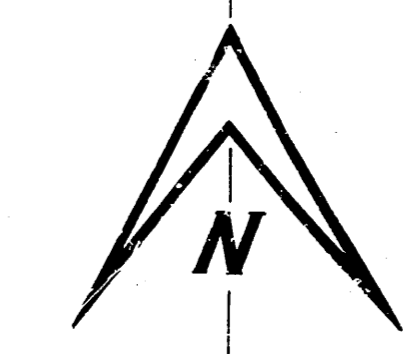
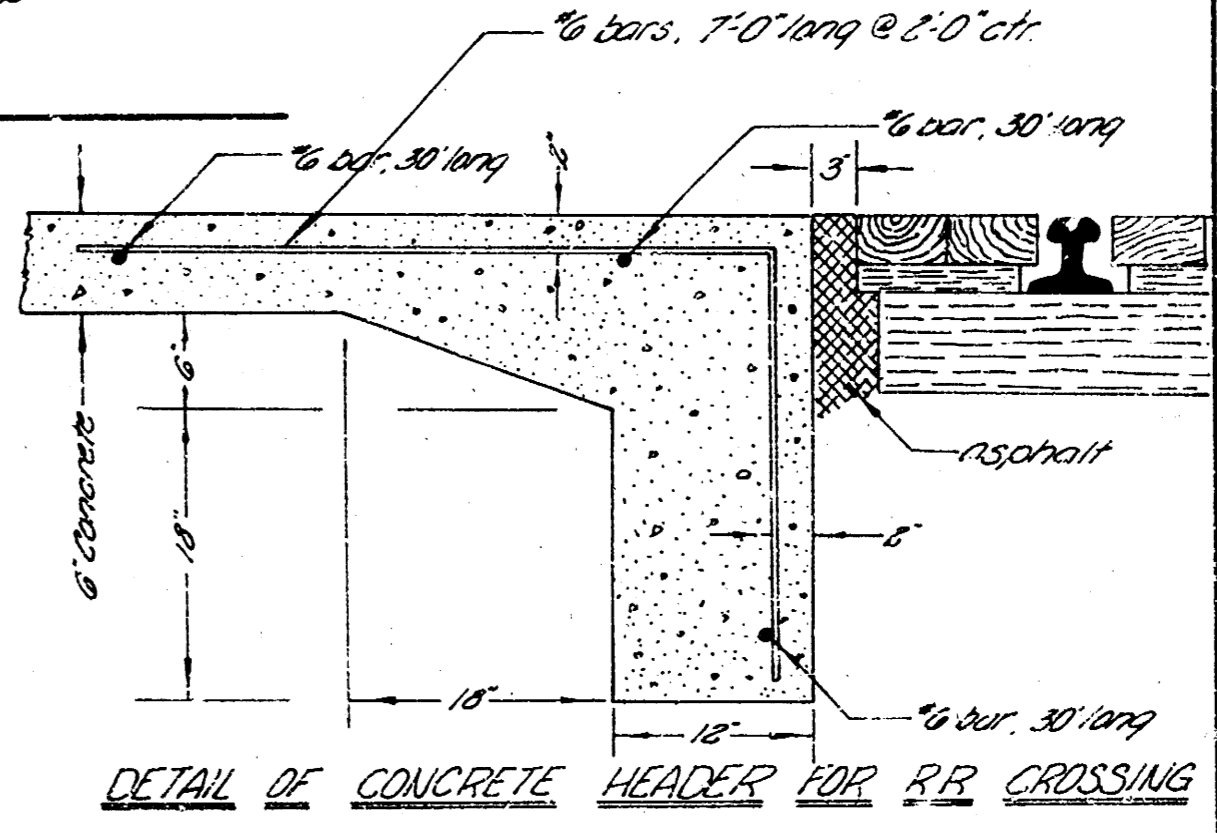
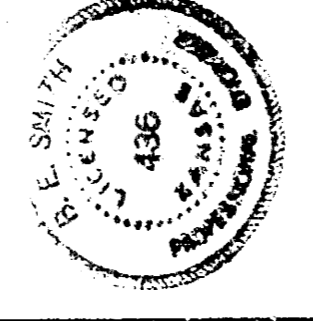

KINKAID
E.L. SANTA FE TO E.L. MEAD AVE
30' CONC. & CB.
CITY OF WICHITA, KANSAS
B.E. SMITH CITY ENGINEER
DATE: JUL 2, 1962 PROJ. NO. CI-69