

B. M. 97.67 iron in thimble @ E. Kinkaid & E. L. Hillside Terrace Addr. & 9866' W. of W. L. Lorraine.  
 Stationing on E. Kinkaid Ave.

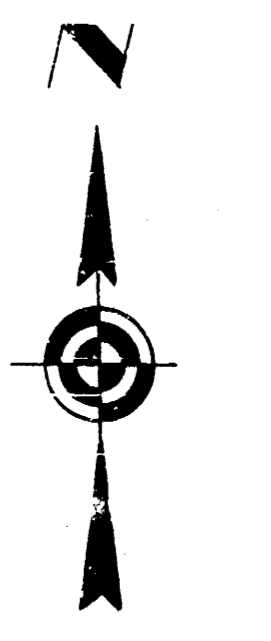

Survey J. K. BK Y-192  
 Plan ✓  
 Elevation ✓  
 Check ✓  
 Notes ✓

	<b>EARTHWORK</b>	<b>PROP.</b>
CITY	222	355.5
	2.2	35.6
24.4 cu. Yd.		391.1 cu. Yd.

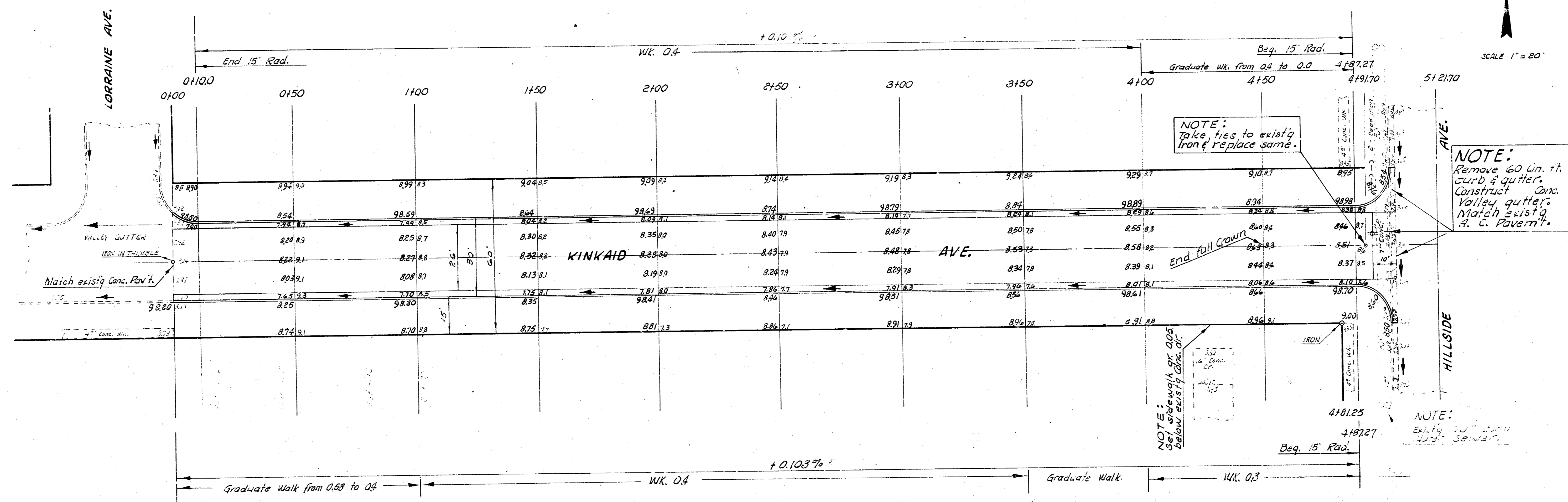
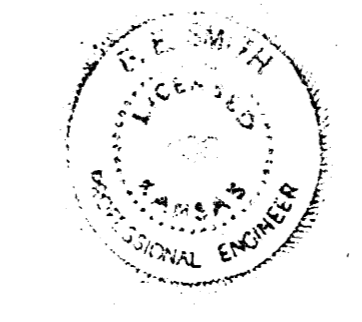

**KINKAID AVE.**  
 EL LORRAINE TO WL HILLSIDE  
 26'-2'-30 A. C.  
 CITY OF WICHITA, KANSAS  
 B. E. SMITH CITY ENGINEER  
 AUG. 1960 , PROJ. NO. C10-92