

B.M. 38.26 "M" in Mueller, Fire Hyd, NW cor Kinkaid & Green
 B.M. 37.23 "R" in Ritchie, E end road, NE cor Volusia & Kinkaid
 Stationing on S. R.

Excavation

Prop	City
Exc	Fill
2,286.6	183.3
+10% 228.7	0
2,515.3	183.3
Total	Total
2,515.3	183.3

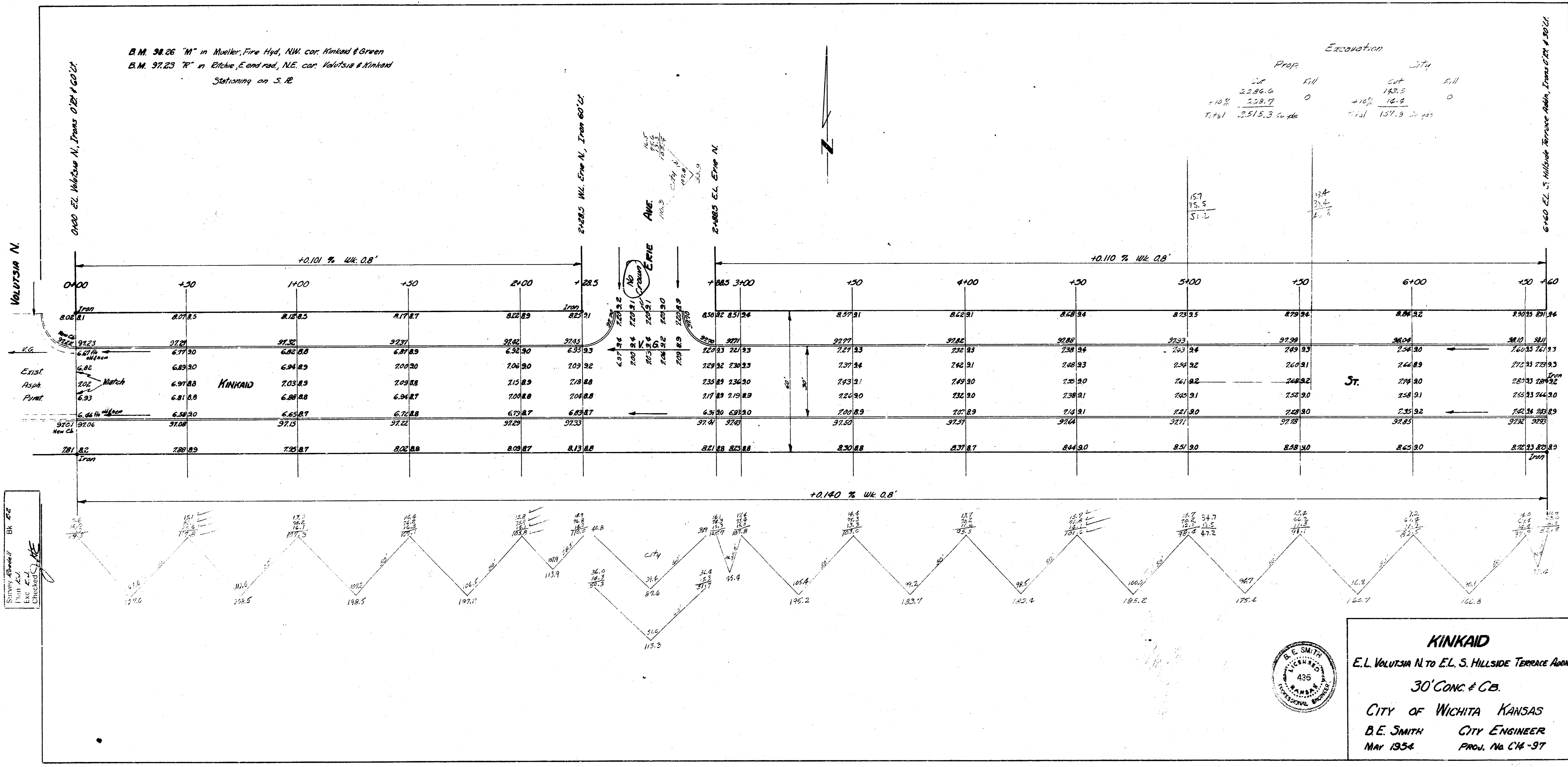

Survey Ground BK 82
 Plan 2-1
 City of Wichita
 Engineering



KINKAID
 E.L. Volusia N to E.L. S. Hillside Terrace Abdn
 30' CONC. & C.B.
 CITY OF WICHITA KANSAS
 B.E. SMITH CITY ENGINEER
 May 1934 PROJ. No. C14-37