

B.M. 99.50 Iron in thimble N.L. Kinkaid & Topeka  
 B.M. 100.08 "J" in Jones Dr. W.E. N.W. cor. Topeka & Kinkaid

NOTE: Base line, back side 4' W.E. N.S.  
 of Kinkaid, stationed from N. to E.

0+33.2 18" Elm 40' Ely to face

0+91 Power pole 48' Ely to face  
 1+02 24" Elm 10' Ely to face

1+48.5 Gar. Door 66' Ely

1+82.6 12' x 12' W.E. Dr. 20' W.E. N.E.  
 1+88 Power pole 48' Ely

1+56 M.K. 20' Ely & M.H.  
 1+57.6 12' x 12' W.E. Dr. 20' W.E. N.E.

1+82 Conc. steps 46' 58" Ely

1+98 12' Elm 47' Ely

2+54 Power pole 47' Ely

Prop.	Excav.
32.4	1.6
41.1	5.4
51.0	19.9
51.6	34.7
44.6	3.5
37.0	
8.3	
264.0	
+10%	
264.0	
Total	277.6 Cu. yds.

NOTE TO FIELD ENGINEER  
 Count trees removed & turn in report.

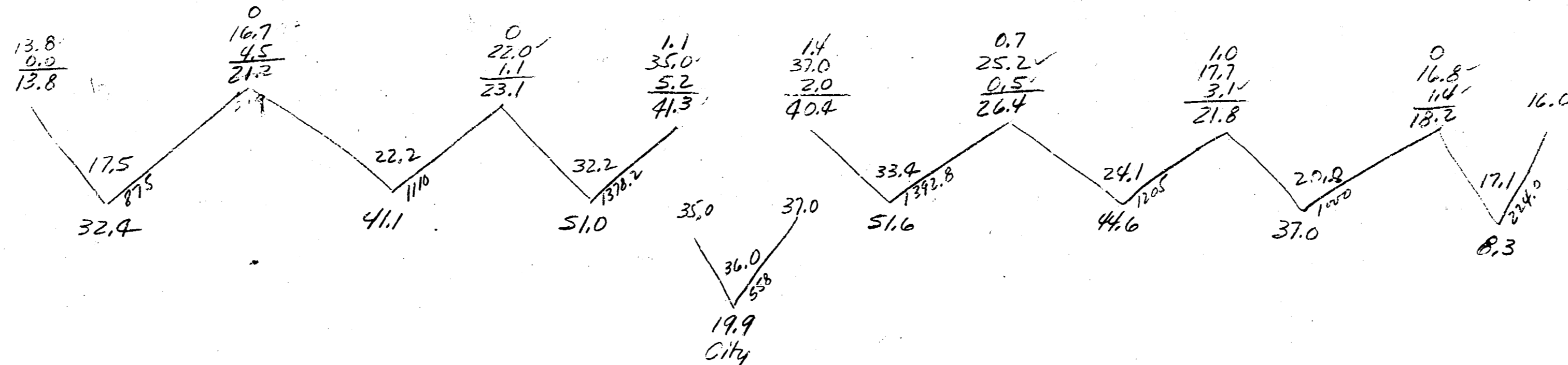
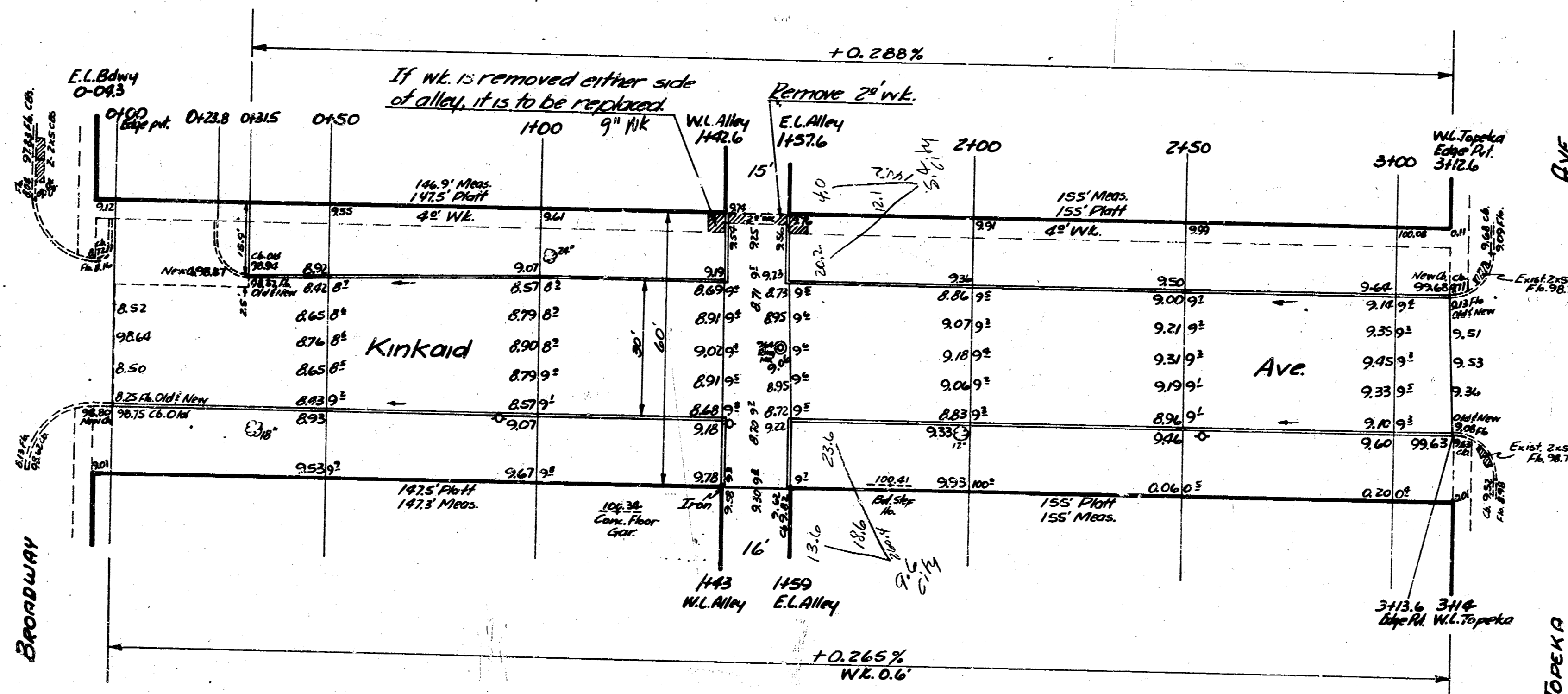

Checked  
 B.E. Smith



KINKAID AVE.  
 EL. BROADWAY TO W.L. TOPEKA  
 30' CONC & CB

CITY OF WICHITA, KANSAS  
 B.E. SMITH City Engineer  
 JAN. 15, 1953 Proj. No. C12-178