

D.M. 115.11' ON R.C.D. U.S. 54 & SHERIDAN N.
 D.M. 116.41' ON S.C.B. KOLLOGO DR. & E. LEONINE N.
 D.M. 114.83' ON W. HUELLER & P. R.C.D. LEONINE & UNIVERSITY
 BASE LINE SURVEY - CTR. LINE LEONINE ROAD

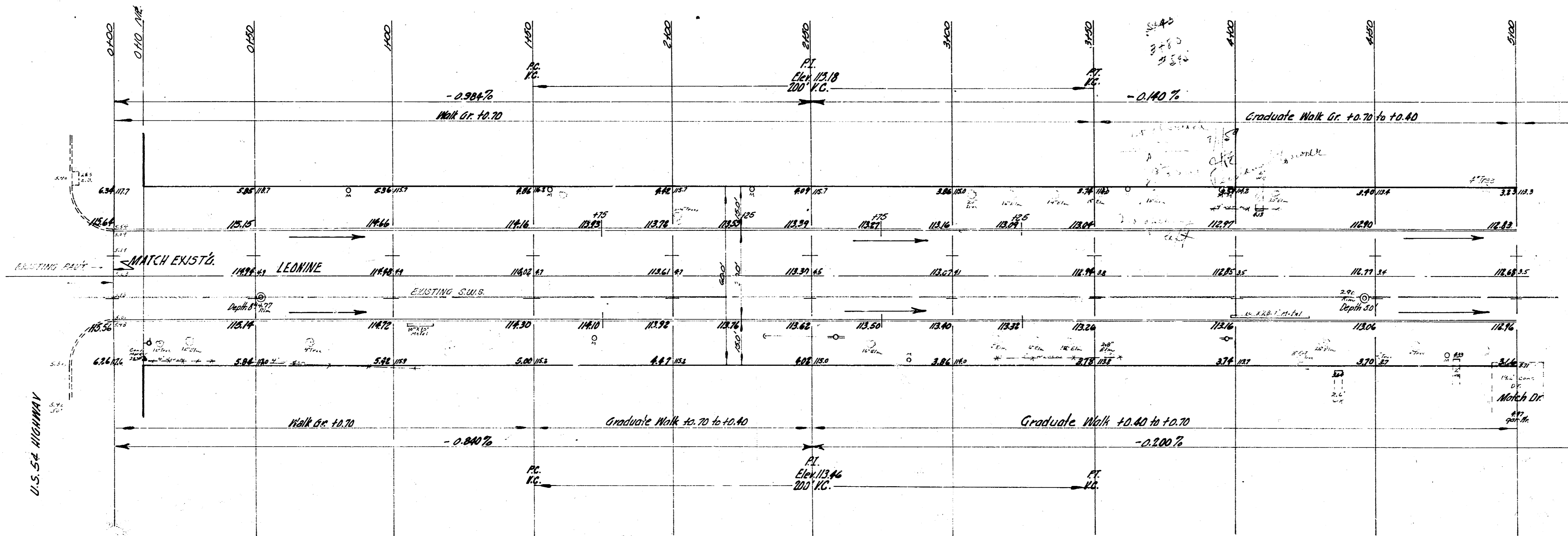

A.M.S.
 11/11/59
 2-10-59

Excavation Totals
 Prop. City
 275.0 11.5
 +0.6 13.0 +0.5 1.4
 1977.9 Cuyler 1.53 Cur. 0.06
 Fill Total
 51
 +0.6 0.2
 18.5 Cuyler.

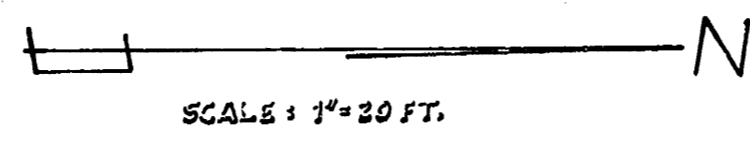

LEONINE ROAD
 U.S. 54 HIGHWAY TO S.W. UNIVERSITY AVE.
 (FROM TRAFF. AVE.)
 300' CONCRETE & CURB
 City of Wichita, Kansas
 B.E. SMITH CITY ENGINEER
 DATE: MAR. 1959 PROJECT NO. CB-105

SHEET 1 of 4

SCALE 1" = 20 FT.

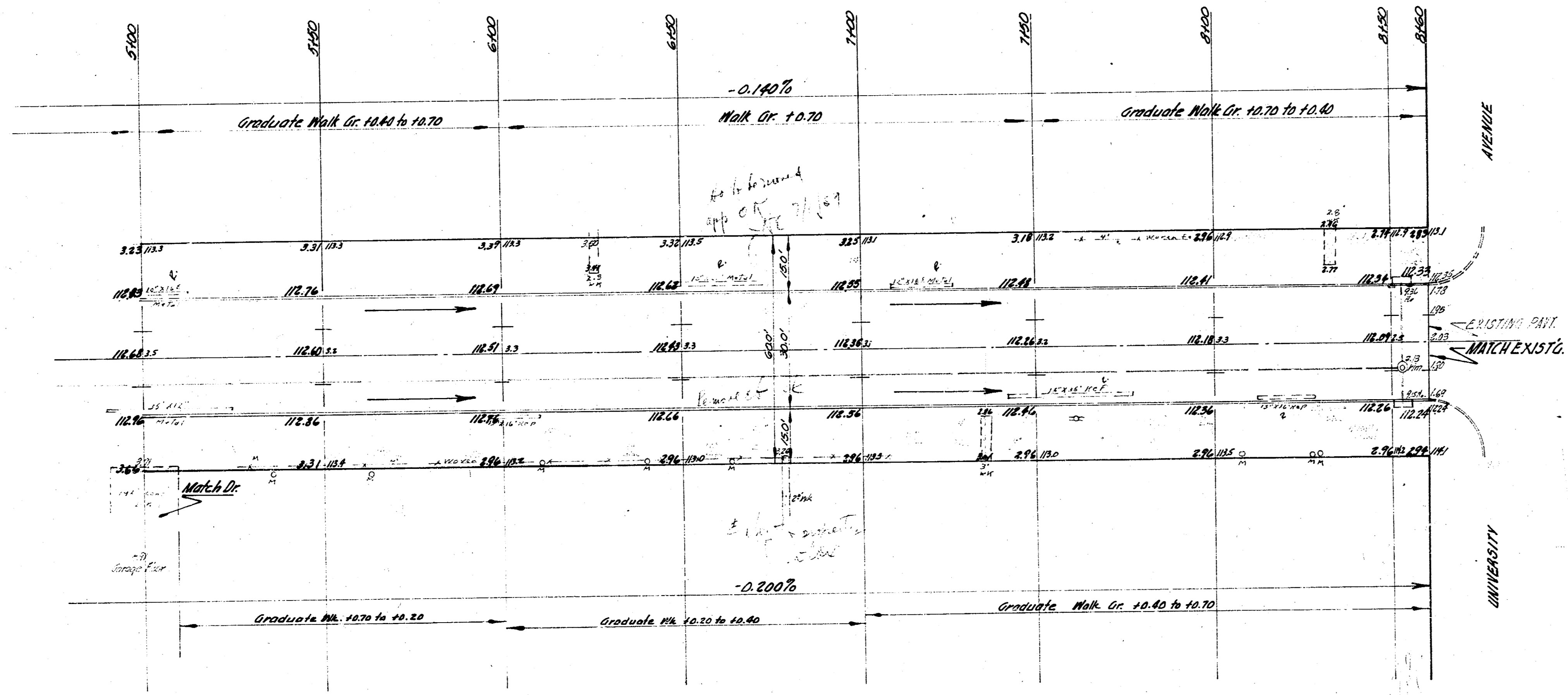

LEOVINE ROAD
 U.S. 54 HIGHWAY S.W. UNIVERSITY AVE.
 PROJECT NO. C18-183
 SHEET 2 of 4
 City of Wichita, Kansas