

BM: 156.36 NW cor Service Station SE cor Oliver & Lincoln

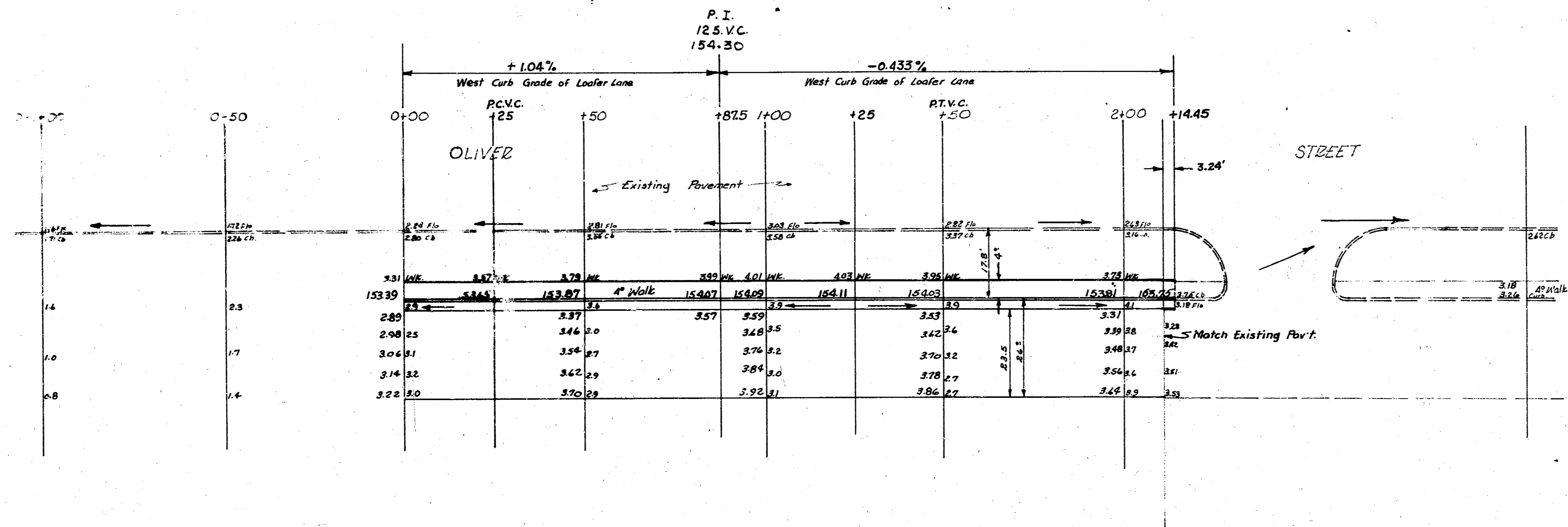

Surveyed by K. G. King
 Checked by G. E. Smith
 Date 10/1/26

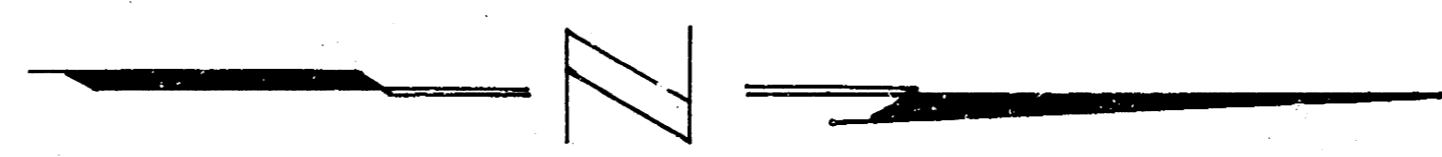
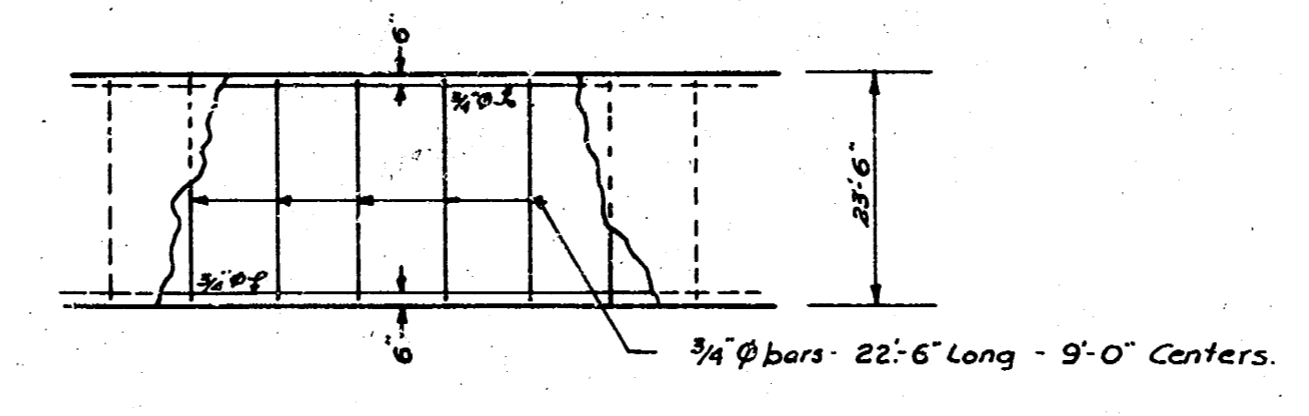
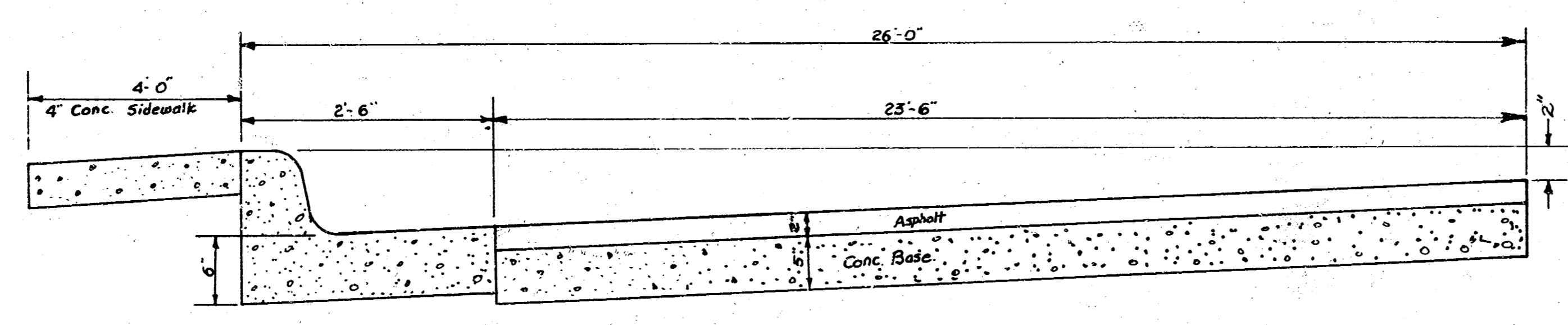

NOTE TO CONTRACTOR
 This project will be constructed under the supervision of the City Engineer and the City Engineer's Office. The City Engineer's Office will be responsible for the design and construction of the project. The City Engineer's Office will be responsible for the design and construction of the project.

Sheet 1 of 2.

LOAFER LANE
 23.5-2-26 A.C.
 CITY OF WICHITA, KANSAS
 B.E. SMITH CITY ENGINEER
 PRIVATE JOB



B.M. 156.35 @ N.W. Cor. Service Station, S.E. cor. Oliver & Lincoln

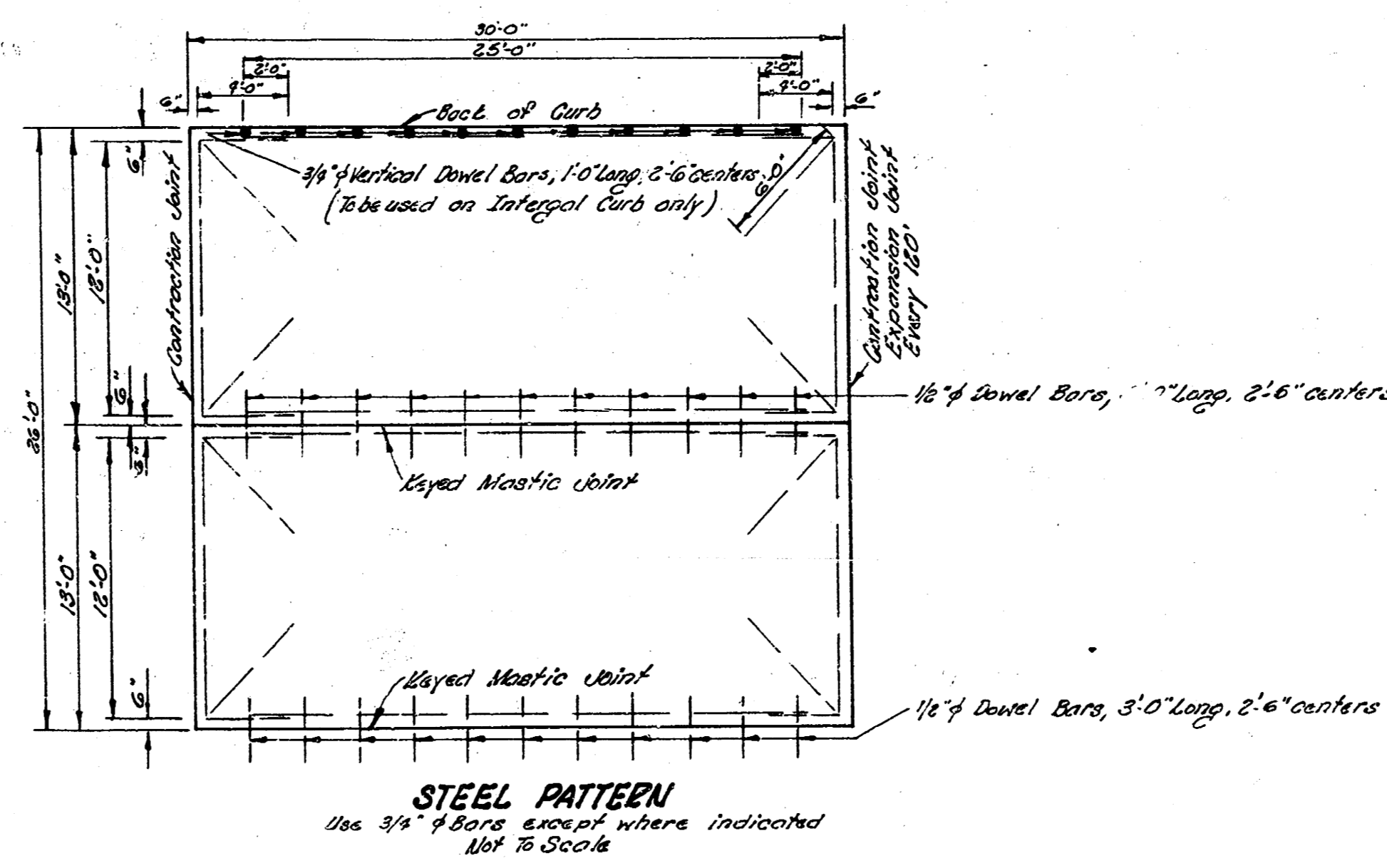
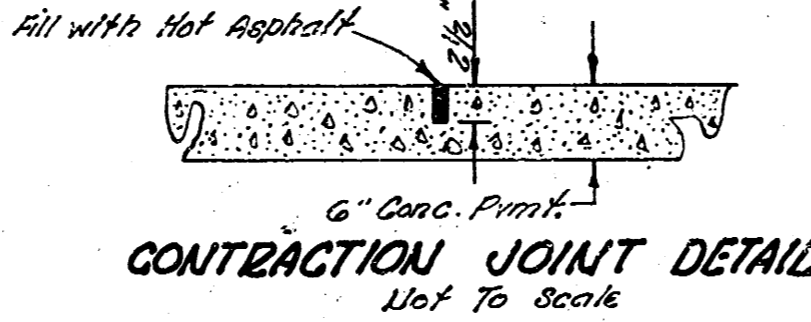
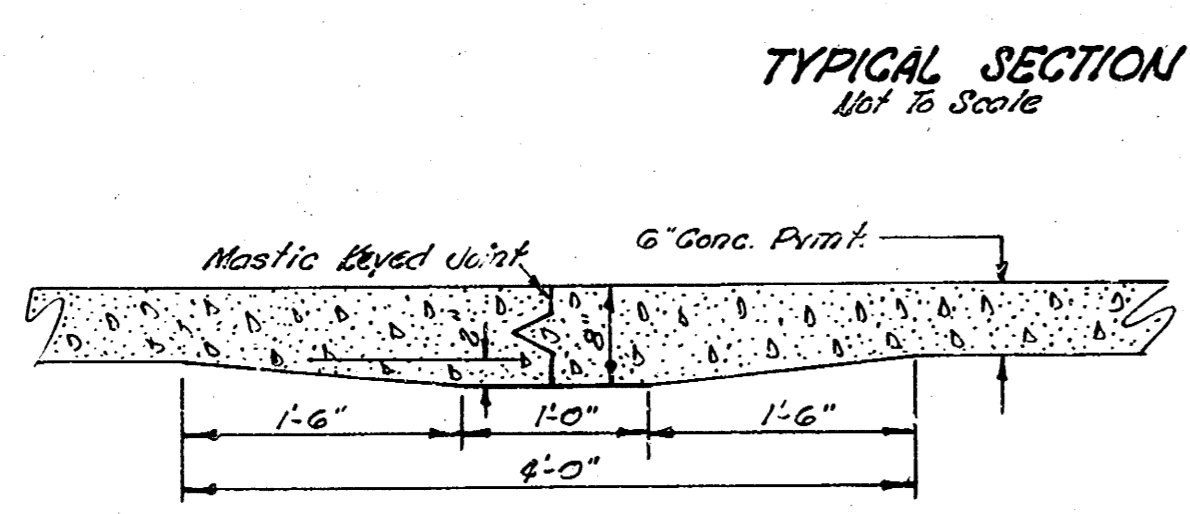
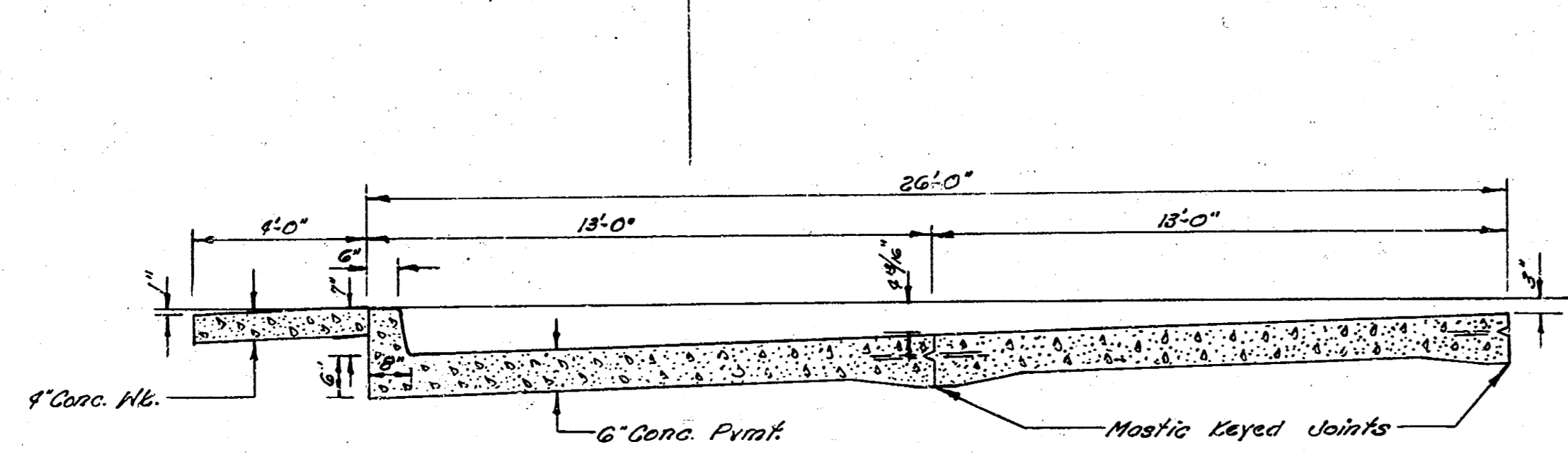
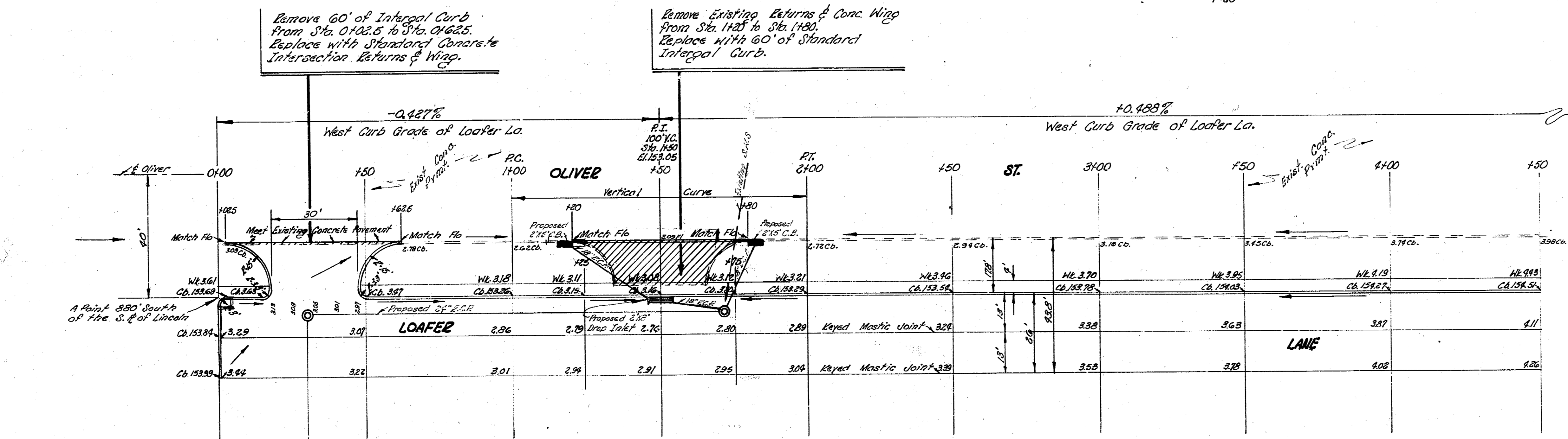
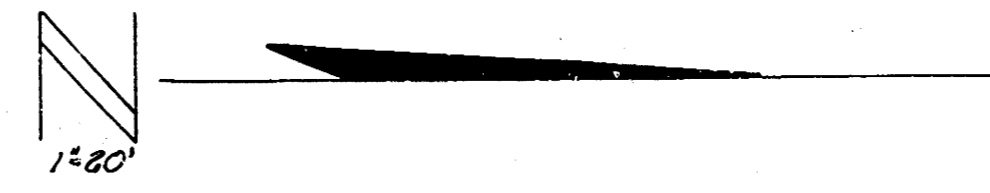

NOTE TO CONTRACTOR

This project will be constructed under the supervision of the City Engineer and conforming to the Specifications of the City of Wichita. The Contractor will reimburse the City of Wichita for all cost of Engineering, Plans and Inspection.



LOAFEE LANE
 FROM 880' S. OF S. LINCOLN, NORTH 760'
 36' CONC. & C.B. - 4' CONC. W.C.

CITY OF WICHITA, KANS.

B.E. SMITH
 Oct. 1954

CITY ENGINEER
 PRIVATE PROJECT

B.M. 156.35
 Survey
 Exc.
 Checked

