

B.M. 102.34 S.W. cor. cor. Parch No. \* 1444 Lydia.

SCALE 1"=20'

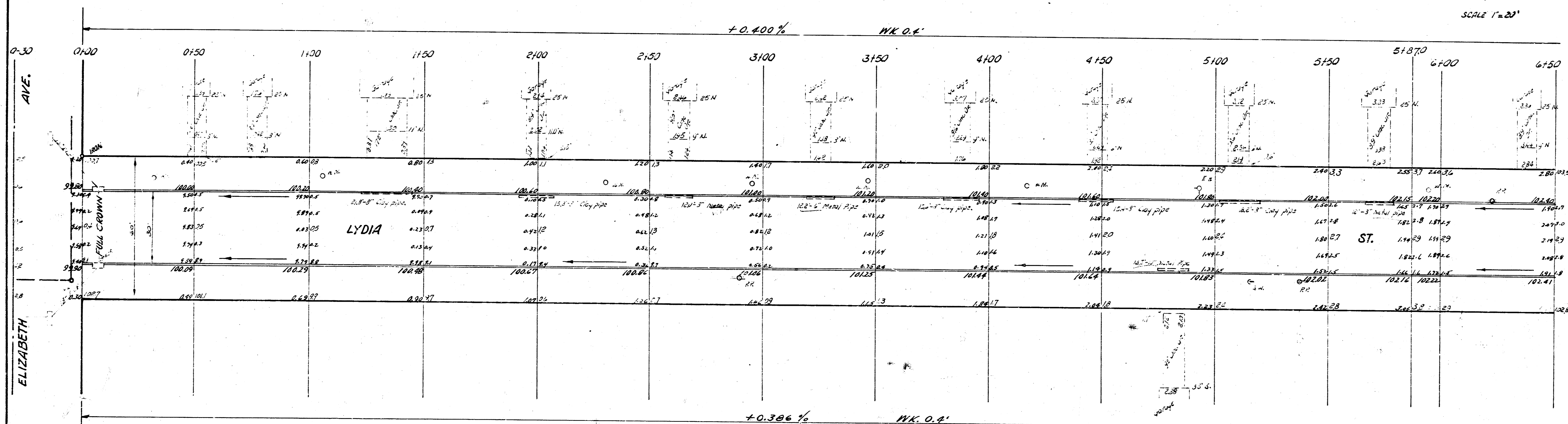

ELIZABETH AVE.

NOTE: MATCH ALL DRIVES SHOWN ON PLAN

Prof. 2345.3  
 Excavation  
 100' 200' 300' 400' 500' 600' 700' 800' 900' 1000'

**LYDIA ST.**  
 NL SENECA to EL ELIZABETH  
 30' CONC. & CB.  
 CITY OF WICHITA, KANSAS  
 B. E. SMITH CITY ENGINEER  
 JUNE 1957 PROJ. NO. C15-8

U.T.C. 10/21  
 U.W. 10/21  
 U.W. 10/21

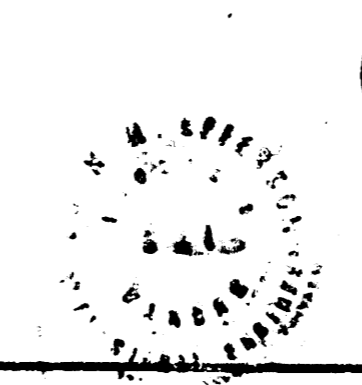

B. M. 104.36 ME. cor. 1st Step It. # 1231 Rita.  
 B. M. 102.83 1/2" Bridge Spike W.S. Power Pole W. S. Seneca at N. Lydia.

