

BM: 103.38 120' spike ES Bell Tel. pole ES Meridian 100' S of SL Grant E.
 BM: 104.43 SE cor lower step No. 11E cor Meridian and Lydia.

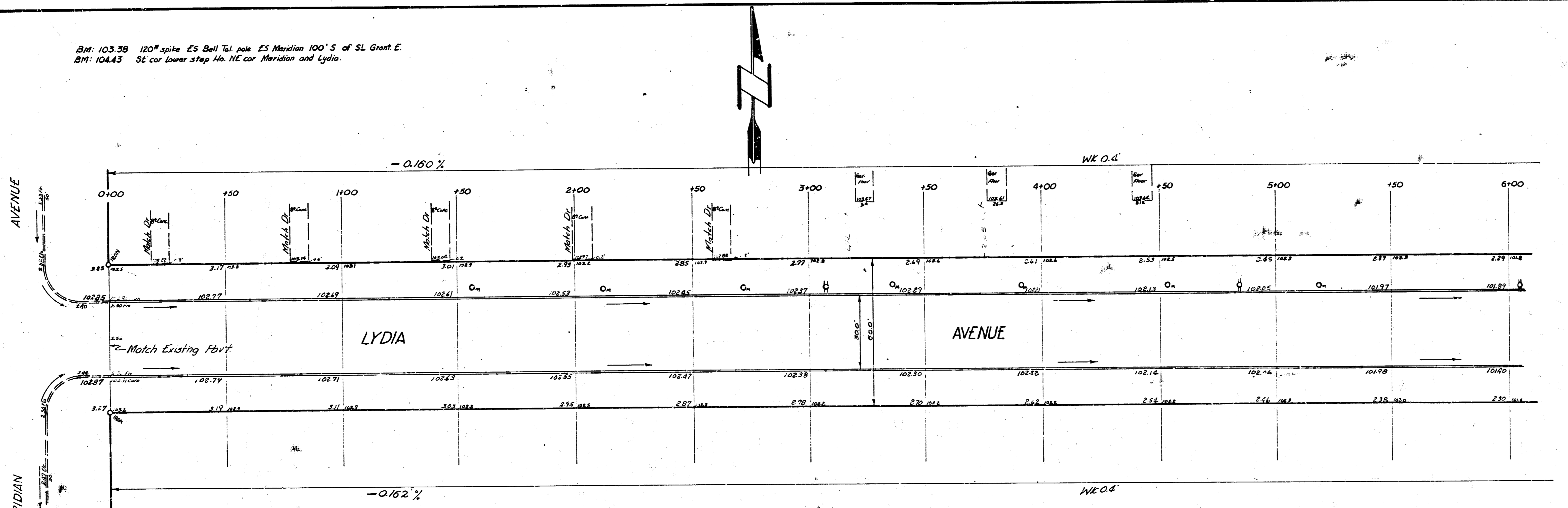

Excavation Totals
 Property - City
 1232.4
 123.2
 110% 1355.6 Cu yds.

City of Wichita
 Div. of Public Works
 Eng. No. 116
 Chicago 77

Sheet 1 of 4



LYDIA AVENUE
 EL Meridian to WL Everett
 30' Conc. & Ch.
 CITY OF WICHITA, KANSAS
 B.E. SMITH CITY ENGINEER
 APRIL 1957 PROJ. NO. C14-364.

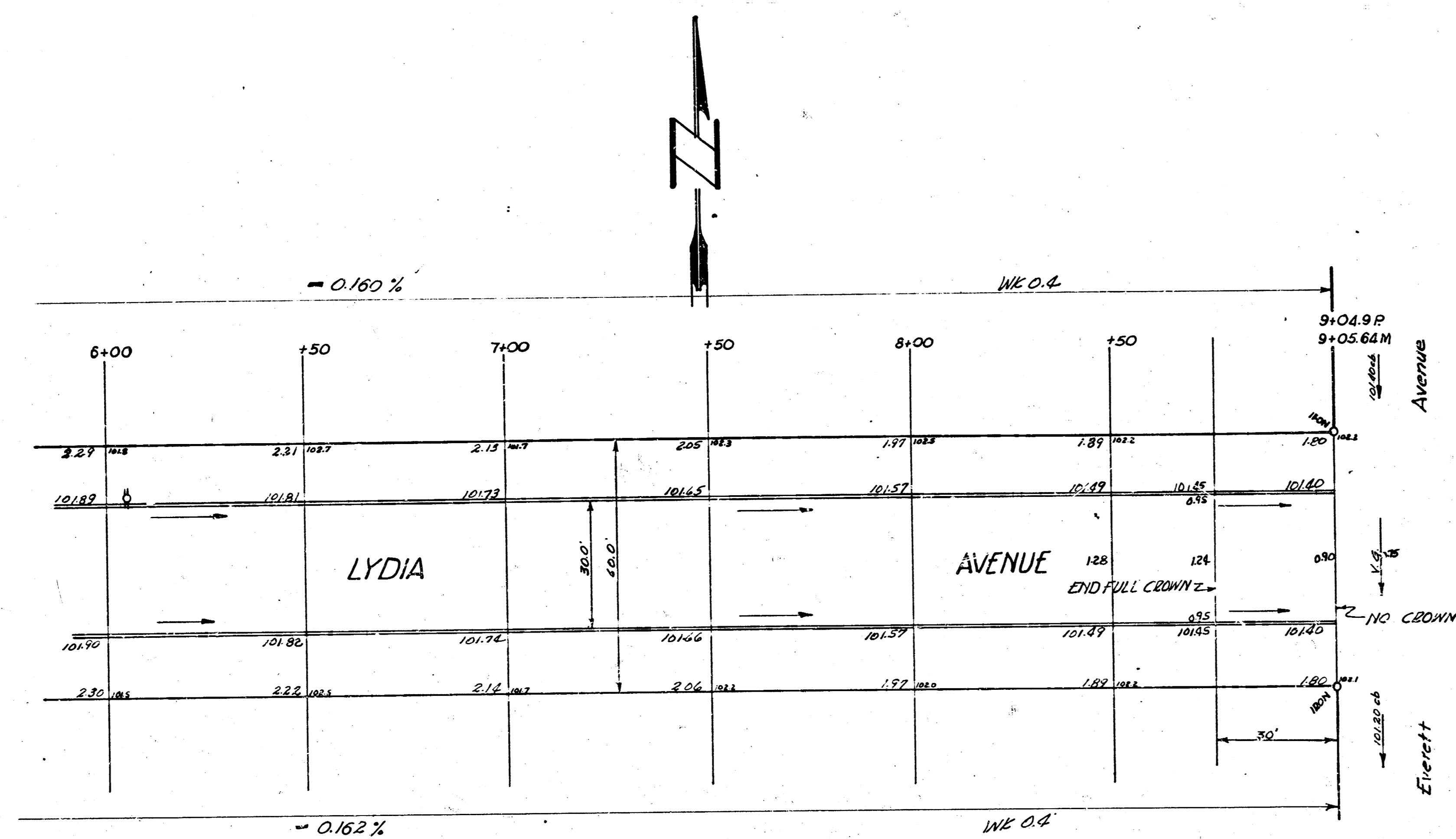

LYDIA AVENUE
 EL Meridian to WL Everett
 Sheet 2 of 4