

Use 1/2" Bars, 3' long on 2'-6" Centers.

DETAIL OF MASTIC JOINT  
NO SCALE

**CURVE DATA**  
Sta. 3102.95 to Sta. 5114.62  
Stationing on South Property line  
Min. Rad.  $L.P. = 6,883'$   $\frac{1}{2} \Delta = 24^\circ 1' 00''$

STATIONS	Arc length South 72	Chord length offset from face of sa. cb	Chord length offset from face of N. cb	DEFLECTION	TOTAL DEFLECTION
3102.95				0° 00' 00"	0° 00' 00"
3150	47.05'	45.67'	37.02'	5° 23' 52"	5° 23' 52"
4100	50.00'	48.52'	39.32'	5° 44' 10"	11° 08' 02"
4150	50.00'	48.51'	39.32'	5° 44' 10"	16° 52' 12"
5100	50.00'	48.52'	39.32'	5° 44' 10"	22° 36' 22"
5114.62	14.62'	14.20'	11.51'	1° 40' 38"	24° 17' 00"

B.M. 115.07 NW cor. lower conc. step to SE cor. Ross Parkway & Leahy Ct.  
B.M. 120.49 NW cor. lower conc. step to 3648 Leahy Ct.  
Base Line & Stationing 30' s. of & Leahy Ct. chaining W. & NW.

**NOTE:**  
Construct roll curb on entire project except at curb transition section.  
All curb elevations shown are at top of roll curb except at EL Ross Parkway.

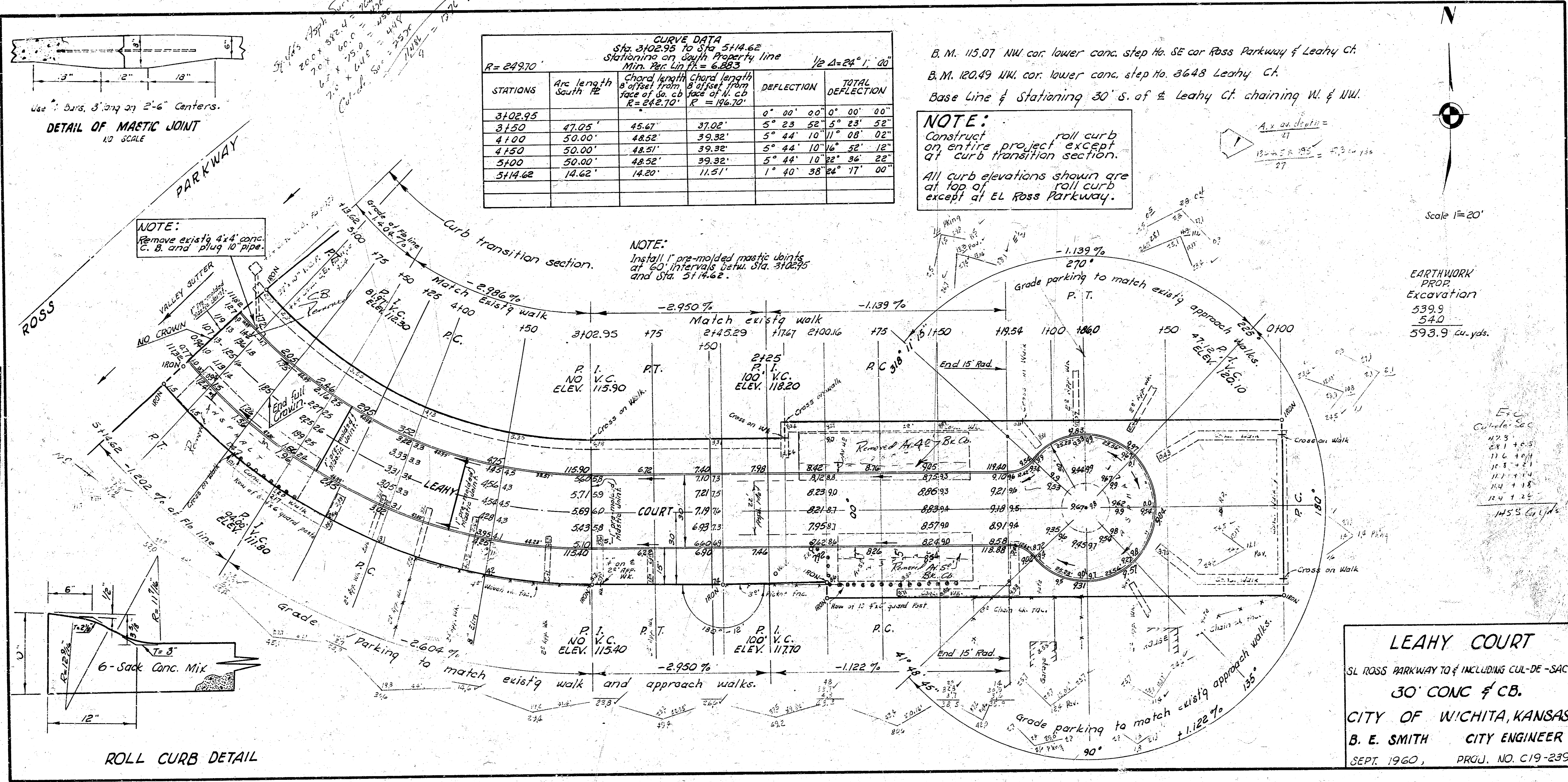

**EARTHWORK**  
Excavation  
539.9  
54.0  
593.9 cu. yds.

**LEAHY COURT**  
SL ROSS PARKWAY TO & INCLUDING CUL-DE-SAC  
30' CONC & CB.  
CITY OF WICHITA, KANSAS  
B. E. SMITH CITY ENGINEER  
SEPT. 1960, PRGJ. NO. C19-239