

1941
MADISON AVE. - SL. RANDOM ROAD - N.L. MURDOCK AVE.
26-2-30 - 2" A.C. - 5" CONC. BASE

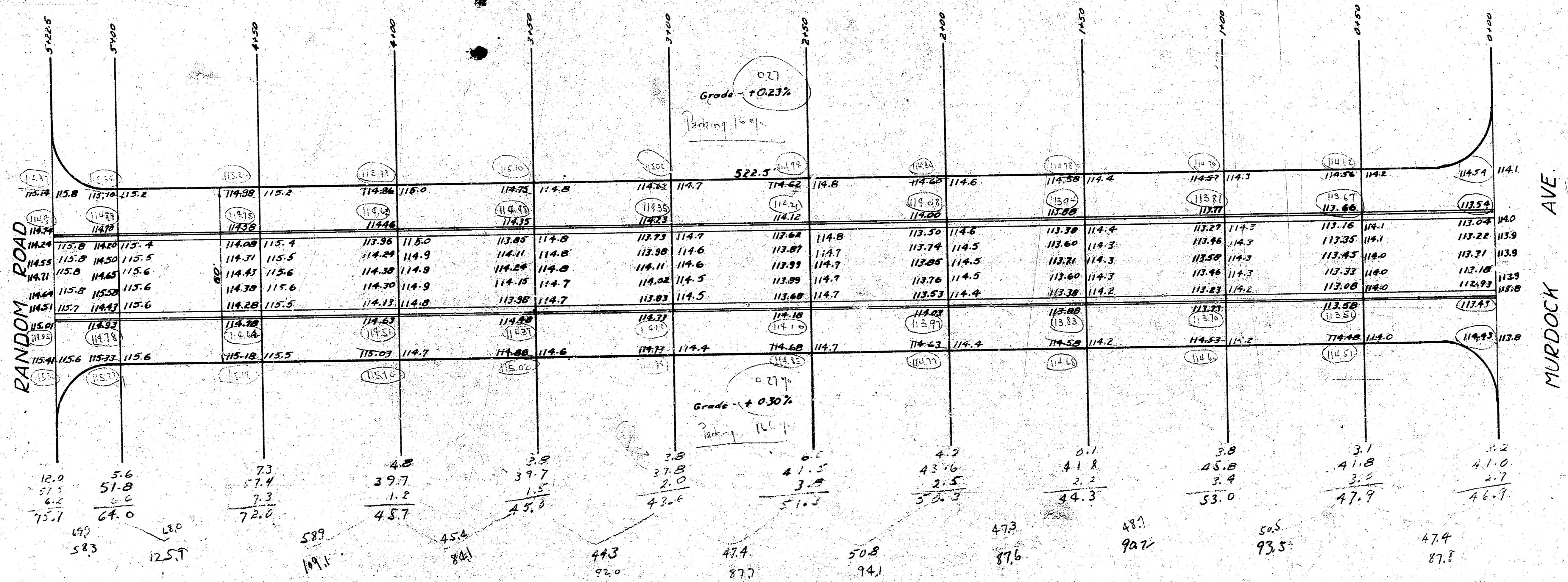

B.M. Elev. - 117.03 -
118.23 Top of West end of 42" cast pipe
at Crane & N.S. Frisco R/M

Total - 100.03 cu.yds.
100.0
1160.0

Figures on right side of sta. line are Ground Elevations
Figures on left side of sta. line are Grade Elevations