

B.M. 116.15 5' in Globe N. End W. Ret. 11TH & Madison
 B.M. 117.70 5' in Globe E. End of N.E. Return N.L. 12TH E.S. Spruce
 Stationing & Base Line on a Line 25' West of East Prop. Line
 At 11TH St. To A Point 25' East of West Prop. Line At 12TH St.

Survey
 Exc
 Checked

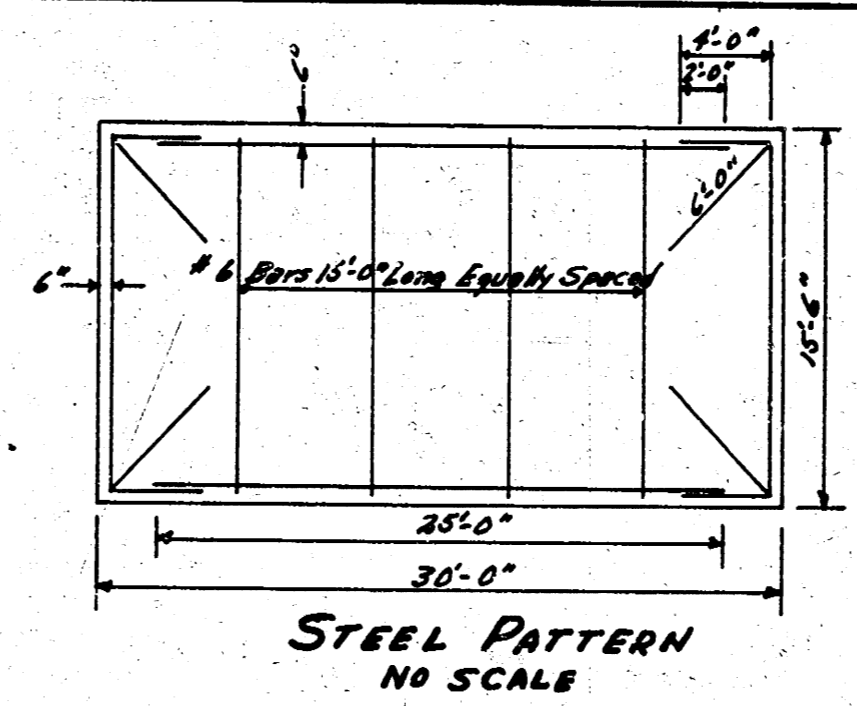

NOTE: STEEL PATTERN AS SHOWN TO BE USED ON EAST 1/2 OF STREET ONLY. REGULAR PATTERN TO BE USED ON WEST 1/2 OF STREET

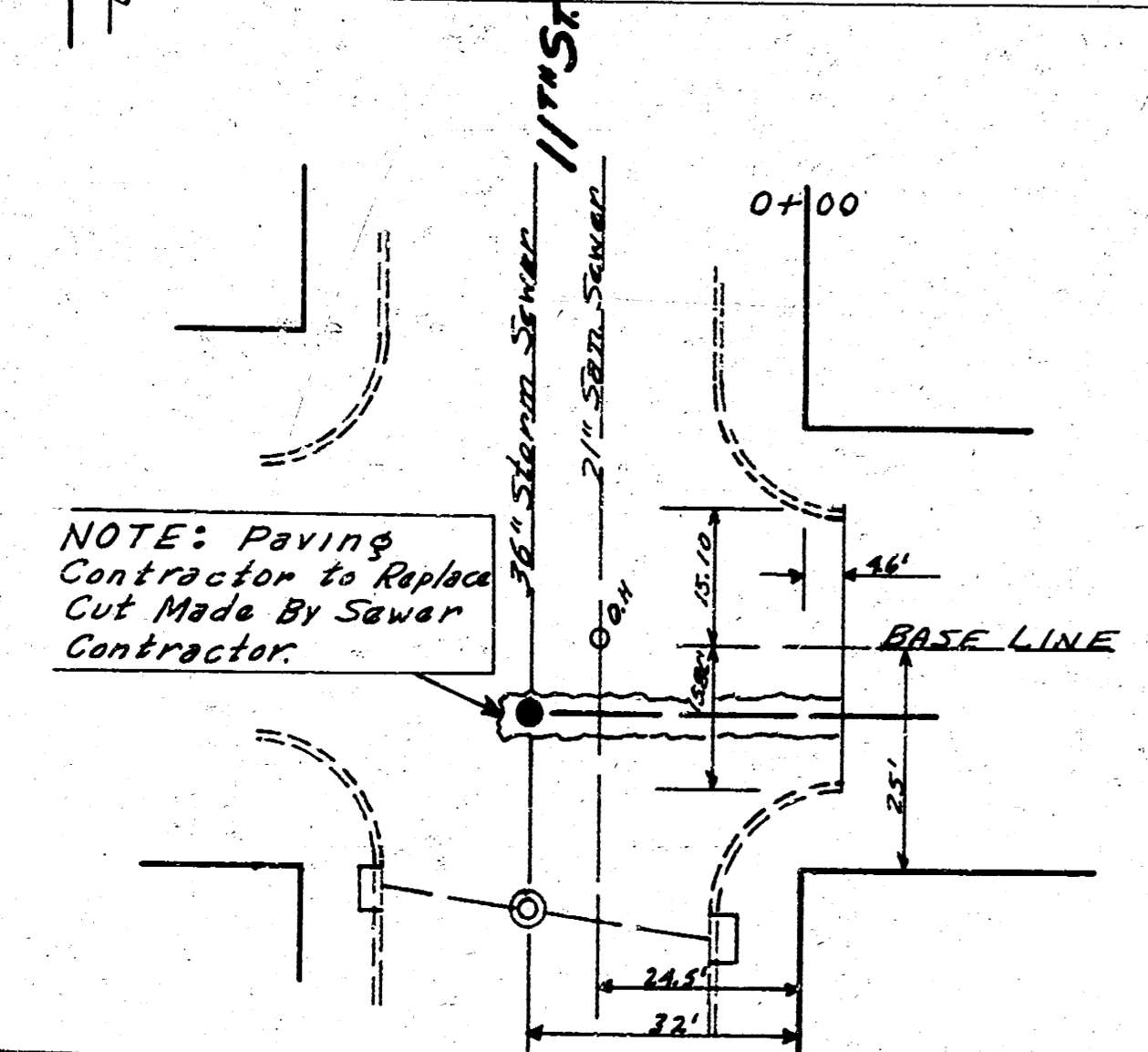
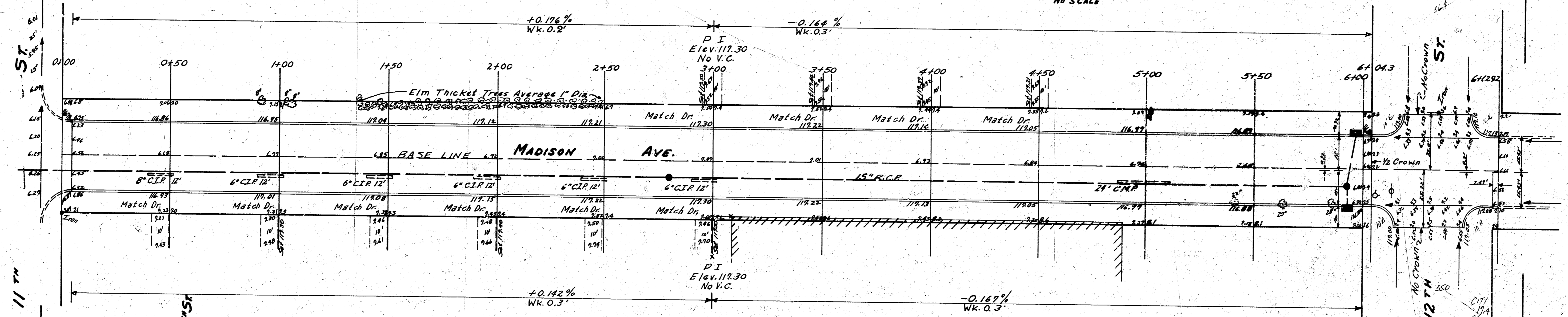

CUT	PROPERTY	FILL	CITY
606.6		11.5	CUT
11% 60.7		11% 8	100.1
629.3 CU YDS CUT		8.3 Cu. YDS FILL	110.10 CU YD CUT



MADISON
 N.L. 11TH To N.L. 12TH
 30' Conc & Cb
 CITY OF WICHITA KAN.
 B.E. SMITH CITY ENGINEER
 Oct. 1955 Proj. No C15/193

SERIAL 5-27
BY
SEMMAN

