

GENERAL NOTES

STATE	PROJECT NO.	YEAR	SHEET NO.	TOTAL SHEETS
KANSAS	87 N-0362-01	2007	2	48

UNLESS SHOWN OR STATED OTHERWISE ON THESE DRAWINGS, MATERIALS AND CONSTRUCTION SHALL BE IN ACCORDANCE WITH CITY OF WICHITA CONCRETE PAVEMENT AND ASPHALTIC CONCRETE PAVEMENT SPECIFICATIONS.

CONTRACTOR WILL BE REQUIRED TO PROVIDE A MINIMUM ADVANCE NOTICE OF SEVENTY-TWO (72) HOURS TO UTILITY COMPANIES PRIOR TO STARTING ANY EXCAVATION AS FOLLOWS:

KANSAS ONE-CALL 1-800-344-7233
OR 687-2470 (LOCAL WICHITA)

THE CONTRACTOR MUST NOTIFY THE FOLLOWING IN CASE OF AN EMERGENCY:

AT&T (TELEPHONE) 800-870-8390
COX COMMUNICATIONS (CABLE) 262-0661
WESTAR (ELECTRIC) 383-8600
KANSAS GAS SERVICE (GAS) 832-3101
CITY OF WICHITA WATER & SEWER MAINT. 262-6000
AQUILA (GAS) 946-0096

THE CONTRACTOR SHALL BE RESPONSIBLE FOR PRESERVING PROPERTY IRONS. THE CONTRACTOR WILL BE REQUIRED TO RE-ESTABLISH ANY PROPERTY IRONS WHICH ARE DAMAGED OR DESTROYED BY HIS CONSTRUCTION OPERATIONS. SUCH IRONS SHALL BE RE-ESTABLISHED BY A LICENSED LAND SURVEYOR IN ACCORDANCE WITH STATE LAWS.

EXISTING UTILITIES AND THEIR LOCATIONS, AS SHOWN ON THE PLANS REPRESENT THE BEST INFORMATION OBTAINABLE FOR DESIGN. LOCATION INFORMATION HAS BEEN OBTAINED FROM THE VARIOUS UTILITY COMPANIES AND IS EITHER FROM COMPANY RECORD DRAWINGS OR COMPANY PROVIDED FIELD LOCATIONS. THE PLAN LOCATIONS SHOWN ARE NOT GUARANTEED. ADDITIONAL EXISTING UTILITIES MAY ALSO BE ENCOUNTERED. ALL UTILITIES ON OR SUPPORTED BY THE BRIDGE WILL REMAIN IN SERVICE DURING CONSTRUCTION. CONTRACTOR SHALL USE CAUTION WHILE WORKING AROUND UTILITIES.

RUBBLE FROM THE REMOVAL OF MISCELLANEOUS STRUCTURES AND EXCESS EXCAVATION WHICH IS TO BE WASTED SHALL BE DISPOSED OF ON SITES TO BE PROVIDED BY THE CONTRACTOR. THESE SITES SHALL BE APPROVED BY THE ENGINEER AS TO SUITABILITY, APPEARANCE AND SITE LOCATION. LOCATIONS THAT, IN THE OPINION OF THE ENGINEER, WILL LEAVE AN UNSIGHTLY APPEARANCE WILL NOT BE APPROVED. ALL DISPOSAL SITES MUST BE APPROVED BY THE KANSAS DEPARTMENT OF HEALTH AND ENVIRONMENT. MATERIAL EITHER STOCKPILED OR DISPOSED OF IN A FLOOD PLAIN WOULD REQUIRE A KANSAS STATE BOARD OF AGRICULTURE PERMIT. ANY MATERIAL DUMPED IN WATERS OF THE UNITED STATES OR WETLANDS IS SUBJECT TO U.S. CORPS OF ENGINEERS PERMITTING REGULATIONS. ANY MATERIAL BURIED OR STOCKPILED BEYOND APPROVED CONSTRUCTION LIMITS WOULD REQUIRE ADDITIONAL ARCHAEOLOGICAL INVESTIGATIONS UNLESS BURIED IN A PREVIOUSLY APPROVED BORROW LOCATION.

A SAW CUT OF AT LEAST ONE-HALF THE DEPTH OF THE EXISTING SURFACE COURSES OR ONE-FOURTH THE DEPTH OF THE EXISTING TOTAL PAVEMENT THICKNESS SHALL BE PROVIDED AT LOCATIONS WHERE PROPOSED CONSTRUCTION ABUTS AN EXISTING SURFACE OR PAVEMENT FOR WHICH PARTIAL REMOVAL OF THAT SURFACE OR PAVEMENT IS REQUIRED. SAW JOINT TO FACILITATE REMOVAL WITHIN THREE (3) FEET OF EXISTING JOINTS WILL NOT BE PERMITTED AND FOR SUCH INSTANCES THE LIMITS OF REMOVAL SHALL EXTEND TO THE EXISTING JOINT.

TELEPHONE MANHOLES ABANDONED IN PLACE SHALL MEET ALL CITY OF WICHITA STANDARD REQUIREMENTS.

ELEVATIONS ARE IN U.S.G.S. DATUM

SELECT SOIL (TOPSOIL SHALL BE PLACED AT A MINIMUM DEPTH OF 6" OR AS SPECIFIED AT ALL LOCATIONS WITHIN THE RIGHT-OF-WAY OUTSIDE OF PAVEMENT. THE FINISHED GRADE INDICATES THE SURFACE ELEVATION AFTER THE PRESCRIBED SELECT SOIL (TOPSOIL) THICKNESS HAS BEEN PLACED.

ALL GRAVEL OR OTHER SIMILAR DEBRIS LARGER THAN 1/2 INCH IN DIAMETER SHALL BE RAKED UP AND REMOVED DURING FINAL GRADE PREPARATION.

WHERE OFFSITE SELECT SOIL IS NEEDED, IT SHALL BE FERTILE NATURAL TOPSOIL, TYPICAL OF THE LOCALITY, OBTAINED FROM WELL DRAINED AREAS. STOCKPILED TOPSOIL MAY BE USED. IT SHALL BE WITHOUT ADMIXTURE OF SUBSOIL OR SLAG AND SHALL BE FREE OF STONES, LUMPS, STICKS, PLANTS, OR THEIR ROOTS, TOXIC SUBSTANCES OR OTHER EXTRANEEOUS MATTER THAT MAY BE HARMFUL TO PLANT GROWTH OR WOULD INTERFERE WITH FUTURE MAINTENANCE. TOPSOIL PH RANGE SHALL BE 5.5 TO 7.0. TOPSOIL SHALL BE APPROVED BY THE LANDSCAPE ARCHITECT PRIOR TO PLACEMENT.

ALL CONSTRUCTION STAKING SHALL BE PERFORMED BY THE CITY OF WICHITA PUBLIC WORKS DEPARTMENT AT NO COST TO THE CONTRACTOR. THE CONTRACTOR SHALL COORDINATE THE SURVEY STAKING WITH THE CITY OF WICHITA PUBLIC WORKS DEPARTMENT AND GIVE THE SURVEYOR 24 HOURS NOTICE WHEN STAKES ARE REQUIRED.

CONTRACTOR SHALL REMOVE AND DELIVER TO 1801 S. MCLEAN ALL SEWER MANHOLE FRAME AND LIDS AND REGULATORY SIGNS NOTED FOR REMOVAL DURING CONSTRUCTION. ALL ASSOCIATED COSTS TO TRANSPORT THE SALVAGED MATERIAL WILL BE SUBSIDIARY TO THE BID ITEM "TRANSPORTATION OF SALVAGED MATERIALS".

ALL BUSINESS SIGNS, POSTS AND LANDSCAPING FEATURES IN CONFLICT WITH THE NEW CONSTRUCTION WILL BE RELOCATED BY OTHERS PRIOR TO CONSTRUCTION. UPON THE START OF CONSTRUCTION, ALL ITEMS THAT REMAIN WITHIN THE CONSTRUCTION LIMITS SHALL BE REMOVED AND DISPOSED OF BY THE CONTRACTOR AT NO ADDITIONAL COST TO THE CITY.

PROPOSED CURBS MATCHING EXISTING CURBS SHALL BE ALTERED TO MATCH THE SHAPE AND DIMENSIONS OF THE EXISTING CURB. POSITIVE DRAINAGE SHALL BE MAINTAINED THROUGH SUCH TRANSITIONS.

BID ITEM:

A.C. PAVEMENT, 12" (10" BIT. BASE) - ASPHALT CEMENT FOR BITUMINOUS MATERIAL SHALL BE PG 70-28 FOR SURFACE AND BASE COURSES. BM-2 AGGREGATE SHALL BE USED IN SURFACE AND BASE COURSES.

6" ASPHALT PAVEMENT PATCH - MATERIAL SHALL CONFORM TO CITY OF WICHITA. SC-1 FOR SURFACE COURSES AND BC-1 FOR BASE COURSES.

BITUMINOUS SURFACE COURSE SHALL BE PLACED WITH A LAYDOWN MACHINE HAVING AUTOMATIC CONTROLS FOR LINE AND GRADE.

A TACK COAT OF EMULSIFIED ASPHALT (SC-1H OR CSS-1H) SHALL BE APPLIED AT AN APPROXIMATE RATE OF 0.05 GAL. PER SQUARE YARD BETWEEN EACH LIFT OF BITUMINOUS MATERIAL.

CONSTRUCTION JOINTS IN EACH LIFT SHALL BE STAGGERED A MINIMUM DISTANCE OF 12 INCHES FROM JOINTS IN PRECEDING LIFTS AND PLACED SO THAT A JOINT WILL BE CONSTRUCTED ON THE CENTERLINE OF THE TOP LIFT.

CRUSHED ROCK SUBGRADE IS TO BE COMPACTED AND SMOOTHED WITH A STEEL FACED ROLLER PRIOR TO PLACEMENT OF PAVEMENT. TACK COAT WILL NOT BE APPLIED TO ROCK BASE.

ALL AREAS DISTURBED BY CONSTRUCTION THAT ARE ADJACENT TO DEVELOPED PROPERTIES SHALL BE RESTORED WITH SOD TO MATCH EXISTING TURF TYPE. RESTORATION OF DISTURBED AREAS SHALL INCLUDE, BUT NOT BE LIMITED TO, TOP SOIL PREPARATION AND SODDING. ALL SODDING WORK SHALL BE IN ACCORDANCE WITH CITY STANDARD SPECIFICATIONS AND THE CITY ADMINISTRATIVE REGULATION NO. AR78, WHICH GOVERNS CLEANUP AND RESTORATION OR REPLACEMENT FOLLOWING CONSTRUCTION. SODDING WILL BE SUBSIDIARY TO "SITE RESTORATION". WHEN THE WEATHER/SEASON PREVENTS THE INSTALLATION OF SOD, THE CONTRACTOR SHALL BE RESPONSIBLE FOR INSTALLING EROSION CONTROL BLANKET (CURLX I, OR APPROVED EQUAL) AT THE BACK OF CURB (8' WIDE MINIMUM). ALL COSTS FOR EROSION MAT INSTALLATION SHALL BE SUBSIDIARY TO "SITE RESTORATION".

IRRIGATION SYSTEMS DISTURBED BY CONSTRUCTION SHALL BE REPAIRED AND RESTORED TO WORKING ORDER BY THE CONTRACTOR. CONTRACTOR SHALL COORDINATE IRRIGATION RESTORATION WITH THE LAND OWNER AND THE LAND OWNER'S IRRIGATION CONTRACTOR.

THE CONTRACTOR SHALL REMOVE PORTIONS OF THE EXISTING STRUCTURE TO CLEAR NEW CONSTRUCTION. CONCRETE REMOVAL LINES ARE APPROXIMATE AND MAY BE VARIED AS DIRECTED BY THE ENGINEER. CONCRETE RUBBLE FROM THE REPAIRS SHALL BE REMOVED FROM THE SITE AND WASTED AT SITES SELECTED BY THE CONTRACTOR AND APPROVED BY THE ENGINEER. SEE TABLE ON SUMMARY OF QUANTITIES SHEET FOR STRUCTURE PORTIONS INCLUDED IN THIS BID ITEM, "REMOVAL OF EXISTING STRUCTURE", LUMP SUM.

THESE PLANS PROVIDE FOR THE CONSTRUCTION OF ALL PROPOSED BRIDGE IMPROVEMENTS WITHOUT THE NECESSITY OF ENTERING OR DISTURBING THE ARKANSAS RIVER. IF THE CONTRACTOR DETERMINES THAT ENTERING THE RIVER WILL BE DESIRED OR NECESSARY, HE WILL BE RESPONSIBLE FOR OBTAINING ALL PERMITS AND ADHERING TO ALL REGULATORY REQUIREMENTS. THE CONTRACTOR SHALL PREVENT ALL CONSTRUCTION MATERIALS AND DEBRIS FROM COMING IN CONTACT WITH THE RIVER.

ANY DISTURBED AREAS WITHIN THE RIVER BANKS SHALL BE RESTORED AS FOLLOWS: SEEDING TO BE ACCOMPLISHED DURING THE PERIOD OF AUGUST 15 THROUGH MARCH 15 WITH THE FOLLOWING AMOUNT AND TYPE OF SEED FOR THE MIX AT A RATE OF 8 POUNDS TOTAL PER 1,000 SQUARE FEET:

- 4 POUNDS K-31 FESCUE
- 2 POUNDS WESTERN WHEATGRASS
- 2 POUNDS SMOOTH BROME

COST TO BE SUBSIDIARY TO "SITE RESTORATION".

THE CONTRACTOR SHALL BE RESPONSIBLE FOR INSTALLING EROSION CONTROL BLANKET (CURLX I, OR APPROVED EQUAL) OVER ALL SEEDED AREAS. ALL COSTS FOR EROSION MAT INSTALLATION SHALL BE SUBSIDIARY TO "SITE RESTORATION".

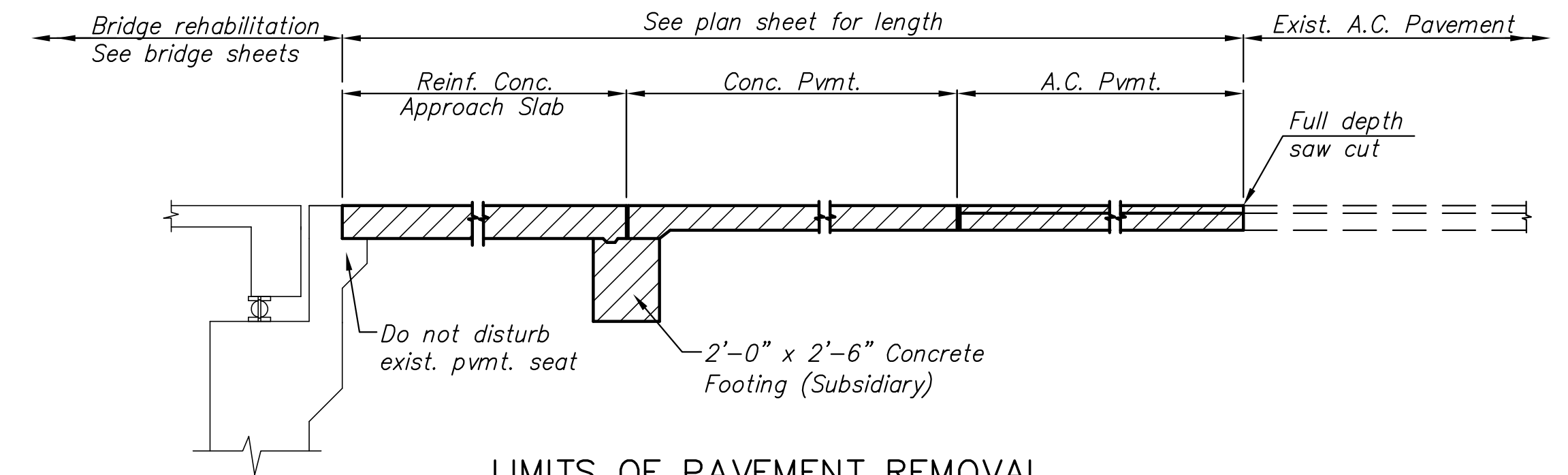

LIMITS OF PAVEMENT REMOVAL (ELEVATION)

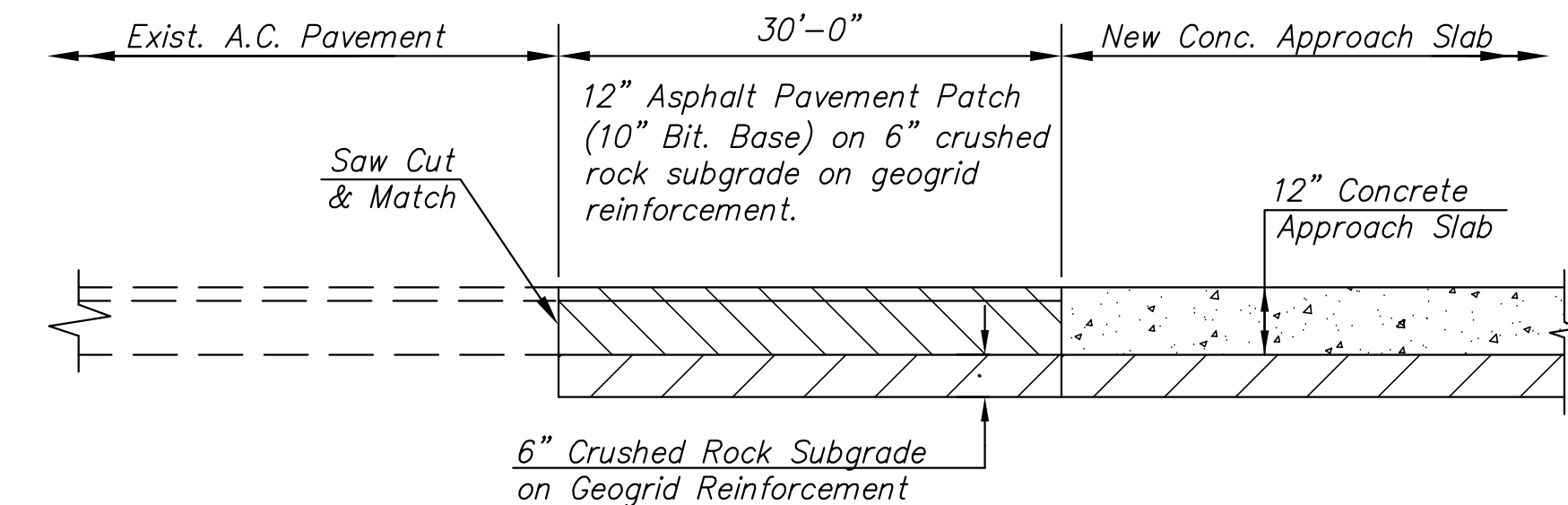

A.C. PAVEMENT HOOKUP DETAIL

Sta. 17+65.88 TO Sta. 17+95.88
Sta. 23+94.12 TO Sta. 24+24.12

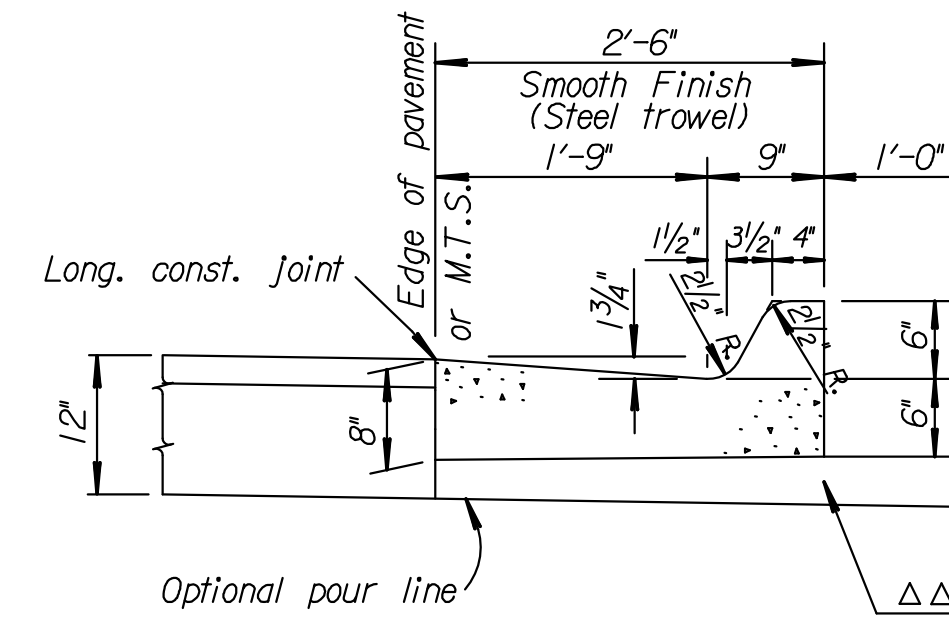

TYPICAL SECTION COMBINED CURB & GUTTER - TYPE I (2'-6" WIDTH)

Note: Conc. C.&G. I contains 0.060 cu. yds.
Conc. Grade 3.0 (AE) per lin.ft.

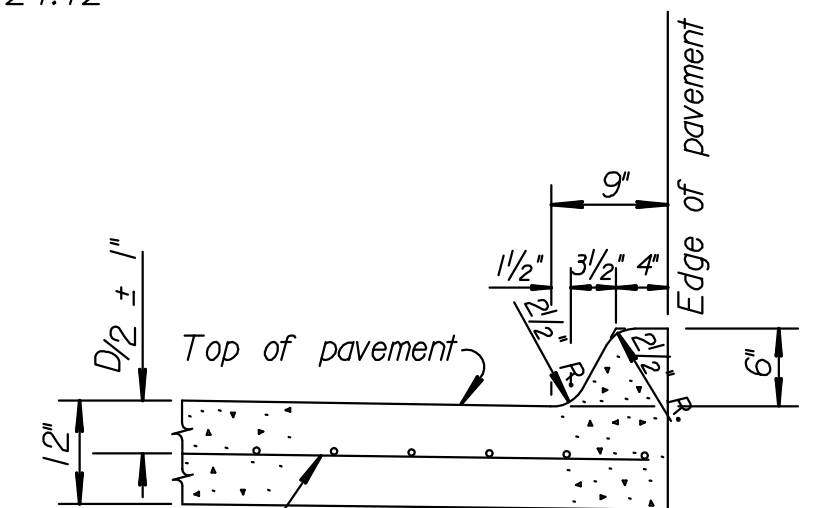

TYPICAL SECTION 6" MONOLITHIC EDGE CURB

COMBINED CURB AND GUTTER GENERAL NOTES

Combined curb and gutter or gutter adjoining concrete pavement may, at the contractor's option, be poured either monolithically or separately, using either the mix used in the concrete pavement or Concrete Grade 3.0 (AE). Pavement Joints shall be continued through curb or gutter and no other planes of weakness will be required. Joints in the combined curb and gutter are to be filled with the same material as used for the pavement joints.

Expansion joints in the combined curb and gutter are to be placed opposite expansion joints in the pavement. Where combined curb and gutter or gutter does not abut concrete pavement or concrete base course, omit tie bars and longitudinal construction joint and place a 1" premoled Expansion Joint Filler (Nonextruding, Type B) cut to the dimensions of the combined curb and gutter or gutter, at a spacing of not to exceed 250' and at the ends of curb returns.

Where combined curb and gutter or gutter is adjacent to bituminous construction, planes of weakness shall be constructed at 10'-0" intervals.

A 4' length of transition from normal gutter section to the tapered gutter section shall be used at the ends of each run of gutter except where the gutter abuts a curb, such as at the end of a bridge. Inlets shall be located so as not to fall within this transition section.

J:\Civil\04223\dwg\TITLE\04223NOTE.dwg 09/18/2007 01:31:32 PM CST

KANSAS DEPARTMENT OF TRANSPORTATION			
GENERAL NOTES			
PROJ. NO. 87 N-0362-01		SEDGWICK CO.	
MKEC ENGINEERING CONSULTANTS, INC. WICHITA, KANSAS			
DESIGNED BY: JAG	CHECKED BY: KJS		
DRAWN BY: DPG	DATE: 4/23/07	SHEET 2 OF 48	