

B.M. 129.63 60" Spike E.S. P. Pole Approx. 115' S. of Manhattan W.S. of Richmond

EXCAV  
PROP 1:0000  
PLAN 1:0000

Chain E. on N.R.

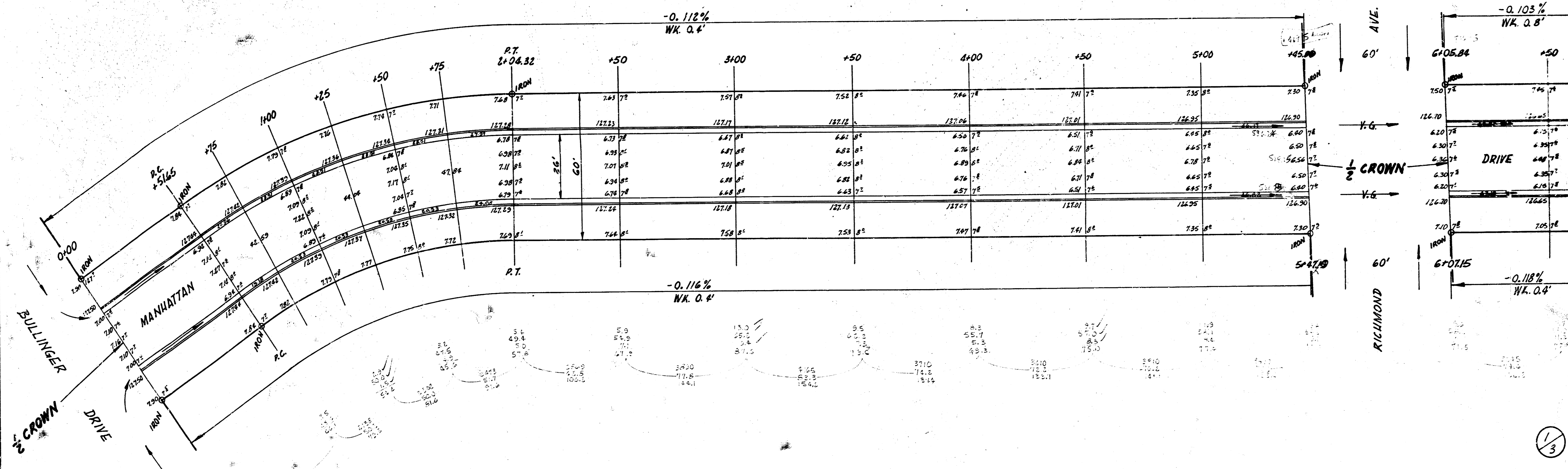

RECALL  
R.B.  
1954  
ME

CURVE DATA FROM STA 0+516.5 TO STA 2+04.32  
STA. ON N.R. R = 251.75' Δ = 34°45'

Sta	Chord Lgth. at 6' Offset N.C.B.	Chord Lgth. at 6' Offset S.C.B.	Deflection Angle	Total Angle Deflection
0+516.5				
+75	22.51	18.86	1° 23' 51"	2° 47' 42"
+100	26.10	19.93	1° 50' 43"	4° 38' 25"
+125	28.10	19.93	1° 50' 43"	6° 29' 08"
+150	28.10	19.93	1° 50' 43"	8° 19' 51"
+175	26.10	18.86	1° 23' 51"	9° 43' 43"
2+04.32	22.51	18.86	1° 23' 51"	11° 07' 34"



MANHATTAN DRIVE  
E.L. BULLINGER - W.L. HALSTEAD  
26-2-30 A.C.  
CITY OF WICHITA, KANS.  
B.E. SMITH CITY ENGINEER  
SEPT., 1954 PROJ. NO. C14-178

TOTAL LENGTH  
5+00  
554.1  
DATE 9/15/54

EXCAV.  
 Prop. 19341 C.A.V. 0 Days

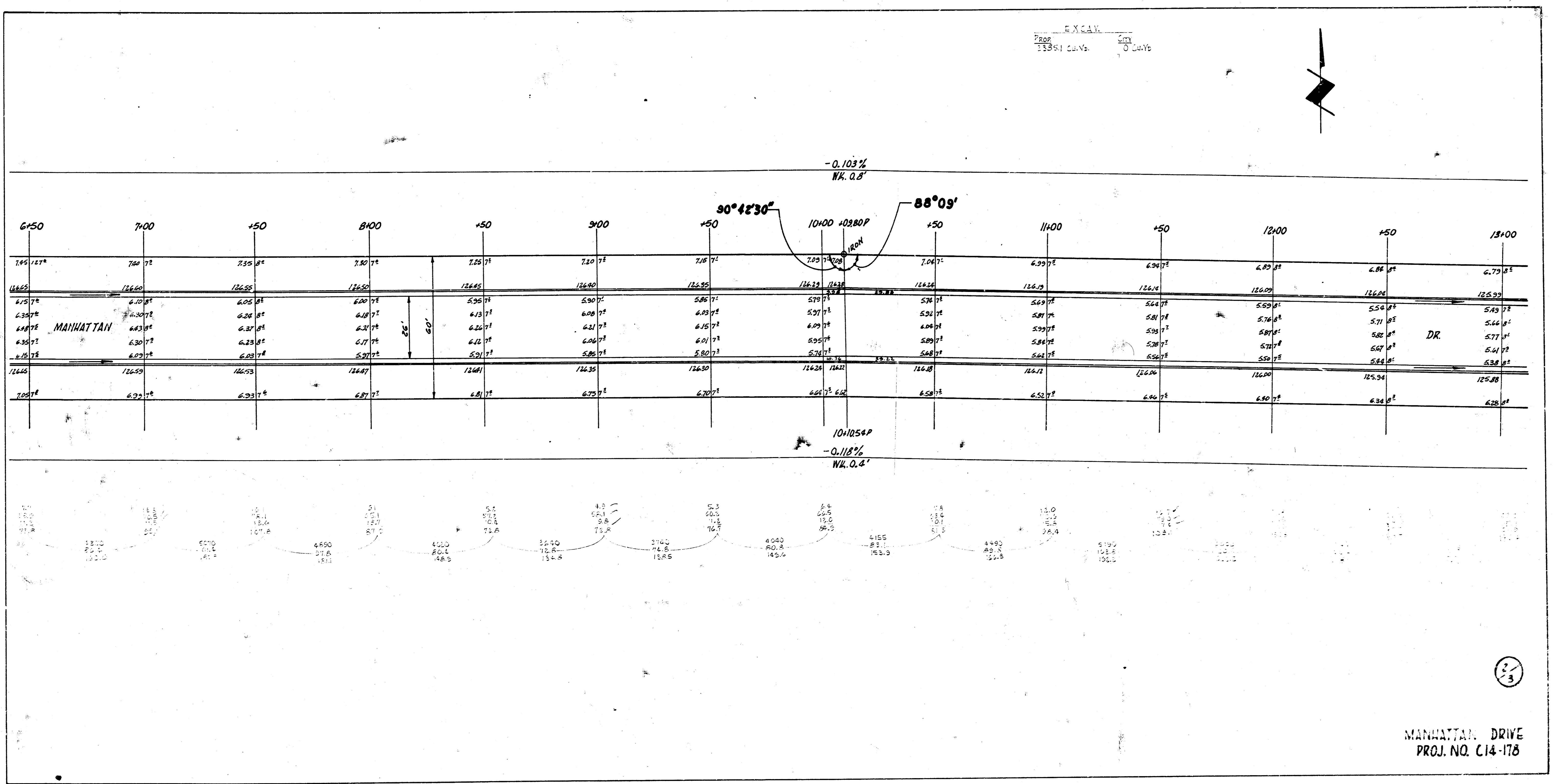
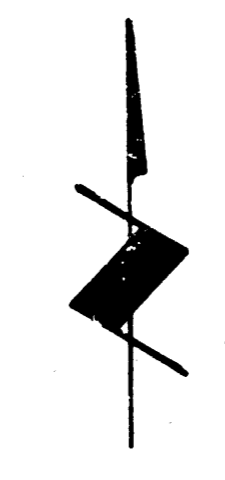

3

MANHATTAN DRIVE  
 PROJ. NO. C14-178

