

B.M. 198.18 Spike W.S. P. Pole, W.S. Woodlawn & N.S. Murdock

Chaining E. on S. R.

FROM EXISTING
TO PROPOSED

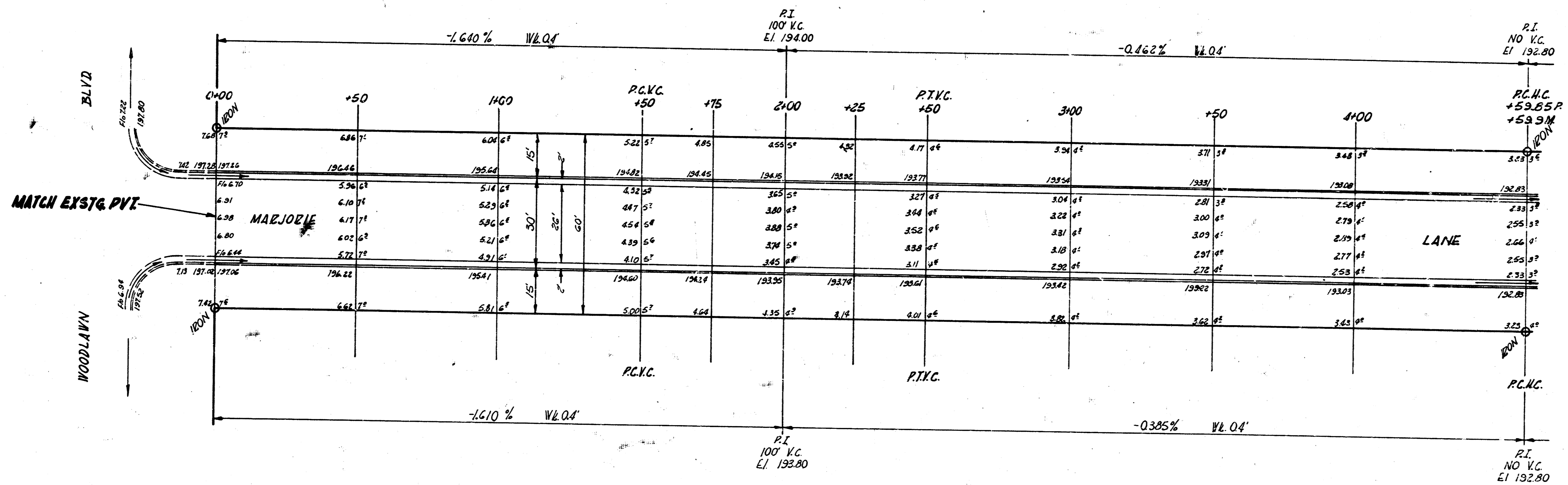

Scale
1" = 10'
1/2" = 20'

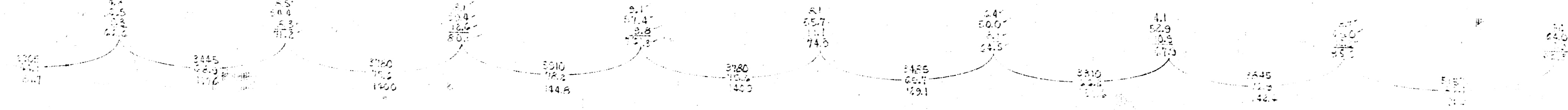

1/2

MARJORIE LANE
E.L. WOODLAWN - WL MISSION RD.
26'-2'-30" A.C.
CITY OF WICHITA, KANS.
B.E. SMITH CITY ENGINEER
JAN, 1955 PROJ. NO. C14-106



TOTAL FROM EXISTING
227.45
100' V.C. 222.1
247.77' Cont.

PROP. EX. 144
1005.3 ON V. 6

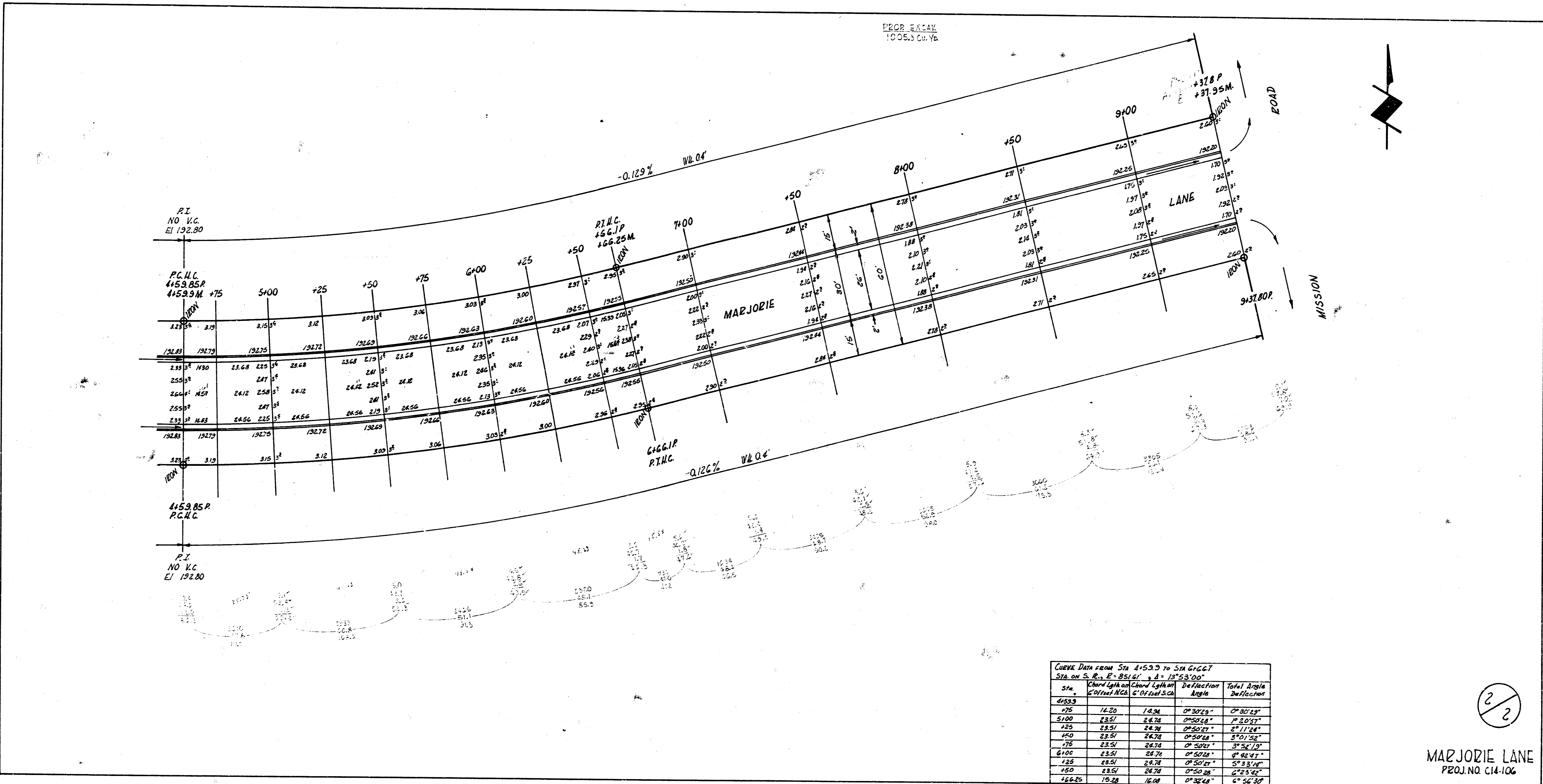

CURVE DATA FROM STA 4+53.85 TO STA 4+66.25
STA ON S. 2. E. 85.16' A = 13°53'00"

Sta	Chord Length	Chord Length	Deflection Angle	Total Angle Deflected
4+53.85				
4+55	16.20	14.24	0°30'28"	0°30'28"
4+60	28.57	24.74	0°50'14"	1°20'42"
4+65	38.51	34.28	0°50'14"	2°10'56"
4+70	46.51	41.74	0°50'14"	3°01'10"
4+75	52.51	46.74	0°50'14"	3°51'24"
4+80	56.51	50.74	0°50'14"	4°41'38"
4+85	59.51	53.74	0°50'14"	5°31'52"
4+90	61.51	55.74	0°50'14"	6°22'06"
4+95	62.51	56.74	0°50'14"	7°12'20"
4+66.25	15.24	16.28	0°30'28"	7°42'48"

2/2
MARJORIE LANE
PROJ. NO. C14-106

1 1 1 1 0