

S.M. 9735 NW Cor. Oak, Park Hs.
NE Cor. Market & Kansas.

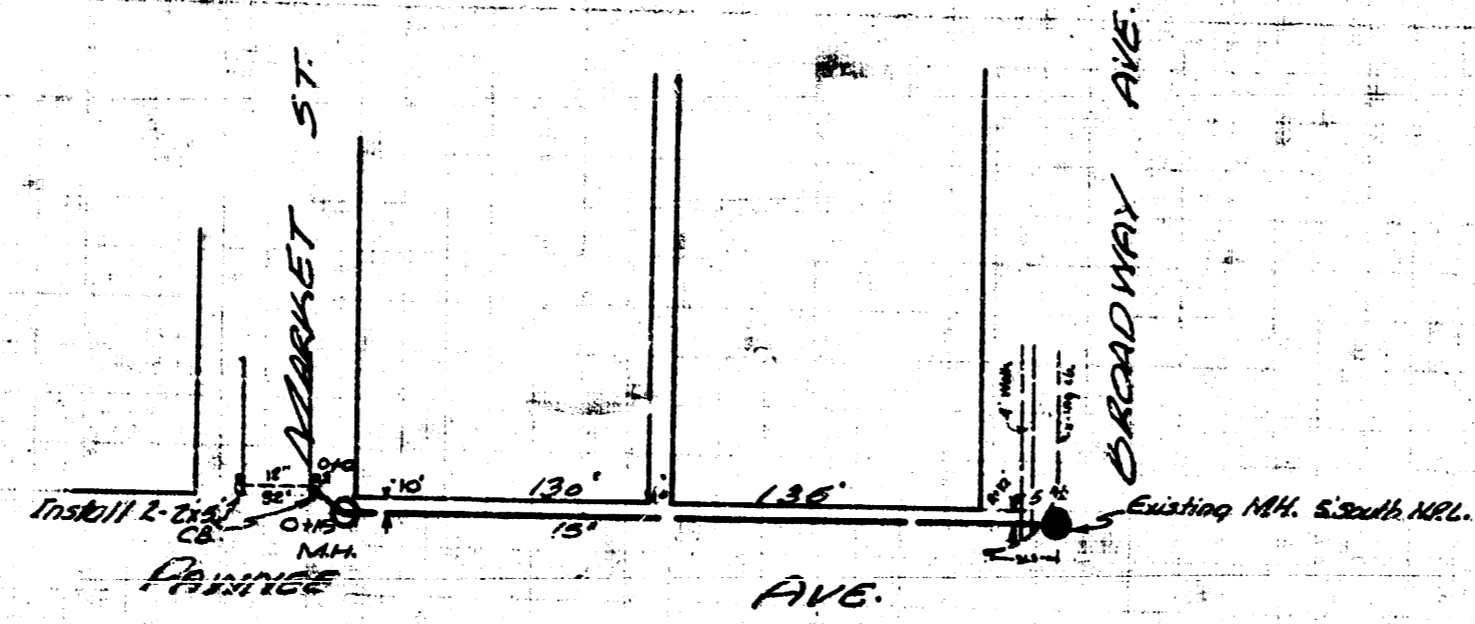

NOTE:
DETAIL OF SEWER EXAGGERATED.

10
11
12
13
14
15
16
17
18
19
20
21
22
23
24
25
26
27
28
29
30

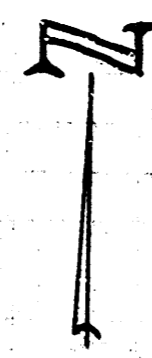
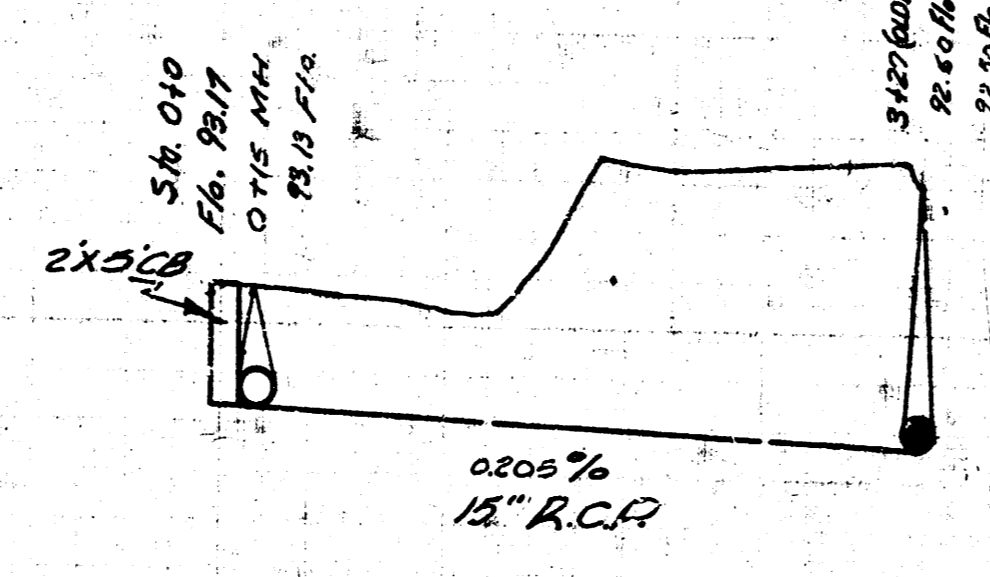

INCIDENTAL DRAINAGE
IN CONNECTION WITH MARKET ST PAVING
CITY OF WICHITA, KANSAS
L.R. WHITE City Engineer
June 1948 Proj. No.