

Reference Points - Iron & Alley & Market
 1. "x" Top Curb 36.24' S.W.
 2. "x" Top Curb 37.00' S.E.

B.M. 128.62 R.R. Spike east side
 Power Pole, N.W. cor. 27th & Market

Reference Points - Iron & 27th & Market
 1. "x" Top Curb 36.00' S.E.
 2. "x" Top Curb 36.99' N.E.

Scale: 1" = 20'

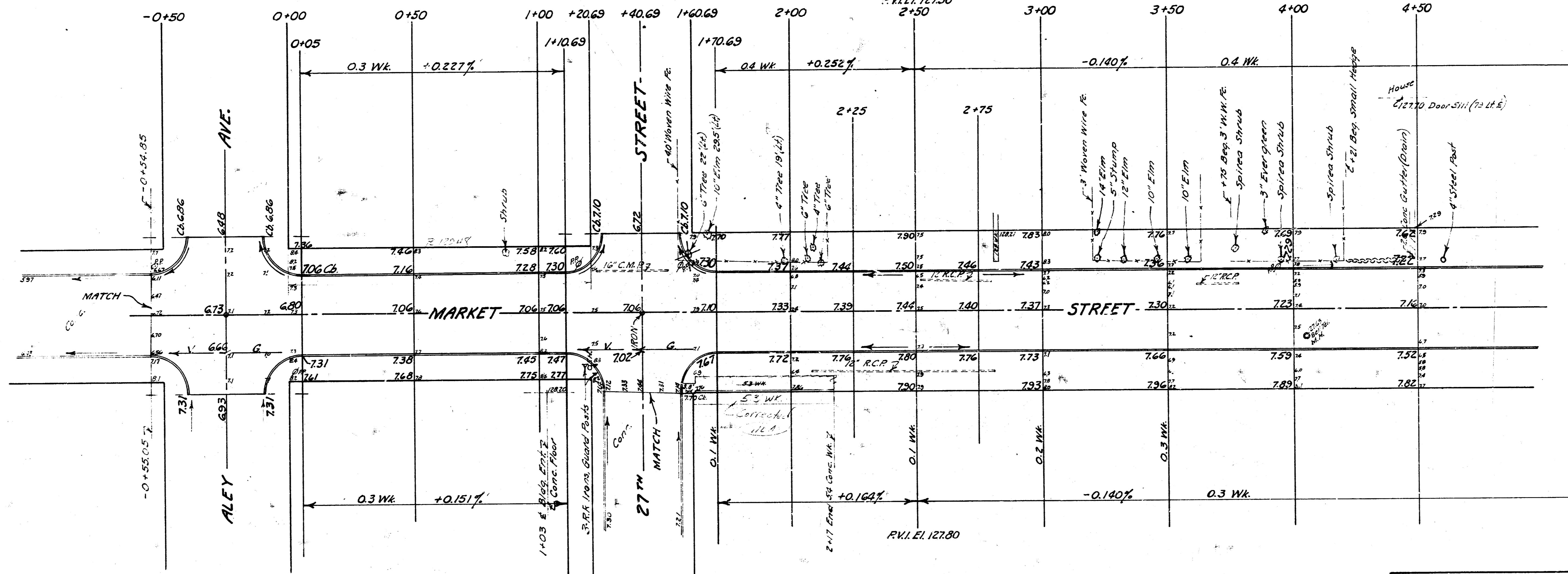

CITY

Cu. Yds. Exc.	227
+10%	23
Totals	250

PROPERTY

	EXCAVATION	COMP. FILL
Cu. Yds.	724	11
+10%	72	1
Totals	796	12

MARKET STREET
 FROM S.L. ALEY to S.L. 28TH
 30'-6" Conc. & Int. Curb
 B.E. SMITH CITY ENGINEER
 CITY OF WICHITA KANSAS
 MAY 1962, Project No. C12-14



1/3

B.M. 130.29 "T" in Tr. Fire Hyd.
NW 28th & Market

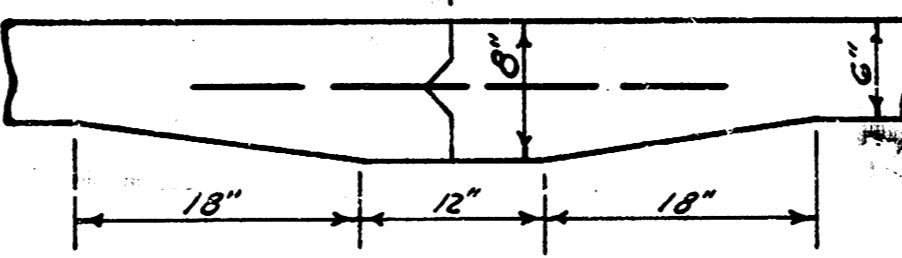
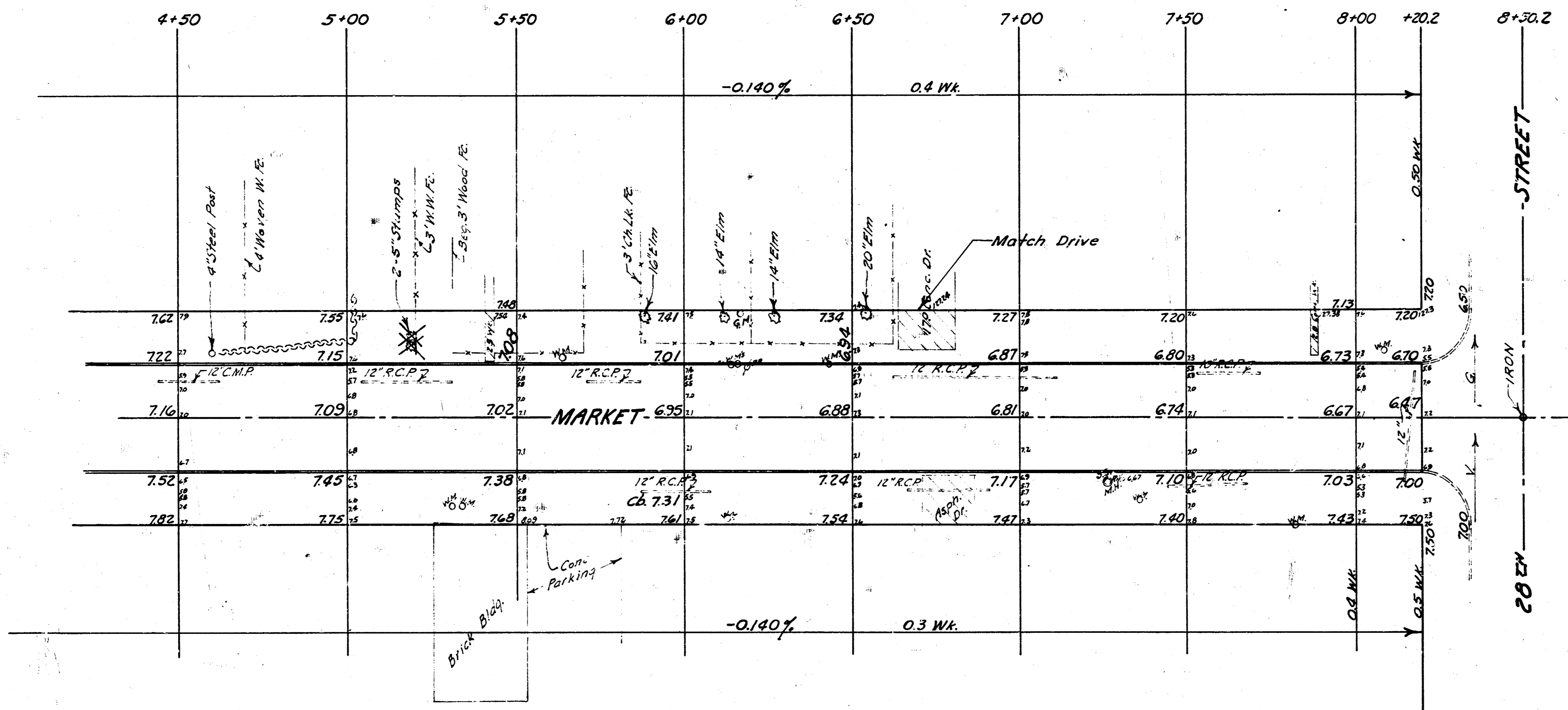
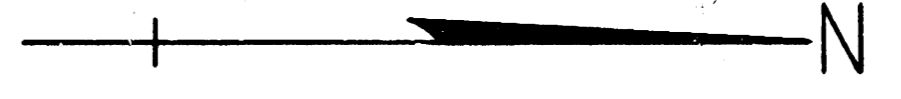

Use $\frac{1}{2}$ " bars 3.0' long @ 30" cts.
MASTIC JOINT DETAIL

23