

S.M. 12874 - N.E. Cor. Coping Cor. Canal Bridge on Market  
 S.W. 12806 - T in 1200, Fire Hydrant S.E. Cor. Market & 25th  
 Stationing on E

CITY  
 1.5  
 2.5  
 3.5  
 4.5  
 5.5  
 6.5  
 7.5  
 8.5  
 9.5  
 10.5  
 11.5  
 12.5  
 13.5  
 14.5  
 15.5  
 16.5  
 17.5  
 18.5  
 19.5  
 20.5  
 21.5  
 22.5  
 23.5  
 24.5  
 25.5  
 26.5  
 27.5  
 28.5  
 29.5  
 30.5  
 31.5  
 32.5  
 33.5  
 34.5  
 35.5  
 36.5  
 37.5  
 38.5  
 39.5  
 40.5  
 41.5  
 42.5  
 43.5  
 44.5  
 45.5  
 46.5  
 47.5  
 48.5  
 49.5  
 50.5  
 51.5  
 52.5  
 53.5  
 54.5  
 55.5  
 56.5  
 57.5  
 58.5  
 59.5  
 60.5  
 61.5  
 62.5  
 63.5  
 64.5  
 65.5  
 66.5  
 67.5  
 68.5  
 69.5  
 70.5  
 71.5  
 72.5  
 73.5  
 74.5  
 75.5  
 76.5  
 77.5  
 78.5  
 79.5  
 80.5  
 81.5  
 82.5  
 83.5  
 84.5  
 85.5  
 86.5  
 87.5  
 88.5  
 89.5  
 90.5  
 91.5  
 92.5  
 93.5  
 94.5  
 95.5  
 96.5  
 97.5  
 98.5  
 99.5  
 100.5

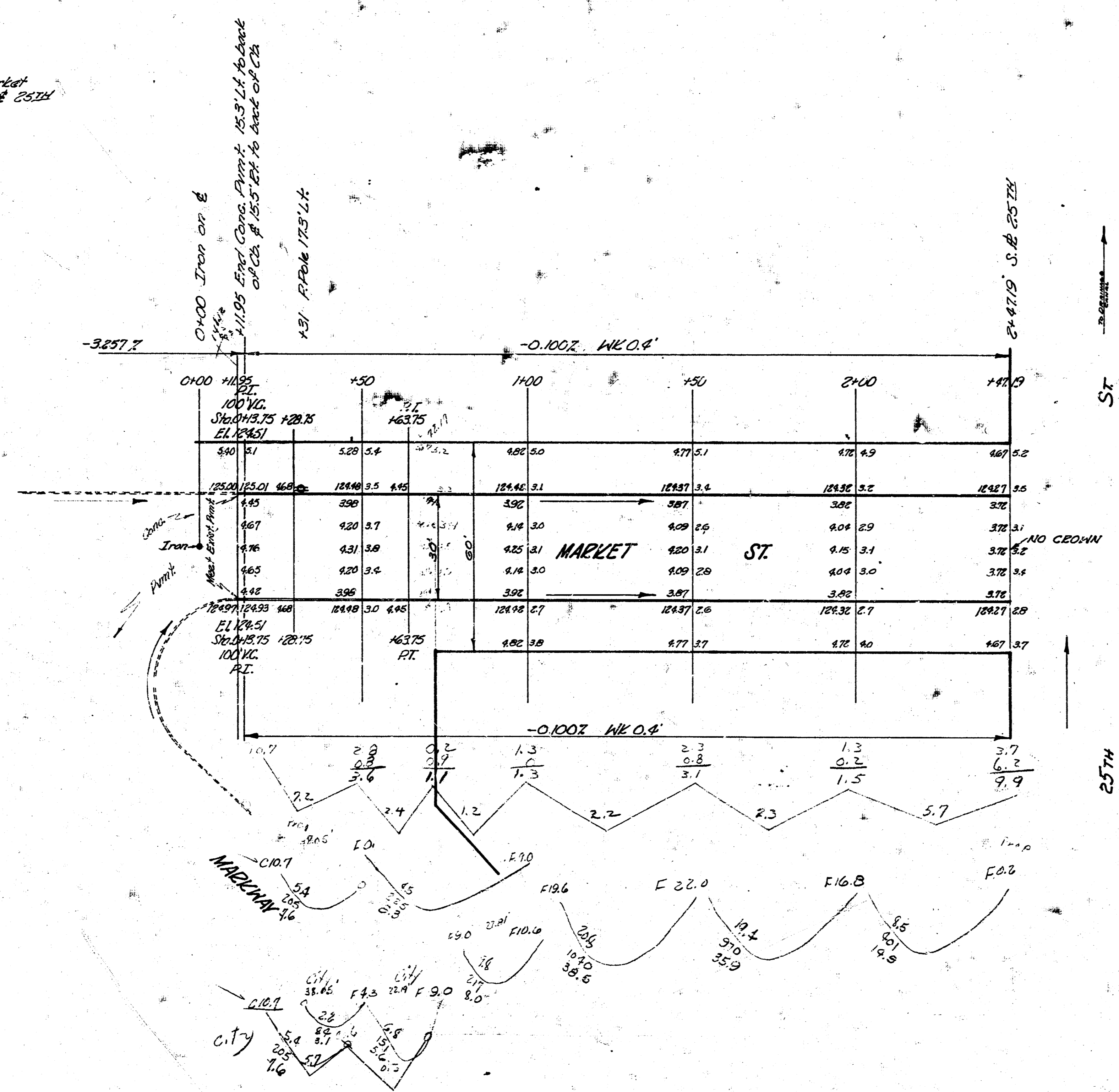

MARKET ST  
 N.E. MAXWELL TO S.E. 25TH  
 30' CONC. & CO.  
 8" CONC.  
 CITY OF WICHITA, KANSAS  
 B.E. SMITH CITY ENGINEER  
 JAN. 17, 1953 PROJ. 16. C12-192



Checked by  
 J.D.  
 2-1-53