

1942

MATHEWSON COURT - N.L. THIRD TO S.L. MATHEWSON LANE

28-C.1
27' Curb to Curb

NOTE: STATIONS ARE ON E OF PROPOSED PAVT.

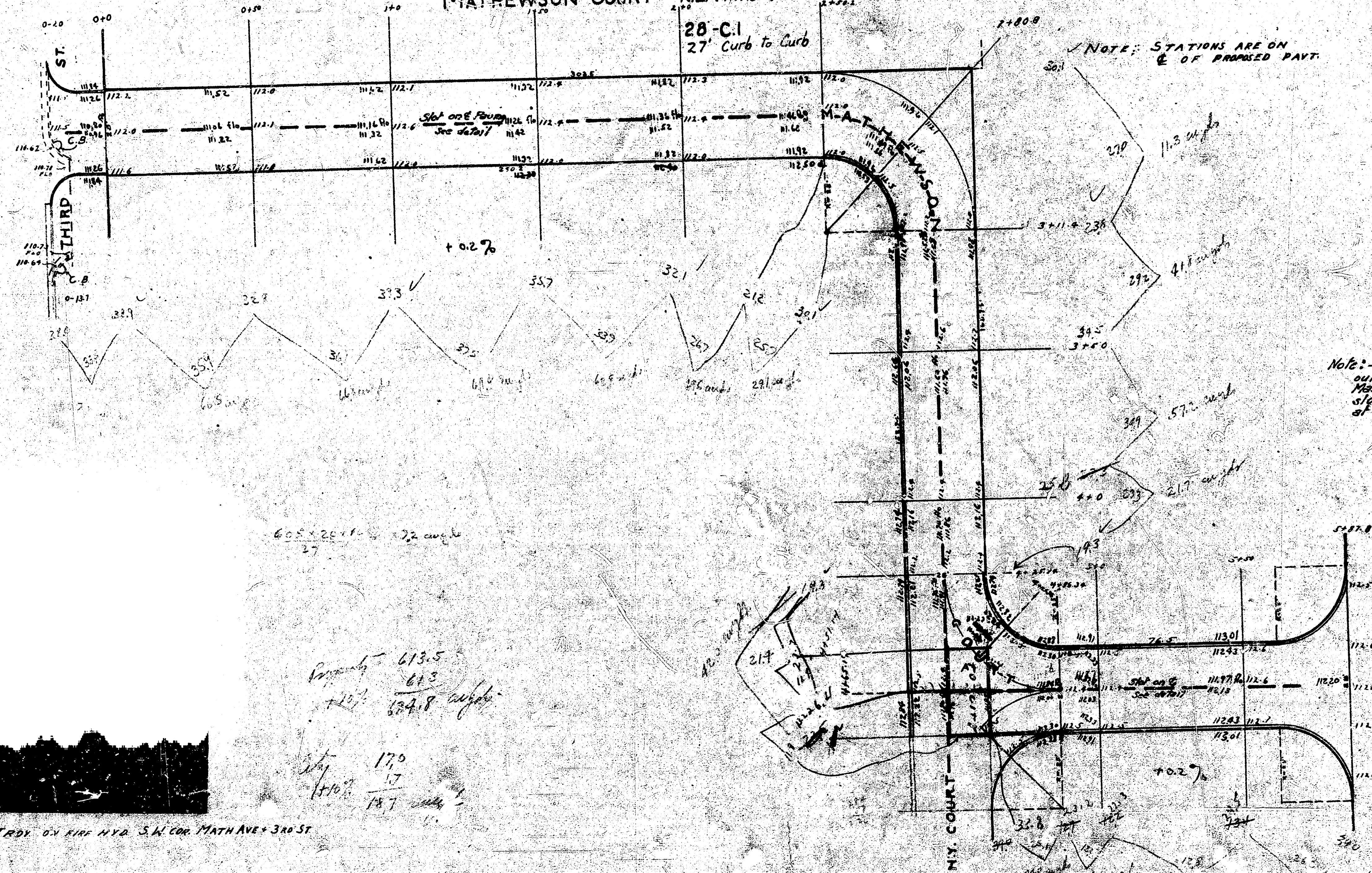

Note: - Slot on E of paving is to be scattered out at 5'-12" at the intersection of Mathewson Court and New York Court the slot is continuous east + west with a branch at right angles to the north to Mathewson Court.

605 x 22 x 10 = 22 curbs

Property 613.5
 + 12.7 = 626.2
 17.0
 18.7



B.M. 11429 T IN T.R.D. ON LINE N.Y.C. S.W. COR. MATH AVE + 3rd ST