

BM. 144.59 SPIKE IN TOP 15" STUMP  
S.L. HARVEST LANE F.W.L. WESTLINK AVE.

BM. 142.77 "B" TOP C. E.L. CHIPPER  
LANE + N. HARVEST LANE

BM. 146.92 NE COR CONC PORCH  
HOUSE #107 MAUS LANE

NOTE TO FIELD ENGINEER AND CONTRACTOR\*  
Grade and Clear Parking for Proposed  
Sidewalk. Compact Fill to Sidewalk Area.  
Sidewalk to be Constructed by Others.

Scale 1"=20'

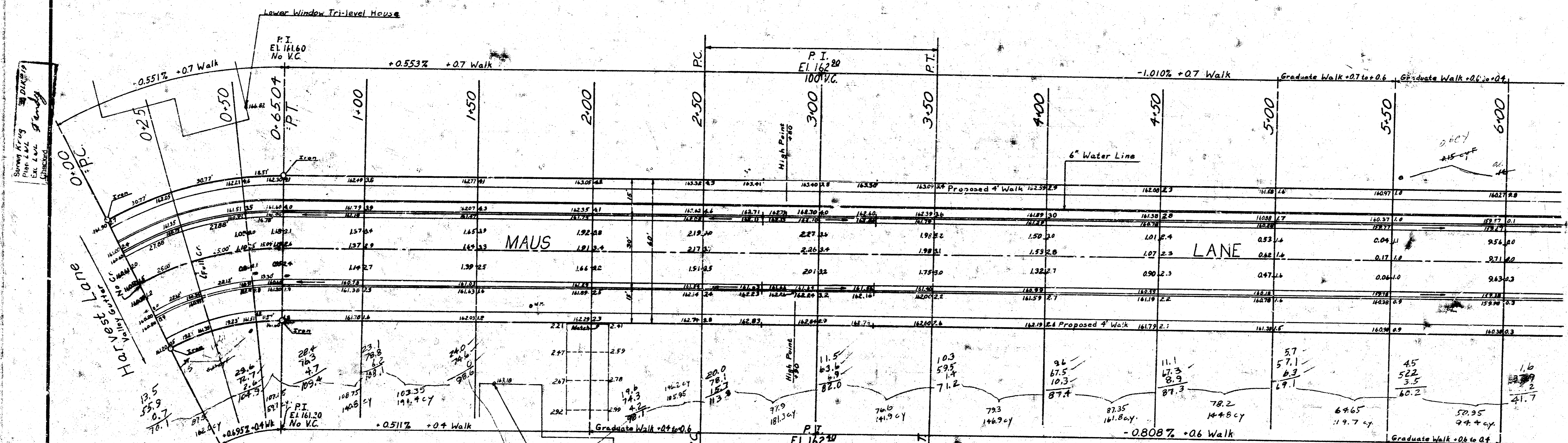

Δ = 28°40' R = 130' T = 332.2' L = 450.4' LC = 64.37'

STA.	ARC.	CHORD LENGTH	CHORD BEARING	TOTAL DEFLECTION
0+00	—	—	0°-00'-00"	0°-00'-00"
0+25	0+25	29.38'	20.55°	5°-30'-33"
0+50	0+50	29.38'	20.55°	11°-01'-06"
0+650+	0+650+	17.69'	12.37°	14°-20'-00"

Def. per Ft = 13.22207 Min.

EXCAVATION	PROPERTY	COMPACTED FILL
+10% 222.8 Cu. Yds.		F-11 0.8 Cu. Yds.
-10% 222.8 Cu. Yds.		S-GM 248.7 Cu. Yds.
Total 2451.0 Cu. Yds.		+ 43.5 Cu. Yds.
		- 3.7 Cu. Yds.
		Total 283.6 Cu. Yds.

MAUS LANE  
From N.L. Harvest Lane  
to S.L. 12<sup>th</sup> Street  
26-2-30 Asphaltic Concrete

B.E. SMITH CITY ENGINEER  
CITY OF WICHITA, KANSAS

DATE SEPTEMBER 1969 C/1827

$\Delta = 75.520^\circ R = 296.6'$  T. = 20.45' L. = 408.4' LC. = 408.1'

CURVE DATA BASED ON 184.296' RAD.  $\Delta = 75.520^\circ$

STA.	ARC.	CHORD LENGTH	CHORD BEARING	DEFLECTION	TOTAL DEFLECTION
6+16.41	—	—	—	0°-0'	0°-0'
6+50.00	3.59'	3.30'	3.85'	0°-0'	0°-0'
6+75.00	25.00'	23.06'	26.94'	2°-4'-33"	2°-4'-33"
6+87.25	12.25'	11.30'	13.20'	1°-10'-59"	3°-56'-40"

Def. per Ft. = 5.79524 Min.

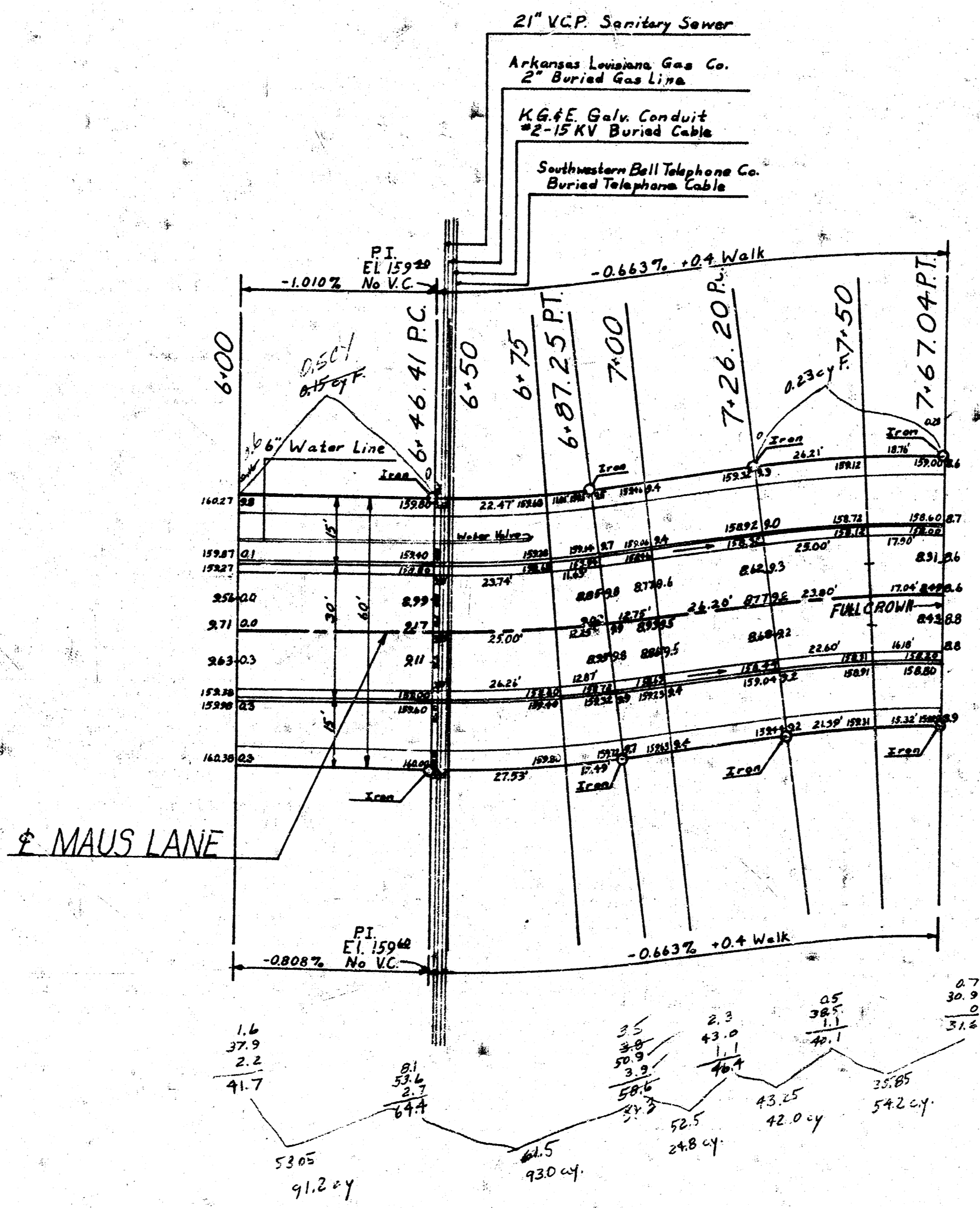

$\Delta = 75.520^\circ R = 296.6'$  T. = 20.45' L. = 408.4' LC. = 408.1'

CURVE DATA BASED ON 184.296' RAD.  $\Delta = 75.520^\circ$

STA.	ARC.	CHORD LENGTH	CHORD BEARING	DEFLECTION	TOTAL DEFLECTION
7+26.20	—	—	—	0°-0'	0°-0'
7+50.00	23.80'	23.82'	18.39'	2°-17'-53"	2°-17'-53"
7+67.00	17.00'	15.74'	15.74'	1°-38'-45"	3°-56'-40"

Def. per Ft. = 5.79524 Min.