

CM #70

B.M. 12597 - on SE corner mid gump base W.S. Broadway fALS 25th
B.M. 12878 - NE corner caping corner canal bridge on Market
B.M. 12402 - Top of flume, cfm Broadway f25th
B.M. 12682 - Top R.R. iron marker, SE Broadway f25th

Note to field engineer:-
Re-cross sections to be taken
before construction begins.

Note:
3/4" = 100' H.

N

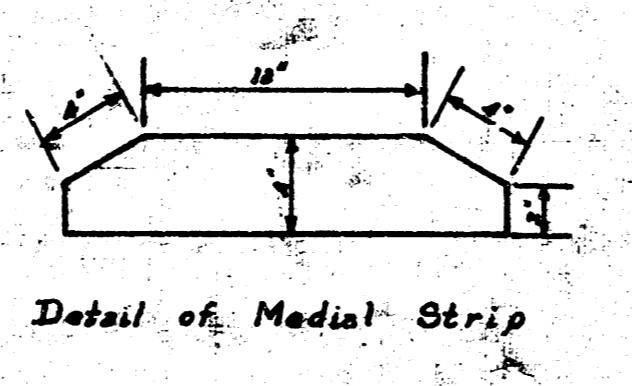
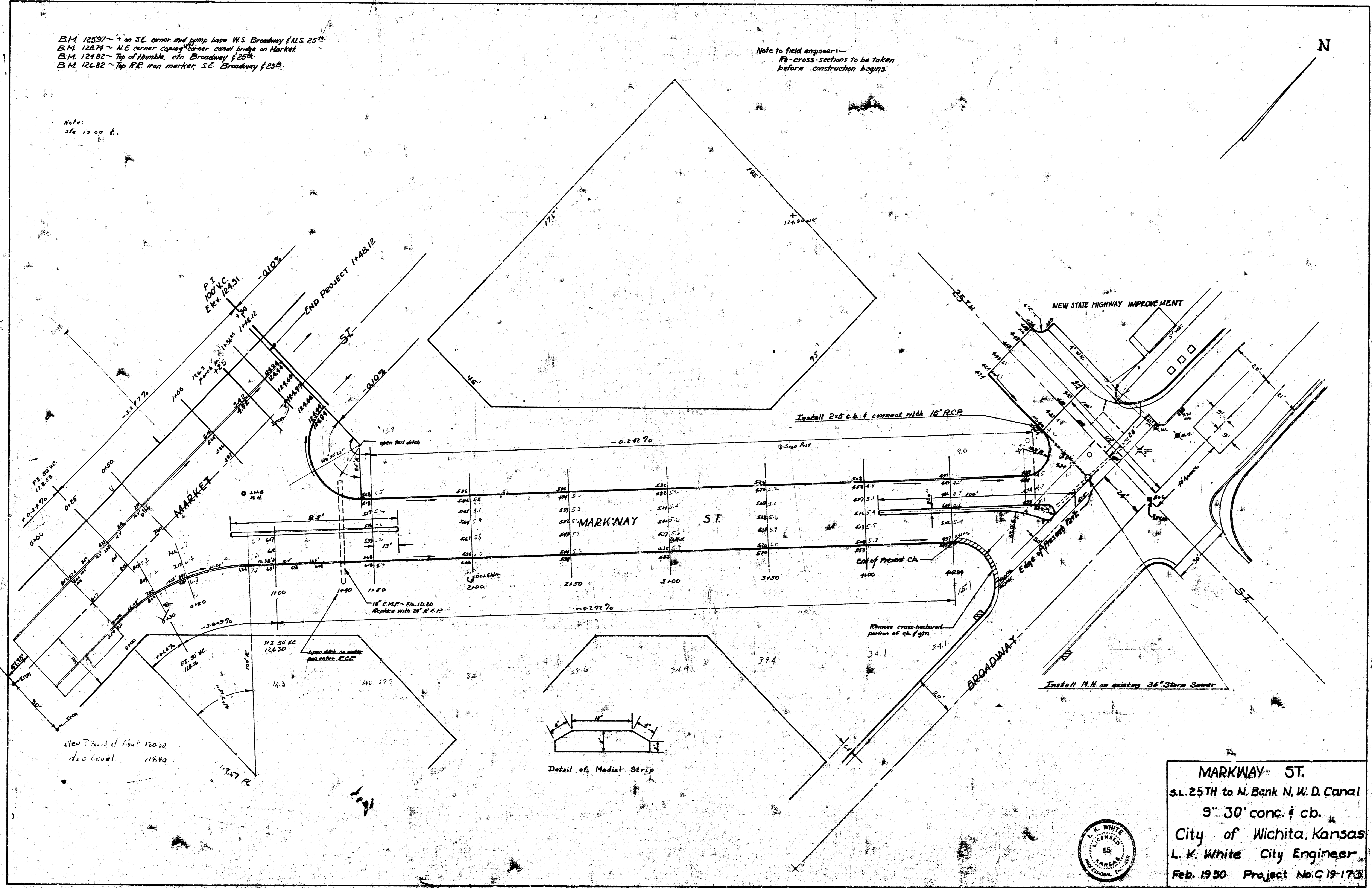

MARKWAY ST.
 S.L. 25TH to N. Bank N.W. D. Canal
 9" 30' conc. & cb.
 City of Wichita, Kansas
 L. K. White City Engineer
 Feb. 1930 Project No. C 19-173

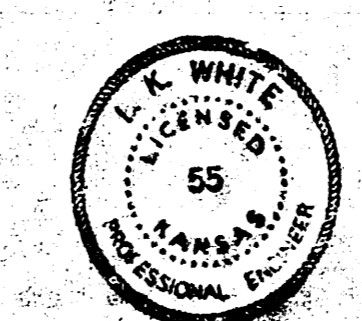

RETAINING WALL AT NORTH BRIDGE ABUTMENT MARKET STREET AND DRAINAGE CANAL

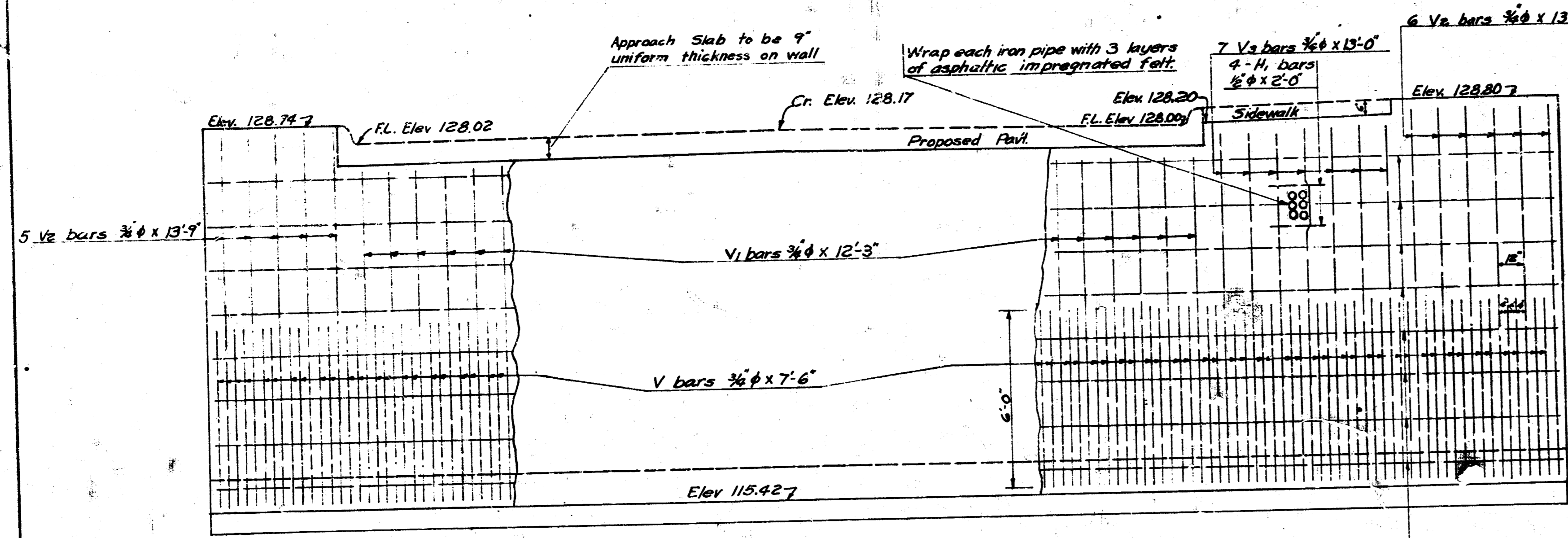

ELEVATION

B.M. 128.74 NE Corner Coping, N.W. Corner Canal Bridge on Market.

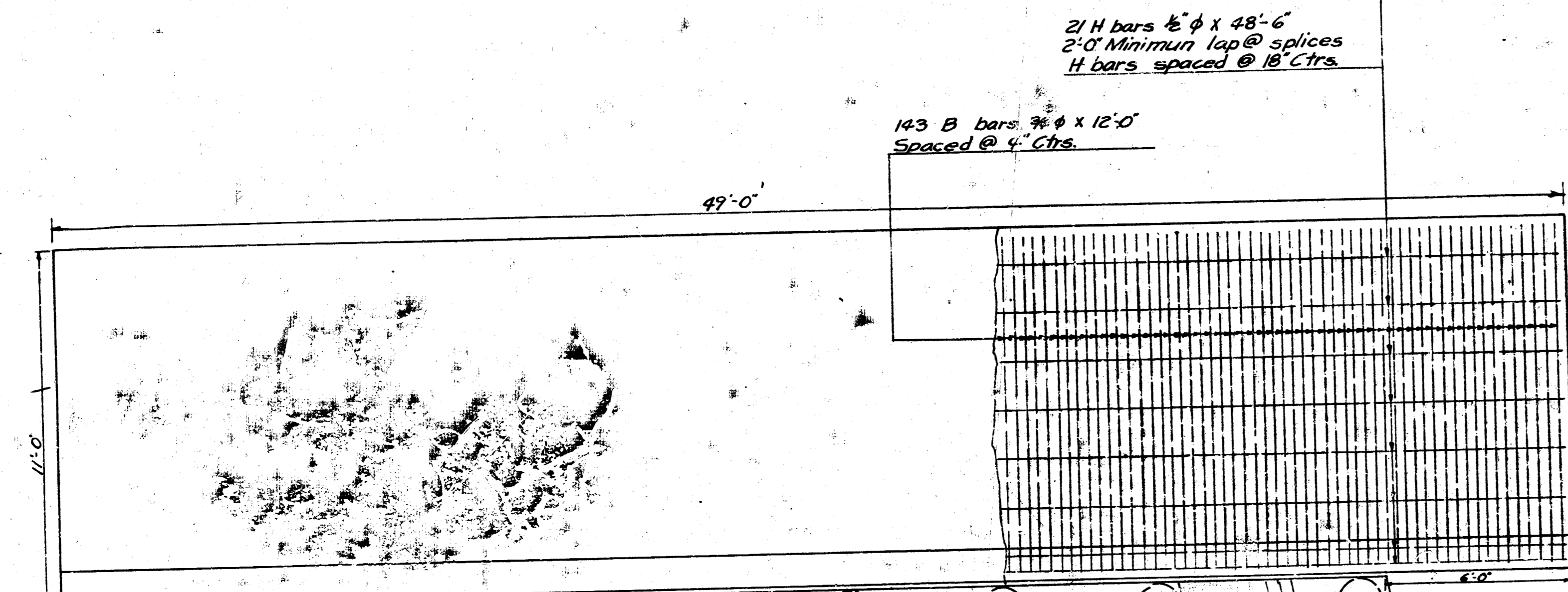

PLAN

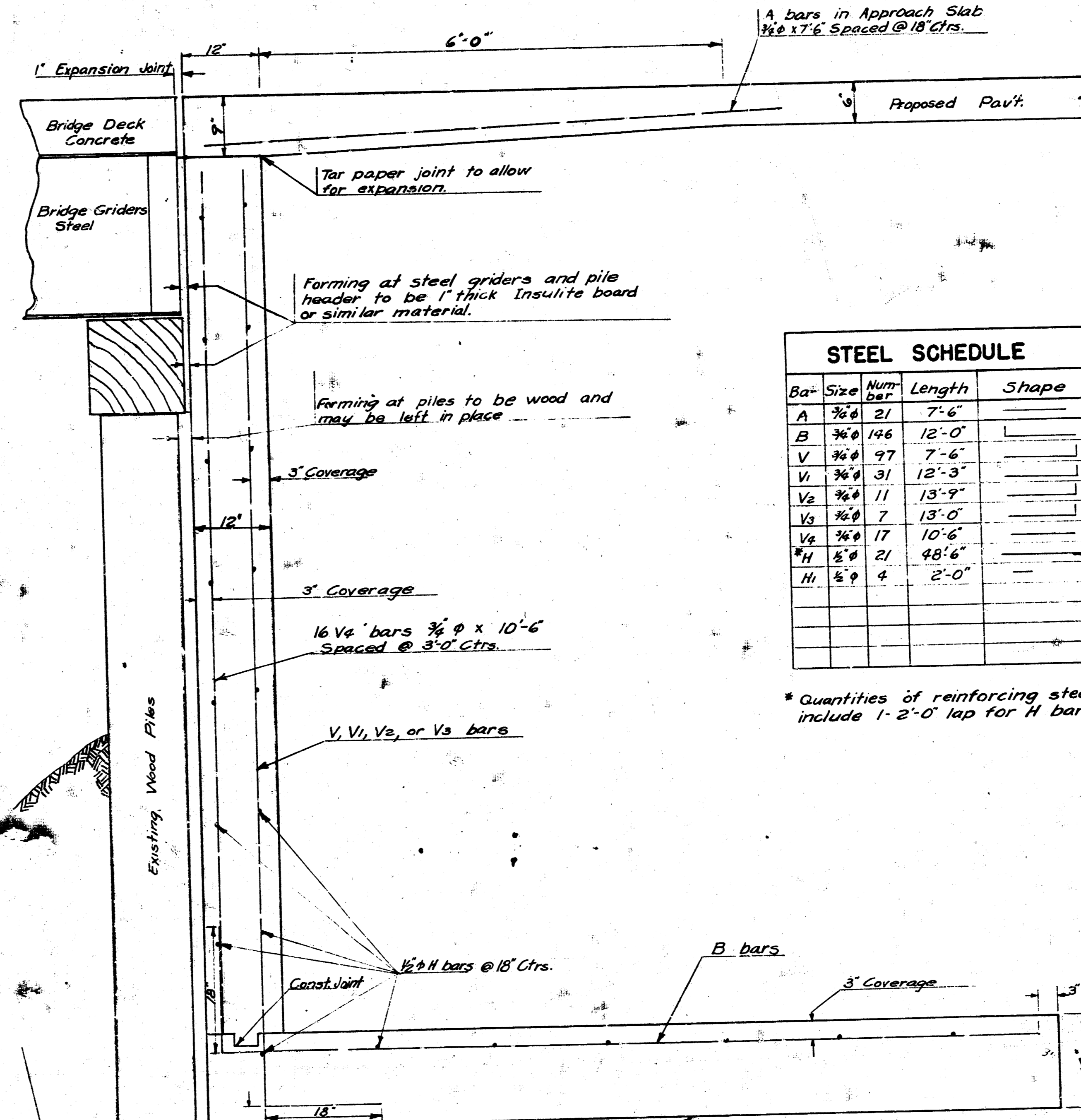

SECTION

STEEL SCHEDULE				
Bar	Size	Num	Length	Shape
A	#6	21	7'-6"	
B	#6	146	12'-0"	
V	#6	97	7'-6"	
V ₁	#6	31	12'-3"	
V ₂	#6	11	13'-9"	
V ₃	#6	7	13'-0"	
V ₄	#6	17	10'-6"	
H	#6	21	48'-6"	
H	#6	4	2'-0"	

* Quantities of reinforcing steel include 1'-2'-0" lap for H bars.

BILL OF MATERIALS		
ITEM	QUANTITY	UNITS
Class A Concrete	46	Cu Yds
Reinforcing Steel	5877	Lbs.
General Excavation	380	Cu Yds