

B.M. 9130 S.E. Cor. Conc. Porch No. #1502 N 30th St. So.
 B.M. 9902 S.E. Cor. Conc. Porch No. #2915 S. Elizabeth.

Sta. 4 Baseline on W. 12 of Martinson from Sta. 0+00 to Sta. 14+64.50;
 Sta. on G' Offset from W. Co. Sta. 14+64.90 to Sta. 16+17.56

PROP. EXCAV.
 13371.5 CU. YD.

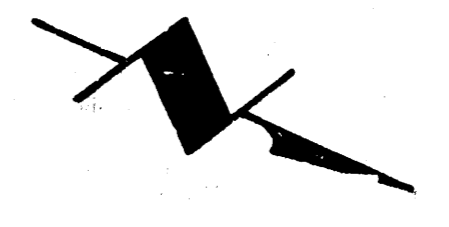
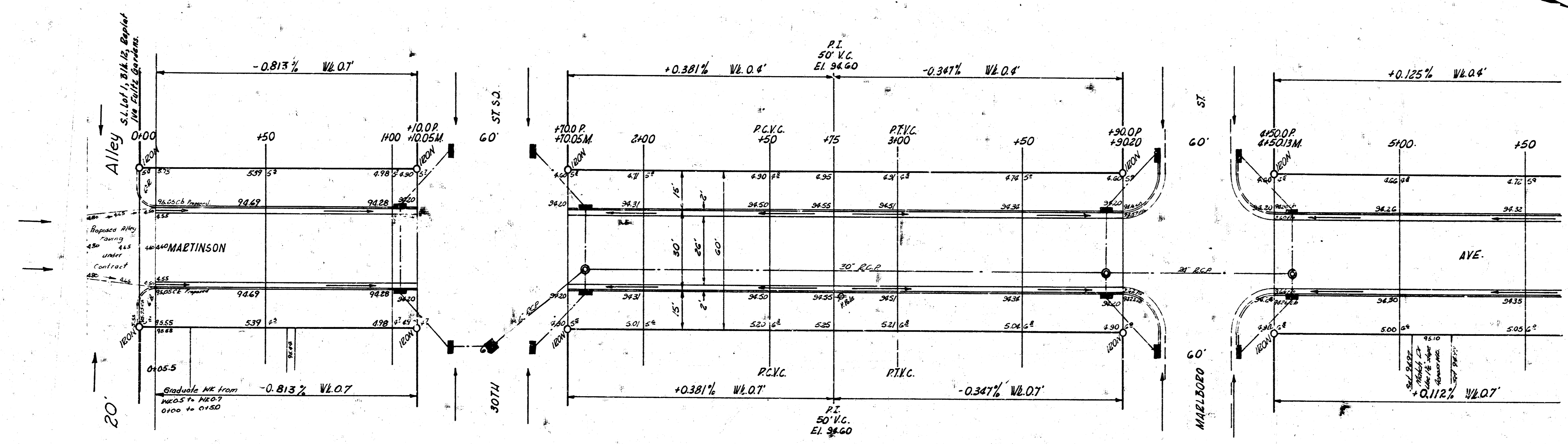

1/5

MARTINSON AVE.
 S.L. REGAL - S.L. LOT 1, BLK. 12,
 REPLAT IVA FULTZ GARDENS
 26'-2'-30" A.C.
 CITY OF WICHITA, KANS.
 B.E. SMITH CITY ENGINEER
 Aug., 1956 PROJ. NO. C14-204



TOTAL PROP. EXCAV.
 13371.5
 10% 1337.15
 12834.35

NOTE: Original walk grade set 0.4 raised walk grade to 0.7 to help drives poured to high.

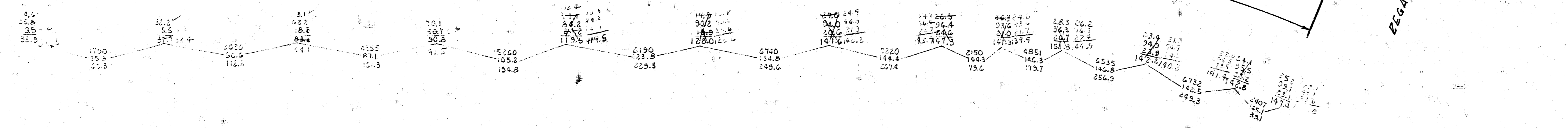
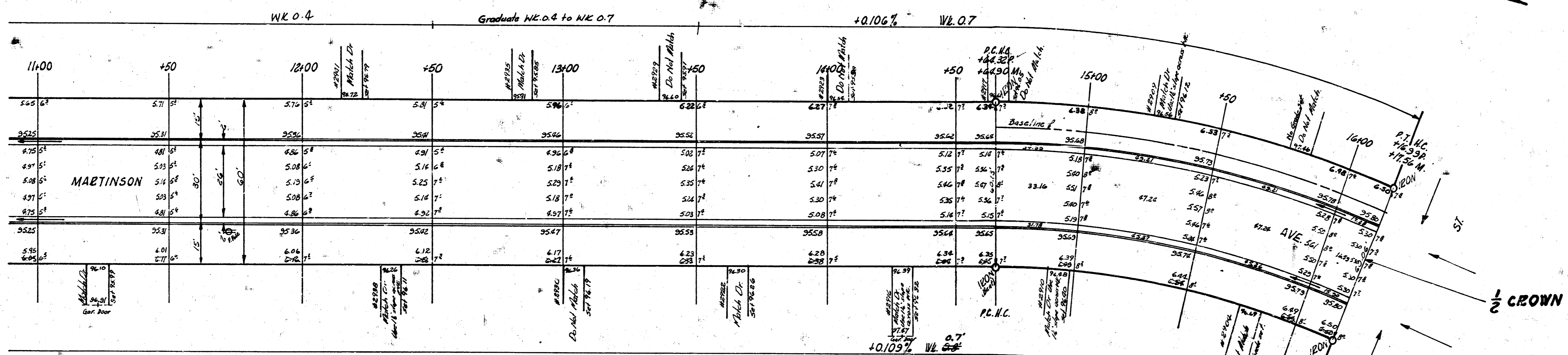

Curve Data from Sta 14+63.0 to Sta 16+17.56

Sta	Chain Length	Chain Length	Deflection	Tan. Len	Deflection
Sta	Offset	Offset	Angle		
14+63.00					
15+00	35.09	31.21	2°38'33"	2°38'33"	
15+50	63.52	44.45	3°45'59"	2°44'38"	
16+10	83.37	64.45	3°46'00"	10°10'38"	
17.56	17.56	15.02	1°12'22"	11°30'00"	

MARTINSON AVE
PLAN 14254 L04