

**M<sup>C</sup>LEAN BOULEVARD**  
 N.L. 15TH. ST. TO LEFT BANK BIG ARK. RIVER  
 PROJ. NO. C12-1

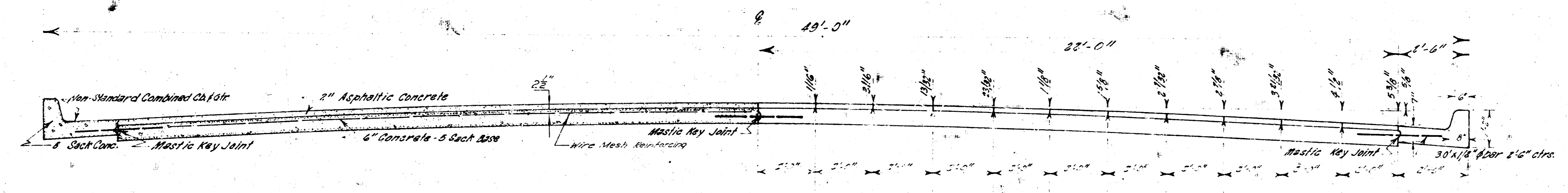

TYPICAL SECTION  
 Scale: 1" = 2'-0"

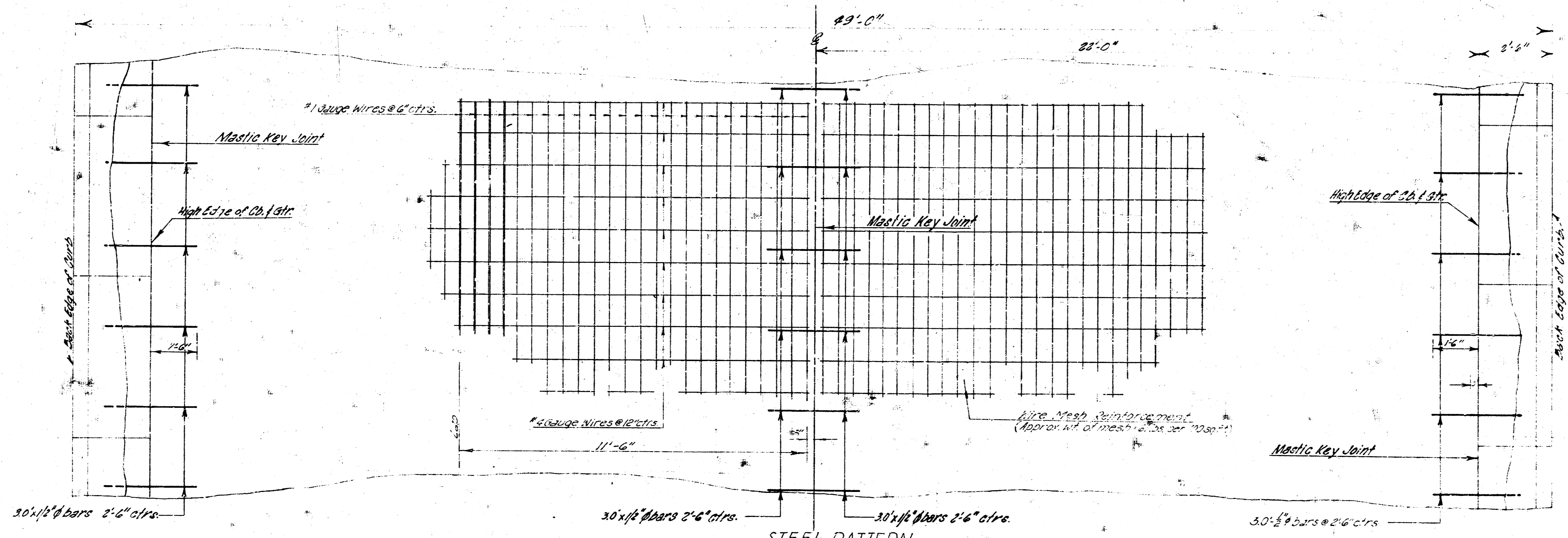

STEEL PATTERN  
 Scale: 1" = 2'-0"

300 lbs. wire mesh per 100 sq. ft. of area. The mesh is to be placed in the concrete and is to be secured with the concrete. The mesh is to be placed in the concrete and is to be secured with the concrete. The mesh is to be placed in the concrete and is to be secured with the concrete.

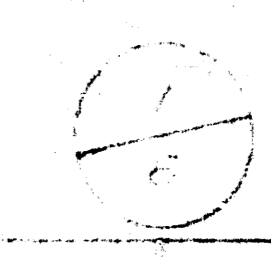

B.M. 120.40 "M" in Mueller 100 fire hnd. on NW Cor. 15<sup>th</sup> & Charles  
 B.M. 118.96 "X" cut top N. of 15<sup>th</sup> St. 4' west of wend Rad. on NW Cor. 15<sup>th</sup> & McLean  
 Base-Line of McLean Avenue Project

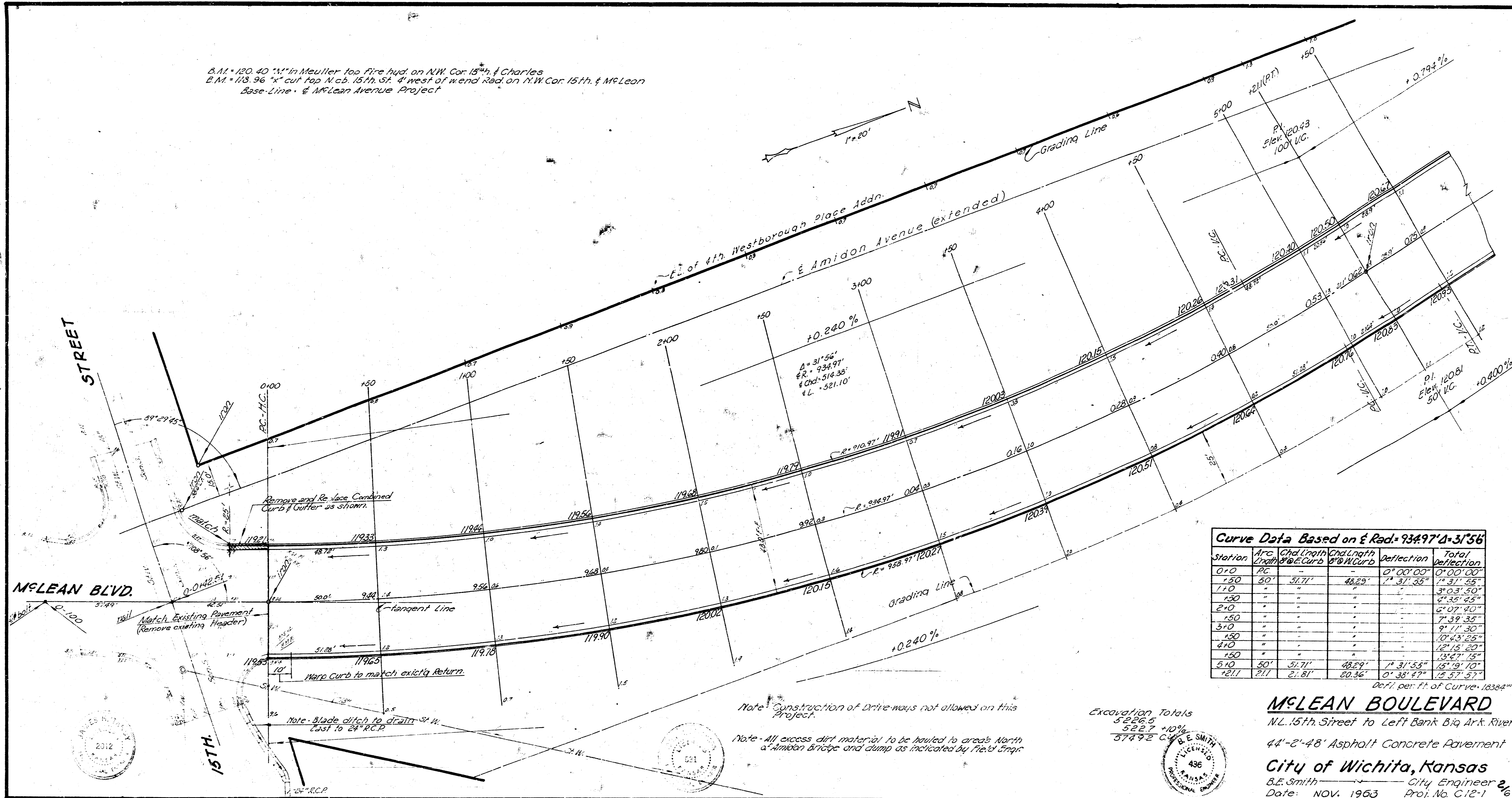

**Curve Data Based on E Rad. = 934.97' Δ = 31°56'**

Station	Arc Length	Chal. Length	Chal. Length @ 2' W. Curb	Deflection	Total Deflection
0+0	PC	-	-	0° 00' 00"	0° 00' 00"
1+0	50'	51.71'	48.29'	1° 31' 35"	1° 31' 35"
2+0	100'	103.42'	96.58'	2° 58' 45"	3° 03' 50"
3+0	150'	155.13'	144.87'	4° 25' 55"	4° 07' 40"
4+0	200'	206.84'	193.16'	5° 53' 05"	5° 39' 35"
5+0	250'	258.55'	241.45'	7° 20' 15"	7° 11' 30"
6+0	300'	310.26'	289.74'	8° 47' 25"	10° 03' 25"
7+0	350'	361.97'	338.03'	10° 14' 35"	12° 15' 20"
8+0	400'	413.68'	386.32'	11° 41' 45"	15° 27' 15"
9+0	450'	465.39'	434.61'	13° 08' 55"	18° 39' 10"
10+0	500'	517.10'	482.90'	14° 36' 05"	21° 51' 05"

Defl. per Ft. of Curve = .03382"

Excavation Totals  
 5226.5  
 922.7 = 10%  
 5749.2 C.M.

**MCLEAN BOULEVARD**  
 N.L. 15<sup>th</sup> Street to Left Bank Big Ark. River  
 44'-2'-48" Asphalt Concrete Pavement  
 City of Wichita, Kansas  
 B.E. Smith City Engineer 2/6  
 Date: NOV. 1963 Proj. No. C12-1

Note: Construction of Drive ways not allowed on this Project.  
 Note: All excess dirt material to be hauled to areas North of Amidon Avenue and dump as indicated by Field Eng.

3/20/72 #99  
 Sewer  
 From Map E. 16  
 11/2/63



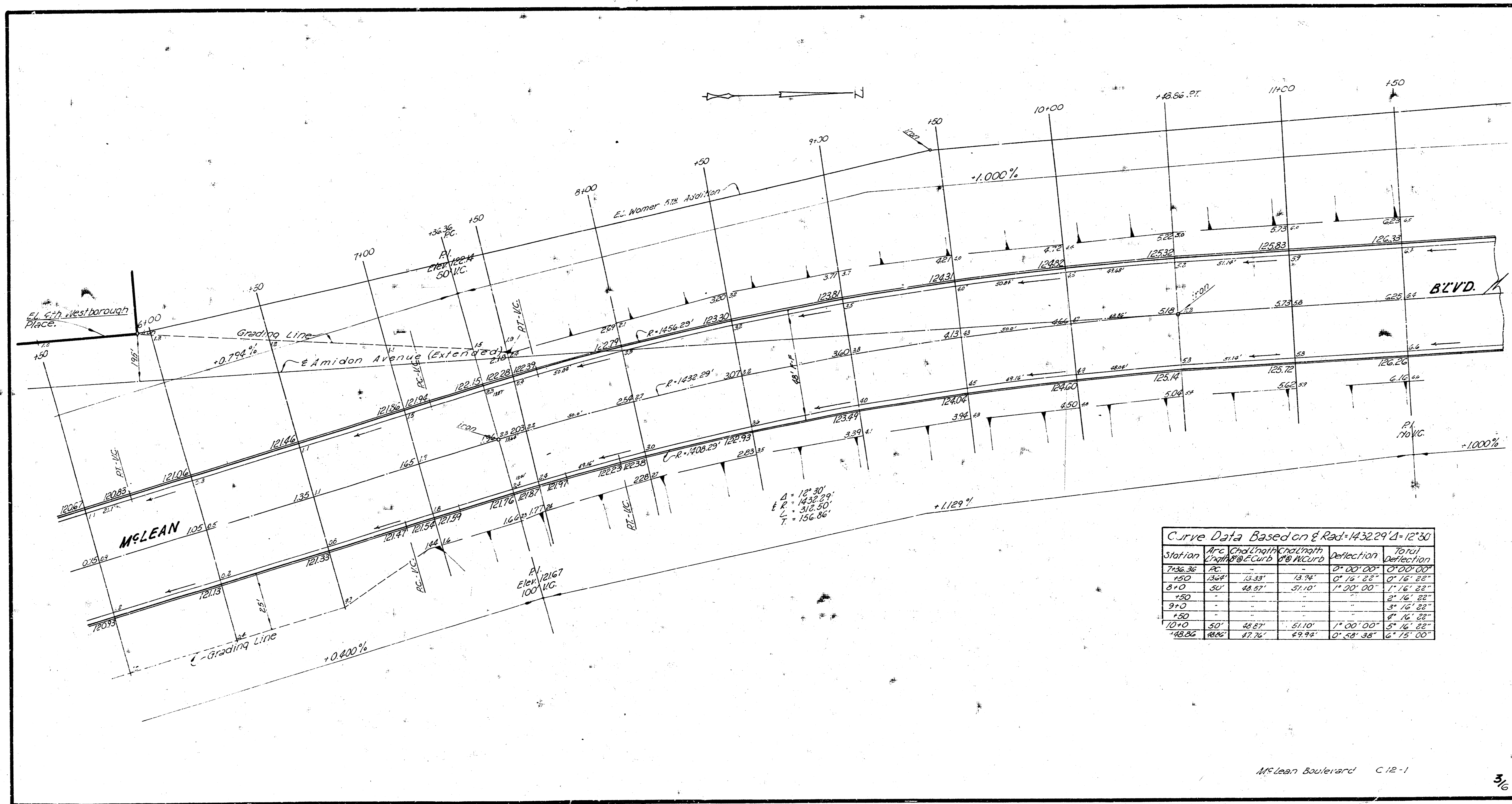

Curve Data Based on  $R=1432.29' @ 12^{\circ}30'$

Station	PC	PT	Curve Length	Deflection	Total Deflection
12067	12067	12106	39.33'	13.74°	0° 16' 22"
12106	12106	12145	39.33'	13.74°	0° 32' 44"
12145	12145	12184	39.33'	13.74°	0° 48' 58"
12184	12184	12223	39.33'	13.74°	1° 05' 12"
12223	12223	12262	39.33'	13.74°	1° 21' 26"
12262	12262	12301	39.33'	13.74°	1° 37' 40"
12301	12301	12340	39.33'	13.74°	1° 53' 54"
12340	12340	12379	39.33'	13.74°	2° 10' 08"
12379	12379	12418	39.33'	13.74°	2° 26' 22"
12418	12418	12457	39.33'	13.74°	2° 42' 36"
12457	12457	12496	39.33'	13.74°	2° 58' 50"
12496	12496	12535	39.33'	13.74°	3° 15' 04"
12535	12535	12574	39.33'	13.74°	3° 31' 18"
12574	12574	12613	39.33'	13.74°	3° 47' 32"
12613	12613	12652	39.33'	13.74°	4° 03' 46"
12652	12652	12691	39.33'	13.74°	4° 19' 59"
12691	12691	12730	39.33'	13.74°	4° 36' 13"
12730	12730	12769	39.33'	13.74°	4° 52' 27"
12769	12769	12808	39.33'	13.74°	5° 08' 41"
12808	12808	12847	39.33'	13.74°	5° 24' 55"
12847	12847	12886	39.33'	13.74°	5° 41' 09"
12886	12886	12925	39.33'	13.74°	5° 57' 23"
12925	12925	12964	39.33'	13.74°	6° 13' 37"
12964	12964	13003	39.33'	13.74°	6° 29' 51"
13003	13003	13042	39.33'	13.74°	6° 46' 05"
13042	13042	13081	39.33'	13.74°	7° 02' 19"
13081	13081	13120	39.33'	13.74°	7° 18' 33"
13120	13120	13159	39.33'	13.74°	7° 34' 47"
13159	13159	13198	39.33'	13.74°	7° 51' 01"
13198	13198	13237	39.33'	13.74°	8° 07' 15"
13237	13237	13276	39.33'	13.74°	8° 23' 29"
13276	13276	13315	39.33'	13.74°	8° 39' 43"
13315	13315	13354	39.33'	13.74°	8° 55' 57"
13354	13354	13393	39.33'	13.74°	9° 12' 11"
13393	13393	13432	39.33'	13.74°	9° 28' 25"
13432	13432	13471	39.33'	13.74°	9° 44' 39"
13471	13471	13510	39.33'	13.74°	10° 00' 53"
13510	13510	13549	39.33'	13.74°	10° 17' 07"
13549	13549	13588	39.33'	13.74°	10° 33' 21"
13588	13588	13627	39.33'	13.74°	10° 49' 35"
13627	13627	13666	39.33'	13.74°	11° 05' 49"
13666	13666	13705	39.33'	13.74°	11° 22' 03"
13705	13705	13744	39.33'	13.74°	11° 38' 17"
13744	13744	13783	39.33'	13.74°	11° 54' 31"
13783	13783	13822	39.33'	13.74°	12° 10' 45"
13822	13822	13861	39.33'	13.74°	12° 26' 59"
13861	13861	13900	39.33'	13.74°	12° 43' 13"
13900	13900	13939	39.33'	13.74°	12° 59' 27"
13939	13939	13978	39.33'	13.74°	13° 15' 41"
13978	13978	14017	39.33'	13.74°	13° 31' 55"
14017	14017	14056	39.33'	13.74°	13° 48' 09"
14056	14056	14095	39.33'	13.74°	14° 04' 23"
14095	14095	14134	39.33'	13.74°	14° 20' 37"
14134	14134	14173	39.33'	13.74°	14° 36' 51"
14173	14173	14212	39.33'	13.74°	14° 53' 05"
14212	14212	14251	39.33'	13.74°	15° 09' 19"
14251	14251	14290	39.33'	13.74°	15° 25' 33"
14290	14290	14329	39.33'	13.74°	15° 41' 47"
14329	14329	14368	39.33'	13.74°	15° 58' 01"
14368	14368	14407	39.33'	13.74°	16° 14' 15"
14407	14407	14446	39.33'	13.74°	16° 30' 29"
14446	14446	14485	39.33'	13.74°	16° 46' 43"
14485	14485	14524	39.33'	13.74°	17° 02' 57"
14524	14524	14563	39.33'	13.74°	17° 19' 11"
14563	14563	14602	39.33'	13.74°	17° 35' 25"
14602	14602	14641	39.33'	13.74°	17° 51' 39"
14641	14641	14680	39.33'	13.74°	18° 07' 53"
14680	14680	14719	39.33'	13.74°	18° 24' 07"
14719	14719	14758	39.33'	13.74°	18° 40' 21"
14758	14758	14797	39.33'	13.74°	18° 56' 35"
14797	14797	14836	39.33'	13.74°	19° 12' 49"
14836	14836	14875	39.33'	13.74°	19° 29' 03"
14875	14875	14914	39.33'	13.74°	19° 45' 17"
14914	14914	14953	39.33'	13.74°	20° 01' 31"
14953	14953	14992	39.33'	13.74°	20° 17' 45"
14992	14992	15031	39.33'	13.74°	20° 33' 59"
15031	15031	15070	39.33'	13.74°	20° 50' 13"
15070	15070	15109	39.33'	13.74°	21° 06' 27"
15109	15109	15148	39.33'	13.74°	21° 22' 41"
15148	15148	15187	39.33'	13.74°	21° 38' 55"
15187	15187	15226	39.33'	13.74°	21° 55' 09"
15226	15226	15265	39.33'	13.74°	22° 11' 23"
15265	15265	15304	39.33'	13.74°	22° 27' 37"
15304	15304	15343	39.33'	13.74°	22° 43' 51"
15343	15343	15382	39.33'	13.74°	22° 59' 05"
15382	15382	15421	39.33'	13.74°	23° 15' 19"
15421	15421	15460	39.33'	13.74°	23° 31' 33"
15460	15460	15499	39.33'	13.74°	23° 47' 47"
15499	15499	15538	39.33'	13.74°	24° 04' 01"
15538	15538	15577	39.33'	13.74°	24° 20' 15"
15577	15577	15616	39.33'	13.74°	24° 36' 29"
15616	15616	15655	39.33'	13.74°	24° 52' 43"
15655	15655	15694	39.33'	13.74°	25° 08' 57"
15694	15694	15733	39.33'	13.74°	25° 25' 11"
15733	15733	15772	39.33'	13.74°	25° 41' 25"
15772	15772	15811	39.33'	13.74°	25° 57' 39"
15811	15811	15850	39.33'	13.74°	26° 13' 53"
15850	15850	15889	39.33'	13.74°	26° 30' 07"
15889	15889	15928	39.33'	13.74°	26° 46' 21"
15928	15928	15967	39.33'	13.74°	27° 02' 35"
15967	15967	16006	39.33'	13.74°	27° 18' 49"
16006	16006	16045	39.33'	13.74°	27° 35' 03"
16045	16045	16084	39.33'	13.74°	27° 51' 17"
16084	16084	16123	39.33'	13.74°	28° 07' 31"
16123	16123	16162	39.33'	13.74°	28° 23' 45"
16162	16162	16201	39.33'	13.74°	28° 39' 59"
16201	16201	16240	39.33'	13.74°	28° 56' 13"
16240	16240	16279	39.33'	13.74°	29° 12' 27"
16279	16279	16318	39.33'	13.74°	29° 28' 41"
16318	16318	16357	39.33'	13.74°	29° 44' 55"
16357	16357	16396	39.33'	13.74°	30° 01' 09"
16396	16396	16435	39.33'	13.74°	30° 17' 23"
16435	16435	16474	39.33'	13.74°	30° 33' 37"
16474	16474	16513	39.33'	13.74°	30° 49' 51"
16513	16513	16552	39.33'	13.74°	31° 06' 05"
16552	16552	16591	39.33'	13.74°	31° 22' 19"
16591	16591	16630	39.33'	13.74°	31° 38' 33"
16630	16630	16669	39.33'	13.74°	31° 54' 47"
16669	16669	16708	39.33'	13.74°	32° 11' 01"
16708	16708	16747	39.33'	13.74°	32° 27' 15"
16747	16747	16786	39.33'	13.74°	32° 43' 29"
16786	16786	16825	39.33'	13.74°	32° 59' 43"
16825	16825	16864	39.33'	13.74°	33° 15' 57"
16864	16864	16903	39.33'	13.74°	33° 32' 11"
16903	16903	16942	39.33'	13.74°	33° 48' 25"
16942	16942	16981	39.33'	13.74°	34° 04' 39"
16981	16981	17020	39.33'	13.74°	34° 20' 53"
17020	17020	17059	39.33'	13.74°	34° 37' 07"
17059	17059	17098	39.33'	13.74°	34° 53' 21"
17098	17098	17137	39.33'	13.74°	35° 09' 35"
17137	17137	17176	39.33'	13.74°	35° 25' 49"
17176	17176	17215	39.33'	13.74°	35° 42' 03"
17215	17215	17254	39.33'	13.74°	35° 58' 17"
17254	17254	17293	39.33'	13.74°	36° 14' 31"
17293	17293	17332	39.33'	13.74°	36° 30' 45"
17332	17332	17371	39.33'	13.74°	36° 46' 59"
17371	17371	17410	39.33'	13.74°	37° 03' 13"
17410	17410	17449	39.33'	13.74°	37° 19' 27"
17449	17449	17488	39.33'	13.74°	37° 35' 41"
17488	17488	17527	39.33'	13.74°	37° 51' 55"
17527	17527	17566	39.33'	13.74°	38° 08' 09"
17566	17566	17605	39.33'	13.74°	38° 24' 23"
17605	17605	17644	39.33'	13.74°	38° 40' 37"
17644	17644	17683	39.33'	13.74°	38° 56' 51"
17683	17683	17722	39.33'	13.74°	39° 13' 05"
17722	17722	17761	39.33'	13.74°	39° 29' 19"
17761	17761	17800	39.33'	13.74°	39° 45' 33"
17800	17800	17839	39.33'	13.74°	39° 61' 47"
17839	17839	17878	39.33'	13.74°	39° 58' 01"
17878	17878	17917	39.33'	13.74°	40° 14' 15"
17917	17917	17956	39.33'	13.74°	40° 30' 29"
17956	17956	17995	39.33'	13.74°	40° 46' 43"
17995	17995	18034	39.33'		

