

1. REVISIONS  
 2. CHANGES  
 3. EROSION  
 4. ALLEY  
 5. C.P.

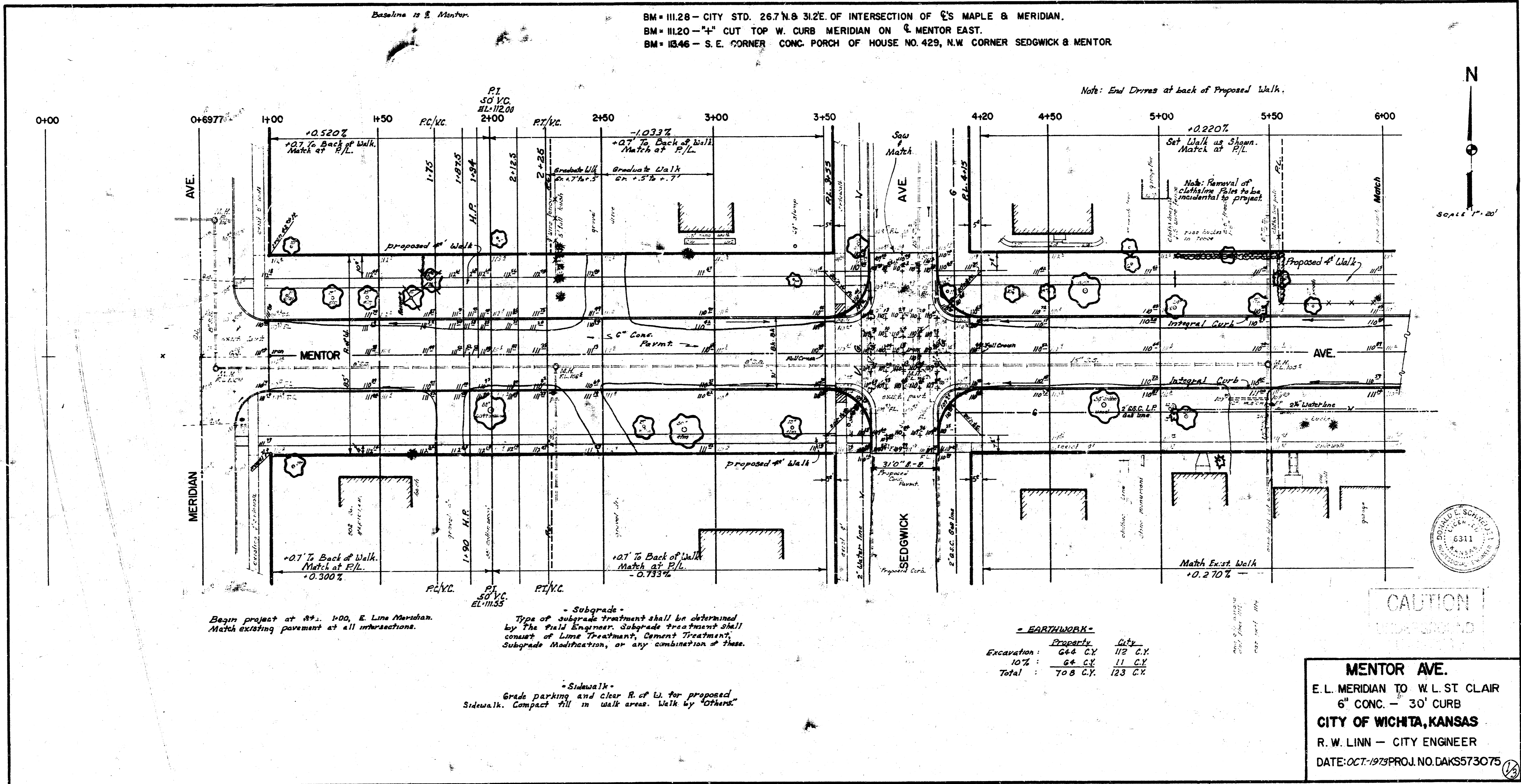

Baseline is E. Mentor.  
 BM=11128 - CITY STD. 26.7 N. & 31.2 E. OF INTERSECTION OF E'S MAPLE & MERIDIAN.  
 BM=1120 - 4" CUT TOP W. CURB MERIDIAN ON E MENTOR EAST.  
 BM=11346 - S. E. CORNER CONC. PORCH OF HOUSE NO. 429, N.W. CORNER SEDGWICK & MENTOR.

Note: End Drives at back of Proposed Walk.

N  
 Scale 1" = 20'

Begin project at Sta. 1+00, E. Line Meridian.  
 Match existing pavement at all intersections.

- Subgrade -  
 Type of subgrade treatment shall be determined by the field Engineer. Subgrade treatment shall consist of Lime Treatment, Cement Treatment, Subgrade Modification, or any combination of these.

- Sidewalk -  
 Grade parking and clear R. of W. for proposed Sidewalk. Compact fill in walk areas. Walk by "Others".

- EARTHWORK -

	Property	City
Excavation:	644 C.Y.	119 C.Y.
10%:	64 C.Y.	11 C.Y.
Total:	708 C.Y.	130 C.Y.

CAUTION  
 ROAD WORK  
 6311  
**MENTOR AVE.**  
 E. L. MERIDIAN TO W. L. ST. CLAIR  
 6" CONC. - 30' CURB  
**CITY OF WICHITA, KANSAS**  
 R. W. LINN - CITY ENGINEER  
 DATE: OCT-1973 PROJ. NO. DAKS573075

SM = 113.46 - S.E. CORNER PORCH OF HOUSE NO. 429, N.W. CORNER SEDGWICK & MENTOR.  
 BM = 111.88 - "4" CUT TOP OF E. CURB ST. CLAIR ON E. MENTOR WEST.

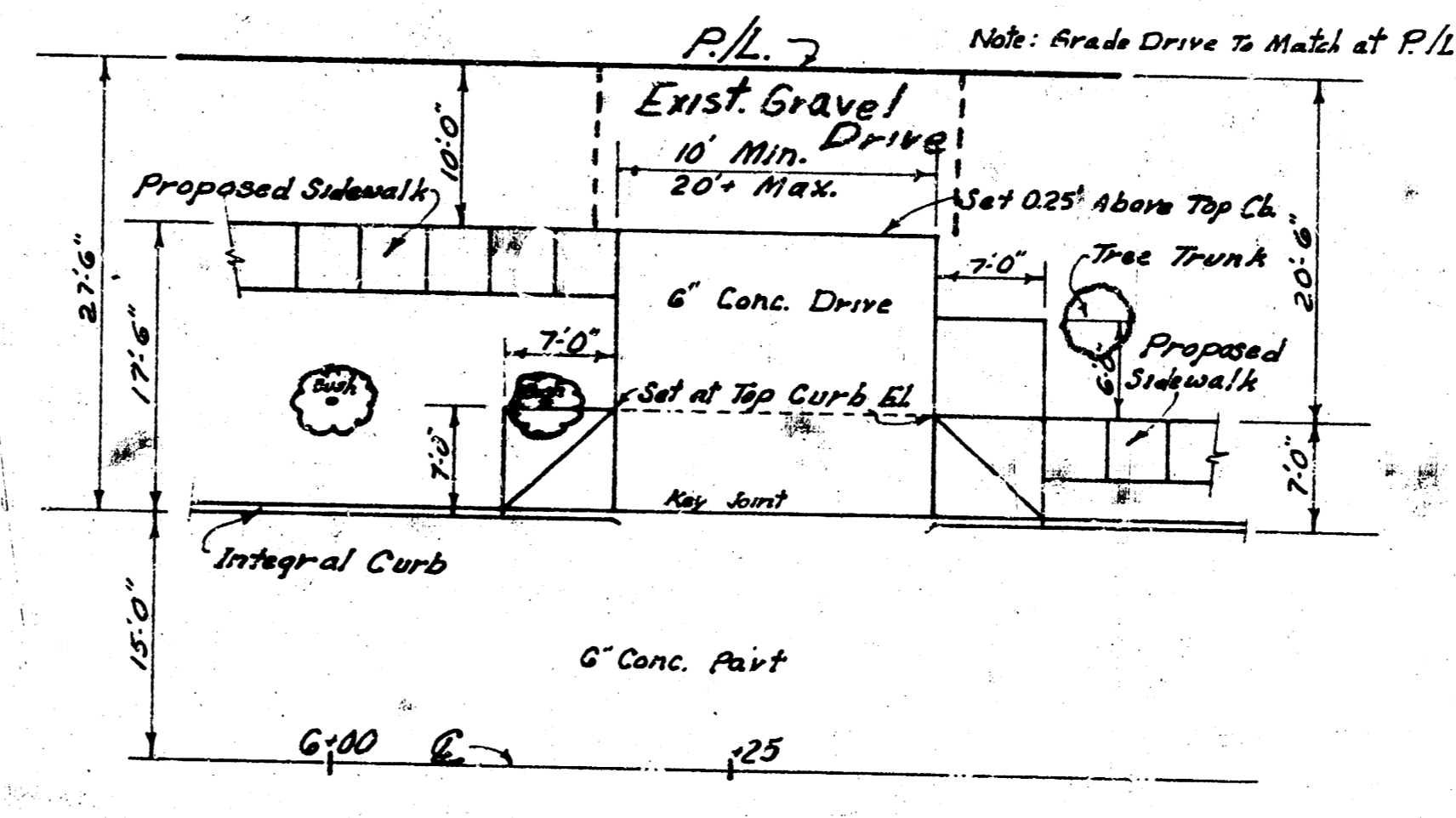
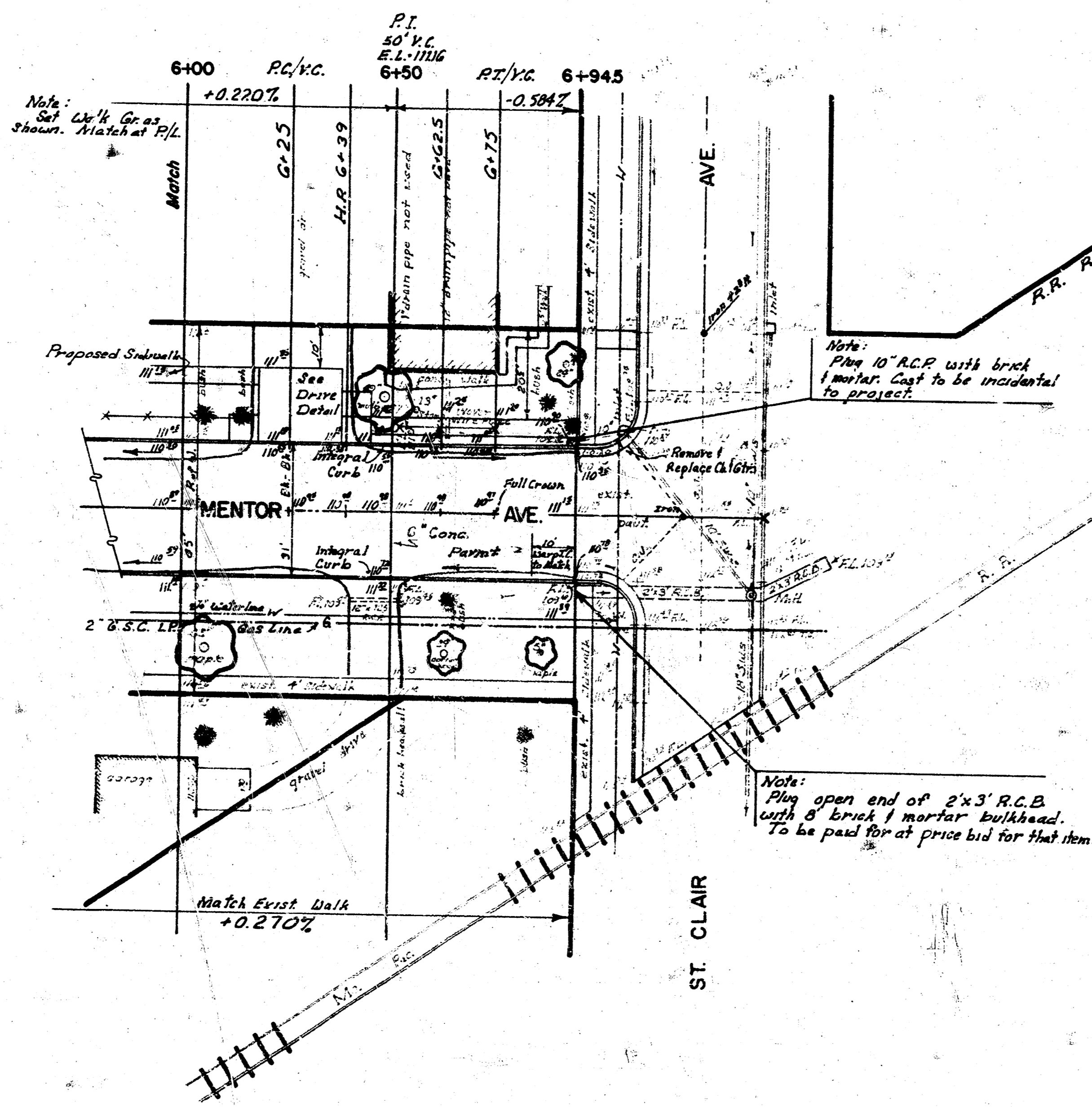

SPECIAL RAMP DRIVE DETAILS  
 SCALE: 1" = 10'

MENTOR AVE.  
 E. L. MERIDIAN TO W. L. ST. CLAIR