

MERIDIAN AVENUE

S.L. BUILDERS 17TH ADDN TO Q 33RD ST

25'-2'-30" ASPH CONC
IMPROVE TO 44'

C 10-94

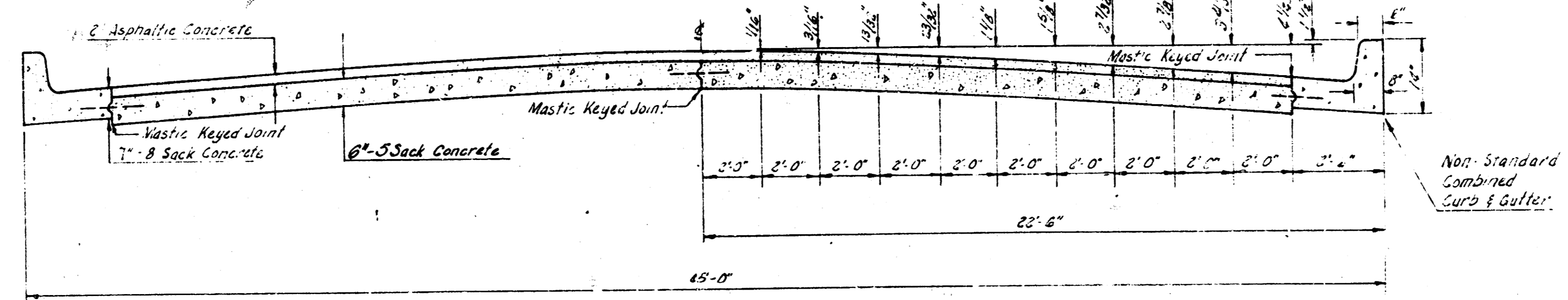

TYPICAL SECTION
NOT TO SCALE

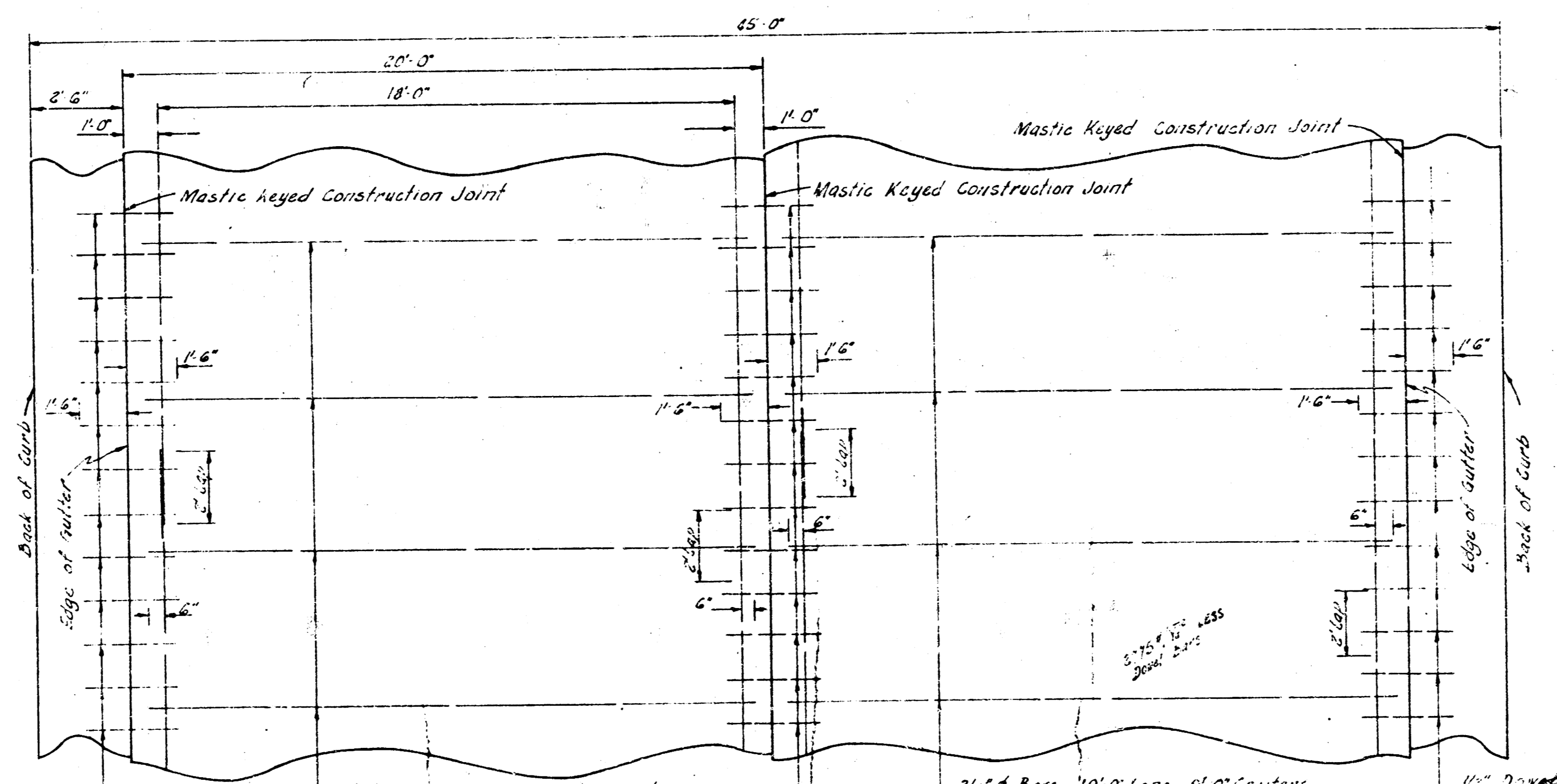

1/2" ϕ Dowel Bars, 3'-0" Long, 2'-6" Centers
 3/4" ϕ Bars, 19'-0" Long, 5'-0" Centers
 3/4" ϕ Bars, 19'-0" Long, 5'-0" Centers
 1/2" ϕ Dowel Bars, 3'-0" Long, 2'-6" Centers
 1/2" ϕ Dowel Bars, 3'-0" Long, 2'-6" Centers

STEEL PATTERN
NOT TO SCALE
USE 3/4" ϕ BARS EXCEPT WHERE NOTED

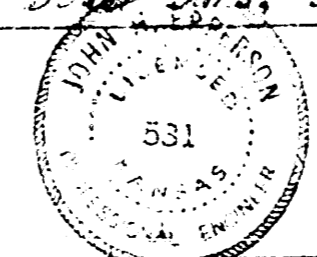

1/6

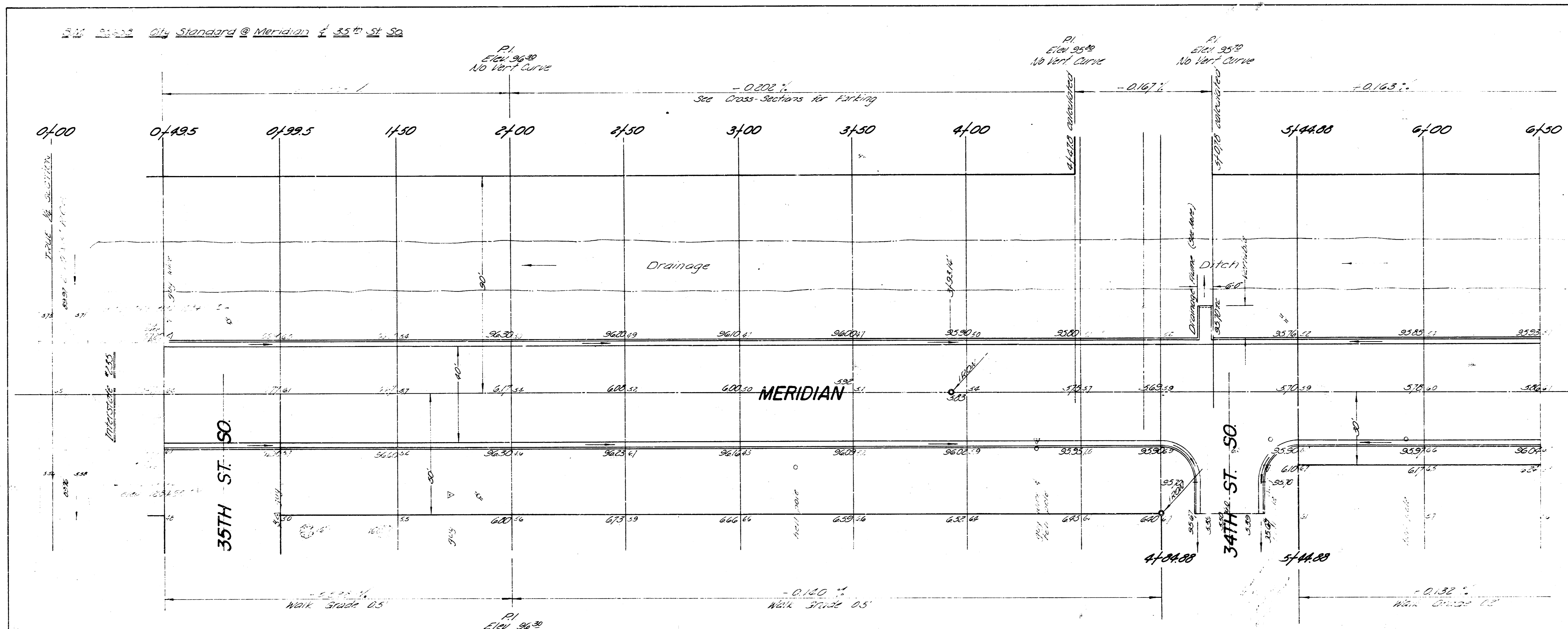

NOTE:
Field engineer shall consult city engineers
office before starting pavement between 0+49.5 &
4+00. Grades in this area may be altered to
maintain interests in pavement.

EXCAVATION			COMP. FILL		
PROP.	IMPROVE.	CITY	PROP.	IMPROVE.	CITY
1,223	716.7	158.5	32.3	64	
1,122	717	139	32	06	
12,34.5	7004	1746	35.5	70	

Drainage Flume Note:
Paving contractor shall construct drainage flume
at Sta. 4+00 as instructed by city field engineer.
Flume shall be poured (6" thick edge) with integral
curb as shown. Length of flume to be determined by
field engineer.

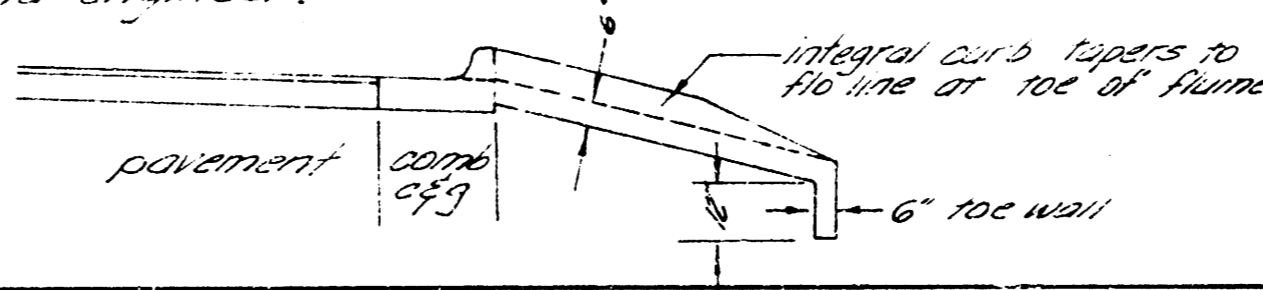

STREET	MERIDIAN AVENUE		
LIMITS	S.L. BUILDERS 17TH ADDN TO & 33RD		
PAVEMENT	40'-2'-44' ASPHALT		
DEPARTMENT	CITY ENGINEERING DEPT. WICHITA, KANSAS		
SCALE:	1" = 20'	BOOK NO.	JFG 54
DRAWN BY:	J. JONES	PROJ. NO.	C-0-94
		DATE:	7/27/94

E.V. 32.35 SA cor conc paron No. 940 S. Meridian

P1
Elev 96.90
No 120' Curve

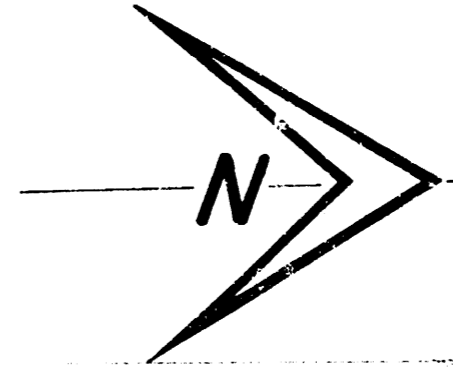

+0.163 %
See cross-sections for parking

-0.103 %
See cross-sections for parking

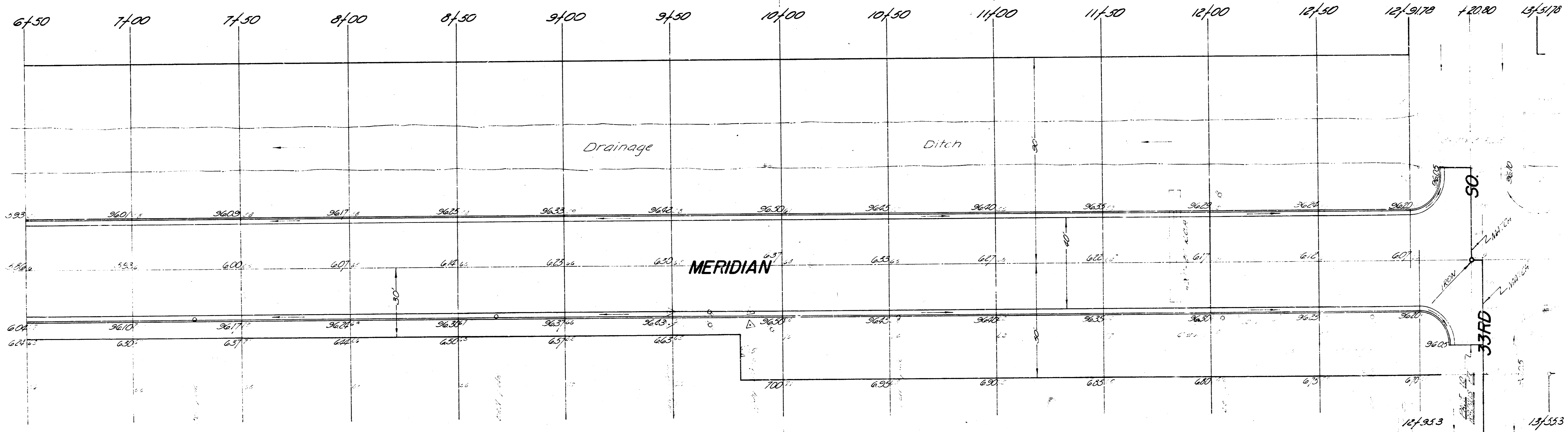

CONSTRUCT BANK DRIVES TO STA 9+40

+0.132 %
WALK BRIDGE DE

-0.102 %
WALK BRIDGE DE

P1
Elev 96.90
No 120' Curve

MERIDIAN
C10-94