

BM 12295 "G" IN GRADE 7' ON W END S. 1ST MILLAIR & MANLYS
 BM 12437 "T" IN TROY TOP PLUS NE COR MINNERPOLIT & 21ST ST.

Bl. 10-2
 Surveyed
 Encaps.
 Checked S.A.F.E.

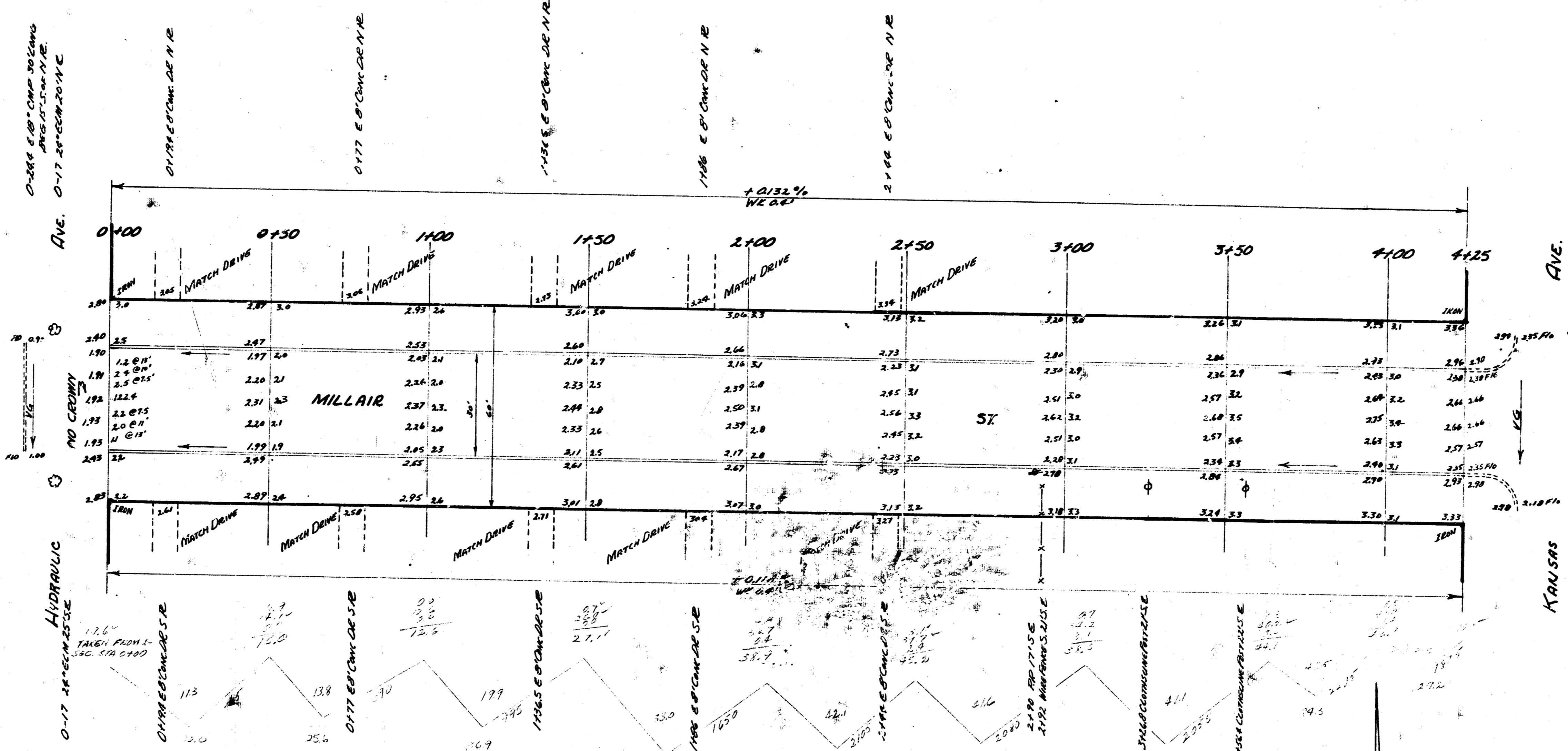

MILLAIR ST.
 E.L. HYDRAULIC TO W. KANSAS
 30' CONC + CB
 CITY OF WICHITA, KANSAS
 B.E. SMITH CITY ENGINEER
 JAN, 13, 1953 PROJ. No. C12-148

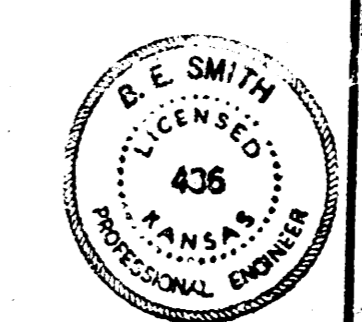

1"=20'

1 2 3 4