

B.M. 113.22 "X" On W.C.B. of Millwood S.L. 3<sup>RD</sup>  
 B.M. 113.74 "X" On S End C.B. Radius S.E. Vine & 3<sup>RD</sup>  
 B.M. 117.02 S.E. Cor. Conc. Parch. N.W. Cor. St. Louis & Millwood  
 Stationing & Base Line

NOTE:  
 Construction of new C.B.s and leads on Millwood  
 at intersections of 3<sup>rd</sup> St. and at St. Louis St. to  
 be done in connection with Incidental Drainage  
 to Millwood Ave., Proj. No. C15-204.

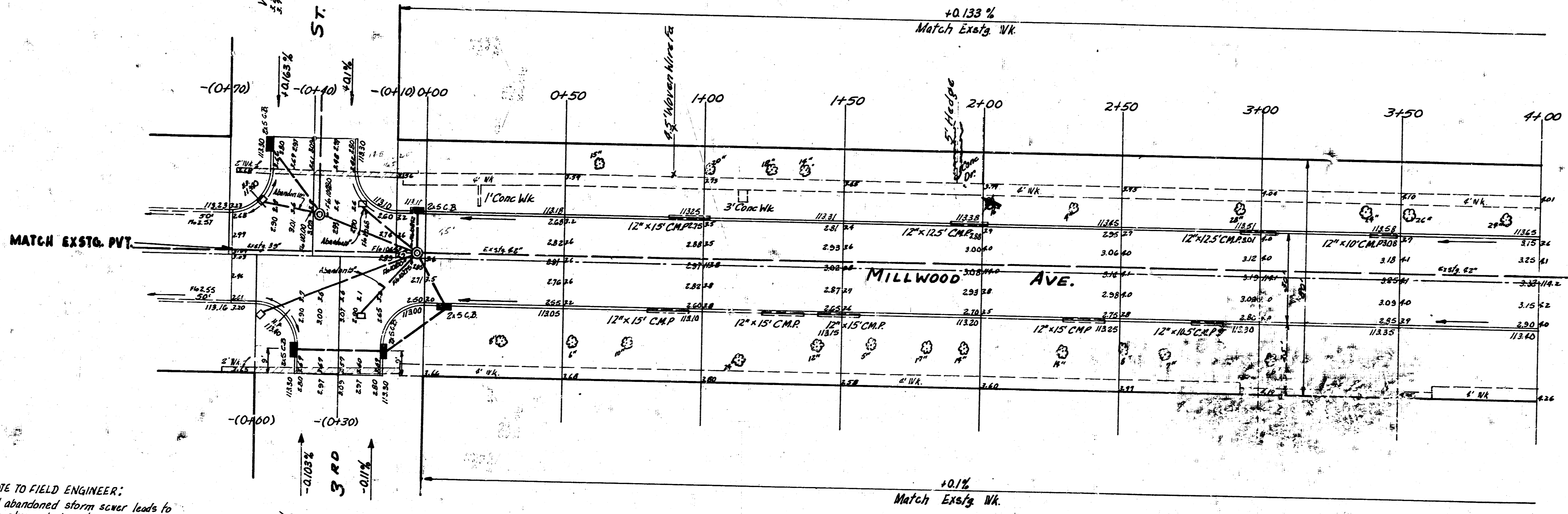

NOTE TO FIELD ENGINEER:  
 All abandoned storm sewer leads to  
 be plugged by others.

Survey  
 Plan  
 Checked  
 7/1

MILLWOOD  
 S.L. 3<sup>RD</sup> To S.L. McLEAN BLYD  
 30' CONC & C.B.  
 CITY OF WICHITA KAN.  
 BE SMITH CITY ENGINEER  
 Oct. 1955 Proj. No. C15-204



1/2

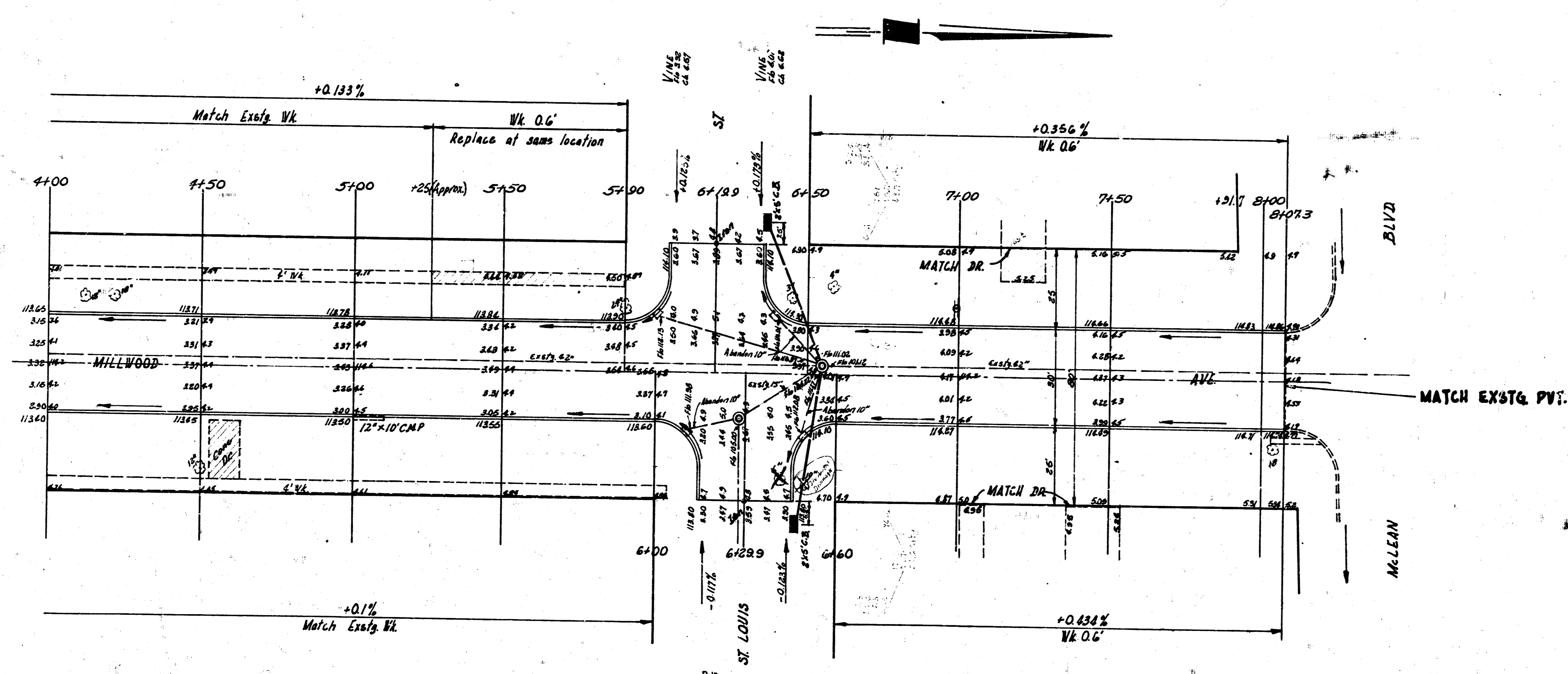

NOTE TO FIELD ENGINEER:  
 All abandoned storm sewer leads to  
 be plugged by others.

2  
2

MILLWOOD AVE.  
 PROJ. NO. C15-204

B.M. 11322 "X" on W. Cb. of Millwood S.L. 3rd  
 B.M. 11374 "X" on S. End Cb. Radius S.E. Vine & 3rd  
 B.M. 11702 S.E. Cor. Conc. Patch N.W. Cor. St. Louis & Millwood  
 Stationing & Base Line on E.

Survey shown  
 on 462  
 Checked 77

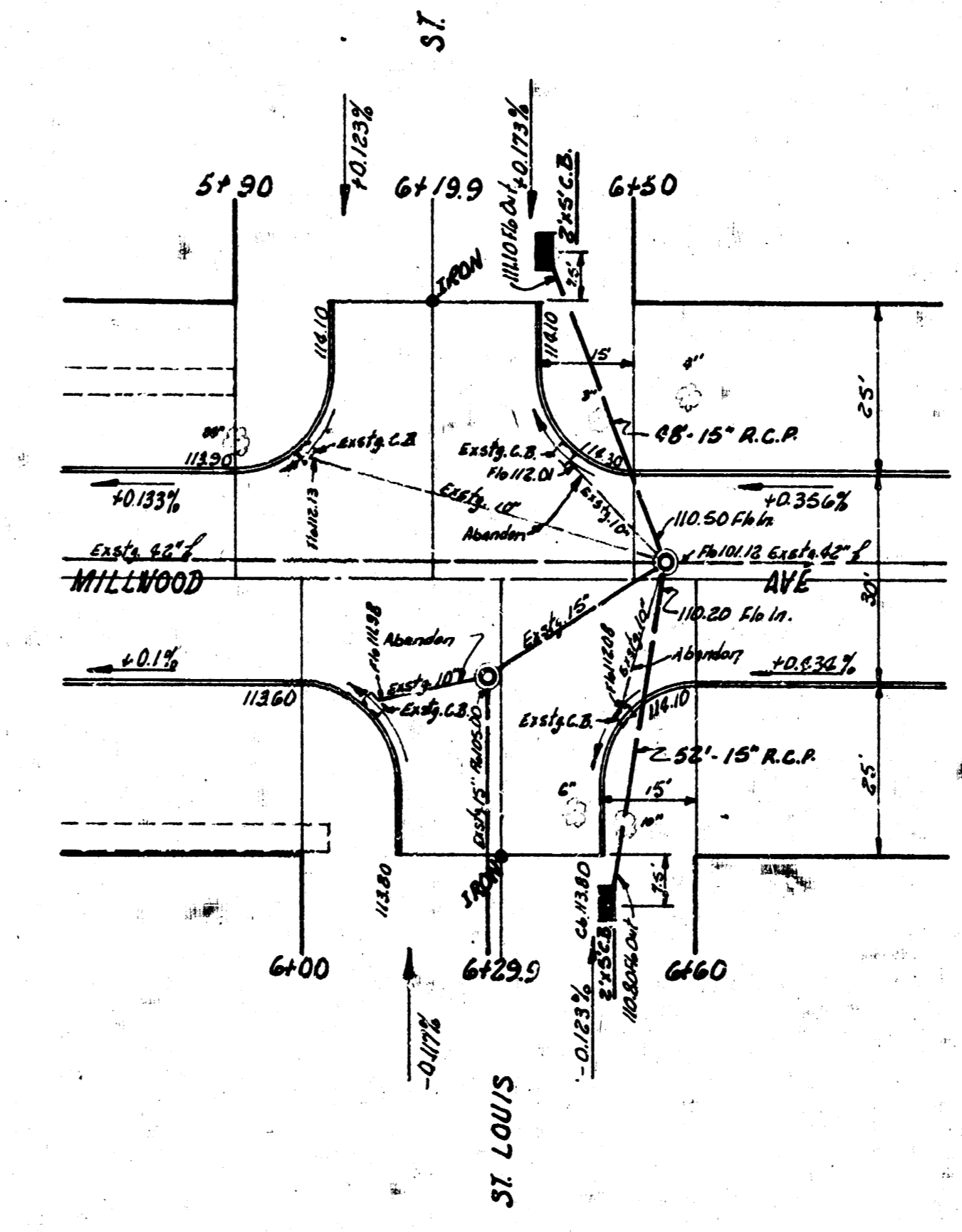
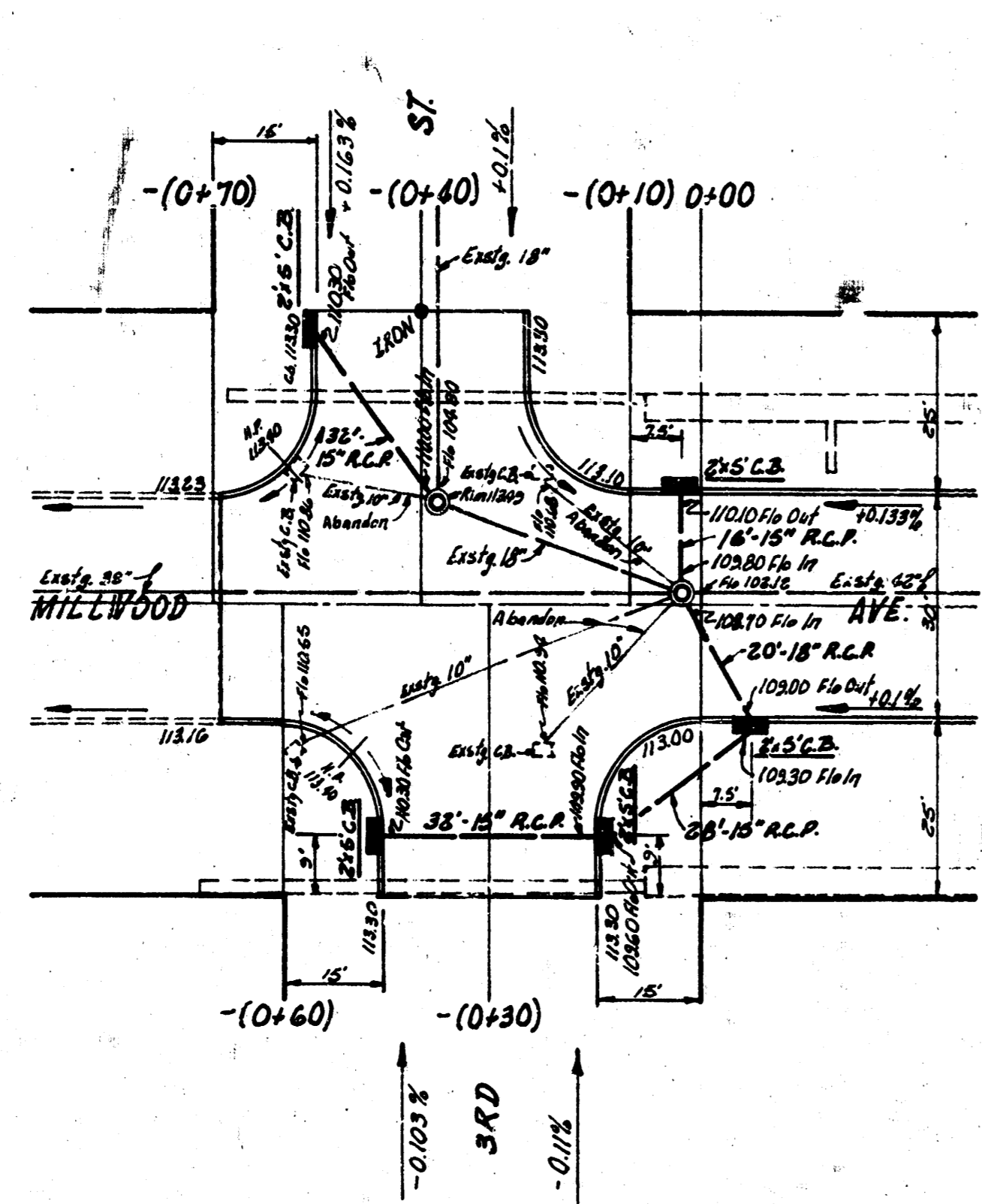

INCIDENTAL DRAINAGE  
 IN CONNECTION WITH PAVING OF MILLWOOD  
 FROM SL 3RD TO SL McLEAN BLVD  
 CITY OF WICHITA, KANS.  
 B.E. SMITH CITY ENGINEER  
 PROJ. NO. C15-204

