

BM: 108.00 "M" in Mueller Fire Plug NE cor Millwood & Walker.
 BM: 108.31 NW cor conc. porch Ho¹⁰²⁸ S Millwood

NOTICE TO FIELD ENGINEER:
 Any additional work or drives other than shown on Plan will be done
 only on receipt of a letter of authorization by the City Engineer, signed
 by the Property Owner. Said additional work will then be done and all
 costs of said work will be charged directly to that owner.

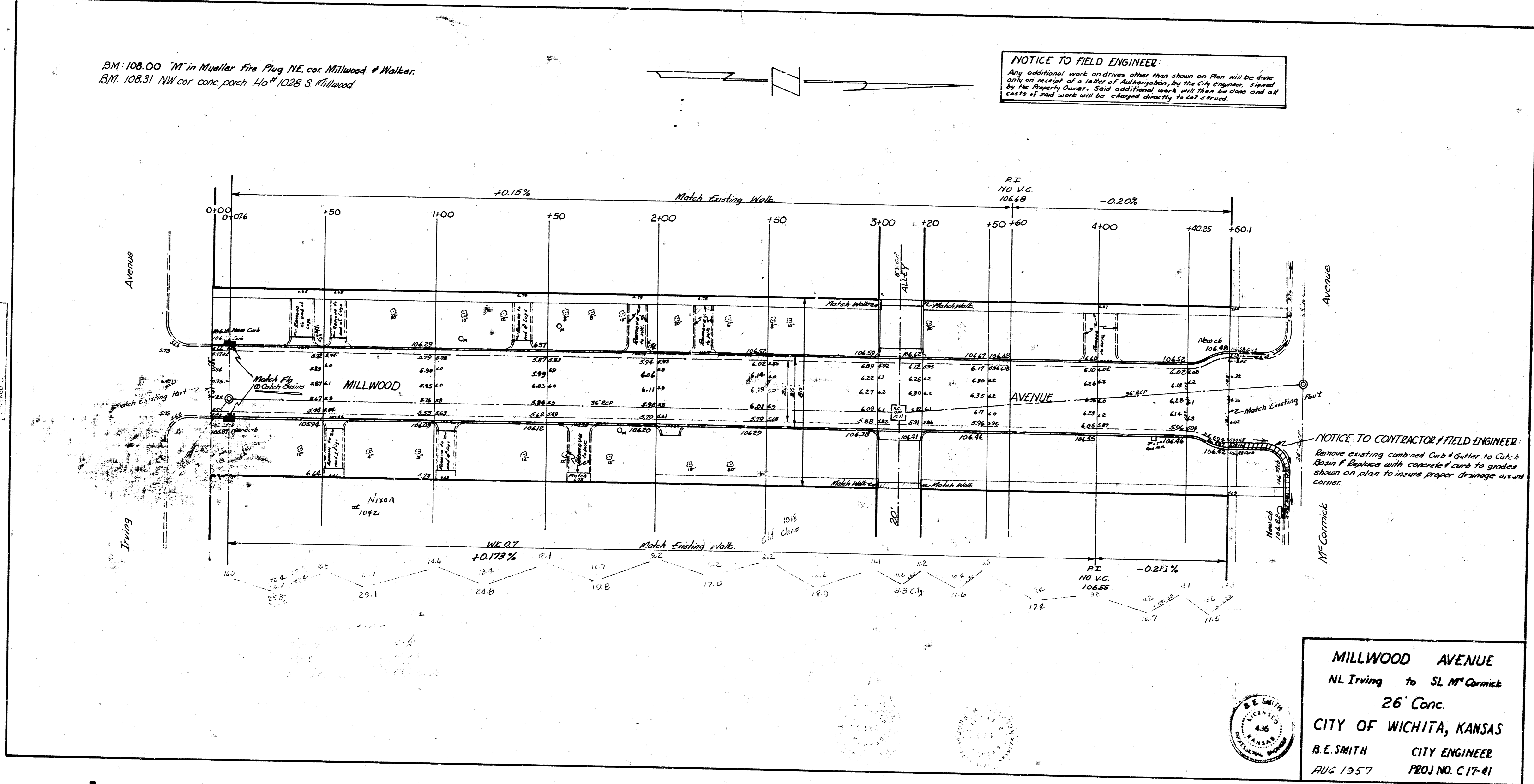

NOTICE TO CONTRACTOR & FIELD ENGINEER:
 Remove existing combined Curb & Gutter to Curb &
 Basin & Replace with concrete curb to grades
 shown on plan to insure proper drainage at road
 corner.

MILLWOOD AVENUE
 NL Irving to SL M^c Cormick
 26' Conc.
 CITY OF WICHITA, KANSAS
 B.E. SMITH CITY ENGINEER
 AUG 1957 PROJ NO. C 17-41



Bk. 186 Y
 Young
 &
 Grooms
 Surveyors
 L.L. Young
 L.L. Grooms