

BM. 98.32 "G" in GLOBE S. END Co. NE COR. MINNEAPOLIS NL. HODSON  
 BM. 99.27 SE COR. PARCH. HOS. 2257 S. MINNEAPOLIS.

NOTE: INSTALL 18" R.C.P.  
 UNDER PAVT. INSTALL AT RIGHT  
 ANGLE TO FRONT. IF POSSIBLE TO USE  
 MINIMUM AMOUNT OF PIPE.

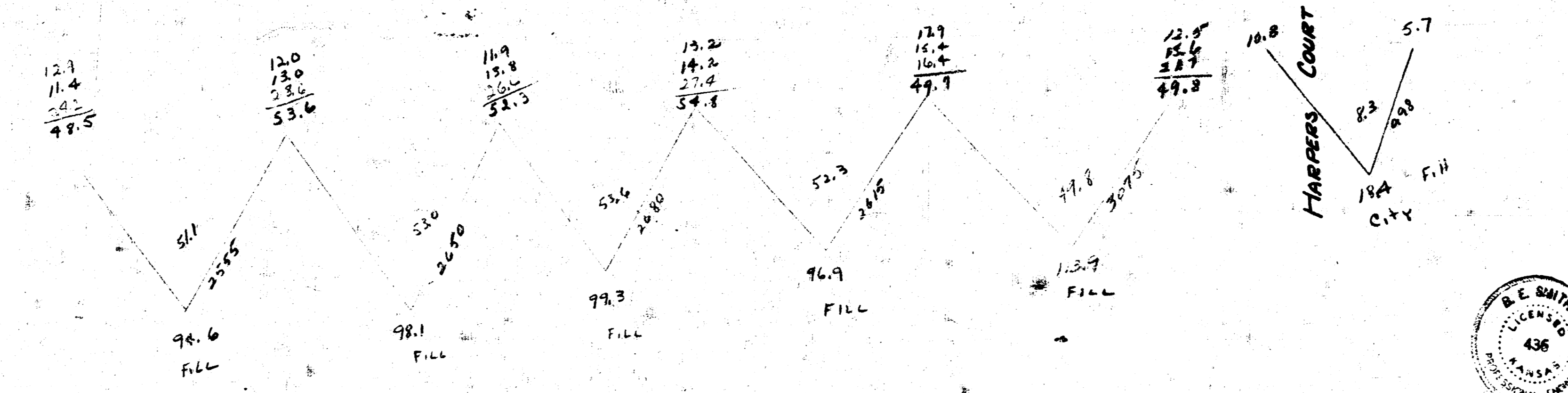
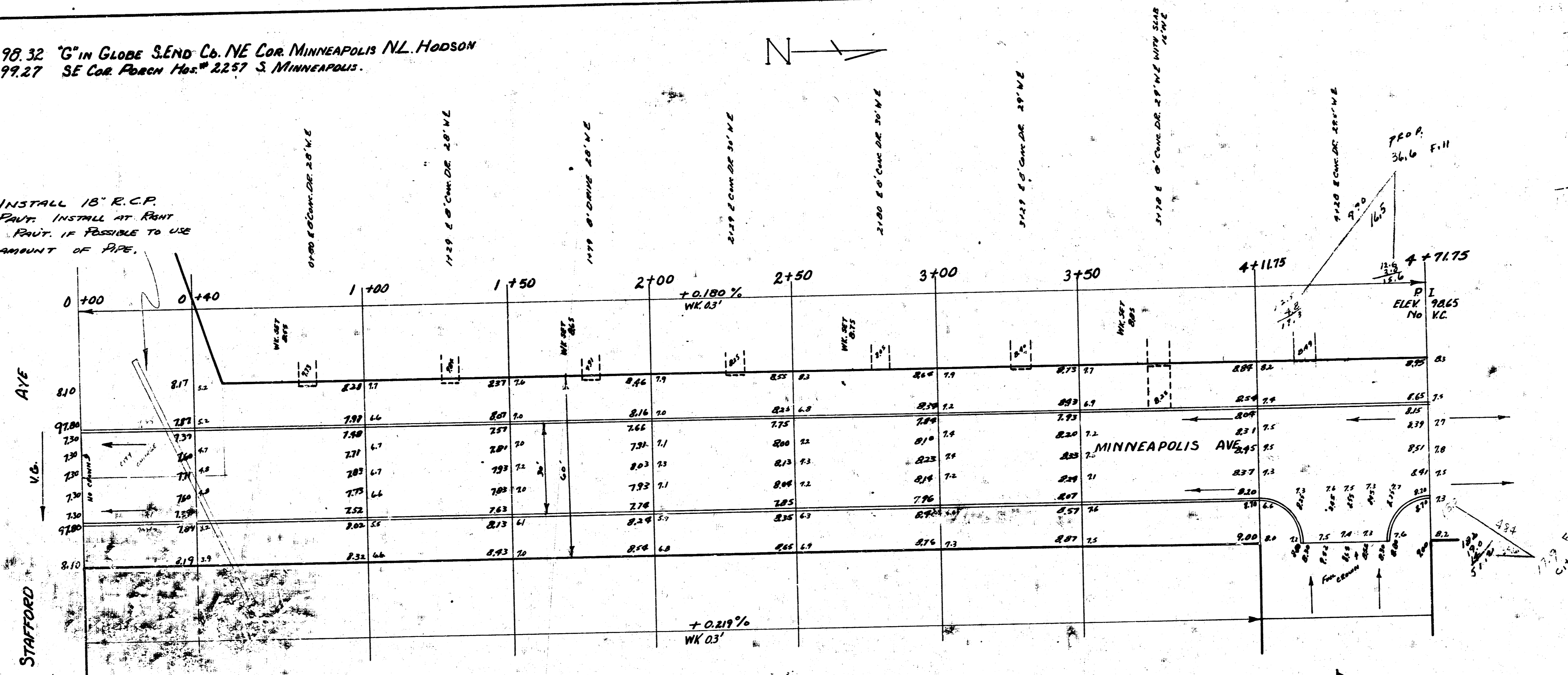

MINNEAPOLIS AVE.  
 NL. STAFFORD TO E. HODSON  
 30' CONC. & CB.  
 CITY OF WICHITA, KANSAS  
 L.K. WHITE CITY ENGINEER  
 JULY 1952 PROJ. NO. C-11-88

1  
2

5-1.5

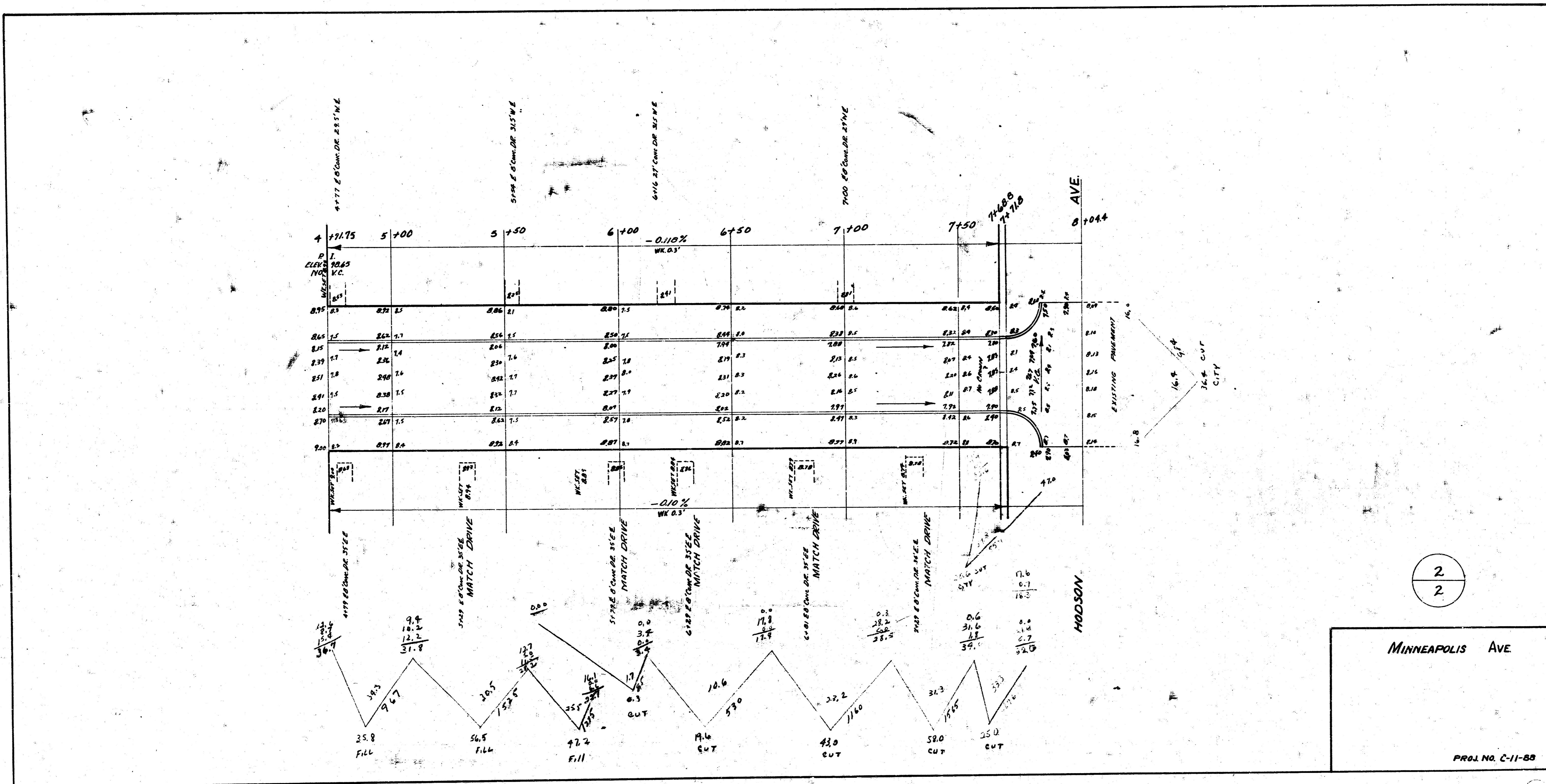

2  
2

MINNEAPOLIS AVE

PROJ. NO. C-11-88

1 3 5 12