

B.M. 128.16 80° Spike N.S. K.G.E. Pole SL Detwiler's 150' E of E.L. Kansas
 B.M. 128.68 S.W. Cor. Conc. Porch Hox # 2520 N. Minneapolis.

Chain N on W12

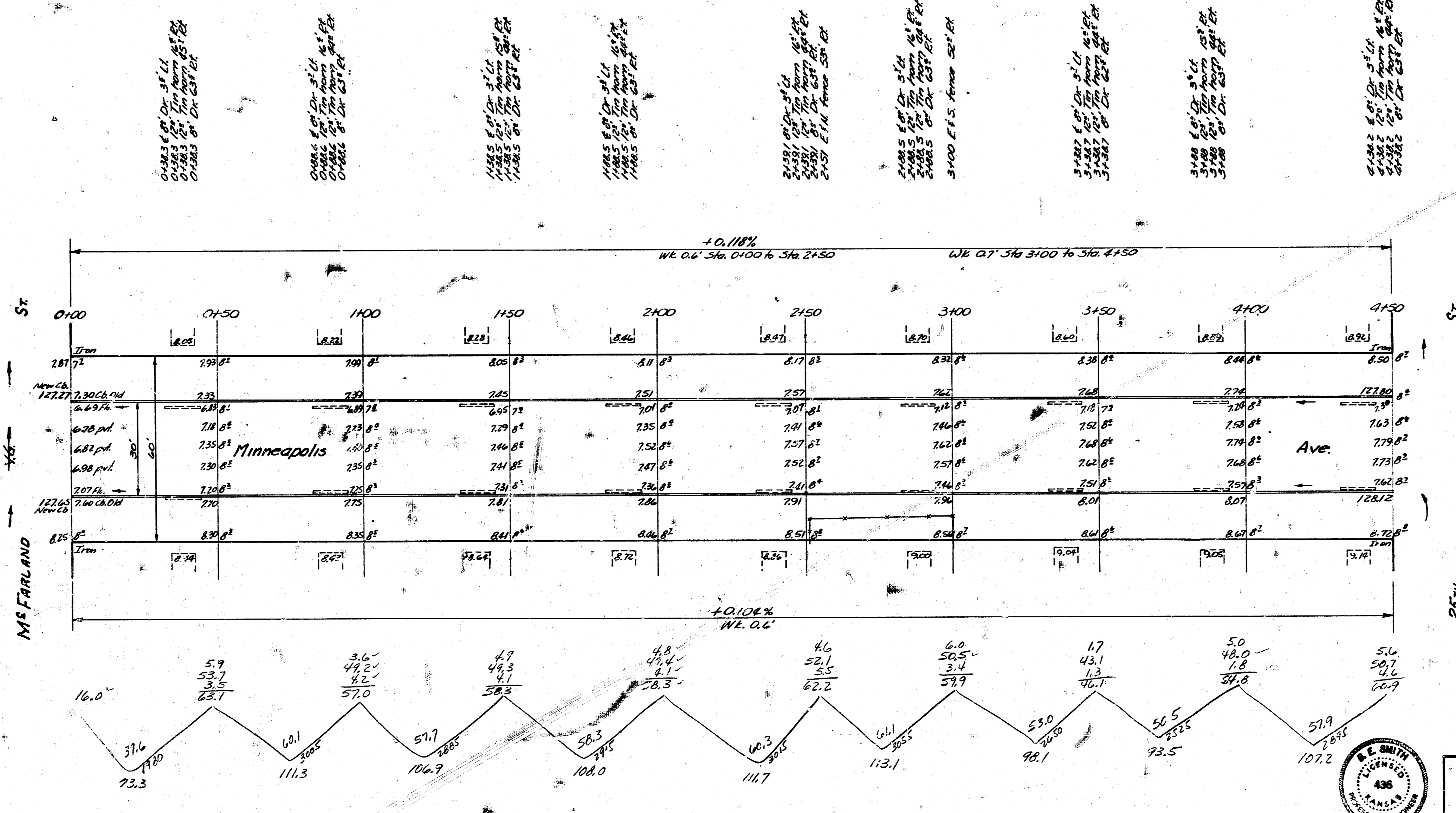

Prop.	Excav.	cut
73.3		0
111.3		
106.9		
108.0		
111.7		
113.1		
98.1		
93.5		
107.2		
923.1		
447		
72.3		
Total 1015.4		

City of Wichita, Kansas
 B.E. Smith
 Professional Engineer

NOTE TO CONTRACTOR & FIELD ENGINEER:
 ALL ENTRANCE PIPE TO BE PLACED ON OWNERS
 PROPERTY. THE STREET DEPT. WILL HAUL THIS
 PIPE AWAY AT THE REQUEST OF THE PROPERTY
 OWNER.

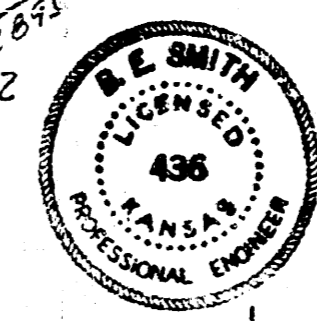

MINNEAPOLIS AVE
 N.L. M^E FARLAND TO S.L. 25TH
 30' CONC & CB

CITY OF WICHITA, KANSAS
 B.E. SMITH CITY ENGINEER
 JAN. 21, 1953 PROJ. NO. C12-207