

Book # 1

B.M. 124.43 N.W. Cor. Conc. Strip No. 1954 MINNESOTA

B.M. 124.00 S.E. Cor. Patch @ 2101 N. MINNESOTA

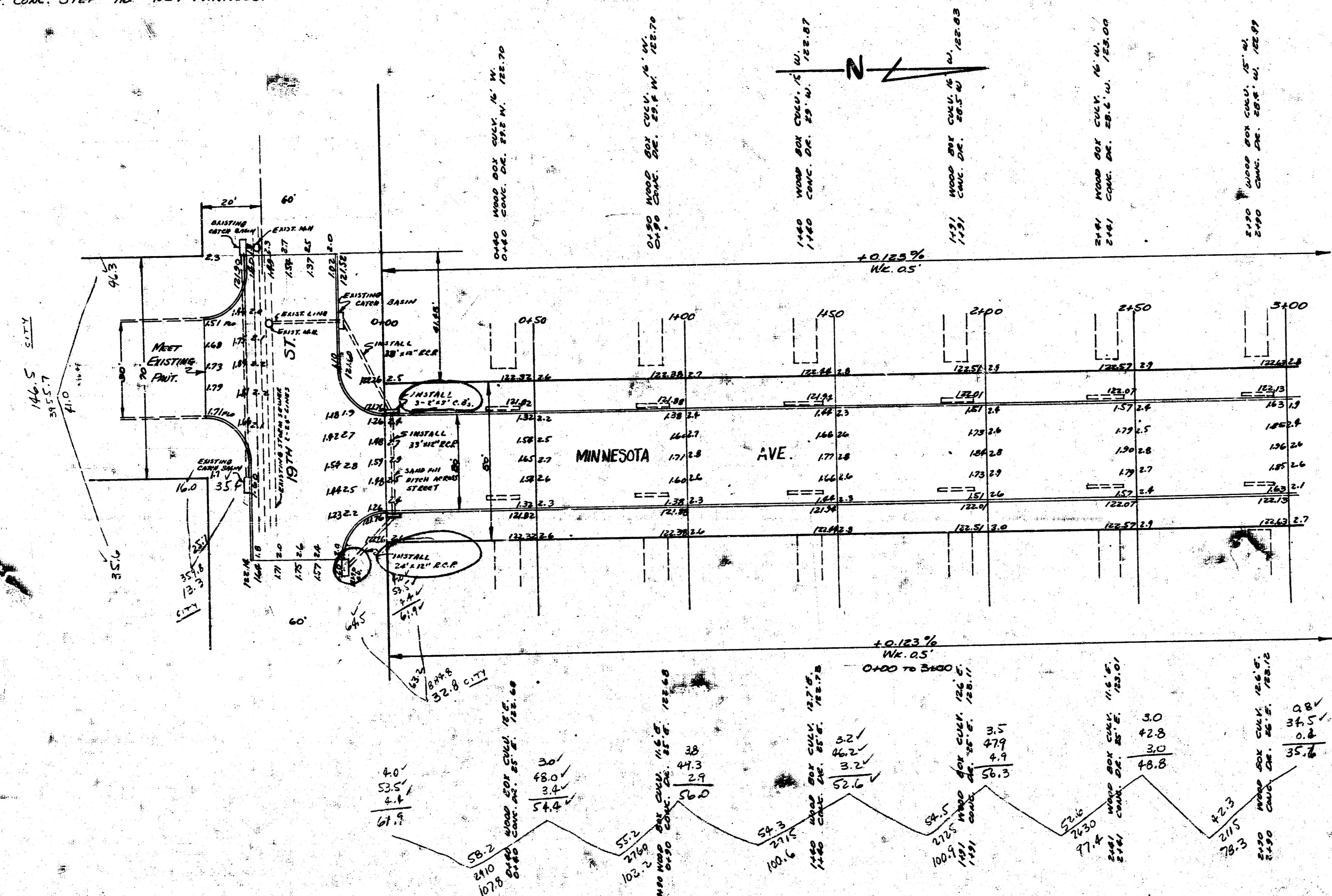

Exc.	
P200.	CITY
107.8	15.5
102.2	32.8
100.6	42.7
100.7	12.5
97.4	6.0
18.3	
60.0	202.0
53.5	+10.0
48.7	
93.0	285.7
37.3	
39.3	
371.0	
+10.0%	
750.1	44.405.

MINNESOTA AVE.
 SL 19TH ST. NL 20TH ST.
 30" CONC. AND CB.
 CITY OF WICHITA, KANS.
 LK WHITE CITY ENGINEER
 JUNE, 1950 PRO NO. C10-53

29 d. 1955

